

UTILITIES BY OTHERS

ALL PROPOSED UTILITY WORK SHOWN ON THIS SHEET WILL BE DONE BY OTHERS. NO PAYMENT WILL BE MADE TO THE CONTRACTOR FOR PROPOSED UTILITY WORK SHOWN ON THIS SHEET.

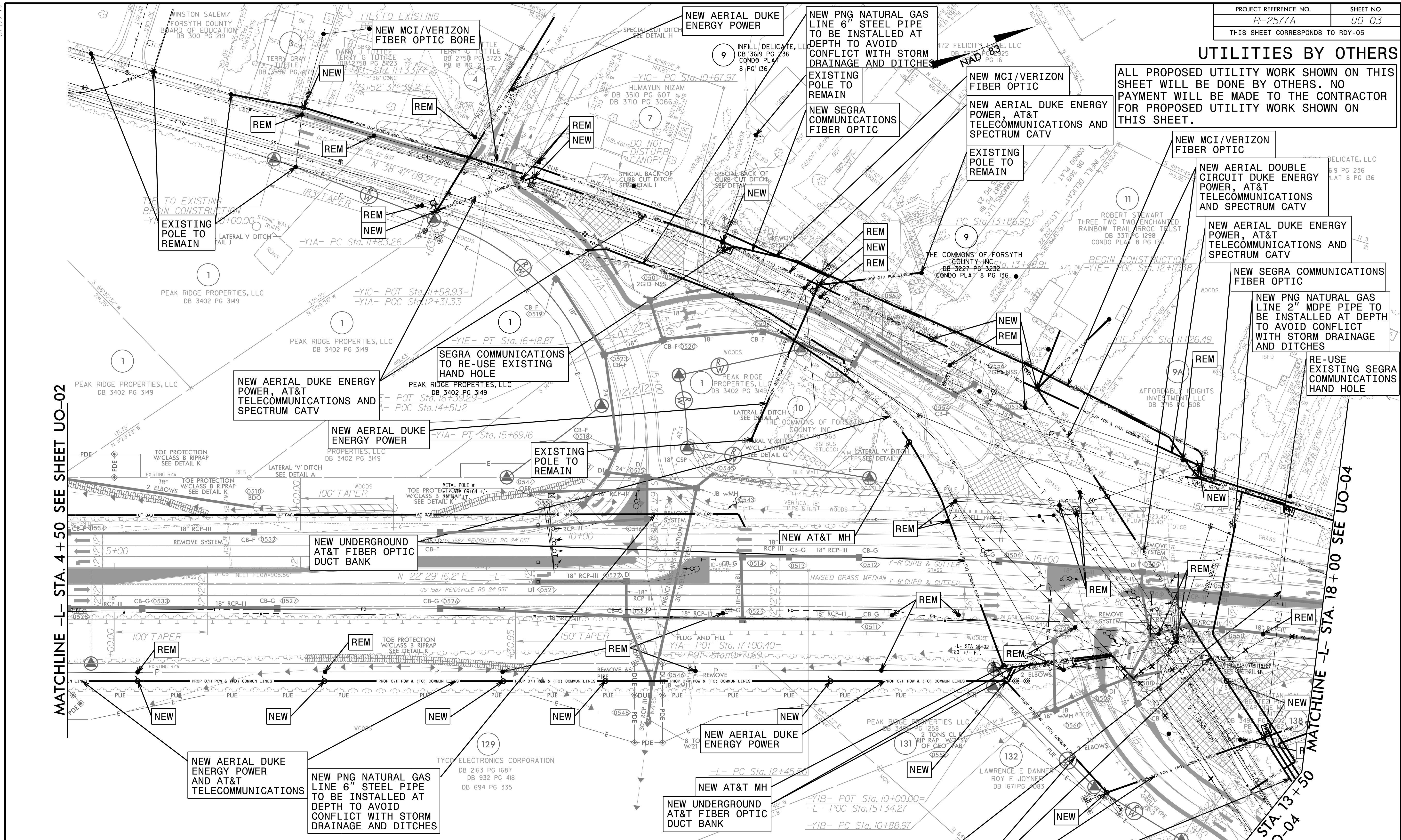

MATCHLINE -L- STA. 4 + 50 SEE SHEET UO-02

MATCHLINE -L- STA. 18 + 00 SEE UO-04

UTILITY OWNERS ON THIS SHEET

- DUKE ENERGY - POWER (D)
- PIEDMONT NATURAL GAS - NATURAL GAS (6" STEEL)
- AT&T - COMMUNICATIONS (D)
- AT&T - COMMUNICATIONS (T)
- MCI - COMMUNICATIONS
- SEGRA - COMMUNICATIONS
- SPECTRUM - CATV
- CITY OF WINSTON SALEM - WATER (6" & 12" CI, 12" & 24" DIP) & (8" VC) SEWER

NOTE:
1. ALL EXISTING OVERHEAD POWER ROUTING/CONNECTIVITY PROVIDED BY DUKE ENERGY AND GOOGLE EARTH

MATTHEW K HOWARD
KATE M HOWARD
DB 3330 PG 3654
PB 13 PG 159

NEW AERIAL DOUBLE CIRCUIT DUKE ENERGY POWER, AT&T TELECOMMUNICATIONS AND SPECTRUM CATV

RKK
 P: (919) 878-9550
 8601 Six Forks Road, Forum 1, Suite 700
 Raleigh, North Carolina 27615-3960
 NC License No. F-0112
 Engineers | Construction Managers | Planners | Scientists
 www.rkk.com
 Responsive People | Creative Solutions

3/19/2024 R:\11111111\Engineering\UB0\ProJ\NR-2577A\ut_rdy05_U003_psh.dgn