

5/28/24

2/22/2024 1:16:11 PM C:\Users\Engineering\OneDrive\Projects\2577A-UC1\p1\UC36_psh.dgn

THE INSTALLATION OF THRUST COLLARS MAY NOT BE NECESSARY AT ALL RELOCATIONS DUE TO THE PLACEMENT OF INSERTION VALVES.

-W20-L-

PROJECT REFERENCE NO.	SHEET NO.
R-2577A	UC-36
DESIGNED BY: MEP	
DRAWN BY: MEP	
CHECKED BY: BMB	
APPROVED BY: BMB	
REVISED:	
NORTH CAROLINA DEPARTMENT OF TRANSPORTATION	
UTILITIES ENGINEERING SEC. PHONE: (919) 707-6690 FAX: (919) 250-4151	
UTILITY CONSTRUCTION PLANS ONLY	

UTILITY CONSTRUCTION

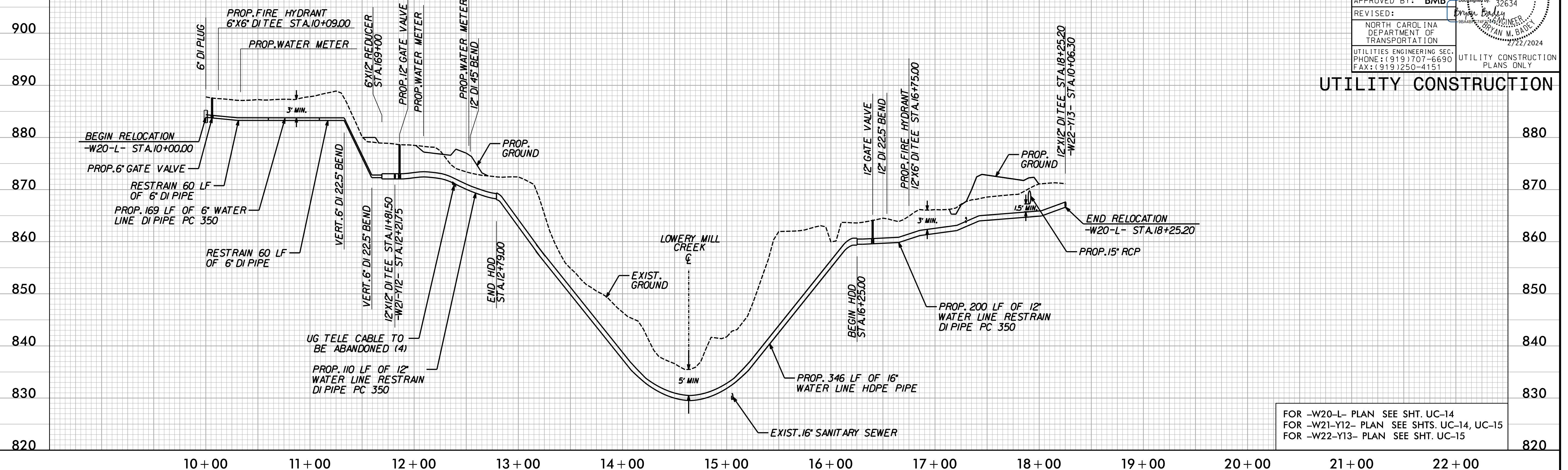

FOR -W20-L- PLAN SEE SHT. UC-14
 FOR -W21-Y12- PLAN SEE SHTS. UC-14, UC-15
 FOR -W22-Y13- PLAN SEE SHT. UC-15

-W21-Y12-

-W22-Y13-

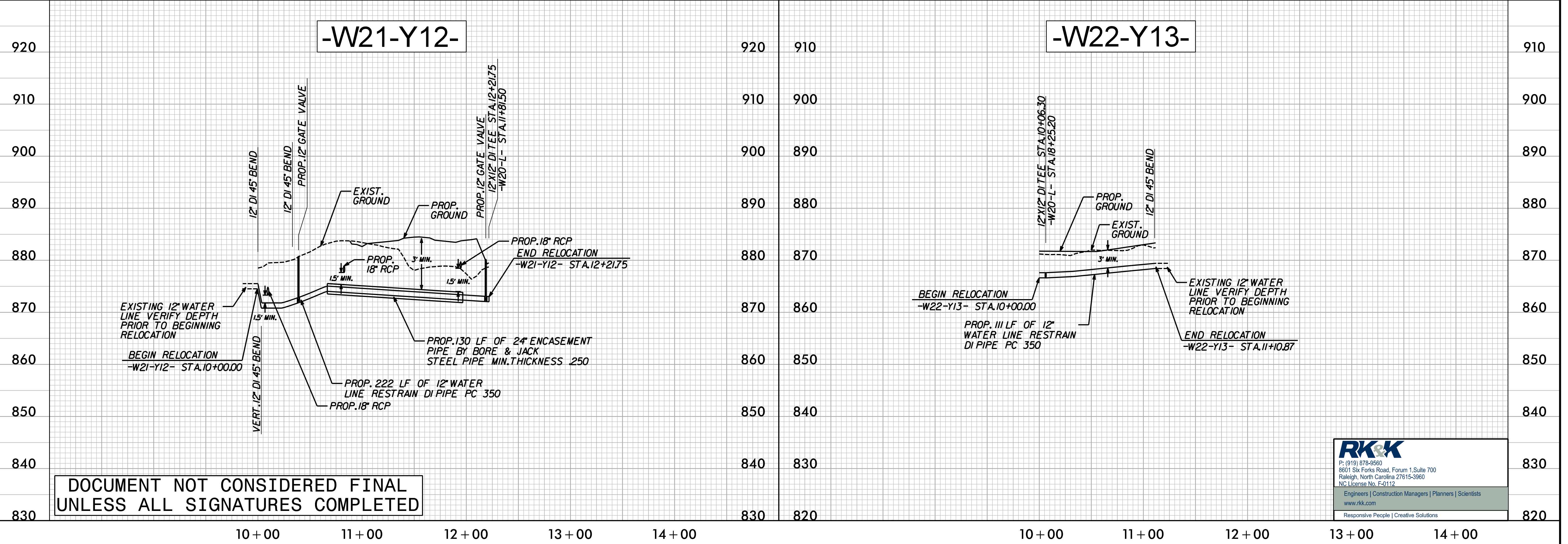

DOCUMENT NOT CONSIDERED FINAL
 UNLESS ALL SIGNATURES COMPLETED