

5/28/24

THE INSTALLATION OF THRUST COLLARS MAY NOT BE NECESSARY AT ALL RELOCATIONS DUE TO THE PLACEMENT OF INSERTION VALVES.

-W3-Y1E-

-W4-L-

PROJECT REFERENCE NO.	SHEET NO.
R-2577A	UC-32
DESIGNED BY: MEP	
DRAWN BY: MEP	
CHECKED BY: BMB	
APPROVED BY: BMB	
REVISED:	
NORTH CAROLINA DEPARTMENT OF TRANSPORTATION	
UTILITIES ENGINEERING SEC. PHONE: (919) 707-6690 FAX: (919) 250-4151	
UTILITY CONSTRUCTION PLANS ONLY	

NOTE: CONTRACTOR TO INSTALL FILL BEFORE INSTALLING -W-4-L-

UTILITY CONSTRUCTION

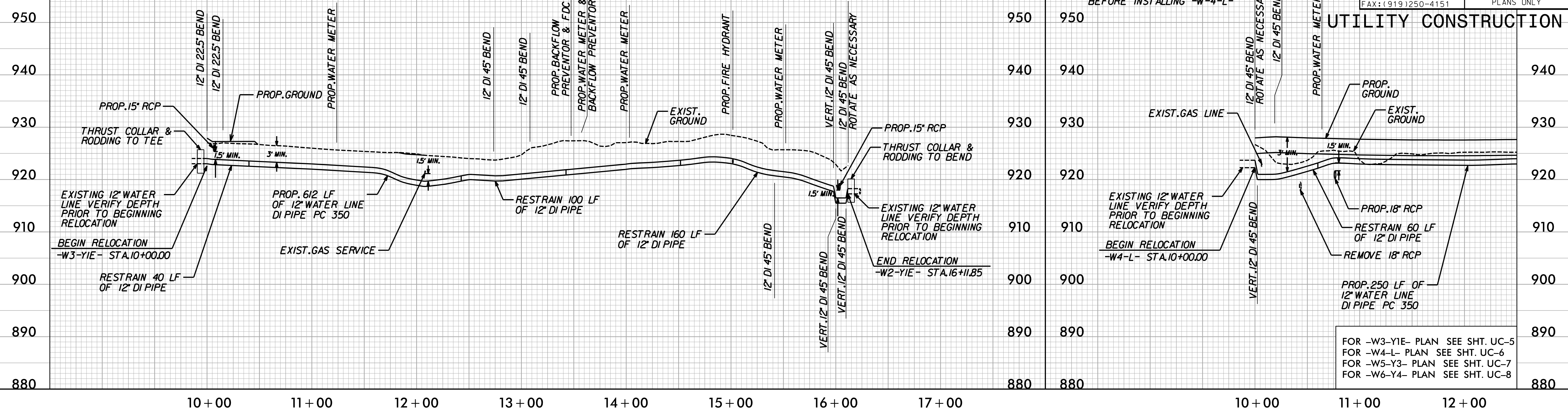

FOR -W3-Y1E- PLAN SEE SHT. UC-5
 FOR -W4-L- PLAN SEE SHT. UC-6
 FOR -W5-Y3- PLAN SEE SHT. UC-7
 FOR -W6-Y4- PLAN SEE SHT. UC-8

-W4-L-

-W5-Y3-

-W6-Y4-

NOTE: CONTRACTOR TO INSTALL FILL BEFORE INSTALLING -W-4-L-

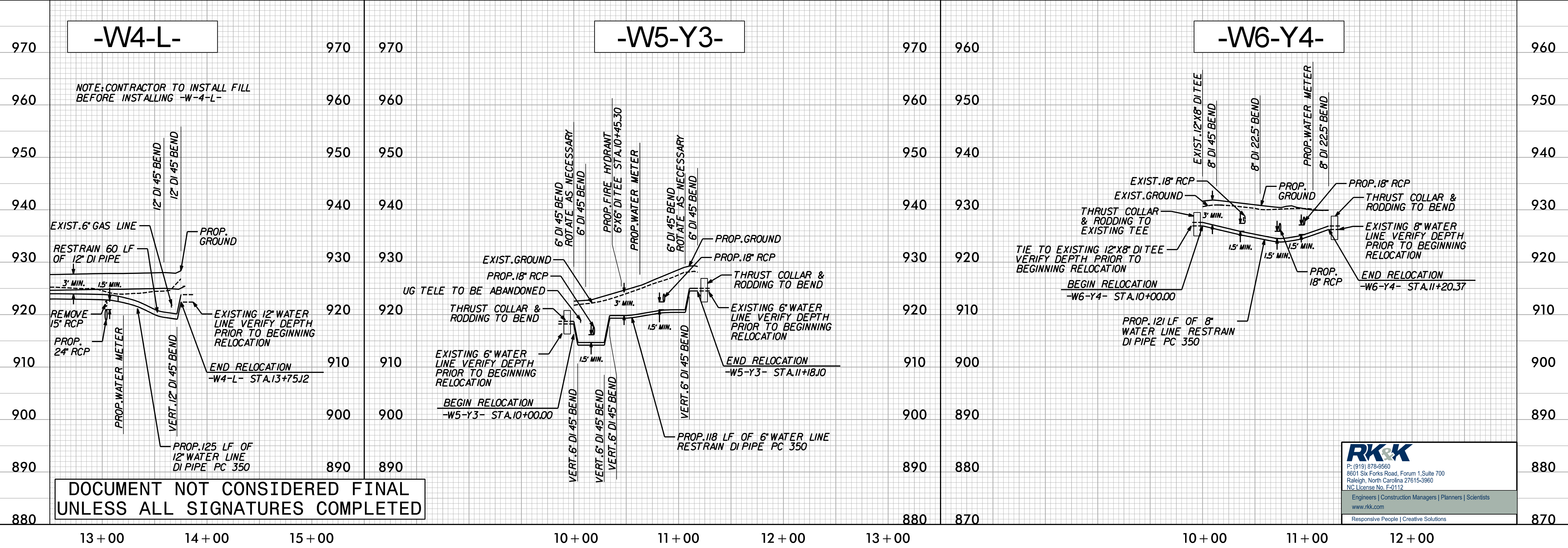

DOCUMENT NOT CONSIDERED FINAL UNLESS ALL SIGNATURES COMPLETED

RK&K
 P: (919) 878-9580
 8601 Six Forks Road, Forum 1, Suite 700
 Raleigh, North Carolina 27615-3960
 NC License No. F-0112
 Engineers | Construction Managers | Planners | Scientists
 www.rkk.com
 Responsive People | Creative Solutions

2/27/2024 1:11:11 PM C:\Users\Engineering\OneDrive\Projects\2577A-U1.p1\UC32.psh.dgn