

STATE OF NORTH CAROLINA
DIVISION OF HIGHWAYS

FORSYTH COUNTY

**LOCATION: US 158 (REIDSVILLE RD.) FROM NORTH OF
US 421/SALEM PARKWAY TO SR 1965 (BELEWS CREEK RD.)**

TYPE OF WORK: TRAFFIC SIGNALS AND SIGNAL COMMUNICATIONS

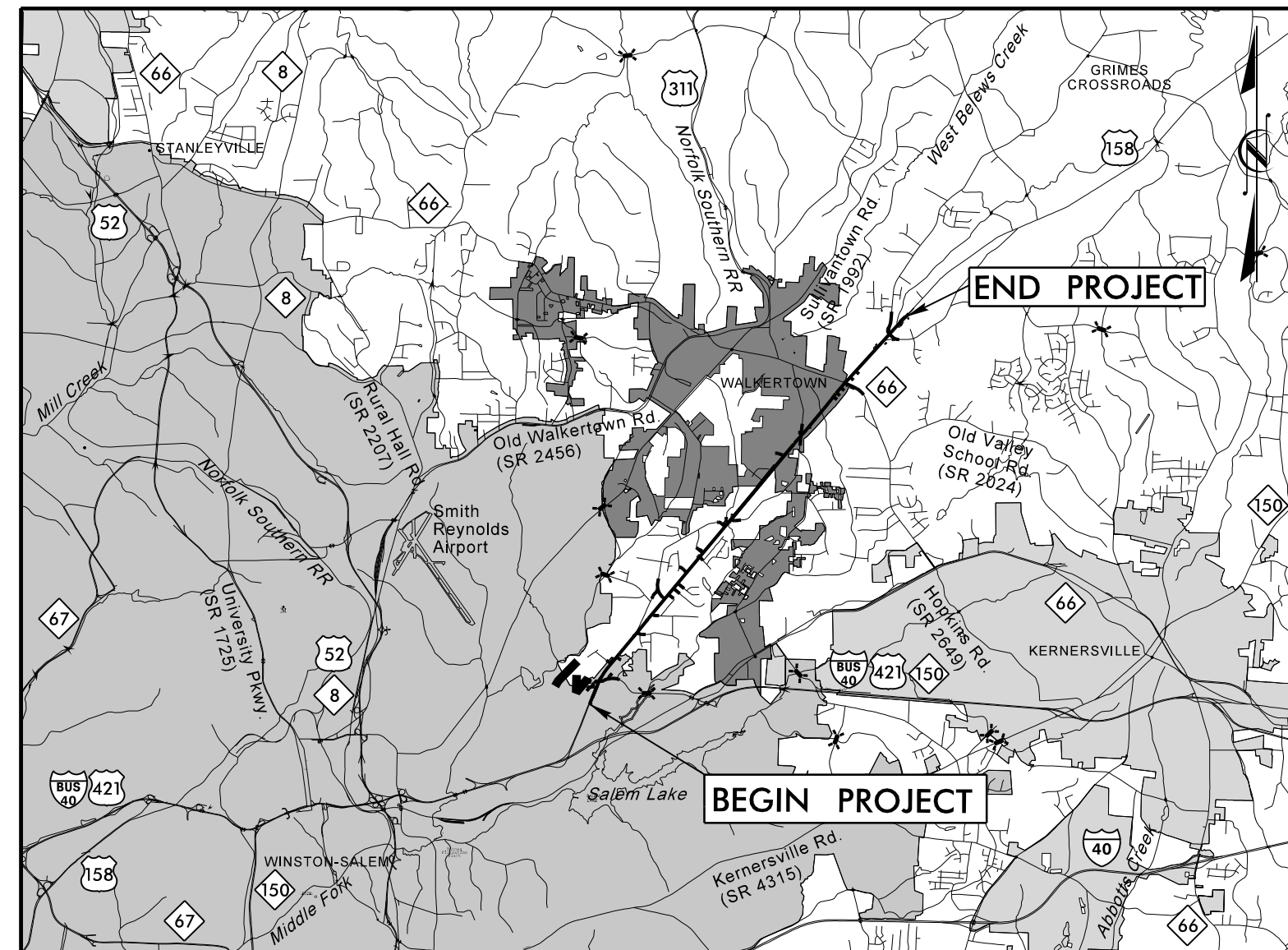
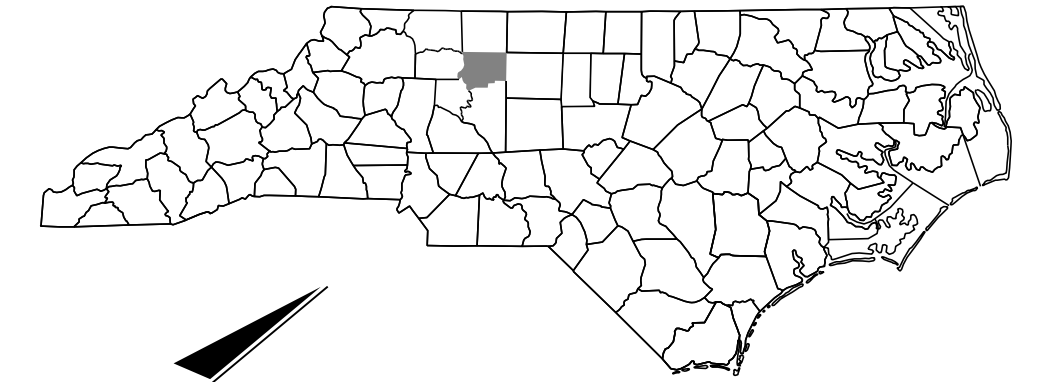

VICINITY MAP (NTS)

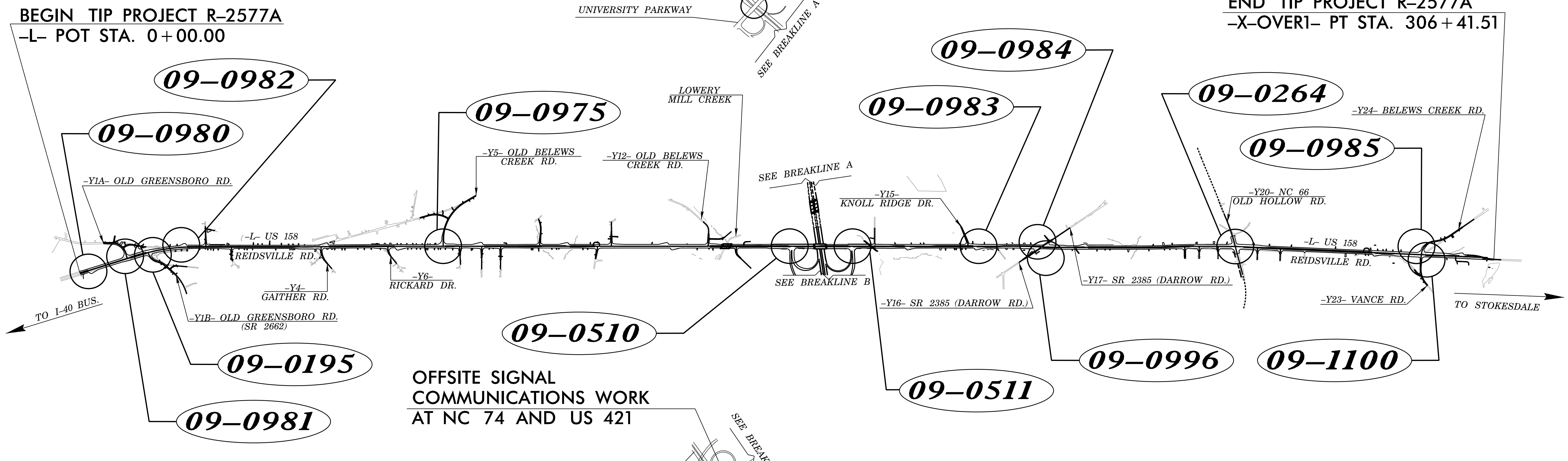

BEGIN TIP PROJECT R-2577A
-L- POT STA. 0+00.00

END TIP PROJECT R-2577A
-X-OVER1- PT STA. 306+41.51

Refer to "Roadway Standard Drawings
NCDOT" dated January 2024 and
"Standard Specifications for Roads
and Structures" dated January 2024.

TIP PROJECT: R-2577A

CONTRACT: C204913

Sheet #	Reference #	Location/Description
Index of Plans		
TITLE SHEET		
SIG. 1	09-0980	US 158 EB (REIDSVILLE RD.) at U-TURN WEST of OLD GREENSBORO RD.
SIG. 2.0-2.6	09-0981	US 158 WB (REIDSVILLE RD.) at OLD GREENSBORO RD.
SIG. 3.0-3.6	09-0195	US 158 EB (REIDSVILLE RD.) at SR 2662 (OLD GREENSBORO RD.)
SIG. 4.0-6.6	09-0982	US 158 WB (REIDSVILLE RD.) at U-TURN EAST of SR 2662 (OLD GREENSBORO RD.)
SIG. 7.0-8.5	09-0975	US 158 WB (REIDSVILLE RD.) at SR 2396 (OLD BELEWS CREEK RD.)
SIG. 9.0-10.5	09-0510	US 158 (REIDSVILLE RD.) at NC 74 EASTBOUND RAMP
SIG. 11.0-15.1	09-0511	US 158 (REIDSVILLE RD.) at NC 74 WESTBOUND RAMP
SIG. 16.0-19.2	09-0983	US 158 EB (REIDSVILLE RD.) at U-TURN WEST of SR 2385 (DARROW ROAD)
SIG. 20.0-21.2	09-0996	US 158 EB (REIDSVILLE RD.) at SR 2385 (DARROW RD.)
SIG. 22.0-27.2	09-0984	US 158 WB (REIDSVILLE RD.) at SR 2385 (DARROW RD.)
SIG. 28.0-29.2	09-0264	US 158 (REIDSVILLE RD.) at NC 66 (OLD HOLLOW RD.)
SIG. 30.0-33.2	09-1100	US 158 EB (REIDSVILLE RD.) at SR 2014 (VANCE RD.)
SIG. 34.0-39.2	09-0985	US 158 WB (REIDSVILLE RD.) at SR 1965 (BELEWS CREEK RD.)
SIG. 40.0-41.2	-----	METAL POLE DETAILS
SIG. M1-M9	-----	SIGNAL COMMUNICATION PLANS
SCP. 1-43	-----	

PLANS PREPARED BY:
RK&K
RUMMEL, KLEPPER & KAHL, LLP
8601 SIX FORKS ROAD, FORUM 1, SUITE 700
RALEIGH, NORTH CAROLINA 27615-3960
NC LICENSE NO. F-0112
1-888-521-4455 OR 919-878-9560

FOR NORTH CAROLINA DEPARTMENT OF TRANSPORTATION

David T. Sears, PE, PTOE
PROJECT ENGINEER

W. Porter Jones, PE
PROJECT DESIGN ENGINEER

**NCDOT TRANSPORTATION SYSTEMS
MANAGEMENT AND OPERATIONS UNIT**
CONTACT INFORMATION:

Phone Number (919) 814-5000

Robert J. Ziemba, PE, CPM - Central Region Signal Engineer
D. Todd Joyce, PE - Signal Equipment Design Review Engineer
Gregg A. Green - Signal Communications Project Engineer

**DIVISION OF HIGHWAYS
TRANSPORTATION MOBILITY
AND SAFETY
DIVISION**

750 N. Greenfield Parkway, Garner, NC 27529