

PROJECT REFERENCE NO. R-2577A		SHEET NO. EC-36/CONST.9	
RW SHEET NO.		HYDRAULICS ENGINEER	
ROADWAY DESIGN ENGINEER		HYDRAULICS ENGINEER	

NOTE: UTILIZE FABRIC INSERT INLET PROTECTION IN LIEU OF TYPE C INLET PROTECTION WHERE WATER MIGHT POND ON ROADWAY USED BY PUBLIC TRAFFIC.

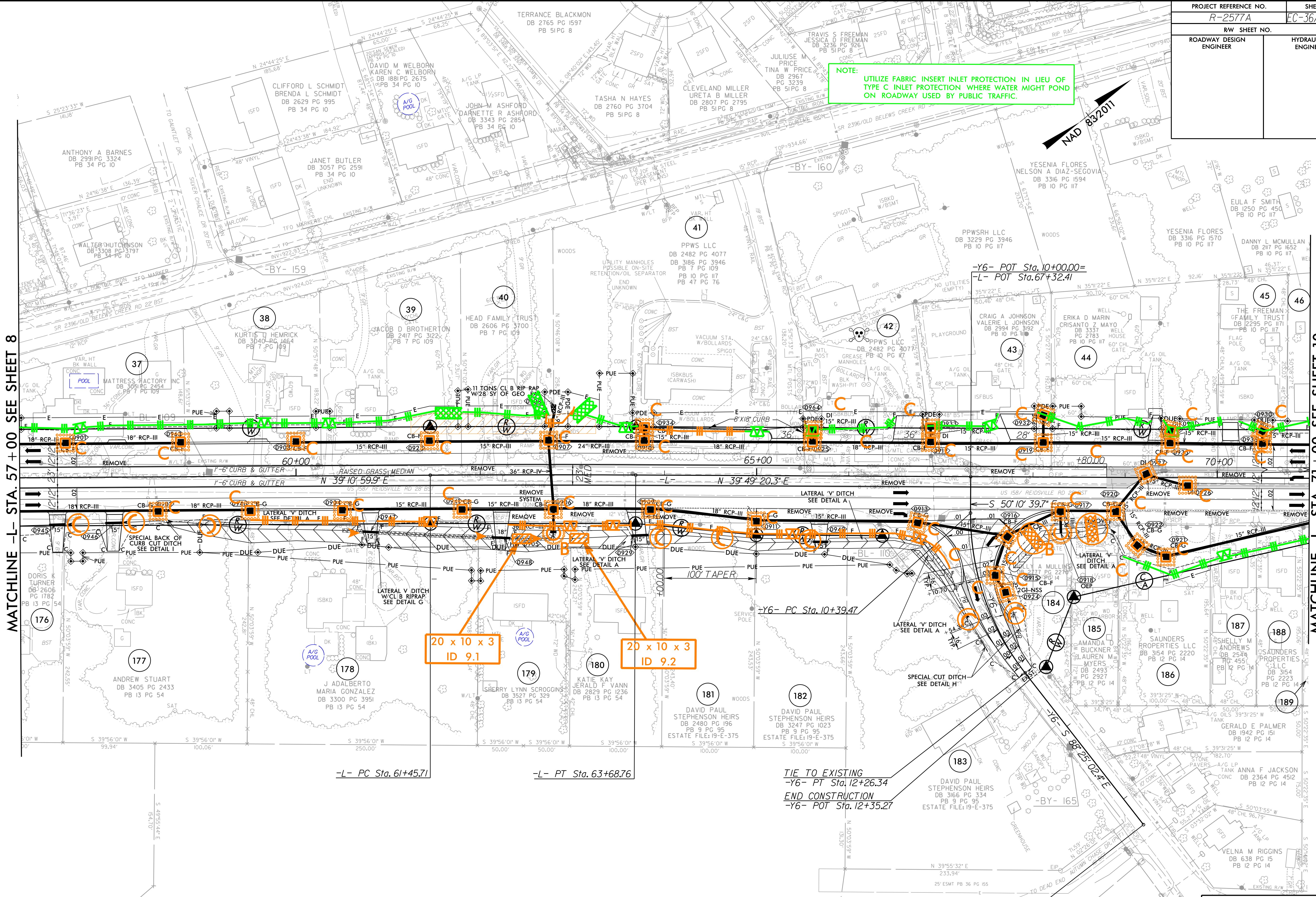
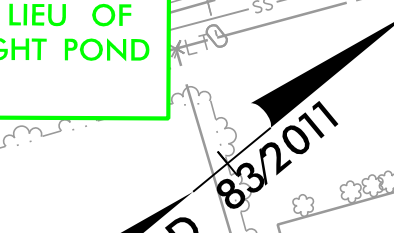

MATCHLINE -L- STA. 57+00 SEE SHEET 8

MATCHLINE -L- STA. 71+00 SEE SHEET 10

20 x 10 x 3
ID 9.1

20 x 10 x 3
ID 9.2

TIE TO EXISTING
-Y6- PT Sta. 12+26.34
END CONSTRUCTION
-Y6- POT Sta. 12+35.27

REMOVAL OF EXISTING PAVEMENT

RK&K
 P: (919) 378-9950
 8601 Six Forks Road, Forum 1, Suite 700
 Raleigh, North Carolina 27615-3960
 NC License No. F-0112
 Engineers | Construction Managers | Planners | Scientists
 www.rk.com
 Responsive People | Creative Solutions

8/17/2023
 C:\Users\jgibson\OneDrive\Documents\Projects\2577A\EC-36\CONST.9\Final.dgn