

-D4-	
PI Sta 10+89.36	PI Sta 11+74.45
$\Delta = 80^{\circ}00'00.0''$ (RT)	$\Delta = 80^{\circ}00'00.0''$ (RT)
D = 143'14" 22.0"	D = 143'14" 22.0"
L = 55.85'	L = 55.85'
T = 33.56'	T = 33.56'
R = 40.00'	R = 40.00'

PROJECT REFERENCE NO. R-2577A	SHEET NO. 26
ROADWAY DESIGN ENGINEER	HYDRAULICS ENGINEER
DOCUMENT NOT CONSIDERED FINAL UNLESS ALL SIGNATURES COMPLETED	

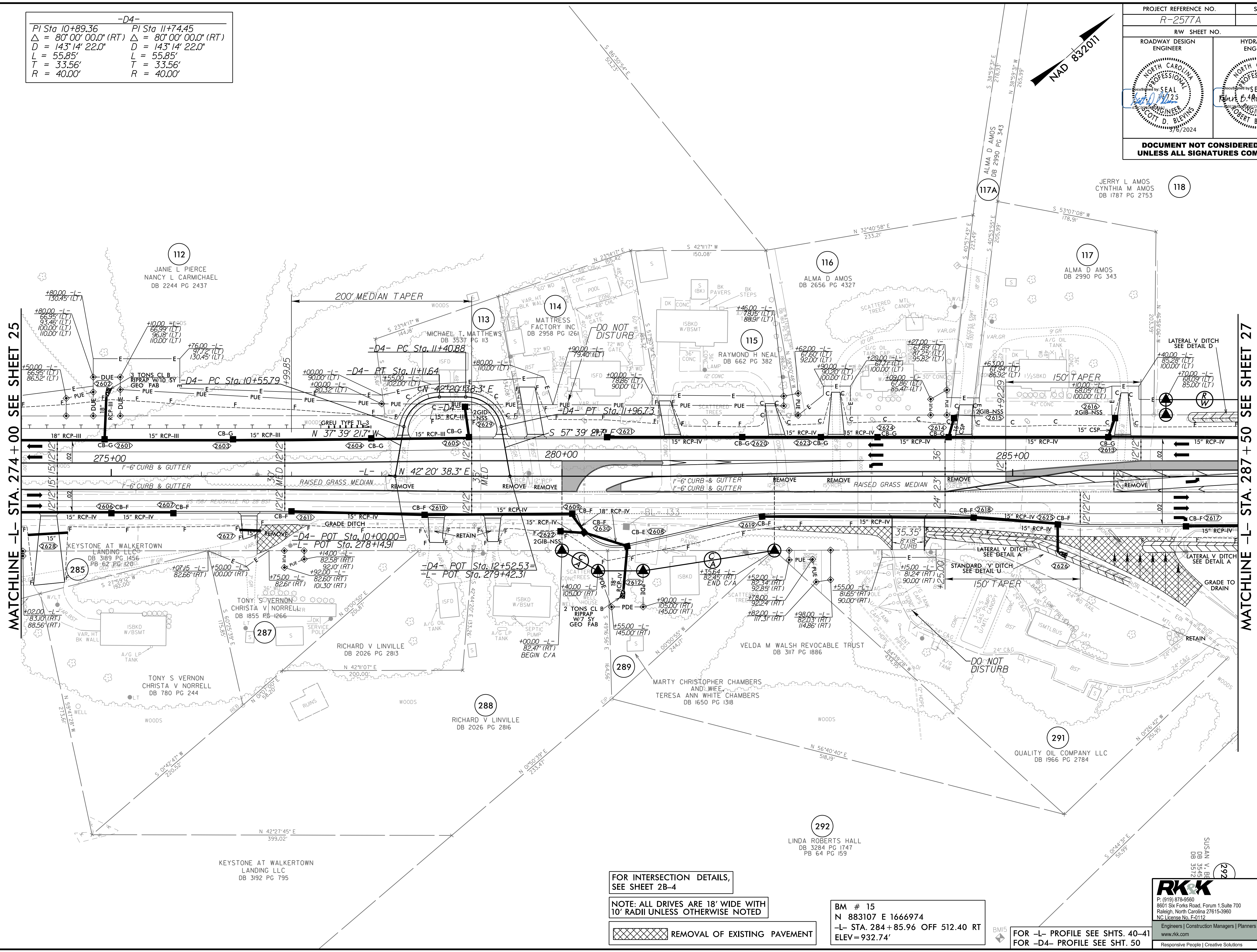

MATCHLINE -L- STA. 274+00 SEE SHEET 25

MATCHLINE -L- STA. 287+50 SEE SHEET 27

FOR INTERSECTION DETAILS,
SEE SHEET 2B-4

NOTE: ALL DRIVES ARE 18' WIDE WITH
10' RADII UNLESS OTHERWISE NOTED

REMOVAL OF EXISTING PAVEMENT

BM # 15
N 883107 E 1666974
-L- STA. 284+85.96 OFF 512.40 RT
ELEV = 932.74'

FOR -L- PROFILE SEE SHTS. 40-41
FOR -D4- PROFILE SEE SHT. 50

RKK
P: (919) 878-9560
8601 Six Forks Road, Forum 1, Suite 700
Raleigh, North Carolina 27615-3960
NC License No. F-0112
Engineers | Construction Managers | Planners | Scientists
www.rkk.com
Responsive People | Creative Solutions

8/17/2023 R:\Roadway\Proj\R-2577A_r.dwg_psh26.dgn