

-Y12-  
 PI Sta 20+65.53  
 $\Delta = 49^{\circ} 29' 20.2" (RT)$   
 $D = 28^{\circ} 38' 52.4"$   
 $L = 172.75'$   
 $T = 92.18'$   
 $R = 200.00'$   
 $SE = EXIST.$   
 $DS = EXIST.$

GENERAL NOTE:  
 PLEASE REFERENCE PLAN SET 280 UTILITY  
 CONSTRUCTION PLAN SHEET UC-14 FOR LOCATION OF  
 PROPOSED 12" WATERLINE. WHEN INSTALLING CURVED  
 GRADRAIL RIGHT OF STA. 138+20 -L- PLACE GUARDRAIL  
 POST TO AVOID IMPACTING PROPOSED 12" WATERLINE.

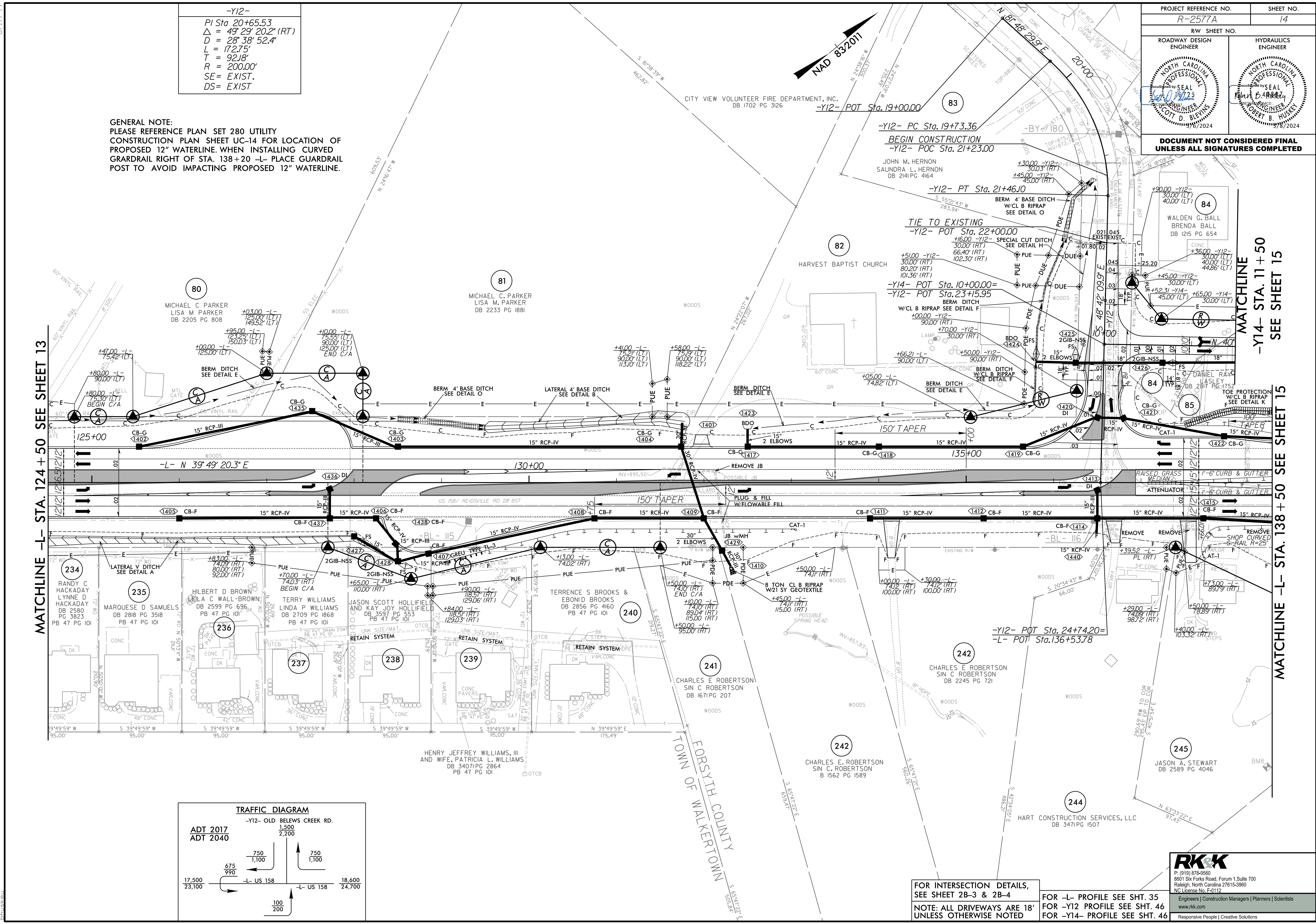

MATCHLINE -L- STA. 124 + 50 SEE SHEET 13

MATCHLINE -L- STA. 138 + 50 SEE SHEET 15

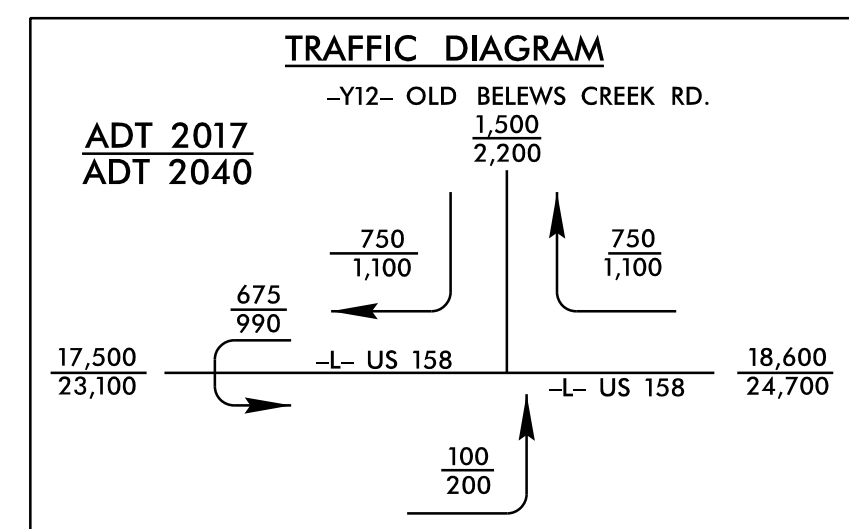

FOR INTERSECTION DETAILS,  
 SEE SHEET 2B-3 & 2B-4  
 NOTE: ALL DRIVEWAYS ARE 18'  
 UNLESS OTHERWISE NOTED

FOR -L- PROFILE SEE SHT. 35  
 FOR -Y12 PROFILE SEE SHT. 46  
 FOR -Y14- PROFILE SEE SHT. 46

**RKK**  
 P: (919) 878-9560  
 8601 Six Forks Road, Forum 1, Suite 700  
 Raleigh, North Carolina 27615-3960  
 NC License No. F-0112  
 Engineers | Construction Managers | Planners | Scientists  
 www.rkk.com  
 Responsive People | Creative Solutions

R:\2024\Projects\N\2577A\_r.dwg, psh14.dgn  
 8/17/2024