

CONTRACT: C204930 TIP PROJECT: HI-0016

STRUCTURES

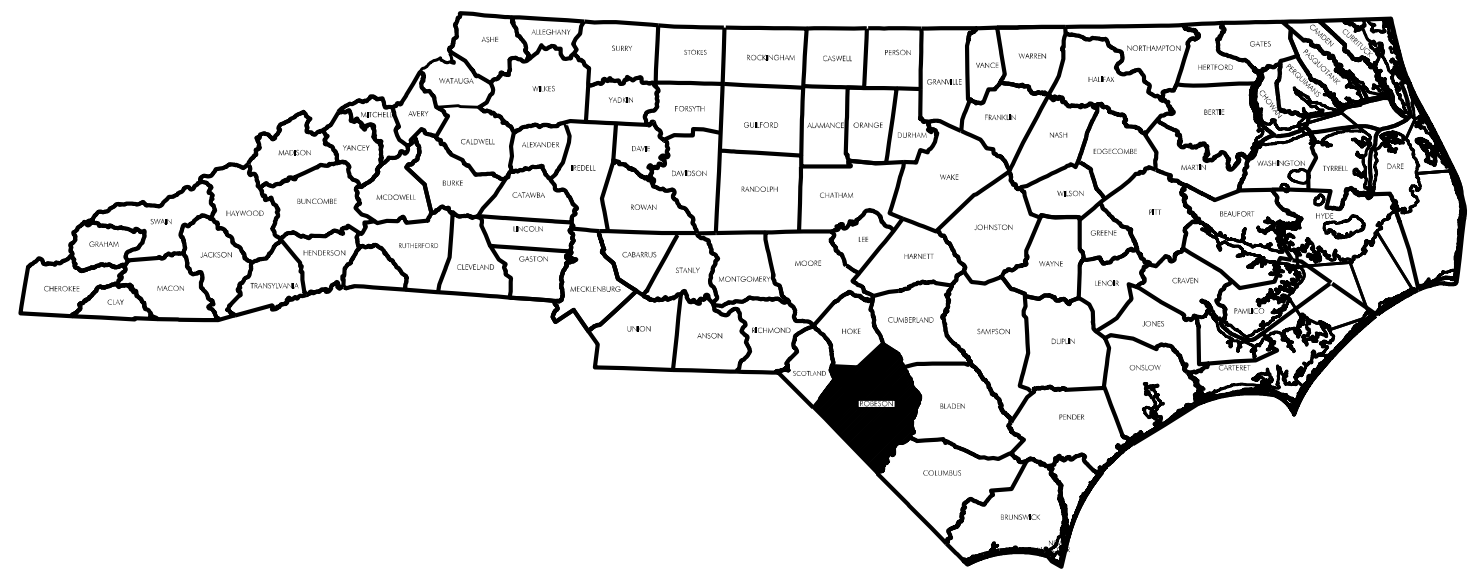

**STATE OF NORTH CAROLINA
DIVISION OF HIGHWAYS
ROBESON COUNTY**

STATE	STATE PROJECT REFERENCE NO.	SHEET NO.	TOTAL SHEETS
N.C.	HI-0016	1	
STATE PROJECT NO.	F.A. PROJ. NO.	DESCRIPTION	
49987.1.1	0074244	PE	
49987.3.1	0074244	CONSTR.	

LOCATION: BRIDGE #770110 ON US 74 WBL/NC 130 WBL OVER LUMBER RIVER OVERFLOW
 BRIDGE #770465 ON US 74 EBL/NC 130 EBL OVER LUMBER RIVER OVERFLOW
 BRIDGE #770118 ON US 74 WBL/NC 130 WBL OVER LUMBER RIVER
 BRIDGE #770466 ON US 74 EBL/NC 130 EBL OVER LUMBER RIVER
 BRIDGE #770490 ON SR 2210 OVER US 74
 BRIDGE #770512 ON SR 2220 OVER US 74

TYPE OF WORK: BRIDGE PRESERVATION - SHOTBLASTING, SILANE DECK TREATMENT & SILANE BARRIER
 RAIL TREATMENT, RECONSTRUCTION OF BRIDGE JOINTS AND SEALS

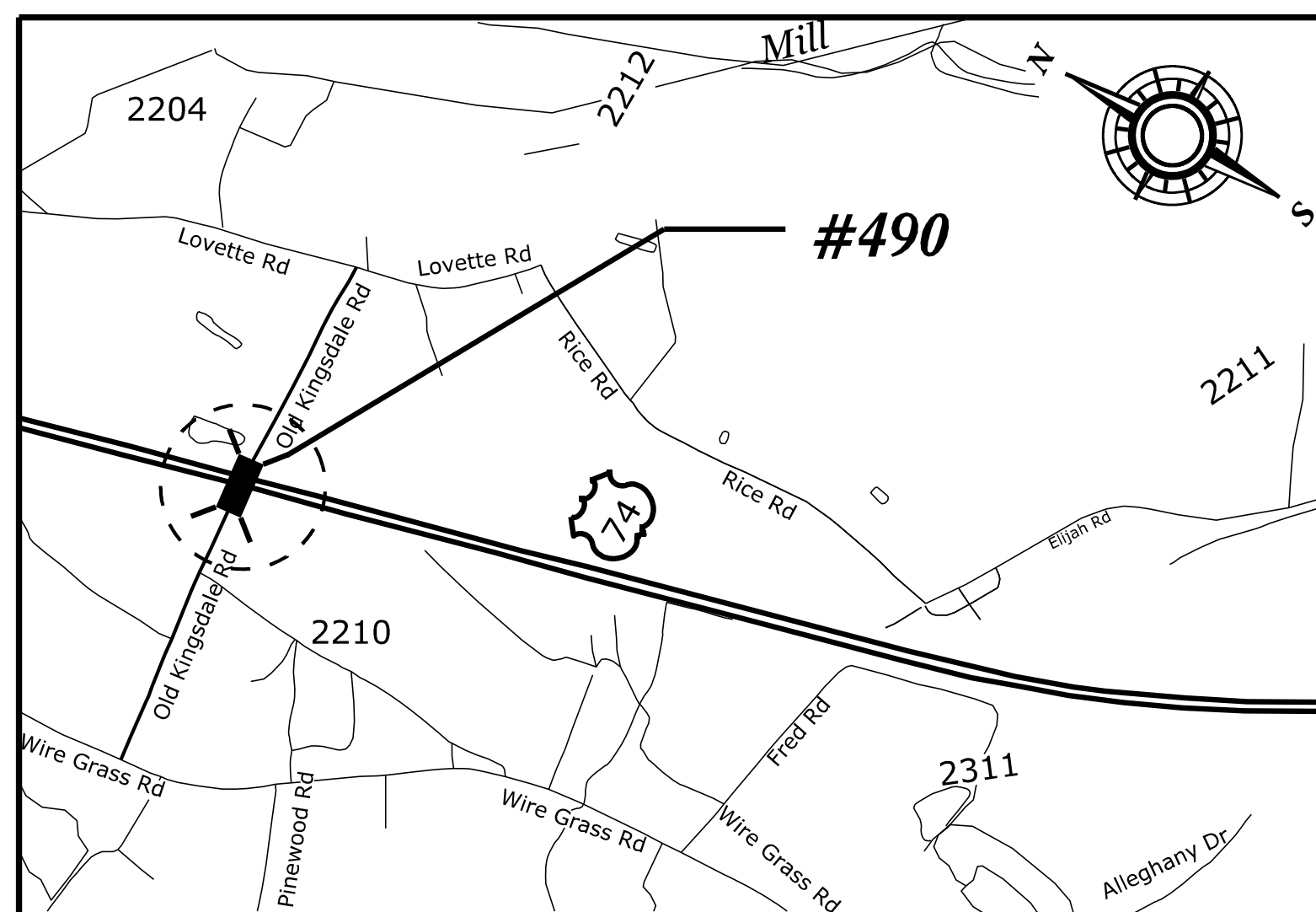

BRIDGE #770490

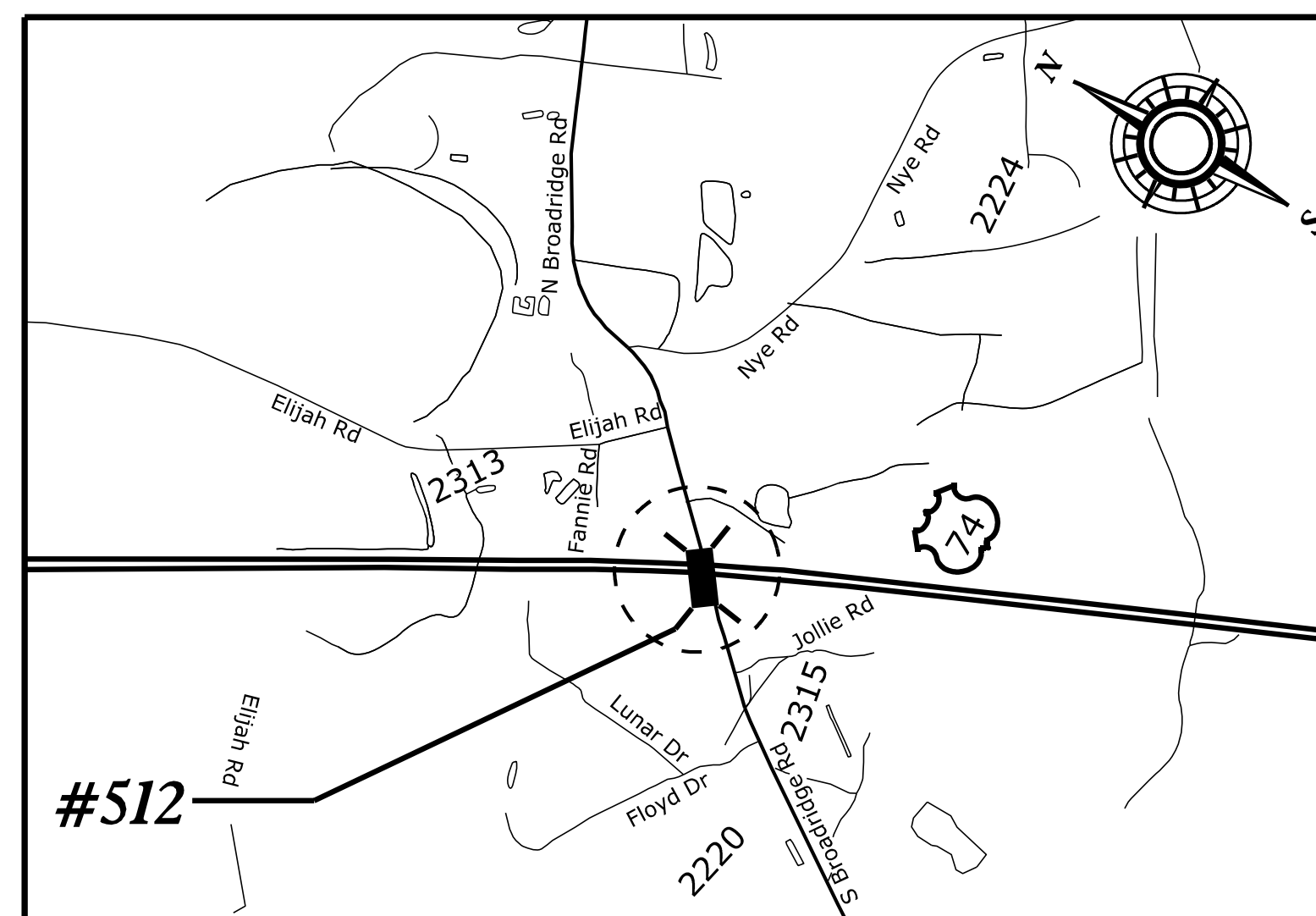

BRIDGE #770512

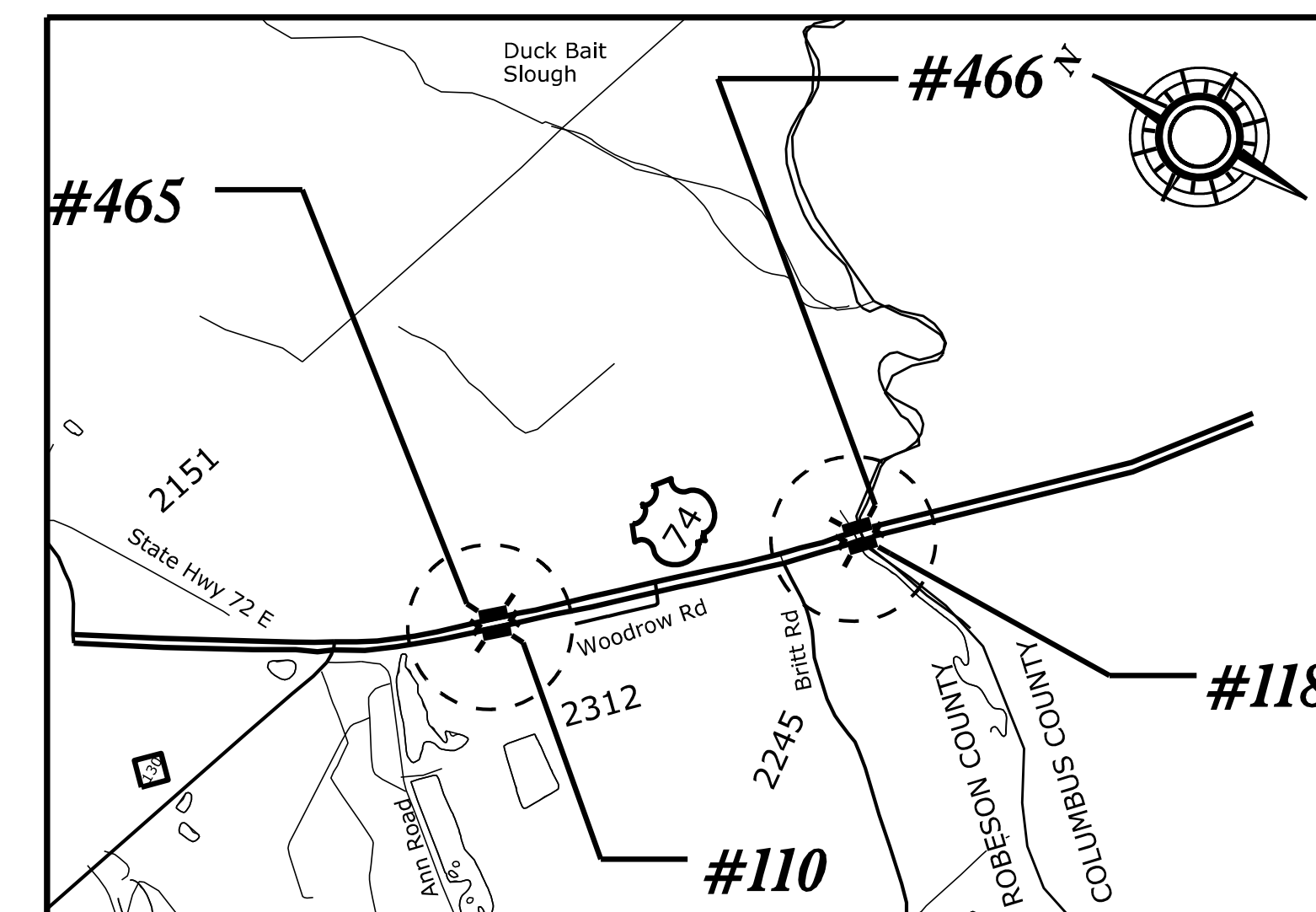

**BRIDGE #770110
BRIDGE #770465
BRIDGE #770118
BRIDGE #770466**

VICINITY MAP

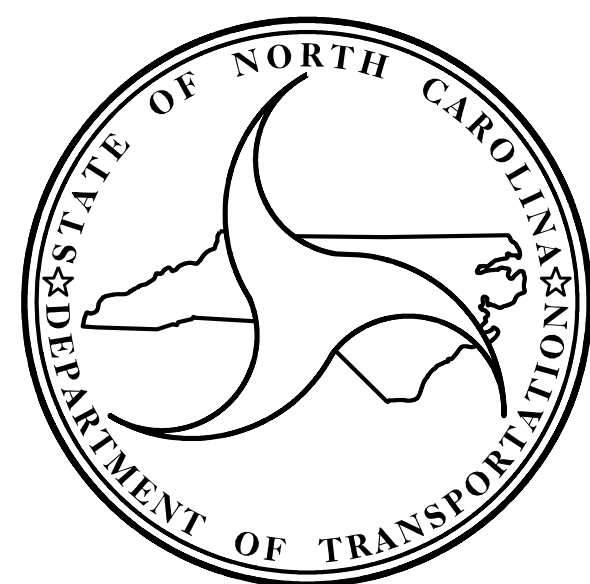

DESIGN DATA

BRIDGE #110 ADT 2019	=	9000
BRIDGE #465 ADT 2019	=	9000
BRIDGE #118 ADT 2019	=	9000
BRIDGE #466 ADT 2018	=	8000
BRIDGE #490 ADT 2016	=	1100
BRIDGE #512 ADT 2019	=	900

PROJECT LENGTH

PROJECT LENGTH #110	=	0.026 MI
PROJECT LENGTH #465	=	0.026 MI
PROJECT LENGTH #118	=	0.052 MI
PROJECT LENGTH #466	=	0.052 MI
PROJECT LENGTH #490	=	0.038 MI
PROJECT LENGTH #512	=	0.035 MI

NCDOT CONTACT: TIM SHERRILL, PE
PROJECT MANAGER

Prepared for:
STRUCTURES MANAGEMENT UNIT
NORTH CAROLINA DEPARTMENT OF TRANSPORTATION

2024 STANDARD SPECIFICATIONS

LETTING DATE:
MAY 28, 2024

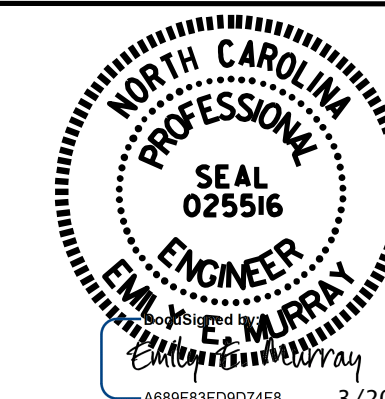

EMILY MURRAY, PE
PROJECT ENGINEER

VOLKERT
5430 Wade Park Boulevard, Suite 410
Raleigh, NC 27607
Tel. 919-854-0344 Fax. 919-854-0355
NC License No. F-0765