

8/17/99

PROJECT REFERENCE NO. BR-0069	SHEET NO. 4
RW SHEET NO.	
ROADWAY DESIGN ENGINEER SEAL 023912 3/11/2024	HYDRAULICS ENGINEER SEAL 049969 3/11/2024
DOCUMENT NOT CONSIDERED FINAL UNLESS ALL SIGNATURES COMPLETED	
moffatt & nichol	

-L-

PI Sta 12+56.59 Δ = 10° 28' 18.0" (RT) D = 2' 02' 46.6" L = 511.74' T = 256.59' R = 2,800.00' DS = 60 MPH Runoff = 144' SE = 06	PI Sta 15+96.91 Δ = 1° 46' 27.7" (RT) D = 1' 02' 30.3" L = 170.33' T = 85.17' R = 5,500.00' DS = 60 MPH Runoff = 72' SE = 03
---	--

W. MAYNARD GREGORY REVOCABLE TRUST
OF 2014 DATED JANUARY 16, 2014
DB 636 PG 650

KEVIN F. WAEGERLE
DAWN C. WAEGERLE
DB 456 PG 95
PB 9 PG 349

MARIA M. PASCHAL
DB 404 PG 890
PB 13 PG 63

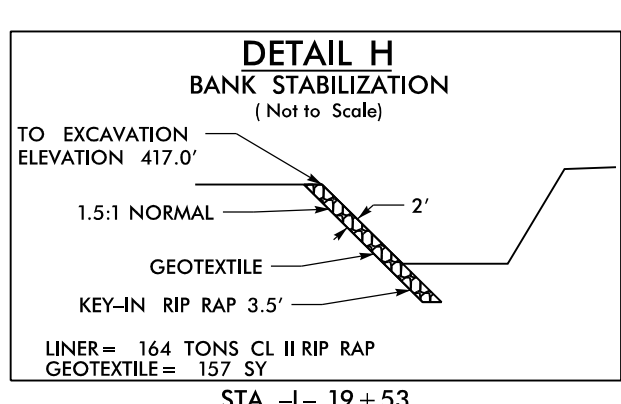
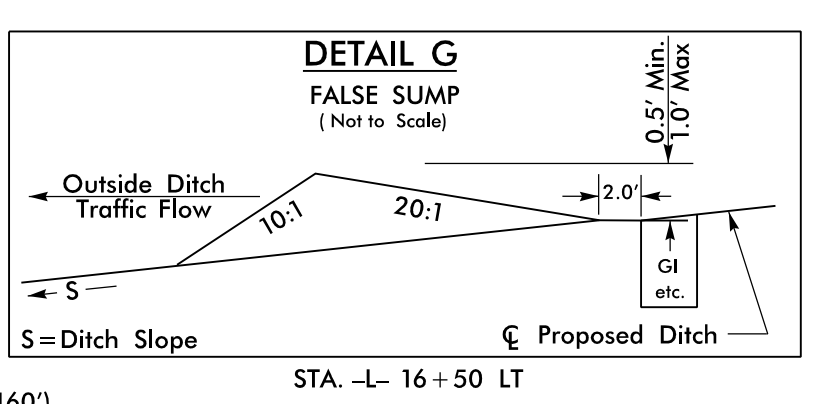
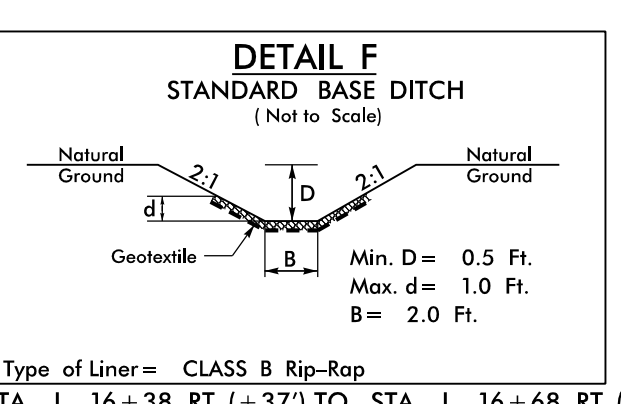
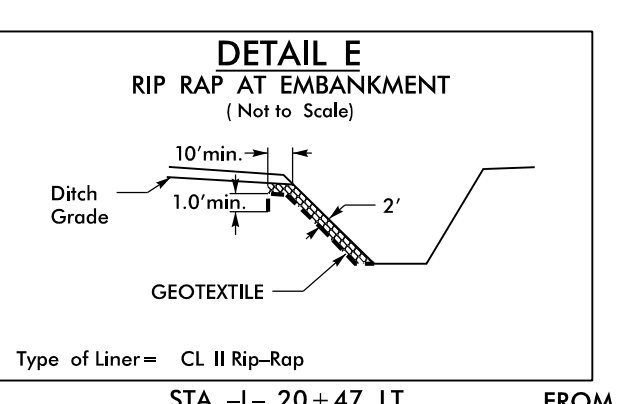
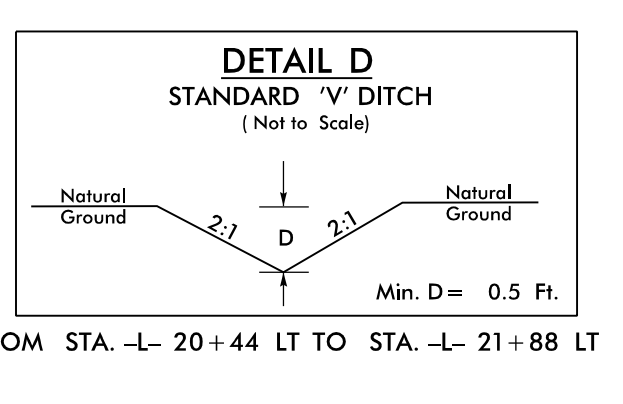
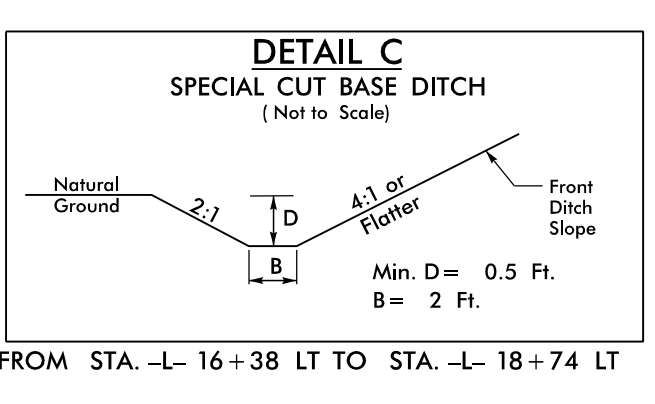
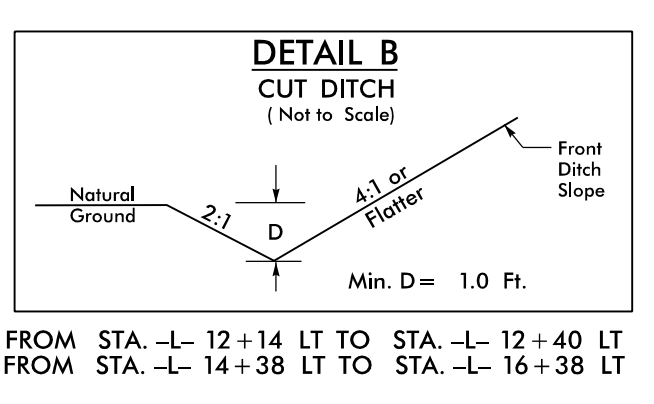
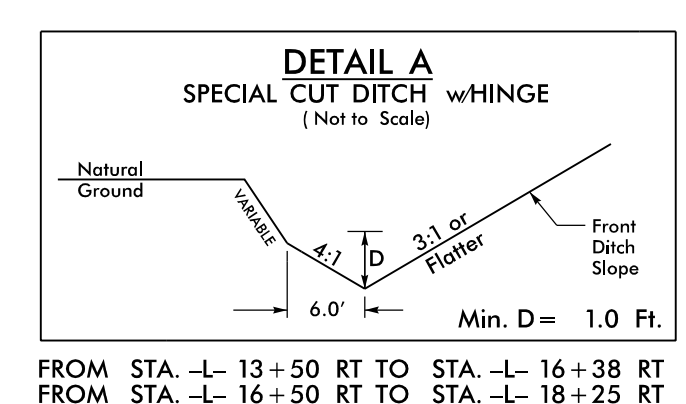
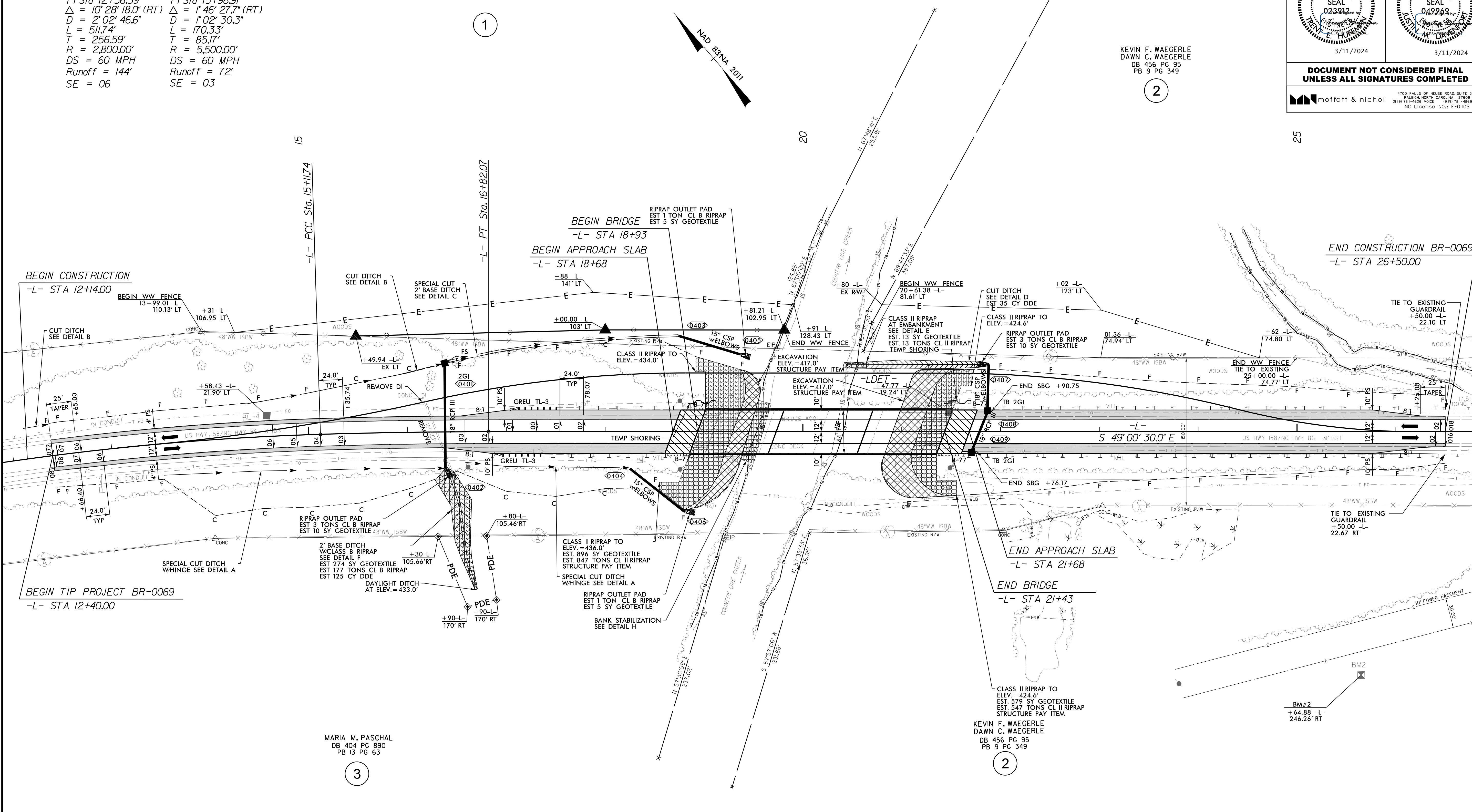

FOR -L- PROFILE, SEE SHEET NO. 5

1/29/2024 6:39:10 PM \\RA10011-1091\BFR-0069\Roadway\Proj\BFR-0069\rdj\PSH04.dgn