

RETAINING WALL NO. 1

THE WALL ENVELOPE DOES NOT ACCURATELY DEPICT THE ACTUAL FACE OF THE WALL AT THE FOLLOWING LOCATION:
 -L- STA. 28+75.00 TO -L- STA. 29+00.00, LT
 -L- STA. 31+40.00 TO -L- STA. 31+50.00, LT

GEOTECHNICAL ENGINEER

ENGINEER

SEAL 041986

D. Matthew Brewer

11/21/23

DATE

SIGNATURE

DATE

DOCUMENT NOT CONSIDERED FINAL UNLESS ALL SIGNATURES COMPLETED

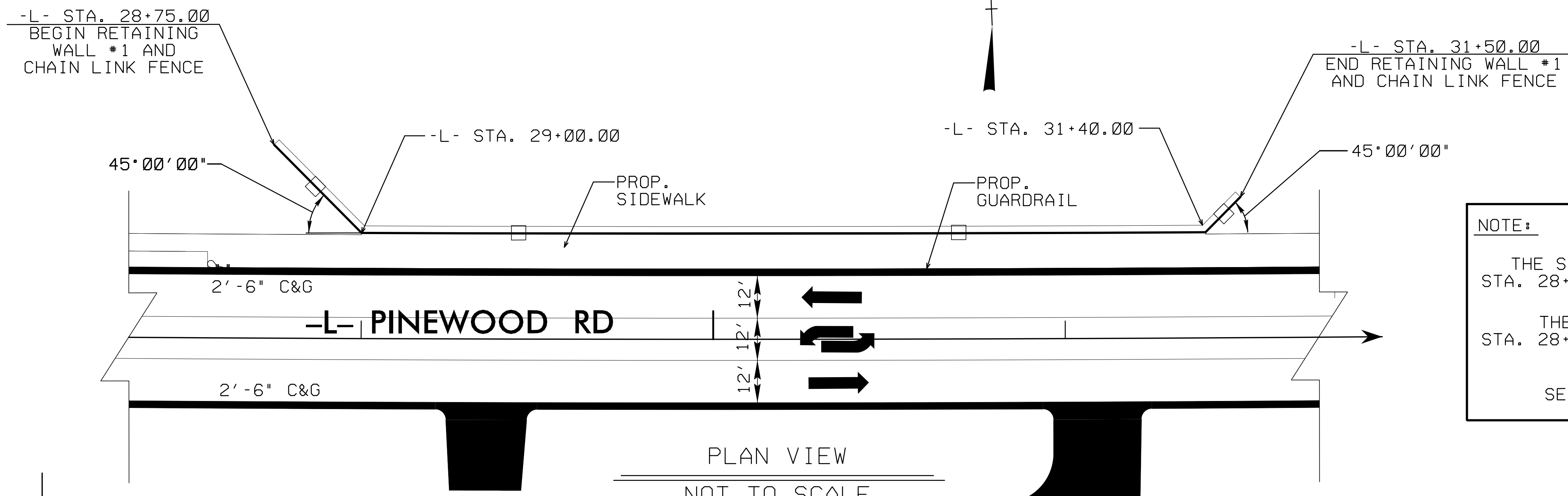

NOTE:

THE SOIL NAIL WALL LIMITS ARE FROM STA. 28+75.00 -L- TO STA. 31+50.00 -L-.

THE SMSE WALL LIMITS ARE FROM STA. 28+75.00 -L- TO STA. 31+50.00 -L-.

SEE SHEET 2 OF 5 FOR DETAILS

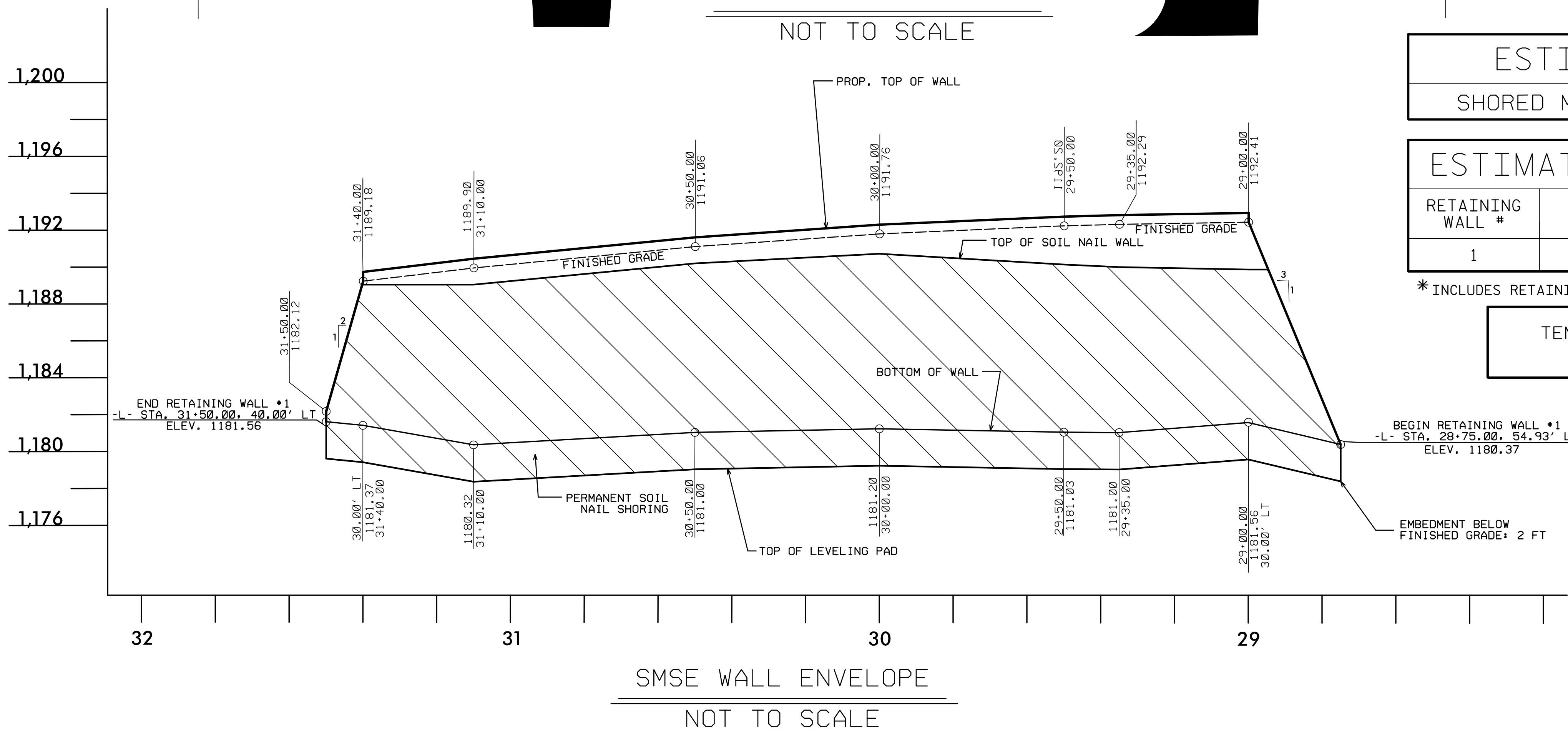

ESTIMATED SMSE WALL QUANTITIES	
SHORED MSE RETAINING WALL NO. 1	3,320 SQ. FT.

ESTIMATED SOIL NAIL WALL QUANTITIES			
RETAINING WALL #	PERMANENT SOIL NAIL RETAINING WALLS (SQUARE FEET)	SOIL NAIL VERIFICATION TESTS	SOIL NAIL PROOF TESTS
1	2,900*	2	8

* INCLUDES RETAINING WALL EMBEDMENT

TEMPORARY SOIL NAIL SHORING 825 SQ. FT. (IF REQUIRED)

PROJECT NO.: U-6036

CALDWELL COUNTY

RETAINING WALL NO. 1 STATION: -L-28+75, LT TO 31+50, LT

SHEET 1 OF 5

Prepared in the Office of:

CGE CAROLINAS GEOTECHNICAL GROUP

2400 CROWNPOINT EXECUTIVE DRIVE SUITE 800 CHARLOTTE, NC 28227 (980) 339-8684

SHORED MECHANICALLY STABILIZED EARTH (SMSE) RETAINING WALL

REVISIONS					
NO.	BY	DATE	NO.	BY	DATE
1			3		
2			4		

SHEET NO. W-1

PREPARED BY: DMB DATE: 11/21/23

REVIEWED BY: REK DATE: 11/21/23