

STATE	STATE PROJECT REFERENCE NO.	SHEET NO.	TOTAL SHEETS
N.C.	U-5112	EC-1	
STATE PROJ. NO.	F. A. PROJ. NO.	DESCRIPTION	
42374.1.FD1	STPDA-1032(003)	PE	
42374.2.1	STPDA-1032(003)	ROW & UTIL	
42374.3.1	STPDA-1032(003)	CONST.	

STATE OF NORTH CAROLINA
DIVISION OF HIGHWAYS

PLAN FOR PROPOSED
HIGHWAY EROSION CONTROL

UNION COUNTY

LOCATION: POTTER ROAD FROM AZTECA DRIVE
TO OLD MONROE ROAD AND
PLEASANT PLAINS ROAD FROM EAST
OF AURORA BOULEVARD TO WEST OF
LAKEWOOD DRIVE

TYPE OF WORK: GRADING, DRAINAGE, PAVEMENT

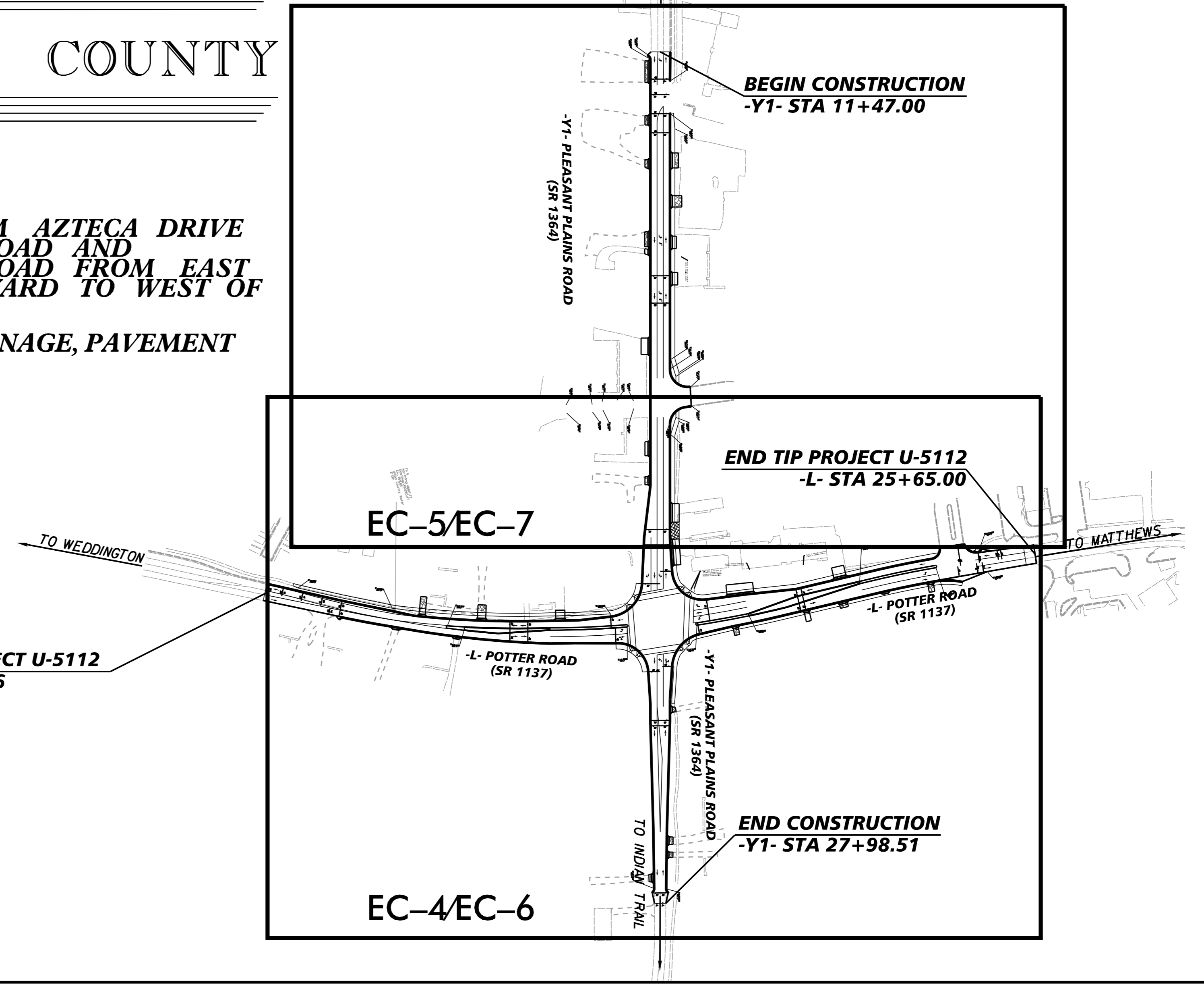
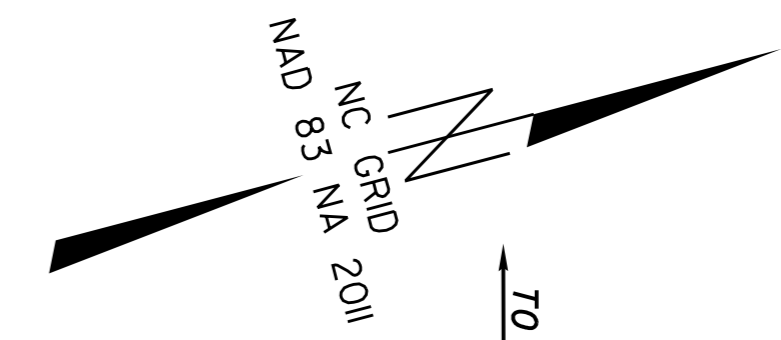

THIS PROJECT CONTAINS
EROSION CONTROL PLANS
FOR CLEARING AND
GRUBBING PHASE OF
CONSTRUCTION.

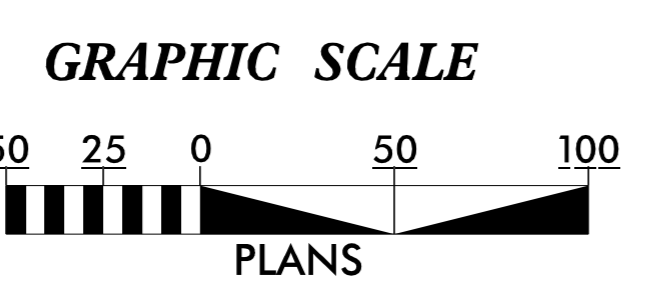

THESE EROSION AND SEDIMENT CONTROL PLANS COMPLY WITH
THE APPLICABLE REGULATIONS SET FORTH BY THE NCG-010000
GENERAL CONSTRUCTION PERMIT EFFECTIVE APRIL 1, 2019
AND ISSUED BY THE NORTH CAROLINA DEPARTMENT OF
ENVIRONMENTAL QUALITY DIVISION OF WATER RESOURCES.

Kimley»Horn ©2024

NC LICENSE #F-0102
200 SOUTH TRYON STREET, SUITE 200
CHARLOTTE, NORTH CAROLINA 28202
PHONE: (704) 333-6131

Prepared In the Office of:
KIMLEY HORN
200 SOUTH TRYON STREET, SUITE 200
CHARLOTTE, NORTH CAROLINA 28202

Designed by:
SPENCER GREEN, PE 4244
NAME LEVEL III CERTIFICATION NO.

Roadway Standard Drawings

The "Roadway Standard Drawings"- Roadway Design Unit - N. C. Department of Transportation - Raleigh, N. C., dated January 2024 and the latest revision thereto are applicable to this project and by reference hereby are considered a part of these plans.

TIP PROJECT: U-5112

K:\CHL_P\PRJ\01036720 - U-5112 (P3 Intersection)\Erosion Control\Design\U-5112_ec_1shdgn

1/12/2024

STATE OF NORTH CAROLINA
DIVISION OF HIGHWAYS

EROSION AND SEDIMENT CONTROL LEGEND

REVISIONS

<u>Std. #</u>	<u>Description</u>	<u>Symbol</u>
1605.01	Temporary Silt Fence	
1606.01	Special Sediment Control Fence	
1622.01	Temporary Berms and Slope Drains	
1630.02	Silt Basin Type B	
1630.03	Temporary Silt Ditch	
1630.04	Stilling Basin	
1630.05	Temporary Diversion	
1630.06	Temporary Rock Silt Check Type-A with Matting and Polyacrylamide (PAM)	
1630.07	Skimmer Basin	
1630.08	Tiered Skimmer Basin	
1630.09	Infiltration Basin	

Rock Inlet Sediment Trap:

1632.01	Type A	A
1632.02	Type B	B
1632.03	Type C	C
1633.01	Temporary Rock Silt Check Type-A	
1633.02	Temporary Rock Silt Check Type-B	
	Wattle / Coir Fiber Wattle	
	Wattle / Coir Fiber Wattle with Polyacrylamide (PAM)	
1634.01	Temporary Rock Sediment Dam Type-A	
1634.02	Temporary Rock Sediment Dam Type-B	
1635.01	Rock Pipe Inlet Sediment Trap Type-A	
1635.02	Rock Pipe Inlet Sediment Trap Type-B	

ONSITE CONCRETE WASHOUT STRUCTURE WITH LINER

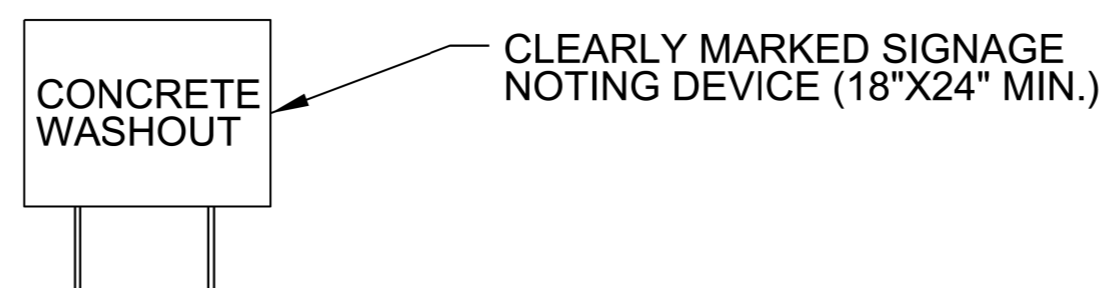
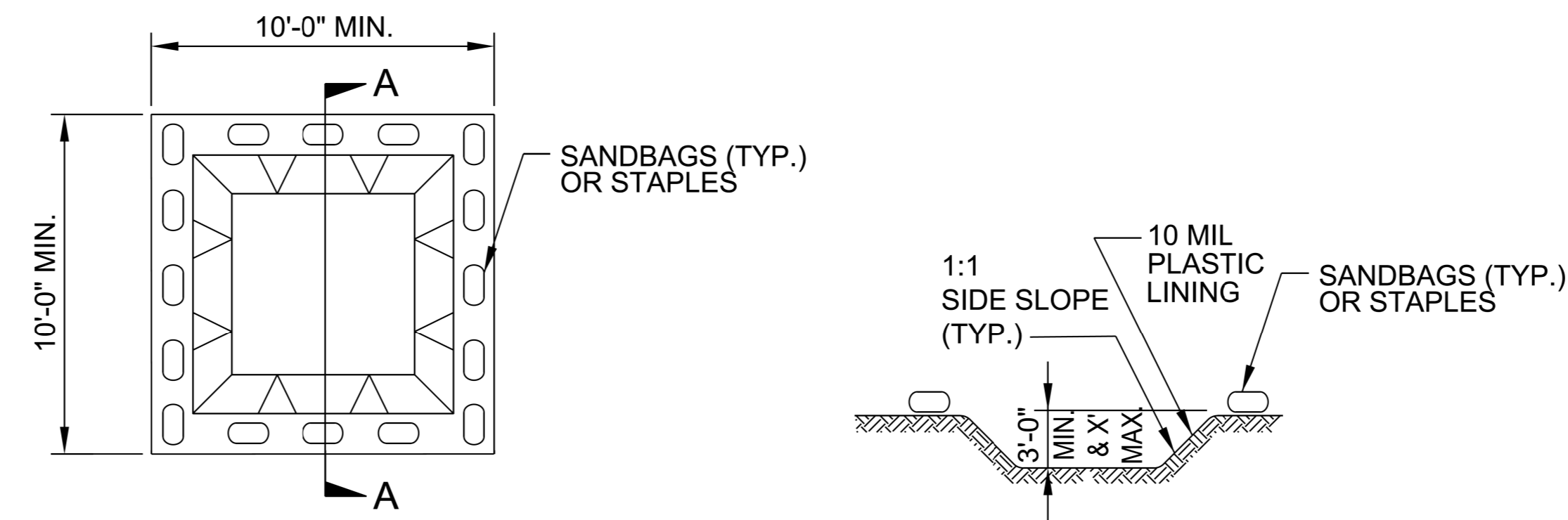

SECTION A-A

- NOTES:**
1. ACTUAL LOCATION DETERMINED IN FIELD
 2. THE CONCRETE WASHOUT STRUCTURES SHALL BE MAINTAINED WHEN THE LIQUID AND/OR SOLID REACHES 75% OF THE STRUCTURES CAPACITY.
 3. CONCRETE WASHOUT STRUCTURE NEEDS TO BE CLEARLY MARKED WITH SIGNAGE NOTING DEVICE.

PLAN

BELOW GRADE WASHOUT STRUCTURE

NOT TO SCALE

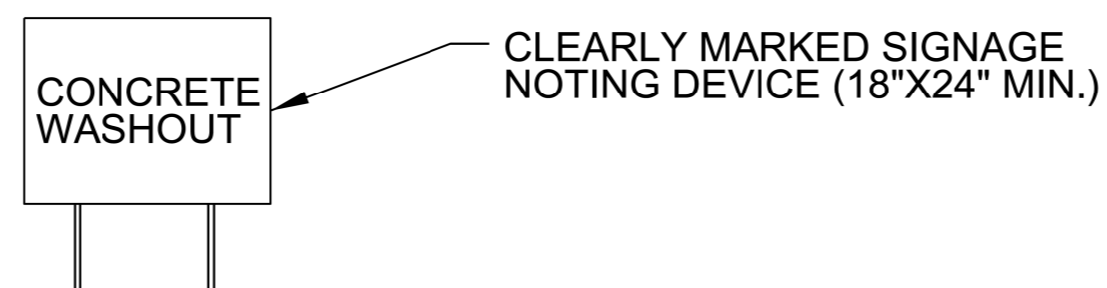
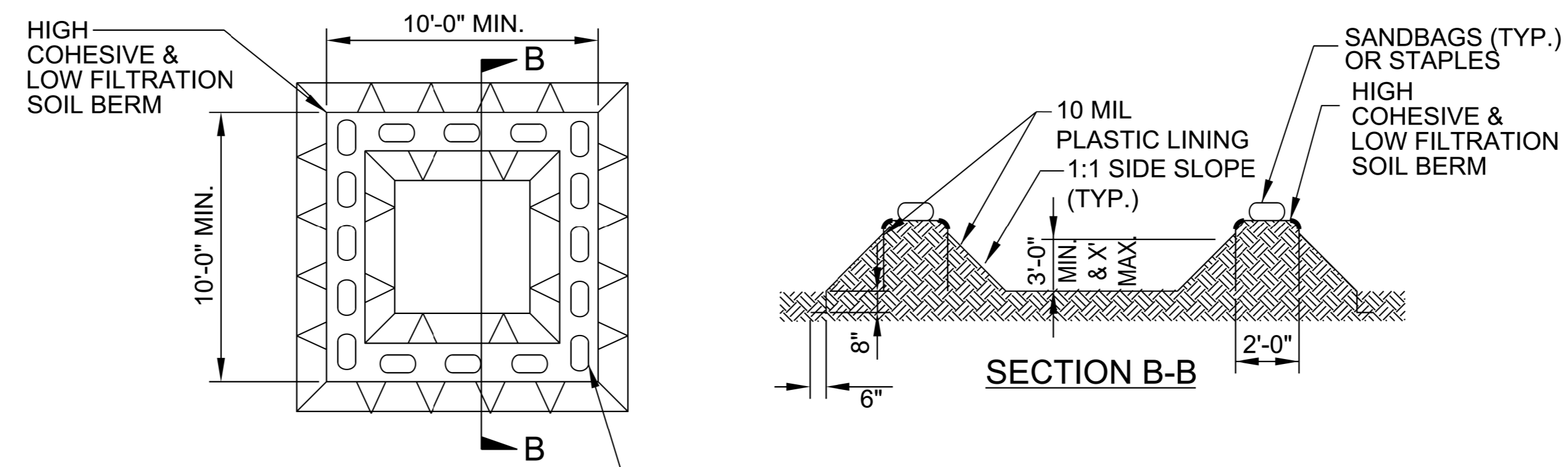

NOTES:

1. ACTUAL LOCATION DETERMINED IN FIELD
2. THE CONCRETE WASHOUT STRUCTURES SHALL BE MAINTAINED WHEN THE LIQUID AND/OR SOLID REACHES 75% OF THE STRUCTURES CAPACITY TO PROVIDE ADEQUATE HOLDING CAPACITY WITH A MINIMUM 12 INCHES OF FREEBOARD.
3. CONCRETE WASHOUT STRUCTURE NEEDS TO BE CLEARLY MARKED WITH SIGNAGE NOTING DEVICE.

PLAN

ABOVE GRADE WASHOUT STRUCTURE

NOT TO SCALE

DIVISION OF HIGHWAYS
STATE OF NORTH CAROLINA

Kimley»Horn <small>© 2024</small>
<small>200 S. TRYON ST. • CHARLOTTE, NC 28202</small>
<small>RIGHT-OF-WAY REV.</small>
<small>CONST. REV.</small>

<small>PROJECT REFERENCE NO.</small>	<small>SHEET NO.</small>
<i>U-5112</i>	<i>EC-3A</i>

SOIL STABILIZATION TIMEFRAMES

REVISIONS

<i>SITE DESCRIPTION</i>	<i>STABILIZATION TIME</i>	<i>TIMEFRAME EXCEPTIONS</i>
PERIMETER DIKES, SWALES, DITCHES AND SLOPES	7 DAYS	NONE
HIGH QUALITY WATER (HQW) ZONES	7 DAYS	NONE
SLOPES STEEPER THAN 3:1	7 DAYS	IF SLOPES ARE 10' OR LESS IN LENGTH AND ARE NOT STEEPER THAN 2:1, 14 DAYS ARE ALLOWED.
SLOPES 3:1 OR FLATTER	14 DAYS	7 DAYS FOR SLOPES GREATER THAN 50' IN LENGTH.
ALL OTHER AREAS WITH SLOPES FLATTER THAN 4:1	14 DAYS	NONE, EXCEPT FOR PERIMETERS AND HQW ZONES.

1/12/2024 K:\CHL_PRR\01036720 - U-5112 (P3 Intersection)\Erosion Control\Design\U-5112.ec_pst_02&03.dgn

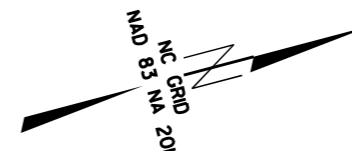

MATCHLINE -Y1- STA 19+80 (SEE SHEET EC-5/CONST.7)

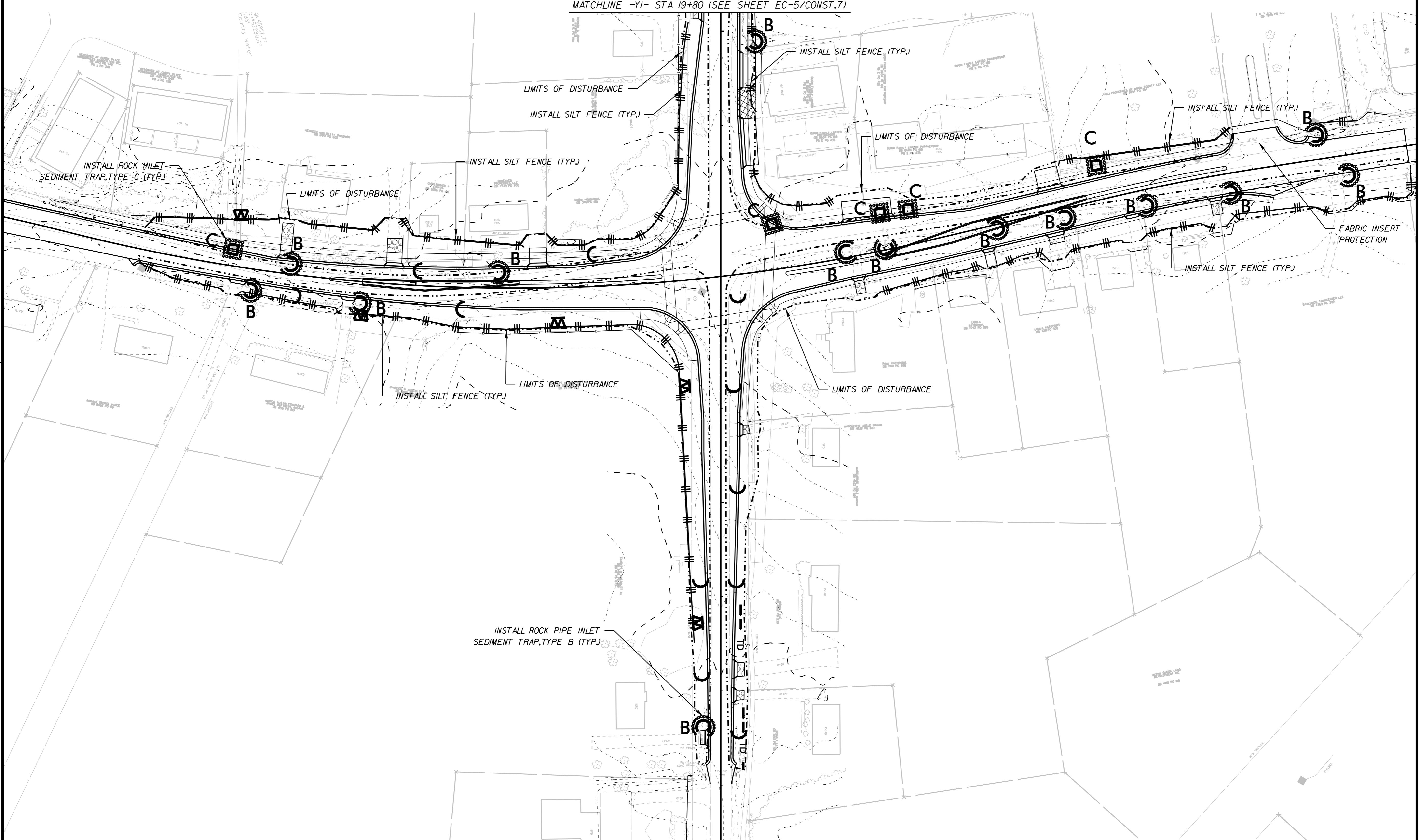

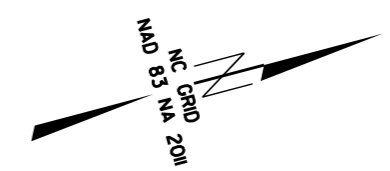

REVISIONS

1/12/2024 K:\CHL_P\01036720 - U-5112 (P3 Intersection)\Erosion Control\Design\U-5112.ec_pst_5.dgn

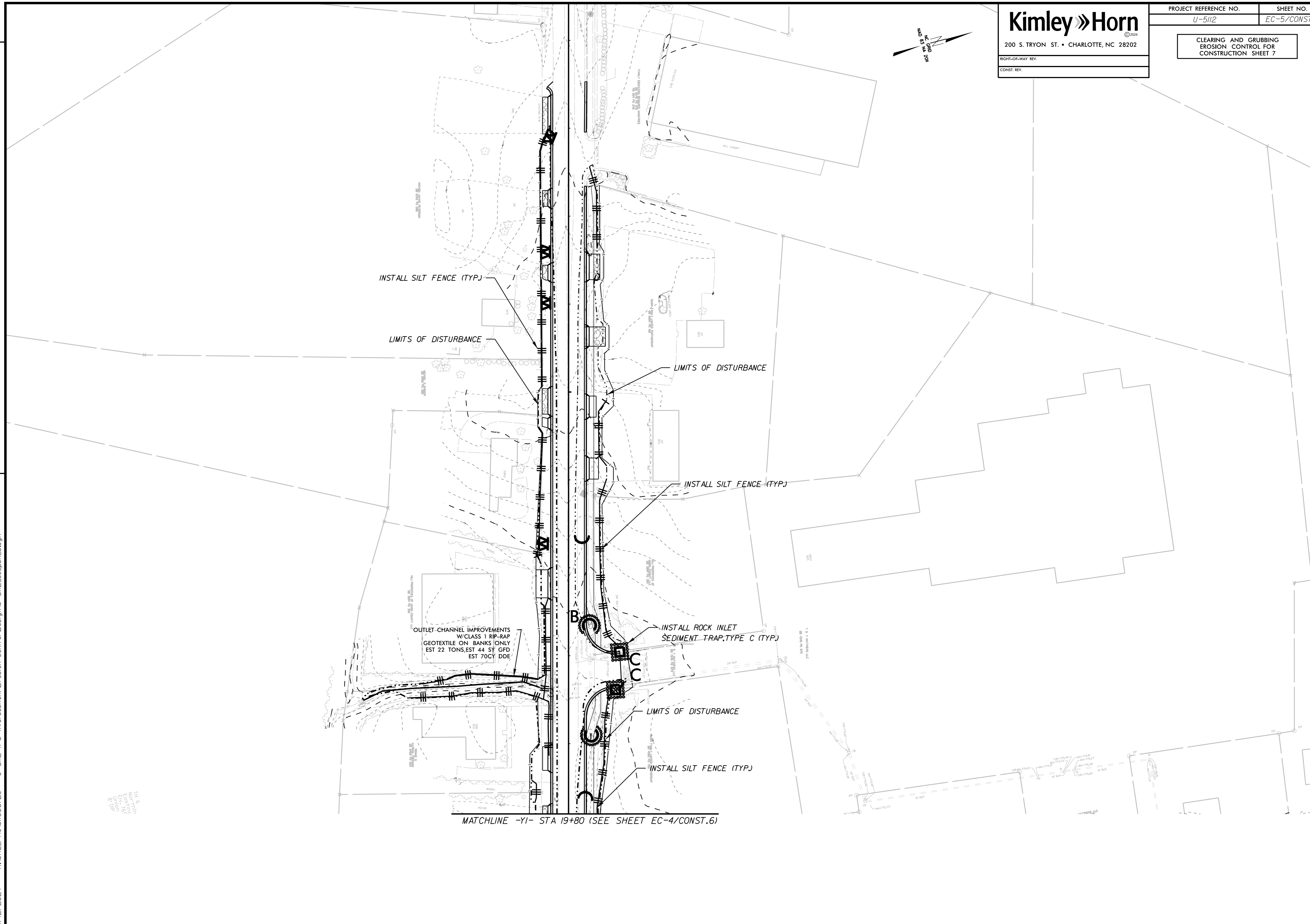

MATCHLINE -Y1- STA 19+80 (SEE SHEET EC-4/CONST.6)

11/8/24
North
Arrow
Scale
1" = 50'
11/8/24

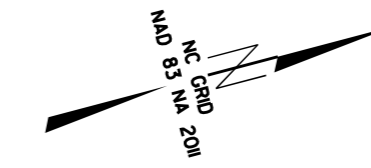

MATCHLINE -Y1- STA 19+80 (SEE SHEET EC-7/CONST.7)

REVISIONS

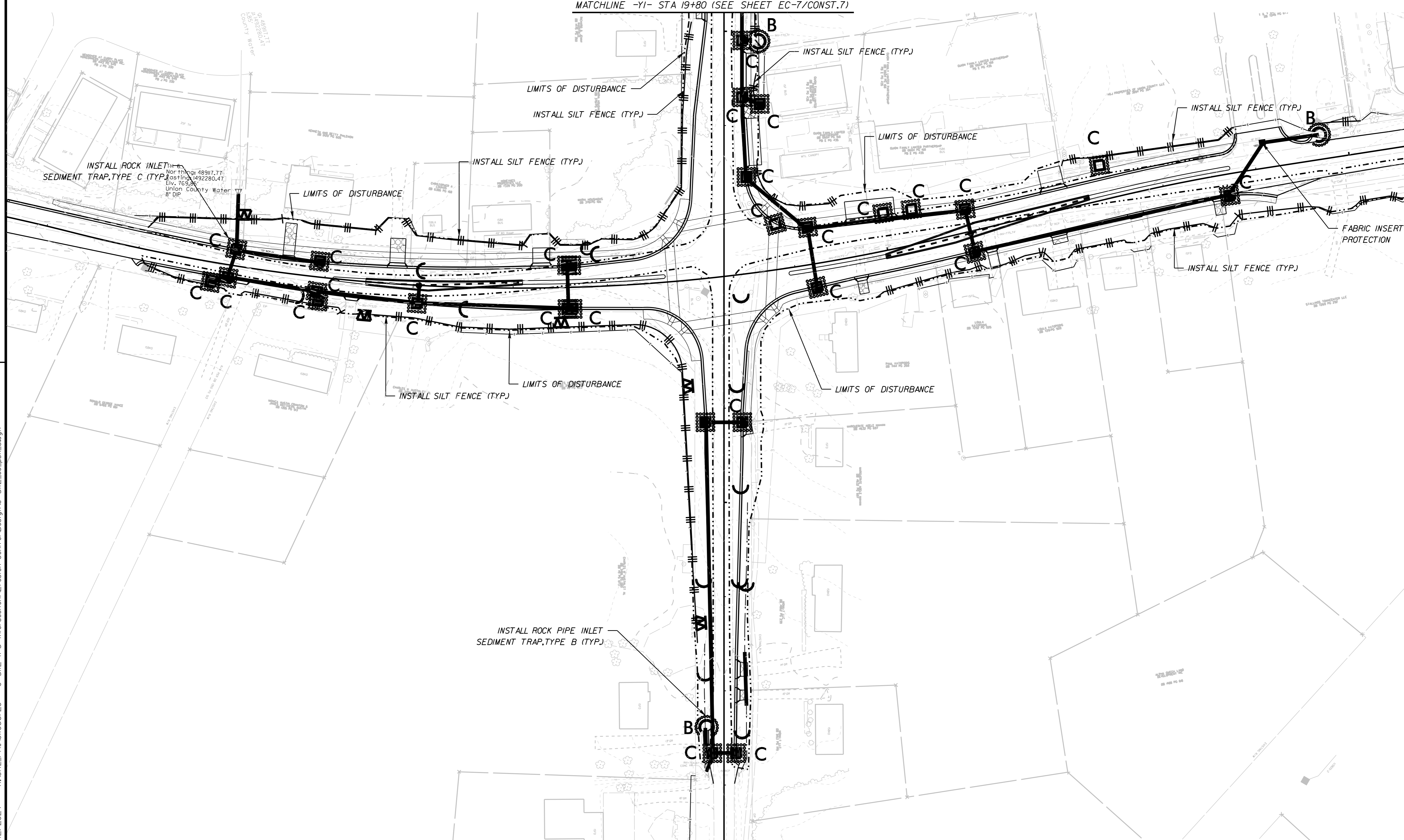

1/12/2024 K:\CHL_P\01036720 - U-5112 (P3 Intersection)\Erosion Control\Design\U-5112.ec_pst_6.dgn

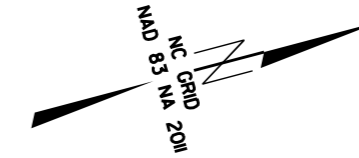

REVISIONS

1/12/2024 K:\CHL_P\01036720 - U-5112 (P3 Intersection)\Erosion Control\Design\U-5112.ec_psh_7.dgn

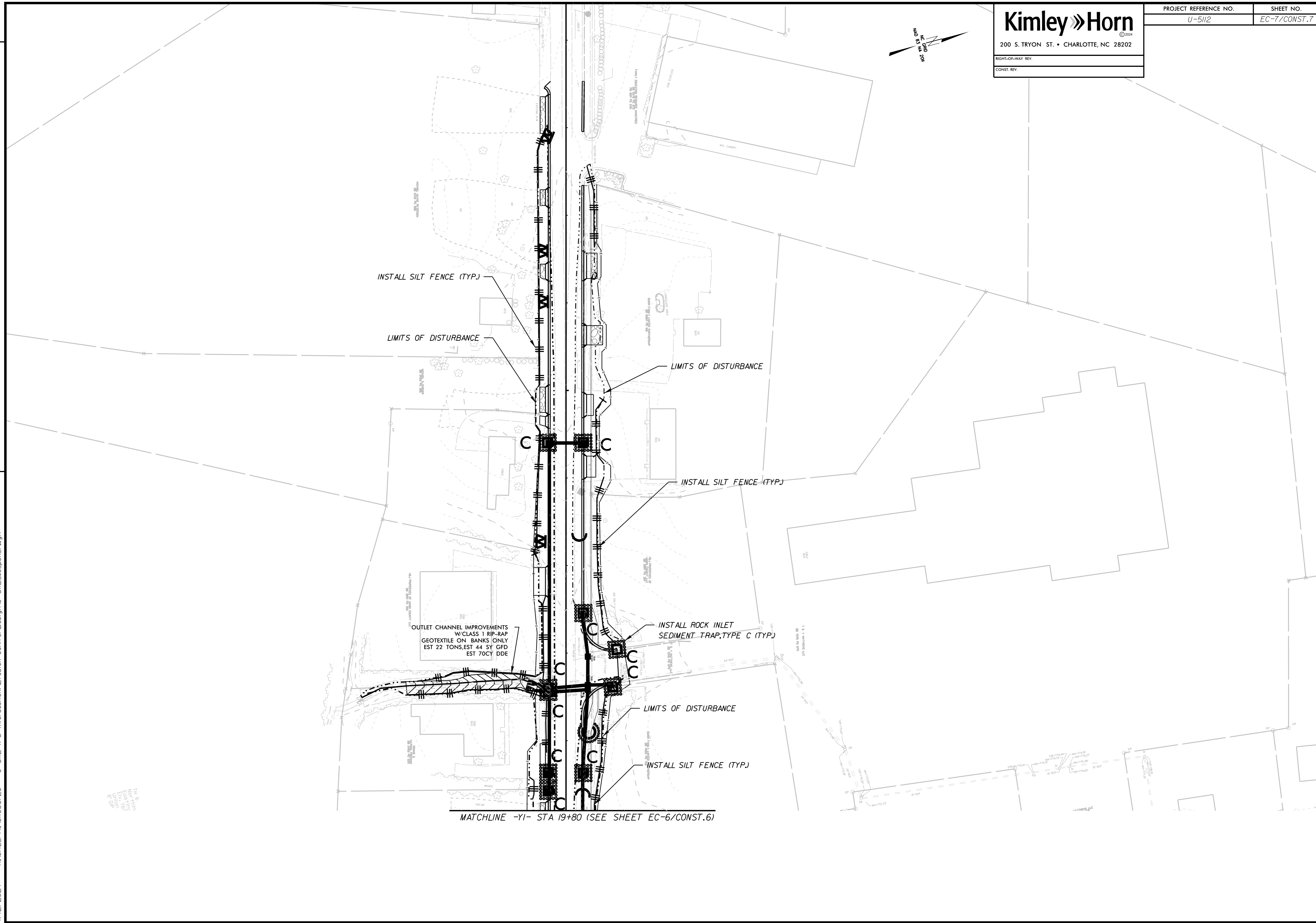

MATCHLINE -Y1- STA 19+80 (SEE SHEET EC-6/CONST.6)

T16
North
Arrow
Scale
1" = 40'
Date
1/12/24