

TIP PROJECT: U-5112

CONTRACT: C204822

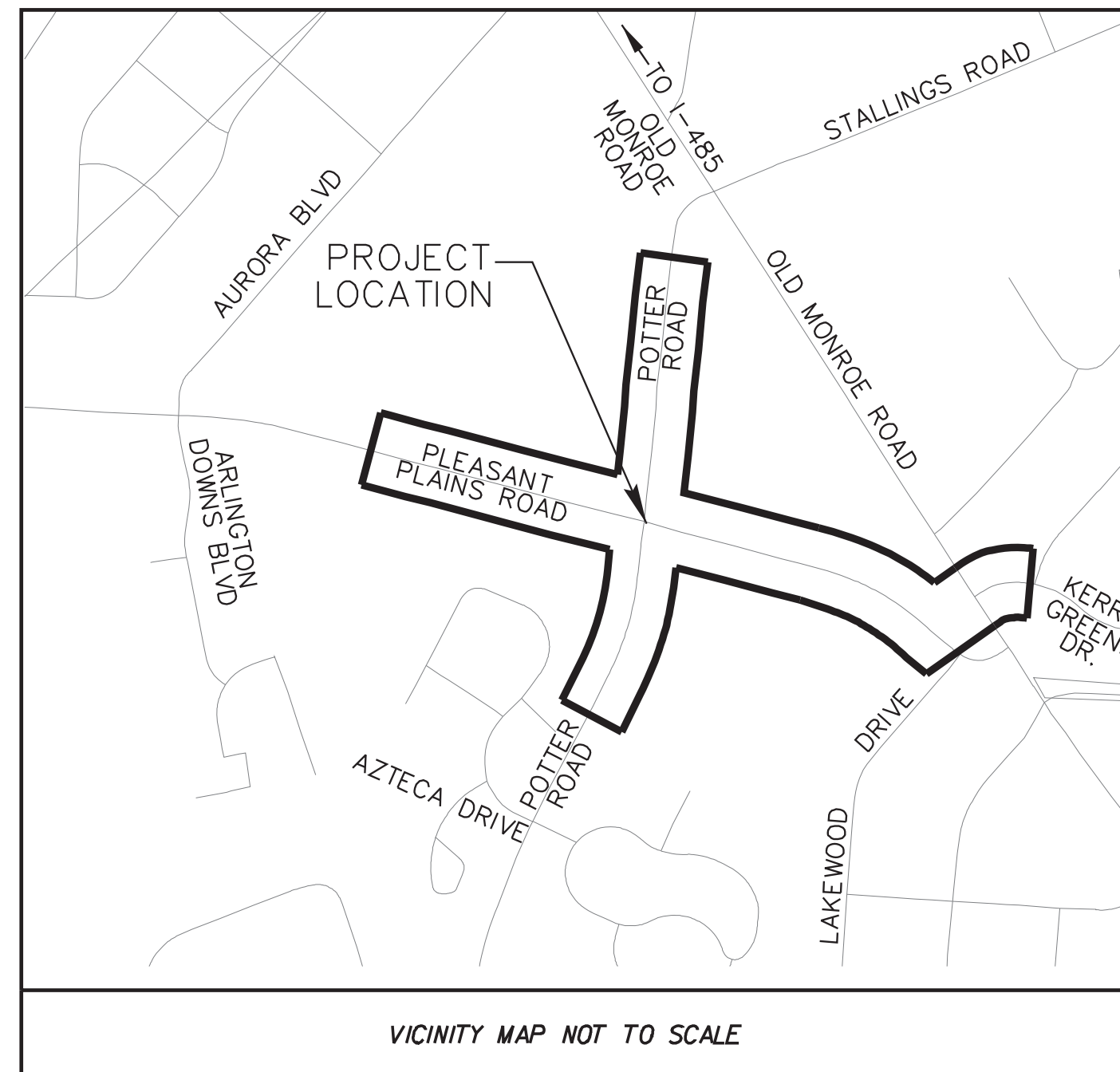

NCDOT CONTACT:
 YANWEI MA, PE
 DIVISION 10, DISTRICT 3
 716 W. MAIN STREET
 ALBEMARLE, NC 28001
 (704) 983-4400

ENGINEER:
 FRANK MASTERSON, PE
 PROJECT MANAGER
 200 SOUTH TRYON ST.
 SUITE 200
 CHARLOTTE, NC 28202
 (704) 333-5131

SURVEYOR:
 JUSTIN CLONIGER, PLS
 420 HAWTHORNE LN
 CHARLOTTE, NC 28204
 (704) 376-2186 EXT 104

UNION COUNTY WATER CONTACT:
 MICHAEL CALDWELL
 PROJECT MANAGER
 500 N. MAIN STREET
 SUITE 600
 MONROE, NC 28112
 (704) 296-4293

STATE OF NORTH CAROLINA
 DIVISION OF HIGHWAYS

UNION COUNTY

**LOCATION: POTTER ROAD FROM AZTECA DRIVE TO OLD MONROE ROAD
 AND PLEASANT PLAINS ROAD FROM EAST OF AURORA BOULEVARD
 TO WEST OF LAKEWOOD DRIVE**

TYPE OF WORK: WATER, SEWER

100% Utility Plans

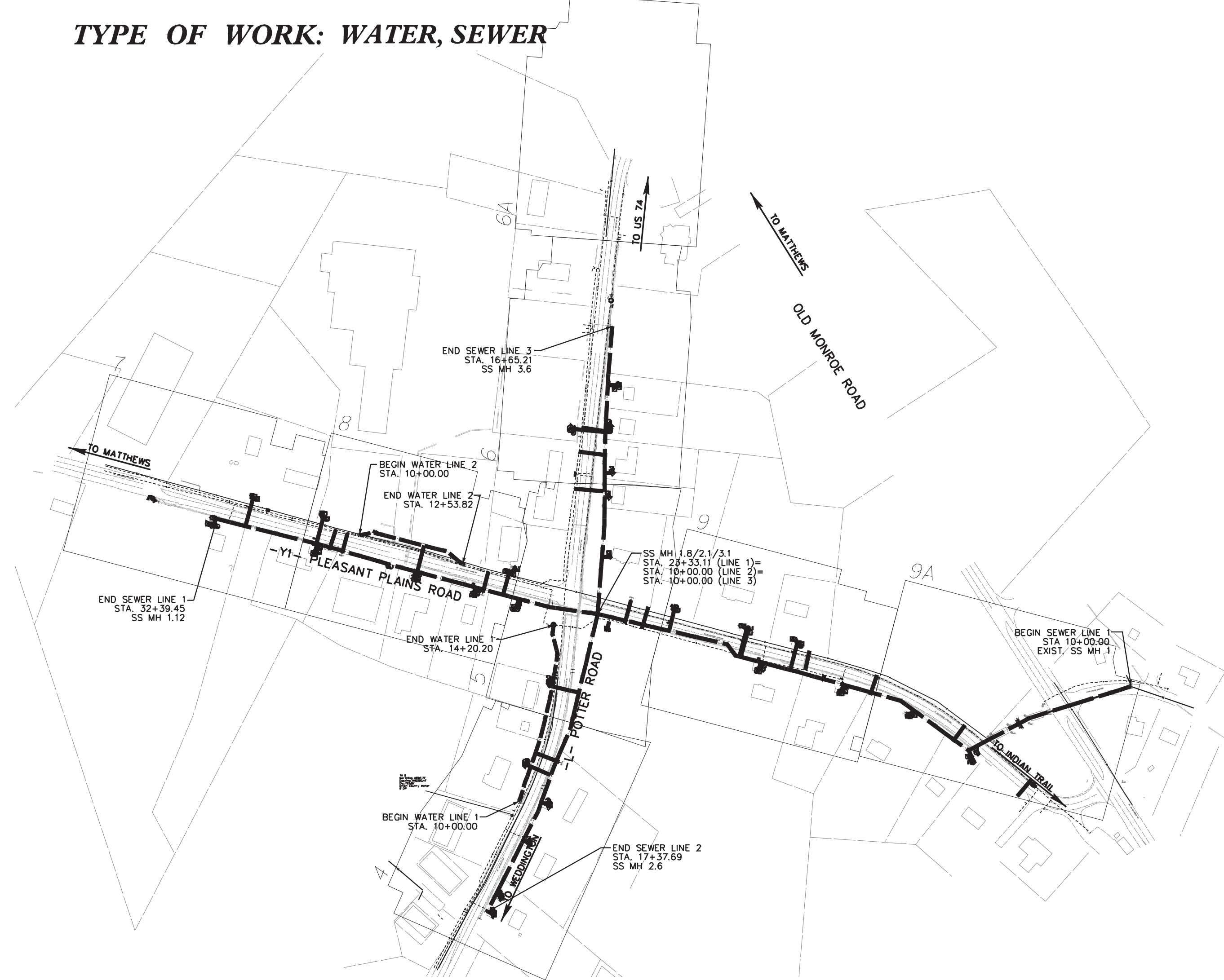

STATE	STATE PROJECT REFERENCE NO.	SHEET NO.	TOTAL SHEETS
N.C.	U-5112	1	14
STATE PROJ. NO.	F. A. PROJ. NO.	DESCRIPTION	
42374.2.1	STPDA-1032(3)	R/W	
42374.3.1	STPDA-1032(3)	CONST	

**DOCUMENT NOT CONSIDERED FINAL
 UNLESS ALL SIGNATURES COMPLETED**

PERMIT PLANS

**DOCUMENT NOT CONSIDERED FINAL
 UNLESS ALL SIGNATURES COMPLETED**

GRAPHIC SCALES

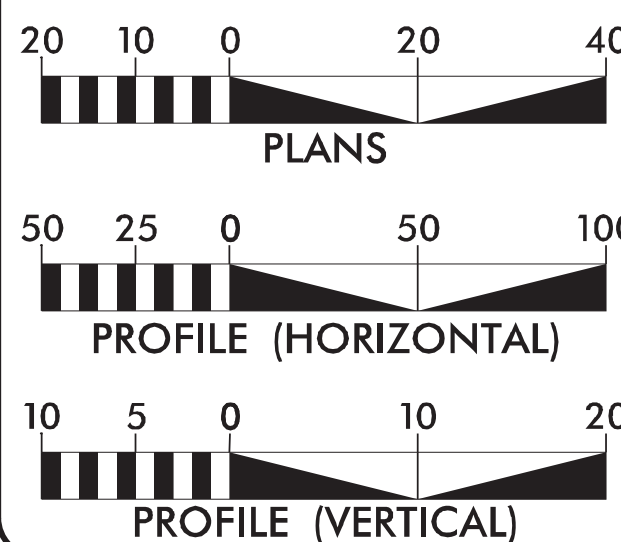

INDEX

SHEET NO.:	DESCRIPTION:
UC-1	TITLE SHEET
UC-2	GENERAL NOTES
UC-3A THRU UC-3D	WATER & SEWER DETAILS
UC-4 THRU UC-9A	WATER & SEWER UTILITY SHEETS - PLAN
UC-10 THRU UC-14	WATER & SEWER UTILITY SHEETS - PROFILES

PROJECT LENGTH

12" WATER LINE: 254 LF
 8" WATER LINE: 421 LF
 8" SANITARY SEWER: 3,643 LF

UTILITY OWNERS

WATER - UNION COUNTY WATER
 SEWER - UNION COUNTY WATER

**PLANS PREPARED FOR
 THE NCDOT BY:**

Kimley»Horn
NC LICENSE #P-0102
 200 SOUTH TRYON STREET, SUITE 200
 CHARLOTTE, NORTH CAROLINA 28202
 PHONE: (704) 333-5131

2024 STANDARD SPECIFICATIONS

RIGHT OF WAY DATE:

DECEMBER 19, 2018

LETTING DATE:

MARCH 19, 2024

FRANK MASTERSON, PE
 PROJECT ENGINEER

DUDLEY SMITH, PE
 PROJECT DESIGN ENGINEER

YANWEI MA, PE
 NCDOT CONTACT

UTILITIES DESIGN ENGINEER



DocuSigned by:
 D C Smith III
 SIGNATURE

P.E.

