

| | |
|---|---------------------|
| PROJECT REFERENCE NO. U-5112 | SHEET NO. PMP-4 |
| RW SHEET NO. | |
| ROADWAY ENGINEER | HYDRAULICS ENGINEER |
| | |
| Documented by: <i>Frank Masterson</i> 2/12/2024 DOCUMENT NOT CONSIDERED FINAL UNLESS ALL SIGNATURES COMPLETED | |

NC GRID
NAD 83 NA 2011
T & Y MATTHEWS LLC
DB 7245 PG 879

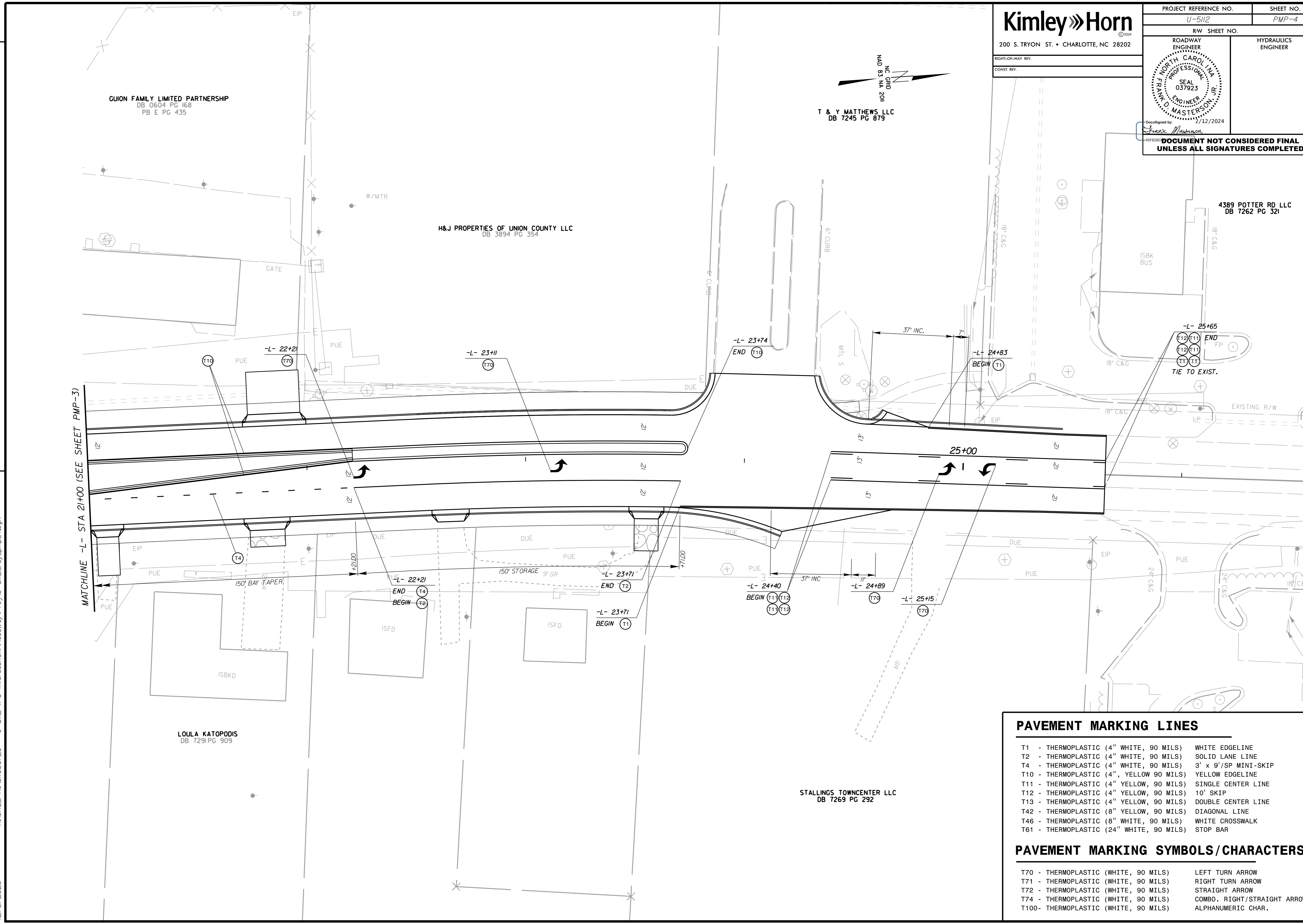

REVISIONS

K:\CHL_P\PROJECTS\U-5112\Roadway\Pro\U-5112_rdy_pmp_4.dgn
12/6/2023

| PAVEMENT MARKING LINES | |
|--|----------------------|
| T1 - THERMOPLASTIC (4" WHITE, 90 MILS) | WHITE EDGE LINE |
| T2 - THERMOPLASTIC (4" WHITE, 90 MILS) | SOLID LANE LINE |
| T4 - THERMOPLASTIC (4" WHITE, 90 MILS) | 3' x 9'/SP MINI-SKIP |
| T10 - THERMOPLASTIC (4", YELLOW 90 MILS) | YELLOW EDGE LINE |
| T11 - THERMOPLASTIC (4" YELLOW, 90 MILS) | SINGLE CENTER LINE |
| T12 - THERMOPLASTIC (4" YELLOW, 90 MILS) | 10' SKIP |
| T13 - THERMOPLASTIC (4" YELLOW, 90 MILS) | DOUBLE CENTER LINE |
| T46 - THERMOPLASTIC (8" YELLOW, 90 MILS) | DIAGONAL LINE |
| T46 - THERMOPLASTIC (8" WHITE, 90 MILS) | WHITE CROSSWALK |
| T61 - THERMOPLASTIC (24" WHITE, 90 MILS) | STOP BAR |

| PAVEMENT MARKING SYMBOLS/CHARACTERS | |
|---------------------------------------|-----------------------------|
| T70 - THERMOPLASTIC (WHITE, 90 MILS) | LEFT TURN ARROW |
| T71 - THERMOPLASTIC (WHITE, 90 MILS) | RIGHT TURN ARROW |
| T72 - THERMOPLASTIC (WHITE, 90 MILS) | STRAIGHT ARROW |
| T74 - THERMOPLASTIC (WHITE, 90 MILS) | COMBO. RIGHT/STRAIGHT ARROW |
| T100 - THERMOPLASTIC (WHITE, 90 MILS) | ALPHANUMERIC CHAR. |