

Documented by: Frank Masterson
2/12/2024
**DOCUMENT NOT CONSIDERED FINAL
UNLESS ALL SIGNATURES COMPLETED**

REVISIONS

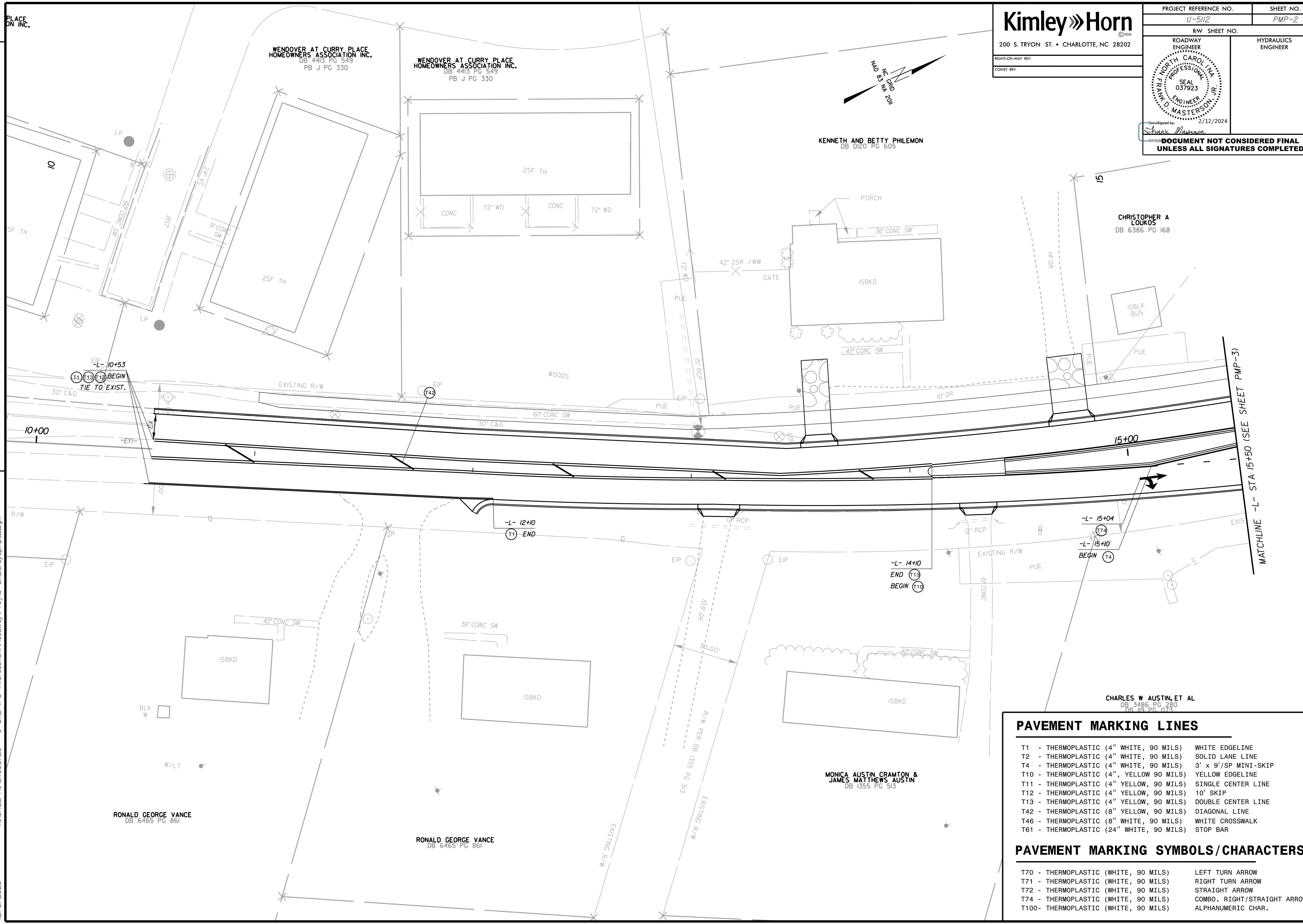

PAVEMENT MARKING LINES

- | | |
|---|----------------------|
| T1 - THERMOPLASTIC (4" WHITE, 90 MILS) | WHITE EDGELINE |
| T2 - THERMOPLASTIC (4" WHITE, 90 MILS) | SOLID LANE LINE |
| T4 - THERMOPLASTIC (4" WHITE, 90 MILS) | 3' x 9'/SP MINI-SKIP |
| T10 - THERMOPLASTIC (4", YELLOW, 90 MILS) | YELLOW EDGELINE |
| T11 - THERMOPLASTIC (4" YELLOW, 90 MILS) | SINGLE CENTER LINE |
| T12 - THERMOPLASTIC (4" YELLOW, 90 MILS) | 10' SKIP |
| T13 - THERMOPLASTIC (4" YELLOW, 90 MILS) | DOUBLE CENTER LINE |
| T42 - THERMOPLASTIC (8" YELLOW, 90 MILS) | DIAGONAL LINE |
| T46 - THERMOPLASTIC (8" WHITE, 90 MILS) | WHITE CROSSWALK |
| T61 - THERMOPLASTIC (24" WHITE, 90 MILS) | STOP BAR |

PAVEMENT MARKING SYMBOLS/CHARACTERS

- | | |
|---------------------------------------|-----------------------------|
| T70 - THERMOPLASTIC (WHITE, 90 MILS) | LEFT TURN ARROW |
| T71 - THERMOPLASTIC (WHITE, 90 MILS) | RIGHT TURN ARROW |
| T72 - THERMOPLASTIC (WHITE, 90 MILS) | STRAIGHT ARROW |
| T74 - THERMOPLASTIC (WHITE, 90 MILS) | COMBO. RIGHT/STRAIGHT ARROW |
| T100 - THERMOPLASTIC (WHITE, 90 MILS) | ALPHANUMERIC CHAR. |

K:\CHL_PRJ\01036720 - U-5112 (P3 Intersection)\Roadway\Pro\U-5112_rdy_pmp_2.dgn
12/6/2023