

BM #1: STA. 12+98.64 -RPB-, N 10003130 E 1728186, RR SPIKE IN 30" POPLAR TREE, EL. 950.91'

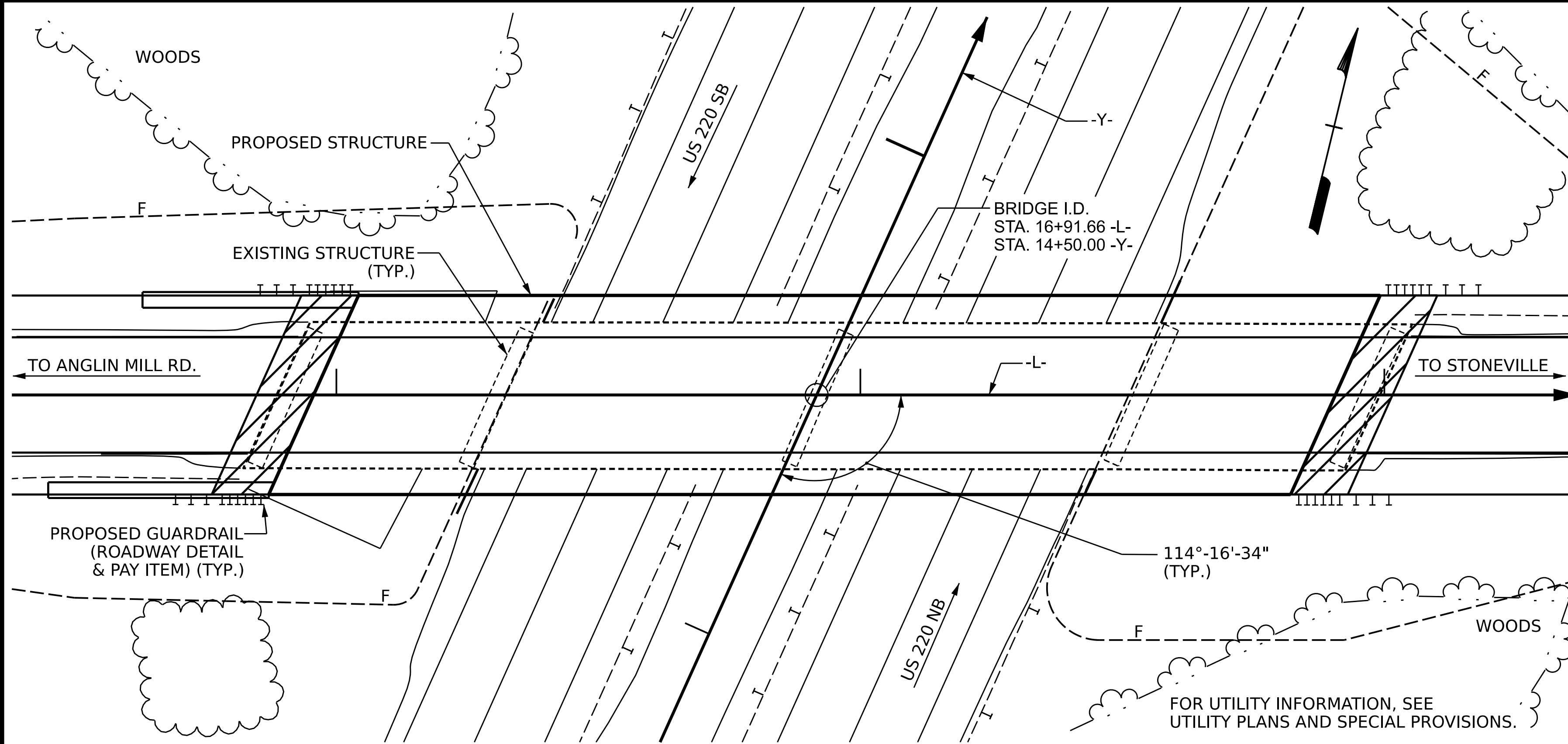

LOCATION SKETCH

NOTES:

ASSUMED LIVE LOAD = HL-93 OR ALTERNATE LOADING.

THIS BRIDGE HAS BEEN DESIGNED IN ACCORDANCE WITH THE AASHTO LRFD BRIDGE DESIGN SPECIFICATIONS.

THIS BRIDGE IS LOCATED IN SEISMIC ZONE 1.

FOR OTHER DESIGN DATA AND GENERAL NOTES, SEE SHEET SN.

FOR SUBMITTAL OF WORKING DRAWINGS, SEE SPECIAL PROVISIONS.

FOR FALSEWORK AND FORMWORK, SEE SPECIAL PROVISIONS.

FOR CRANE SAFETY, SEE SPECIAL PROVISIONS.

FOR GROUT FOR STRUCTURES, SEE SPECIAL PROVISIONS.

FOR MAINTENANCE AND PROTECTION OF TRAFFIC BENEATH PROPOSED STRUCTURE, SEE SPECIAL PROVISIONS.

THE CLASS AA CONCRETE IN THE BRIDGE DECK SHALL CONTAIN FLY ASH OR GROUND GRANULATED BLAST FURNACE SLAG AT THE SUBSTITUTION RATE SPECIFIED IN ARTICLE 1024-1 AND IN ACCORDANCE WITH ARTICLES 1024-5 AND 1024-6 OF THE STANDARD SPECIFICATIONS. NO PAYMENT WILL BE MADE FOR THIS SUBSTITUTION AS IT IS CONSIDERED INCIDENTAL TO THE COST OF THE REINFORCED CONCRETE DECK SLAB.

THE EXISTING STRUCTURE CONSISTING OF REINFORCED CONCRETE DECK ON PRESTRESSED CONCRETE GIRDERS WITH SPAN LENGTH OF 42 FT, 2 @ 61.5 FT AND 45.5 FT, WITH A CLEAR ROADWAY WIDTH OF 28 FT ON A REINFORCED CONCRETE CAP ON PPC PILE END BENTS AND REINFORCED CONCRETE CAP ON POST AND BEAM BENT AND LOCATED AT THE EXISTING STRUCTURE SHALL BE REMOVED. THE EXISTING BRIDGE IS PRESENTLY NOT POSTED FOR LOAD LIMIT.

THE SUBSTRUCTURE OF THE EXISTING BRIDGE INDICATED ON THE PLANS IS FROM THE BEST INFORMATION AVAILABLE. SINCE THIS INFORMATION IS SHOWN FOR THE CONVENIENCE OF THE CONTRACTOR, THE CONTRACTOR SHALL HAVE NO CLAIM WHATSOEVER AGAINST THE DEPARTMENT OF TRANSPORTATION FOR ANY DELAYS OR ADDITIONAL COST INCURRED BASED ON DIFFERENCES BETWEEN THE EXISTING BRIDGE SUBSTRUCTURE SHOWN ON THE PLANS AND THE ACTUAL CONDITIONS AT THE PROJECT SITE.

THE LOCATION OF THE CONSTRUCTION JOINT IN THE DRILLED PIERS IS BASED ON AN APPROXIMATE GROUND LINE ELEVATION. IF THE CONSTRUCTION JOINT IS ABOVE THE ACTUAL GROUND ELEVATION, THE CONTRACTOR SHALL PLACE THE CONSTRUCTION JOINT 1 FT. BELOW THE GROUND LINE.

FOR ASBESTOS ASSESSMENT, SEE SPECIAL PROVISIONS.

THE ELEVATIONS AND CLEARANCES SHOWN ON THE PLANS AT THE POINTS OF MINIMUM VERTICAL CLEARANCE ARE FROM THE BEST INFORMATION AVAILABLE. PRIOR TO BEGINNING BRIDGE CONSTRUCTION, VERIFY THE ELEVATIONS ON THE EXISTING PAVEMENT AND CHECK THE CLEARANCE. REPORT ANY VARIATIONS TO THE ENGINEER. ANY PLAN REVISIONS NECESSARY TO ACHIEVE THE REQUIRED MINIMUM VERTICAL CLEARANCE WILL BE PROVIDED BY THE DEPARTMENT.

REMOVABLE FORMS MAY BE USED IN LIEU OF METAL STAY-IN-PLACE FORMS IN ACCORDANCE WITH ARTICLE 420-3 OF THE STANDARD SPECIFICATIONS.

NEEDLE BEAMS WILL NOT BE ALLOWED UNLESS OTHERWISE CALLED FOR ON THE PLANS OR APPROVED BY THE ENGINEER.

FOR THERMAL SPRAYED COATING (METALLIZATION), SEE SPECIAL PROVISIONS.

FOR FOAM JOINT SEALS, SEE SPECIAL PROVISIONS.

FOR ELASTOMERIC CONCRETE, SEE SPECIAL PROVISIONS.

TOTAL BILL OF MATERIAL

	REMOVAL OF EXISTING STRUCTURE AT STA. 16+91.66 -L-	ASBESTOS ASSESSMENT	3'-6" DIA. DRILLED PIER IN SOIL	3'-6" DIA. DRILLED PIER NOT IN SOIL	DYNAMIC PILE TESTING	CSL TESTING	REINFORCED CONCRETE DECK SLAB	GROOVING BRIDGE FLOORS	CLASS A CONCRETE	BRIDGE APPROACH SLABS STA. 16+91.66 -L-
	LUMP SUM	LUMP SUM	LIN. FT.	LIN. FT.	EA.	EA.	SQ. FT	SQ. FT	CU. YDS	LUMP SUM
SUPERSTRUCTURE							7,753	7,556		LUMP SUM
END BENT 1									51.5	
BENT 1			80.2	15.6					34.9	
END BENT 2									50.2	
TOTAL	LUMP SUM	LUMP SUM	80.2	15.6	1	3	7,753	7,556	136.6	LUMP SUM

TOTAL BILL OF MATERIAL

	REINFORCING STEEL	SPIRAL COLUMN REINFORCING STEEL	54" PRESTRESSED CONCRETE GIRDER		PILE DRIVING EQUIPMENT SET UP FOR HP 12 X 53 STEEL PILES	HP 12 X 53 STEEL PILES		VERTICAL CONCRETE BARRIER RAIL	4" SLOPE PROTECTION	ELASTOMERIC BEARINGS	FOAM JOINT SEALS
	LBS.	LBS.	NO.	LIN. FT.	EA.	NO.	LIN. FT.	LIN. FT.	SQ. YDS	LUMP SUM	LUMP SUM
SUPERSTRUCTURE			10	954.0				385.43		LUMP SUM	LUMP SUM
END BENT 1	5,956				10	10	450		215		
BENT 1	9,993	3,173									
END BENT 2	5,834				10	10	450		240		
TOTAL	21,783	3,173	10	954.0	20	20	900	385.43	455	LUMP SUM	LUMP SUM

PROJECT NO. BR-0095
 ROCKINGHAM COUNTY
 STATION: 16+91.66 -L-

SHEET 3 OF 3

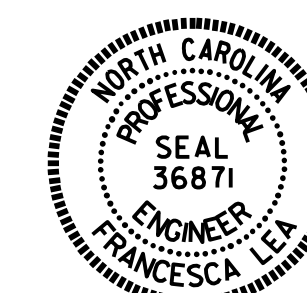

STATE OF NORTH CAROLINA
 DEPARTMENT OF TRANSPORTATION
 RALEIGH
GENERAL DRAWING
 FOR BRIDGE ON
 SR 1360 (SMITH RD) OVER US220
 BETWEEN SR 1376 AND US 220/BUS

DRAWN BY : Q. T. NGUYEN DATE : 06/2023
 CHECKED BY : F. LEA DATE : 08/2023
 DESIGN ENGINEER OF RECORD : Z. MALIK DATE : 04/2023

DOCUMENT NOT CONSIDERED FINAL UNLESS ALL SIGNATURES COMPLETED

REVISIONS						SHEET NO.
NO.	BY:	DATE:	NO.	BY:	DATE:	S-04
1			3			TOTAL SHEETS
2			4			29