

STATE OF NORTH CAROLINA
DIVISION OF HIGHWAYS

TRANSPORTATION MANAGEMENT PLAN

ROCKINGHAM COUNTY

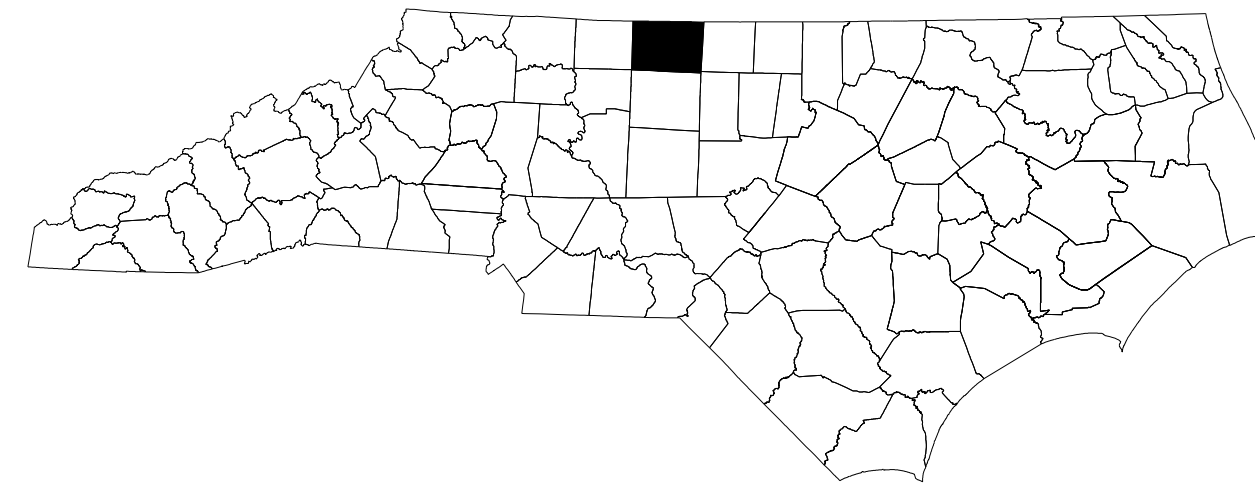

LOCATION: BRIDGE #780170 ON SR 1360 (SMITH RD) OVER US 220
TYPE OF WORK: GRADING, PAVING, DRAINAGE AND STRUCTURE

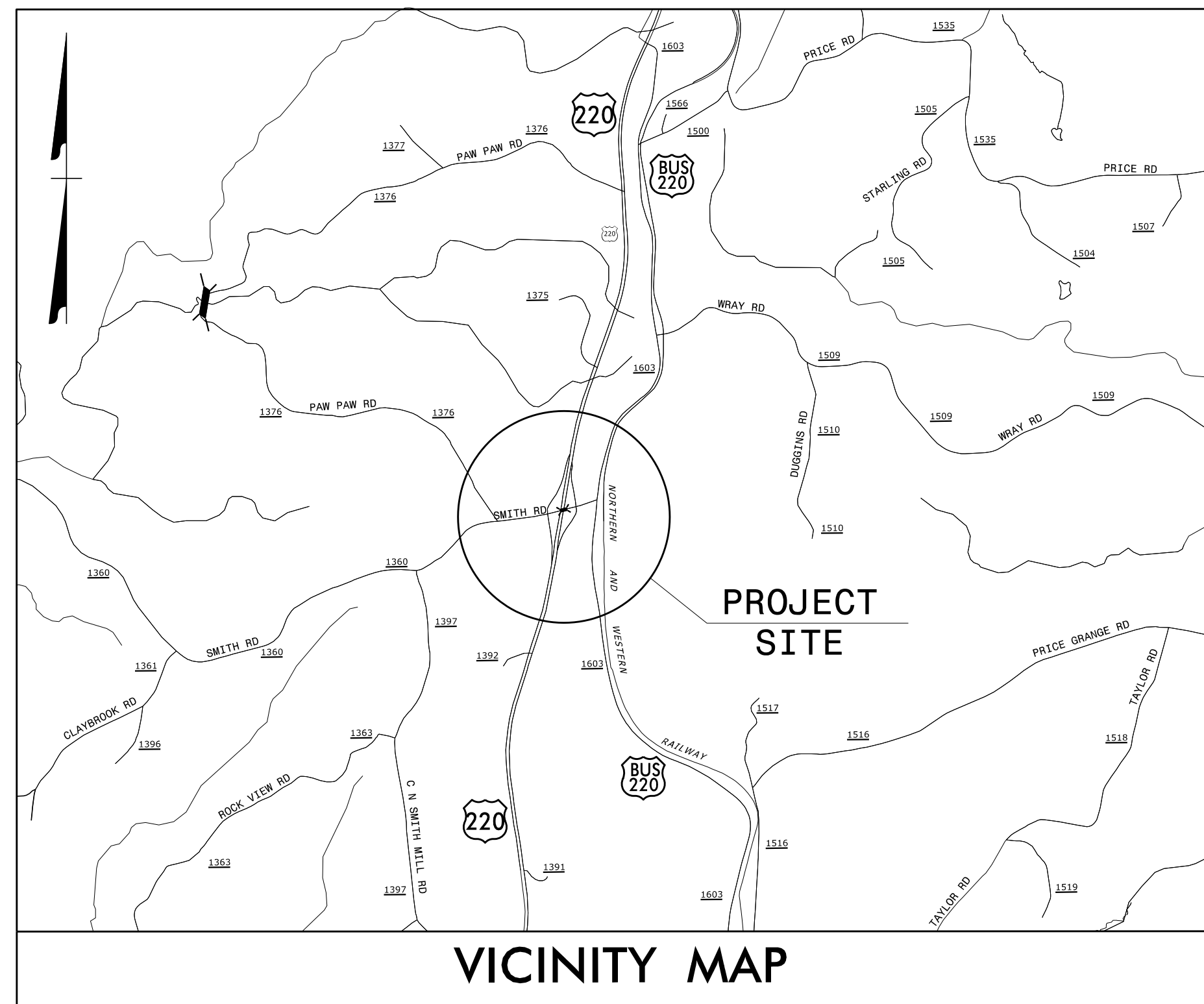

VICINITY MAP

INDEX OF SHEETS	
SHEET NO.	TITLE
TMP-1	TITLE SHEET, VICINITY MAP, AND INDEX OF SHEETS
TMP-1A	LIST OF APPLICABLE ROADWAY STANDARD DRAWINGS, AND LEGEND
TMP-1B	TRANSPORTATION OPERATIONS PLAN: (MANAGEMENT STRATEGIES, GENERAL NOTES, AND LOCAL NOTES)
TMP-2	PORTABLE CONCRETE BARRIER AT TEMPORARY SHORING LOCATIONS
TMP-2A	TEMPORARY SHORING DATA
TMP-2B	SPECIAL SIGN DESIGNS
TMP-3	TEMPORARY TRAFFIC CONTROL PHASING
TMP-4	SMITH ROAD OFFSITE DETOUR
TMP-5	SMITH ROAD & RAMP C OFFSITE DETOUR
TMP-6	SMITH ROAD, RAMP A & RAMP B OFFSITE DETOUR
TMP-7	TRAFFIC CONTROL DETAILS

SHEET NO.
TMP-1

BR-0095

TIP PROJECT:

**DOCUMENT NOT CONSIDERED FINAL
UNLESS ALL SIGNATURES COMPLETED**

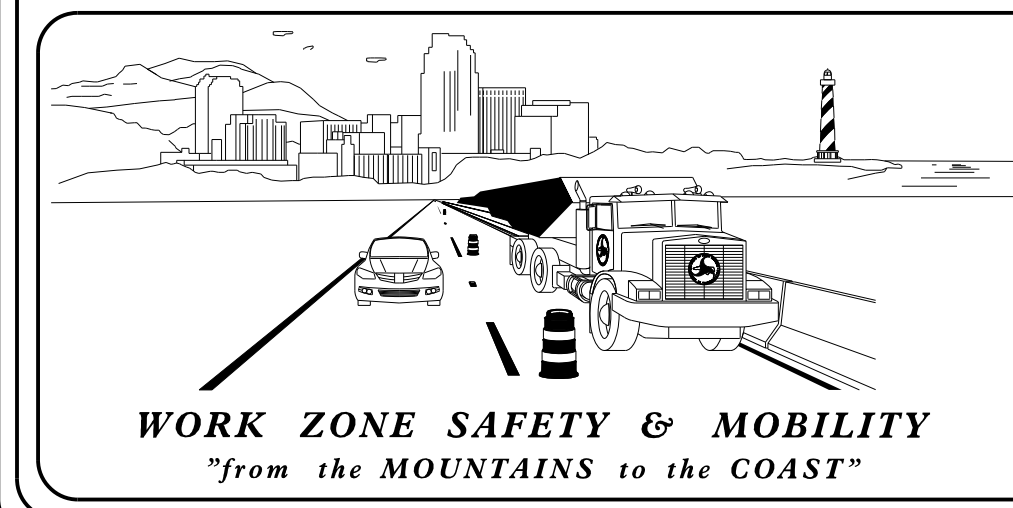

PLANS PREPARED BY:

MATTHEW AKLILU

NCDOT CONTACTS:

KENNETH C. THORNEWELL, PE
PROJECT ENGINEER

MICHAEL STEELMAN
PROJECT DESIGN ENGINEER

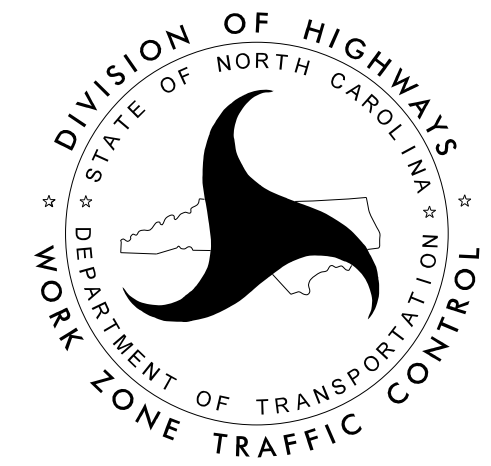

APPROVED: Kenneth C. Thornevell, Jr.
DATE: 01/04/2024

SEAL

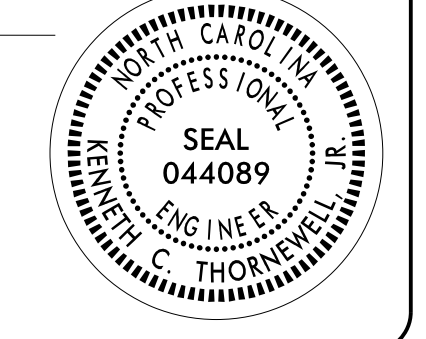

1/4/2024 P:\TIP\Projects-BR-0095\TrafficControl\TC\BR-0095_TC_TMP_1.dgn User:mackfilu