



NC DEPARTMENT OF TRANSPORTATION ATTENTION:
 DIVISION OF HIGHWAYS
 STRUCTURE MANAGEMENT UNIT

Structure Safety Report

4 Year Underwater Element Inspection

COUNTY: JOHNSTON STRUCTURE NUMBER: 500050 FREQUENCY: 48 MONTHS

FACILITY CARRIED: NC210 MILE POST: _____

LOCATION: 0.2MI E.JCT SR1341

FEATURE INTERSECTED: MIDDLE CREEK

LATITUDE: 35° 30' 28.02" LONGITUDE: 78° 24' 5.31"

SUPERSTRUCTURE: REINFORCED CONCRETE FLOOR ON I-BEAMS

SUBSTRUCTURE: RC ABUT1;E.BT2:RCP&B;INT.BTS:RCP&B WIDENED W/PPC PILES

1@34';2@33.917';1@34'

SPANS: 1@34";2@33.917";1@34"

FRACTURE CRITICAL TEMPORARY SHORING SCOUR CRITICAL SCOUR PLAN OF ACTION

PRESENT CONDITION: Fair INSPECTION DATE: 07/06/2015

POSTED SV: Not Posted POSTED TTST: Not Posted

OTHER SIGNS PRESENT: _____



LOOKING EAST

Sign noticed issued for	Number Required
<u>NO</u> WEIGHT LIMIT	<u>0</u>
<u>NO</u> DELINEATORS	<u>0</u>
<u>NO</u> NARROW BRIDGE	<u>0</u>
<u>NO</u> ONE LANE BRIDGE	<u>0</u>
<u>NO</u> LOW CLEARANCE	<u>0</u>

INSPECTED BY Brad Cleaver	SIGNATURE 	ASSISTED BY jf
------------------------------	---------------	-------------------

BRIDGE INSPECTION RECORD AND SUMMARY FOR SHORED STRUCTURES OR STRUCTURES WITH TEMPORARY REPAIRS MADE TO KEEP A BRIDGE OPEN

BRIDGE: **500050** County **Johnston** DATE: **11/6/2013**

THE FOLLOWING S. I. & A ITEMS ARE TO BE CODED TO REFLECT THE FACT THAT THE STRUCTURE IS SHORED OR HAS HAD TEMPORARY REPAIRS MADE TO KEEP THE BRIDGE OPEN :

	<u>CODE</u>	<u>BY</u>
S I & A ITEM 103 - TEMPORARY STRUCTURE DESIGNATION	T	TSE
S I & A ITEM 59 - SUPERSTRUCTURE	4	TSE <i>11/6/13</i>
S I & A ITEM 60 - SUBSTRUCTURE		
S I & A ITEM 64 OPERATING RATING		
	HS	BY:
S I & A ITEM 66 - INVENTORY RATING		
	HS	BY:

COMMENTS

Plates welded to the bottom flange of some beams.

Temporary Repair ~~REPAIR~~ TEMP TMS 11/6/13
RETAIN

Span Element Report

Structure Number: 500050

Inspection Date: 07/06/2015

Span Number 1

Span Length 34 Feet

Number of Beams/Girders: 13

Element Number	Parent Number	Element Name	Total Quantity	Level 1 Quantity	Level 2 Quantity	Level 3 Quantity	Level 4 Quantity	Maint. Quantity	Maint. Code
12		Reinforced Concrete Deck	998	998	0	0	0	0	3326
107		Steel Open Girder/Beam	442	442	0	0	0	0	3314
515	107	Steel Protective Coating	2197	2197	0	0	0	0	3342
210		Reinforced Concrete Pier Wall	4	4	0	0	0	0	3348
215		Reinforced Concrete Abutment	30	30	0	0	0	0	3350
234		Reinforced Concrete Pier Cap	30	30	0	0	0	0	3348
316		Other Bearings	26	26	0	0	0	0	3334
515	316	Steel Protective Coating	26	26	0	0	0	0	3342
331		Reinforced Concrete Bridge Railing	68	68	0	0	0	0	3318
510		Wearing Surface	952	952	0	0	0	0	2816

"Near" Approach and Substructure quantities have been include for reporting purposes. The last span will also include End Bent 2 and Far Approach quantities where applicable

Span Number 2

Span Length 33.917 Feet

Number of Beams/Girders: 13

Element Number	Parent Number	Element Name	Total Quantity	Level 1 Quantity	Level 2 Quantity	Level 3 Quantity	Level 4 Quantity	Maint. Quantity	Maint. Code
12		Reinforced Concrete Deck	995	995	0	0	0	0	3326
107		Steel Open Girder/Beam	442	442	0	0	0	0	3314
515	107	Steel Protective Coating	2197	2197	0	0	0	0	3342
205		Reinforced Concrete Column	2	0	2	0	0	10	3348
226		Prestressed Concrete Pile	2	0	2	0	0	10	3348
234		Reinforced Concrete Pier Cap	30	30	0	0	0	0	3348
301		Pourable Joint Seal	30	30	0	0	0	0	3310
316		Other Bearings	26	26	0	0	0	0	3334
515	316	Steel Protective Coating	26	26	0	0	0	0	3342
331		Reinforced Concrete Bridge Railing	68	68	0	0	0	0	3318
510		Wearing Surface	950	950	0	0	0	0	2816

"Near" Approach and Substructure quantities have been include for reporting purposes. The last span will also include End Bent 2 and Far Approach quantities where applicable

Span Number 3

Span Length 33.917 Feet

Number of Beams/Girders: 13

Element Number	Parent Number	Element Name	Total Quantity	Level 1 Quantity	Level 2 Quantity	Level 3 Quantity	Level 4 Quantity	Maint. Quantity	Maint. Code
205		Reinforced Concrete Column	2	2	0	0	0	0	3348
226		Prestressed Concrete Pile	2	2	0	0	0	0	3348
234		Reinforced Concrete Pier Cap	30	30	0	0	0	0	3348

"Near" Approach and Substructure quantities have been include for reporting purposes. The last span will also include End Bent 2 and Far Approach quantities where applicable

Superstructure Detailed Element Quantities

Structure Number: 500050

Inspection Date: 07/06/2015

Element Location	Location Number	Element Number	Element Name	Total Quantity	Level 1 Quantity	Level 2 Quantity	Level 3 Quantity	Level 4 Quantity	Maint. Quantity	Maint. Code	Priority Maintenance
<input type="checkbox"/> Deck	1	12	Reinforced Concrete Deck	998	998	0	0	0	0	3326	<input type="checkbox"/> Requested
<input type="checkbox"/> Bridge Rail	1	331	Reinforced Concrete Bridge Railing	34	34	0	0	0	0	3318	<input type="checkbox"/> Requested
<input type="checkbox"/> Bridge Rail	2	331	Reinforced Concrete Bridge Railing	34	34	0	0	0	0	3318	<input type="checkbox"/> Requested
<input type="checkbox"/> Wearing Surfaces		510	Wearing Surface	952	952	0	0	0	0	2816	<input type="checkbox"/> Requested
<input type="checkbox"/> Beam	1	107	Steel Open Girder/Beam	34	34	0	0	0	0	3314	<input type="checkbox"/> Requested
Protective System		515	Steel Protective Coating	169	169	0	0	0	0	3342	
<input type="checkbox"/> Beam	2	107	Steel Open Girder/Beam	34	34	0	0	0	0	3314	<input type="checkbox"/> Requested
Protective System		515	Steel Protective Coating	169	169	0	0	0	0	3342	
<input type="checkbox"/> Beam	3	107	Steel Open Girder/Beam	34	34	0	0	0	0	3314	<input type="checkbox"/> Requested
Protective System		515	Steel Protective Coating	169	169	0	0	0	0	3342	
<input type="checkbox"/> Beam	4	107	Steel Open Girder/Beam	34	34	0	0	0	0	3314	<input type="checkbox"/> Requested
Protective System		515	Steel Protective Coating	169	169	0	0	0	0	3342	
<input type="checkbox"/> Beam	5	107	Steel Open Girder/Beam	34	34	0	0	0	0	3314	<input type="checkbox"/> Requested
Protective System		515	Steel Protective Coating	169	169	0	0	0	0	3342	
<input type="checkbox"/> Beam	6	107	Steel Open Girder/Beam	34	34	0	0	0	0	3314	<input type="checkbox"/> Requested
Protective System		515	Steel Protective Coating	169	169	0	0	0	0	3342	
<input type="checkbox"/> Beam	7	107	Steel Open Girder/Beam	34	34	0	0	0	0	3314	<input type="checkbox"/> Requested
Protective System		515	Steel Protective Coating	169	169	0	0	0	0	3342	
<input type="checkbox"/> Beam	8	107	Steel Open Girder/Beam	34	34	0	0	0	0	3314	<input type="checkbox"/> Requested
Protective System		515	Steel Protective Coating	169	169	0	0	0	0	3342	
<input type="checkbox"/> Beam	9	107	Steel Open Girder/Beam	34	34	0	0	0	0	3314	<input type="checkbox"/> Requested
Protective System		515	Steel Protective Coating	169	169	0	0	0	0	3342	
<input type="checkbox"/> Beam	10	107	Steel Open Girder/Beam	34	34	0	0	0	0	3314	<input type="checkbox"/> Requested
Protective System		515	Steel Protective Coating	169	169	0	0	0	0	3342	
<input type="checkbox"/> Beam	11	107	Steel Open Girder/Beam	34	34	0	0	0	0	3314	<input type="checkbox"/> Requested
Protective System		515	Steel Protective Coating	169	169	0	0	0	0	3342	
<input type="checkbox"/> Beam	12	107	Steel Open Girder/Beam	34	34	0	0	0	0	3314	<input type="checkbox"/> Requested
Protective System		515	Steel Protective Coating	169	169	0	0	0	0	3342	
<input type="checkbox"/> Beam	13	107	Steel Open Girder/Beam	34	34	0	0	0	0	3314	<input type="checkbox"/> Requested
Protective System		515	Steel Protective Coating	169	169	0	0	0	0	3342	
<input type="checkbox"/> Bearing Device	1	316	Other Bearings	1	1	0	0	0	0	3334	<input type="checkbox"/> Requested

Element Location	Location Number	Element Number	Element Name	Total Quantity	Level 1 Quantity	Level 2 Quantity	Level 3 Quantity	Level 4 Quantity	Maint. Quantity	Maint. Code	Priority Maintenance
Protective System		515	Steel Protective Coating	1	1	0	0	0	0	3342	
<input type="checkbox"/> Bearing Device	1	316	Other Bearings	1	1	0	0	0	0	3334	<input type="checkbox"/> Requested
Protective System		515	Steel Protective Coating	1	1	0	0	0	0	3342	
<input type="checkbox"/> Bearing Device	2	316	Other Bearings	1	1	0	0	0	0	3334	<input type="checkbox"/> Requested
Protective System		515	Steel Protective Coating	1	1	0	0	0	0	3342	
<input type="checkbox"/> Bearing Device	2	316	Other Bearings	1	1	0	0	0	0	3334	<input type="checkbox"/> Requested
Protective System		515	Steel Protective Coating	1	1	0	0	0	0	3342	
<input type="checkbox"/> Bearing Device	3	316	Other Bearings	1	1	0	0	0	0	3334	<input type="checkbox"/> Requested
Protective System		515	Steel Protective Coating	1	1	0	0	0	0	3342	
<input type="checkbox"/> Bearing Device	3	316	Other Bearings	1	1	0	0	0	0	3334	<input type="checkbox"/> Requested
Protective System		515	Steel Protective Coating	1	1	0	0	0	0	3342	
<input type="checkbox"/> Bearing Device	4	316	Other Bearings	1	1	0	0	0	0	3334	<input type="checkbox"/> Requested
Protective System		515	Steel Protective Coating	1	1	0	0	0	0	3342	
<input type="checkbox"/> Bearing Device	4	316	Other Bearings	1	1	0	0	0	0	3334	<input type="checkbox"/> Requested
Protective System		515	Steel Protective Coating	1	1	0	0	0	0	3342	
<input type="checkbox"/> Bearing Device	5	316	Other Bearings	1	1	0	0	0	0	3334	<input type="checkbox"/> Requested
Protective System		515	Steel Protective Coating	1	1	0	0	0	0	3342	
<input type="checkbox"/> Bearing Device	5	316	Other Bearings	1	1	0	0	0	0	3334	<input type="checkbox"/> Requested
Protective System		515	Steel Protective Coating	1	1	0	0	0	0	3342	
<input type="checkbox"/> Bearing Device	6	316	Other Bearings	1	1	0	0	0	0	3334	<input type="checkbox"/> Requested
Protective System		515	Steel Protective Coating	1	1	0	0	0	0	3342	
<input type="checkbox"/> Bearing Device	6	316	Other Bearings	1	1	0	0	0	0	3334	<input type="checkbox"/> Requested
Protective System		515	Steel Protective Coating	1	1	0	0	0	0	3342	
<input type="checkbox"/> Bearing Device	7	316	Other Bearings	1	1	0	0	0	0	3334	<input type="checkbox"/> Requested
Protective System		515	Steel Protective Coating	1	1	0	0	0	0	3342	
<input type="checkbox"/> Bearing Device	7	316	Other Bearings	1	1	0	0	0	0	3334	<input type="checkbox"/> Requested
Protective System		515	Steel Protective Coating	1	1	0	0	0	0	3342	
<input type="checkbox"/> Bearing Device	8	316	Other Bearings	1	1	0	0	0	0	3334	<input type="checkbox"/> Requested
Protective System		515	Steel Protective Coating	1	1	0	0	0	0	3342	
<input type="checkbox"/> Bearing Device	8	316	Other Bearings	1	1	0	0	0	0	3334	<input type="checkbox"/> Requested
Protective System		515	Steel Protective Coating	1	1	0	0	0	0	3342	

Element Location	Location Number	Element Number	Element Name	Total Quantity	Level 1 Quantity	Level 2 Quantity	Level 3 Quantity	Level 4 Quantity	Maint. Quantity	Maint. Code	Priority Maintenance
<input type="checkbox"/> Bearing Device	9	316	Other Bearings	1	1	0	0	0	0	3334	<input type="checkbox"/> Requested
Protective System		515	Steel Protective Coating	1	1	0	0	0	0	3342	
<input type="checkbox"/> Bearing Device	9	316	Other Bearings	1	1	0	0	0	0	3334	<input type="checkbox"/> Requested
Protective System		515	Steel Protective Coating	1	1	0	0	0	0	3342	
<input type="checkbox"/> Bearing Device	10	316	Other Bearings	1	1	0	0	0	0	3334	<input type="checkbox"/> Requested
Protective System		515	Steel Protective Coating	1	1	0	0	0	0	3342	
<input type="checkbox"/> Bearing Device	10	316	Other Bearings	1	1	0	0	0	0	3334	<input type="checkbox"/> Requested
Protective System		515	Steel Protective Coating	1	1	0	0	0	0	3342	
<input type="checkbox"/> Bearing Device	11	316	Other Bearings	1	1	0	0	0	0	3334	<input type="checkbox"/> Requested
Protective System		515	Steel Protective Coating	1	1	0	0	0	0	3342	
<input type="checkbox"/> Bearing Device	11	316	Other Bearings	1	1	0	0	0	0	3334	<input type="checkbox"/> Requested
Protective System		515	Steel Protective Coating	1	1	0	0	0	0	3342	
<input type="checkbox"/> Bearing Device	12	316	Other Bearings	1	1	0	0	0	0	3334	<input type="checkbox"/> Requested
Protective System		515	Steel Protective Coating	1	1	0	0	0	0	3342	
<input type="checkbox"/> Bearing Device	12	316	Other Bearings	1	1	0	0	0	0	3334	<input type="checkbox"/> Requested
Protective System		515	Steel Protective Coating	1	1	0	0	0	0	3342	
<input type="checkbox"/> Bearing Device	13	316	Other Bearings	1	1	0	0	0	0	3334	<input type="checkbox"/> Requested
Protective System		515	Steel Protective Coating	1	1	0	0	0	0	3342	
<input type="checkbox"/> Bearing Device	13	316	Other Bearings	1	1	0	0	0	0	3334	<input type="checkbox"/> Requested
Protective System		515	Steel Protective Coating	1	1	0	0	0	0	3342	

Structure Number: 500050
Span Number 2

Inspection Date: 07/06/2015

Element Location	Location Number	Element Number	Element Name	Total Quantity	Level 1 Quantity	Level 2 Quantity	Level 3 Quantity	Level 4 Quantity	Maint. Quantity	Maint. Code	Priority Maintenance
<input type="checkbox"/> Deck	1	12	Reinforced Concrete Deck	995	995	0	0	0	0	3326	<input type="checkbox"/> Requested
<input type="checkbox"/> Bridge Rail	1	331	Reinforced Concrete Bridge Railing	34	34	0	0	0	0	3318	<input type="checkbox"/> Requested
<input type="checkbox"/> Bridge Rail	2	331	Reinforced Concrete Bridge Railing	34	34	0	0	0	0	3318	<input type="checkbox"/> Requested
<input type="checkbox"/> Wearing Surfaces		510	Wearing Surface	950	950	0	0	0	0	2816	<input type="checkbox"/> Requested
<input type="checkbox"/> Beam	1	107	Steel Open Girder/Beam	34	34	0	0	0	0	3314	<input type="checkbox"/> Requested
Protective System		515	Steel Protective Coating	169	169	0	0	0	0	3342	
<input type="checkbox"/> Beam	2	107	Steel Open Girder/Beam	34	34	0	0	0	0	3314	<input type="checkbox"/> Requested
Protective System		515	Steel Protective Coating	169	169	0	0	0	0	3342	
<input type="checkbox"/> Beam	3	107	Steel Open Girder/Beam	34	34	0	0	0	0	3314	<input type="checkbox"/> Requested
Protective System		515	Steel Protective Coating	169	169	0	0	0	0	3342	
<input type="checkbox"/> Beam	4	107	Steel Open Girder/Beam	34	34	0	0	0	0	3314	<input type="checkbox"/> Requested
Protective System		515	Steel Protective Coating	169	169	0	0	0	0	3342	
<input type="checkbox"/> Beam	5	107	Steel Open Girder/Beam	34	34	0	0	0	0	3314	<input type="checkbox"/> Requested
Protective System		515	Steel Protective Coating	169	169	0	0	0	0	3342	
<input type="checkbox"/> Beam	6	107	Steel Open Girder/Beam	34	34	0	0	0	0	3314	<input type="checkbox"/> Requested
Protective System		515	Steel Protective Coating	169	169	0	0	0	0	3342	
<input type="checkbox"/> Beam	7	107	Steel Open Girder/Beam	34	34	0	0	0	0	3314	<input type="checkbox"/> Requested
Protective System		515	Steel Protective Coating	169	169	0	0	0	0	3342	
<input type="checkbox"/> Beam	8	107	Steel Open Girder/Beam	34	34	0	0	0	0	3314	<input type="checkbox"/> Requested
Protective System		515	Steel Protective Coating	169	169	0	0	0	0	3342	
<input type="checkbox"/> Beam	9	107	Steel Open Girder/Beam	34	34	0	0	0	0	3314	<input type="checkbox"/> Requested
Protective System		515	Steel Protective Coating	169	169	0	0	0	0	3342	
<input type="checkbox"/> Beam	10	107	Steel Open Girder/Beam	34	34	0	0	0	0	3314	<input type="checkbox"/> Requested
Protective System		515	Steel Protective Coating	169	169	0	0	0	0	3342	
<input type="checkbox"/> Beam	11	107	Steel Open Girder/Beam	34	34	0	0	0	0	3314	<input type="checkbox"/> Requested
Protective System		515	Steel Protective Coating	169	169	0	0	0	0	3342	
<input type="checkbox"/> Beam	12	107	Steel Open Girder/Beam	34	34	0	0	0	0	3314	<input type="checkbox"/> Requested
Protective System		515	Steel Protective Coating	169	169	0	0	0	0	3342	
<input type="checkbox"/> Beam	13	107	Steel Open Girder/Beam	34	34	0	0	0	0	3314	<input type="checkbox"/> Requested
Protective System		515	Steel Protective Coating	169	169	0	0	0	0	3342	
<input type="checkbox"/> Bearing Device	1	316	Other Bearings	1	1	0	0	0	0	3334	<input type="checkbox"/> Requested

Element Location	Location Number	Element Number	Element Name	Total Quantity	Level 1 Quantity	Level 2 Quantity	Level 3 Quantity	Level 4 Quantity	Maint. Quantity	Maint. Code	Priority Maintenance
Protective System		515	Steel Protective Coating	1	1	0	0	0	0	3342	
<input type="checkbox"/> Bearing Device	1	316	Other Bearings	1	1	0	0	0	0	3334	<input type="checkbox"/> Requested
Protective System		515	Steel Protective Coating	1	1	0	0	0	0	3342	
<input type="checkbox"/> Bearing Device	2	316	Other Bearings	1	1	0	0	0	0	3334	<input type="checkbox"/> Requested
Protective System		515	Steel Protective Coating	1	1	0	0	0	0	3342	
<input type="checkbox"/> Bearing Device	2	316	Other Bearings	1	1	0	0	0	0	3334	<input type="checkbox"/> Requested
Protective System		515	Steel Protective Coating	1	1	0	0	0	0	3342	
<input type="checkbox"/> Bearing Device	3	316	Other Bearings	1	1	0	0	0	0	3334	<input type="checkbox"/> Requested
Protective System		515	Steel Protective Coating	1	1	0	0	0	0	3342	
<input type="checkbox"/> Bearing Device	3	316	Other Bearings	1	1	0	0	0	0	3334	<input type="checkbox"/> Requested
Protective System		515	Steel Protective Coating	1	1	0	0	0	0	3342	
<input type="checkbox"/> Bearing Device	4	316	Other Bearings	1	1	0	0	0	0	3334	<input type="checkbox"/> Requested
Protective System		515	Steel Protective Coating	1	1	0	0	0	0	3342	
<input type="checkbox"/> Bearing Device	4	316	Other Bearings	1	1	0	0	0	0	3334	<input type="checkbox"/> Requested
Protective System		515	Steel Protective Coating	1	1	0	0	0	0	3342	
<input type="checkbox"/> Bearing Device	5	316	Other Bearings	1	1	0	0	0	0	3334	<input type="checkbox"/> Requested
Protective System		515	Steel Protective Coating	1	1	0	0	0	0	3342	
<input type="checkbox"/> Bearing Device	5	316	Other Bearings	1	1	0	0	0	0	3334	<input type="checkbox"/> Requested
Protective System		515	Steel Protective Coating	1	1	0	0	0	0	3342	
<input type="checkbox"/> Bearing Device	6	316	Other Bearings	1	1	0	0	0	0	3334	<input type="checkbox"/> Requested
Protective System		515	Steel Protective Coating	1	1	0	0	0	0	3342	
<input type="checkbox"/> Bearing Device	6	316	Other Bearings	1	1	0	0	0	0	3334	<input type="checkbox"/> Requested
Protective System		515	Steel Protective Coating	1	1	0	0	0	0	3342	
<input type="checkbox"/> Bearing Device	7	316	Other Bearings	1	1	0	0	0	0	3334	<input type="checkbox"/> Requested
Protective System		515	Steel Protective Coating	1	1	0	0	0	0	3342	
<input type="checkbox"/> Bearing Device	7	316	Other Bearings	1	1	0	0	0	0	3334	<input type="checkbox"/> Requested
Protective System		515	Steel Protective Coating	1	1	0	0	0	0	3342	
<input type="checkbox"/> Bearing Device	8	316	Other Bearings	1	1	0	0	0	0	3334	<input type="checkbox"/> Requested
Protective System		515	Steel Protective Coating	1	1	0	0	0	0	3342	
<input type="checkbox"/> Bearing Device	8	316	Other Bearings	1	1	0	0	0	0	3334	<input type="checkbox"/> Requested
Protective System		515	Steel Protective Coating	1	1	0	0	0	0	3342	

Structure Number: 500050
Span Number 2

Inspection Date: 07/06/2015

Element Location	Location Number	Element Number	Element Name	Total Quantity	Level 1 Quantity	Level 2 Quantity	Level 3 Quantity	Level 4 Quantity	Maint. Quantity	Maint. Code	Priority Maintenance
<input type="checkbox"/> Bearing Device	9	316	Other Bearings	1	1	0	0	0	0	3334	<input type="checkbox"/> Requested
Protective System		515	Steel Protective Coating	1	1	0	0	0	0	3342	
<input type="checkbox"/> Bearing Device	9	316	Other Bearings	1	1	0	0	0	0	3334	<input type="checkbox"/> Requested
Protective System		515	Steel Protective Coating	1	1	0	0	0	0	3342	
<input type="checkbox"/> Bearing Device	10	316	Other Bearings	1	1	0	0	0	0	3334	<input type="checkbox"/> Requested
Protective System		515	Steel Protective Coating	1	1	0	0	0	0	3342	
<input type="checkbox"/> Bearing Device	10	316	Other Bearings	1	1	0	0	0	0	3334	<input type="checkbox"/> Requested
Protective System		515	Steel Protective Coating	1	1	0	0	0	0	3342	
<input type="checkbox"/> Bearing Device	11	316	Other Bearings	1	1	0	0	0	0	3334	<input type="checkbox"/> Requested
Protective System		515	Steel Protective Coating	1	1	0	0	0	0	3342	
<input type="checkbox"/> Bearing Device	11	316	Other Bearings	1	1	0	0	0	0	3334	<input type="checkbox"/> Requested
Protective System		515	Steel Protective Coating	1	1	0	0	0	0	3342	
<input type="checkbox"/> Bearing Device	12	316	Other Bearings	1	1	0	0	0	0	3334	<input type="checkbox"/> Requested
Protective System		515	Steel Protective Coating	1	1	0	0	0	0	3342	
<input type="checkbox"/> Bearing Device	12	316	Other Bearings	1	1	0	0	0	0	3334	<input type="checkbox"/> Requested
Protective System		515	Steel Protective Coating	1	1	0	0	0	0	3342	
<input type="checkbox"/> Bearing Device	13	316	Other Bearings	1	1	0	0	0	0	3334	<input type="checkbox"/> Requested
Protective System		515	Steel Protective Coating	1	1	0	0	0	0	3342	
<input type="checkbox"/> Bearing Device	13	316	Other Bearings	1	1	0	0	0	0	3334	<input type="checkbox"/> Requested
Protective System		515	Steel Protective Coating	1	1	0	0	0	0	3342	
<input type="checkbox"/> Expansion Joints	1	301	Pourable Joint Seal	30	30	0	0	0	0	3310	<input type="checkbox"/> Requested

Superstructure Element Defect Descriptions

Structure Number: 500050
Span Number

Inspection Date: 07/06/2015

Substructure Detailed Element Quantities

Structure Number: 500050
End Bent 1

Inspection Date: 07/06/2015

Element Location	Location Number	Element Number	Element Name	Total Quantity	Level 1 Quantity	Level 2 Quantity	Level 3 Quantity	Level 4 Quantity	Maint. Quantity	Maint. Code	Priority Maintenance
<input type="checkbox"/> Caps	1	234	Reinforced Concrete Pier Cap	30	30	0	0	0	0	3348	<input type="checkbox"/> Requested
<input type="checkbox"/> Piles and Columns	1	210	Reinforced Concrete Pier Wall	2	2	0	0	0	0	3348	<input type="checkbox"/> Requested
<input type="checkbox"/> Piles and Columns	2	210	Reinforced Concrete Pier Wall	2	2	0	0	0	0	3348	<input type="checkbox"/> Requested
<input type="checkbox"/> Abutments	1	215	Reinforced Concrete Abutment	30	30	0	0	0	0	3350	<input type="checkbox"/> Requested

Bent 1

Element Location	Location Number	Element Number	Element Name	Total Quantity	Level 1 Quantity	Level 2 Quantity	Level 3 Quantity	Level 4 Quantity	Maint. Quantity	Maint. Code	Priority Maintenance
<input type="checkbox"/> Caps	1	234	Reinforced Concrete Pier Cap	30	30	0	0	0	0	3348	<input type="checkbox"/> Requested
<input checked="" type="checkbox"/> Piles and Columns	1	226	Prestressed Concrete Pile	1	0	1	0	0	5	3348	<input type="checkbox"/> Requested
<input checked="" type="checkbox"/> Piles and Columns	2	205	Reinforced Concrete Column	1	0	1	0	0	5	3348	<input type="checkbox"/> Requested
<input checked="" type="checkbox"/> Piles and Columns	3	205	Reinforced Concrete Column	1	0	1	0	0	5	3348	<input type="checkbox"/> Requested
<input checked="" type="checkbox"/> Piles and Columns	4	226	Prestressed Concrete Pile	1	0	1	0	0	5	3348	<input type="checkbox"/> Requested

Bent 2

Element Location	Location Number	Element Number	Element Name	Total Quantity	Level 1 Quantity	Level 2 Quantity	Level 3 Quantity	Level 4 Quantity	Maint. Quantity	Maint. Code	Priority Maintenance
<input type="checkbox"/> Caps	1	234	Reinforced Concrete Pier Cap	30	30	0	0	0	0	3348	<input type="checkbox"/> Requested
<input type="checkbox"/> Piles and Columns	1	226	Prestressed Concrete Pile	1	1	0	0	0	0	3348	<input type="checkbox"/> Requested
<input type="checkbox"/> Piles and Columns	2	205	Reinforced Concrete Column	1	1	0	0	0	0	3348	<input type="checkbox"/> Requested
<input type="checkbox"/> Piles and Columns	3	205	Reinforced Concrete Column	1	1	0	0	0	0	3348	<input type="checkbox"/> Requested
<input type="checkbox"/> Piles and Columns	4	226	Prestressed Concrete Pile	1	1	0	0	0	0	3348	<input type="checkbox"/> Requested

Substructure Element Defect Descriptions

Structure Number: 500050

Inspection Date: 07/06/2015

Bent 1

Bent 1	Row 1	Piles and Columns	1							
Element: 226	Name	Prestressed Concrete Pile	Qty: 1	Lvl 2: 1	Lvl 3: 0	Lvl 4: 0	Maint. Qty: 0	5		
Defect Description:										
Underwater inspection:										
5' of Abrasion/Wear (PSC): Abrasion or wearing has exposed coarse aggregate but the aggregate remains secure in the concrete.										

Bent 1	Row 1	Piles and Columns	2							
Element: 205	Name	Reinforced Concrete Column	Qty: 1	Lvl 2: 1	Lvl 3: 0	Lvl 4: 0	Maint. Qty: 0	5		
Defect Description:										
Underwater inspection:										
5 Feet of Abrasion/Wear (RC): Abrasion or wearing has exposed coarse aggregate but the aggregate remains secure in the concrete. 1/16" cracks on f-2 and f-4 from m/l to w/l.										

Bent 1	Row 1	Piles and Columns	3							
Element: 205	Name	Reinforced Concrete Column	Qty: 1	Lvl 2: 1	Lvl 3: 0	Lvl 4: 0	Maint. Qty: 0	5		
Defect Description:										
Underwater inspection:										
5 Feet of Abrasion/Wear (RC): Abrasion or wearing has exposed coarse aggregate but the aggregate remains secure in the concrete. 1/16" cracks on f-2 and from m/l to w/l.										

Bent 1	Row 1	Piles and Columns	4							
Element: 226	Name	Prestressed Concrete Pile	Qty: 1	Lvl 2: 1	Lvl 3: 0	Lvl 4: 0	Maint. Qty: 0	5		
Defect Description:										
Underwater inspection:										
5' of Abrasion/Wear (PSC): Abrasion or wearing has exposed coarse aggregate but the aggregate remains secure in the concrete.										

National Bridge and NC Inspection Items

Structure Number: 500050

Inspection Date: 07/06/2015

National Bridge Inventory Items

Item	Grade Scale	Grade
Item 58: Deck	0 - 9 , N	
Item 59: Superstructure	0 - 9 , N	
Item 60: Substructure	0 - 9 , N	5
Item 61: Channel and Channel Protection	0 - 9 , N	7
Item 62: Culvert	0 - 9 , N	
Item 71: Waterway Adequacy	0 - 9 , N	7
Item 72: Approach Roadway Alignment	0 - 9 , N	

Note: If NBI Inspection Item is not present, code NBI item with "N"

NC SMU Inspection Items

Item	Grade Scale	Grade	Maint. Qty.	Maint. Code
Deck Debris	G, F, P, or C		0	3376
Drainage System	G, F, P, or C		0	3332
Utilities	G, F, P, or C			
Slope Protection	G, F, P, or C		0	3352
Wingwall	G, F, P, or C			
Scour	G, F, P, or C	G		
Field Scour Evaluation		G		
Drift	G, F, P, or C	G	0	3366
Fender System	G, F, P, or C		0	3364
Response to Live Load	G, F, P, or C			
Estimated Remaining Life	0 - 100 Years			

Note: If NC SMU Inspection Item is not present, leave NC SMU item blank

Inspection Information

Item	Grade Scale	Grade
Regulatory Sign Noticed Issued	YES/NO	N
Priority Maintenance Request Submitted	YES/NO	N
Inspection Time	Hours	6
Traffic Control Time	Hours	
Snooper Time	Hours	
Ladder Used	YES/NO	N
Bucket Truck Used	YES/NO	N
Boat Used	YES/NO	N
Other Equipment Used	YES/NO	N

National Bridge and NC SMU Inspection Item Details

Structure Number: 500050

Inspection Date: 07/06/2015

Item	Grade	Maint Code	Qty.
Details			

Structure: 500050

County: JOHNSTON

Date: 07/06/2015

Condition Photos



LOOKING EAST



LOOKING SOUTH



LOOKING NORTH



LOOKING WEST



bent 1, span 1

IDENTIFICATION				CLASSIFICATION			
(1) STATE NAME -NORTH CAROLINA	BRIDGE	500050		SUFFICIENCY RATING =			9
(8) STRUCTURE NUMBER(FEDERAL)		000000001010050		STATUS =	Structurally Deficient		
(5) INVENTORY ROUTE (ON/UNDER) - ON		31002100					
(2) STATE HIGHWAY DEPARTMENT DISTRICT		3					
(3) COUNTY CODE	101	(4) PLACE CODE	0	(112)NBIS BRIDGE SYSTEM -			YES
(6) FEATURE INTERSECTED - MIDDLE CREEK				(104)HIGHWAY SYSTEM	Is not on NHS		0
(7) FACILITY CARRIED NC210				(26) FUNCTIONAL CLASS -	Minor Arterial		06
(9) LOCATION 0.2MI E.JCT SR1341				(100)STRAHNET HIGHWAY -	Not a STRAHNET Route		0
(11)MILEPOINT		0		(101)PARALLEL STRUCTURE -	No Parallel Structure		N
(16)LAT 35° 30' 28.02"	(17)LONG	78° 24' 5.31"		(102)DIRECTION OF TRAFFIC -	2-way Traffic		2
(98)BORDER BRIDGE STATE CODE	PCT SHARE			(103)TEMPORARY STRUCTURE -	Temporary Structure/Conditions		T
(99)BORDER BRIDGE STRUCTURE NO				(110)DESIGNATED NATIONAL NETWORK -	On the National Network		1
STRUCTURE TYPE AND MATERIAL				(20) TOLL	On Free Road		3
(43) STRUCTURE TYPE MAIN: Steel				(31) MAINTAIN -	State Highway Agency		01
TYPE - Stringer Mutlibeam or Girder	CODE	302		(22) OWNER -	State Highway Agency		01
(44) STRUCTURE TYPE APPR :				(37) HISTORICAL SIGNIFICANCE -	Not Eligible		5
TYPE -	CODE	000		CONDITION			
(45) NUMBER OF SPANS IN MAIN UNIT		4		(58) DECK			7
(46) NUMBER OF APPROACH SPANS				(59) SUPERSTRUCTURE			4
(107)DECK STRUCTURE TYPE - 1	CODE			(60) SUBSTRUCTURE			6
(108)WEARING SURFACE / PROTECTIVE SYSTEM :				(61) CHANNEL & CHANNEL PROTECTION			7
(A) TYPE OF WEARING SURFACE -	CODE			(62) CULVERTS			N
(B) TYPE OF MEMBRANE -	CODE			LOAD RATING AND POSTING			
(C) TYPE OF DECK PROTECTION -	CODE			(31) DESIGN LOAD	H 15		2
AGE AND SERVICE				(63) OPERATING RATING METHOD -	Load Factor		1
(27) YEAR BUILT		1934		(64) OPERATING RATING -	HS-1		1
(106)YEAR RECONSTRUCTED		1961		(65) INVENTORY RATING METHOD -	Load Factor		1
(42) TYPE OF SERVICE : ON - Highway				(66) INVENTORY RATING -	HS-1		1
UNDER - Waterway	CODE	15		(70) BRIDGE POSTING -	No Posting Required		5
(28) LANES: ON STRUCTURE 2 UNDER STRUCTURE		0		(41) STRUCTURE OPEN, POSTED ,OR CLOSED			D
(29) AVERAGE DAILY TRAFFIC		5000		DESCRIPTION -	Open Temporary Shoring		
(30) YEAR OF ADT 2013	(109) TRUCK ADT PCT	8%		APPRAISAL			
(19) BYPASS OR DETOUR LENGTH		11 MI		(67) STRUCTURAL EVALUATION			3
GEOMETRIC DATA				(68) DECK GEOMETRY			4
(48) LENGTH OF MAXIMUM SPAN		33 FT		(69) UNDERCLEARANCES,VERTI & HORIZ			N
(49) STRUCTURE LENGTH		136 FT		(71) WATERWAY ADEQUACY			7
(50)CURB OR SIDEWALK: LEFT .7915 FT RIGHT .7915 FT				(72) APPROACH ROADWAY ALIGNMENT			8
(51) BRIDGE ROADWAY WIDTH CURB TO CURB		28 FT		(36) TRAFFIC SAFETY FEATURES			0000
(52) DECK WIDTH OUT TO OUT		29.333 FT		(113)SCOUR CRITICAL BRIDGES			8
(32) APPROACH ROADWAY WIDTH (W/SHOULDERS)		23 FT		PROPOSED IMPROVEMENTS			
(33) BRIDGE MEDIAN - No Median	CODE	0		(75) TYPE OF WORK -			CODE
(34) SKEW 0°	(35) STRUCTURE FLARED	0		(76) LENGTH OF STRUCTURE IMPROVEMENT			
(10) INVENTORY ROUTE MIN VERT CLEAR		999.9 FT		(94) BRIDGE IMPROVEMENT COST			
(47) INVENTORY ROUTE TOTAL HORIZ CLEAR		28 FT		(95) ROADWAY IMPROVEMENT COST			
(53) MIN VERT CLEAR OVER BRIDGE RDWY		999.9 FT		(96) TOTAL PROJECT COST			
(54) MIN VERT UNDERCLEAR REF Not a Highway or Railroad		0 FT		(97) YEAR OF IMPROVEMENT COST ESTIMATE			
(55) MIN LAT UNDERCLEAR RT REF Not a Highway or Railroad		000 FT		(114)FUTURE ADT	10000	(115) YEAR FUTURE ADT	2025
(56) MIN LAT UNDERCLEAR LT REF -		000 FT		INSPECTIONS			
NAVIGATION DATA				(90) INSPECTION DATE			10/22/2013
(38) NAVIGATION CONTROL - No Navigational Control	CODE	0		(92) CRITICAL FEATURE INSPECTION :		(93) CFI DATE	
(111)PIER PROTECTION -	CODE			A) FRACTURE CRIT DETAIL -	NO	A)	
(39) NAVIGATION VERTICAL CLEARANCE		0		B) UNDERWATER INSP -	YES 48Mo	B)	07/06/2015
(116)VERT - LIFT BRIDGE NAV MIN VERT CLEAR	FT			C) OTHER SPECIAL INSP	NO	C)	
(40) NAVIGATION HORIZONTAL CLEARANCE		0 FT		SCOUR			

BRIDGE MANAGEMENT UNIT

DATA ON EXISTING STRUCTURE

Update Date: 01/25/2016

COUNTY : JOHNSTON DIVISION : 4 DISTRICT : 3 STRUCTURE NUMBER : 500050 LENGTH : 136 FEET

ROUTE CARRIED : NC210 FEATURE INTERSECTED : MIDDLE CREEK

LOCATED : 0.2MI E.JCT SR1341 BRIDGE NAME : CITY :

FUNC. CLASS : 06 SYST.ON : FA SYST.UNDER : NFA ADT & YR : 5000 2013 RAIL TYPE : LT 241 RT 241

BUILT : 1934 BY : SHPWC PROJ : 2390 FED.AID PROJ : DESIGN LOAD : H 15

REHAB : 1961 BY : DBM PROJ : 122 ALIGNMENT : TAN. SKEW : 90 LANES : ON 2 UNDER 0

NAVIGATION : VC 0 FT HC 0 FT HT. CRN. TO BED : 21 FT WATER DEPTH : 3 FT

SUPERSTRUCTURE : REINFORCED CONCRETE FLOOR ON I-BEAMS

SUBSTRUCTURE : RC ABUT1;E.BT2:RCP&B;INT.BTS:RCP&B WIDENED W/PPC PILES

SPANS : 1@34';2@33.917';1@34'

BEAMS OR GIRDERS : 13 LINES W18X47 I-BEAMS @ 2'4 CENTERS

FLOOR : 5.5 RC/2.5" AWS ENCROACHMENT : DECK (OUT TO OUT) : 29.333 FT

CLEAR ROADWAY : 28 FT BETWEEN RAILS : 29.583 FT SIDEWALK OR CURB : LT .7915 FT RT .7915 FT

VERT.CL.OVER : 999.9 FT

INV.RTG. : HS-1 OPE.RTG. : HS-1 CONTR.MEMBER : Int Bm POSTED : SV TTST DATE 03/23/2009

SYSTEM : Primary N.C. Route GREEN LINE ROUTE : N

UNDER ROUTES AND CLEARANCES

REMARKS :

Bridge Inspection Field Sketch



Roadway	22.5ft Wide	2 Paved Lanes	Looking East
Left Shoulder	7ft Wide		7ft Unpaved
Right Shoulder	7ft Wide		7ft Unpaved
Left Guardrail			
Right Guardrail			

CHECKED BY: WTW 10/22/2013

Title APPROACH ROADWAY		Description LOOKING EAST	
Bridge No: 500050	Drawn By: GGW	Date: 03/31/2006	File Name: S0214000180

Bridge Inspection Field Sketch

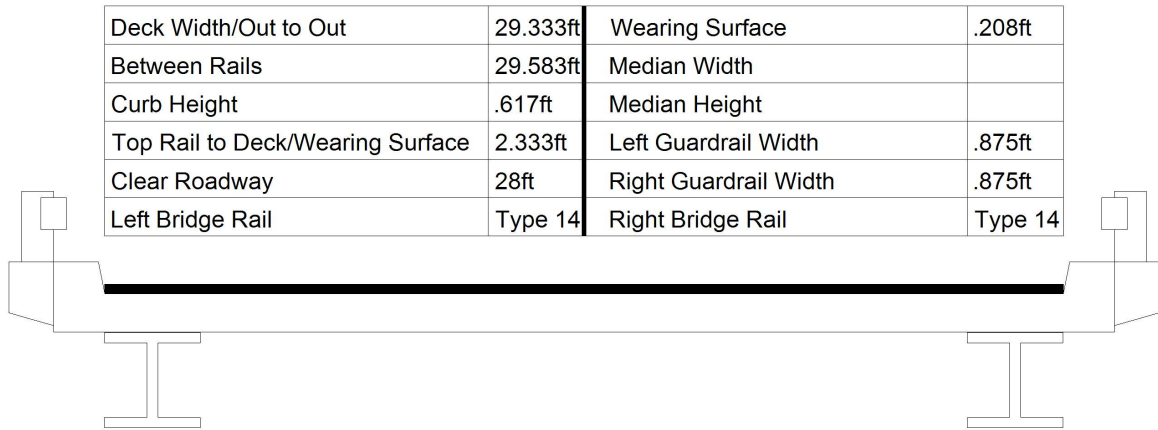

Measurements for Span #	1		
Deck Thickness	.5	Left Overhang	.617
Top of Rail to Bottom of Beam	4.333	Right Overhang	.617

Beam No	Beam Type	Spacing	Comments
1	Steel I Beam	2.333ft	
2	Steel I Beam	2.333ft	
3	Steel I Beam	2.333ft	
4	Steel I Beam	2.333ft	
5	Steel I Beam	2.333ft	
6	Steel I Beam	2.333ft	
7	Steel I Beam	2.333ft	
8	Steel I Beam	2.333ft	
9	Steel I Beam	2.333ft	
10	Steel I Beam	2.333ft	
11	Steel I Beam	2.333ft	
12	Steel I Beam	2.333ft	
13	Steel I Beam		

CHECKED BY: WTW 10/22/2013

Title

TYPICAL SECTION

Description

LOOKING EAST

Bridge No: 500050

Drawn By: GGW

Date: 03/31/2006

File Name: S0214000181

Bridge Inspection Field Sketch

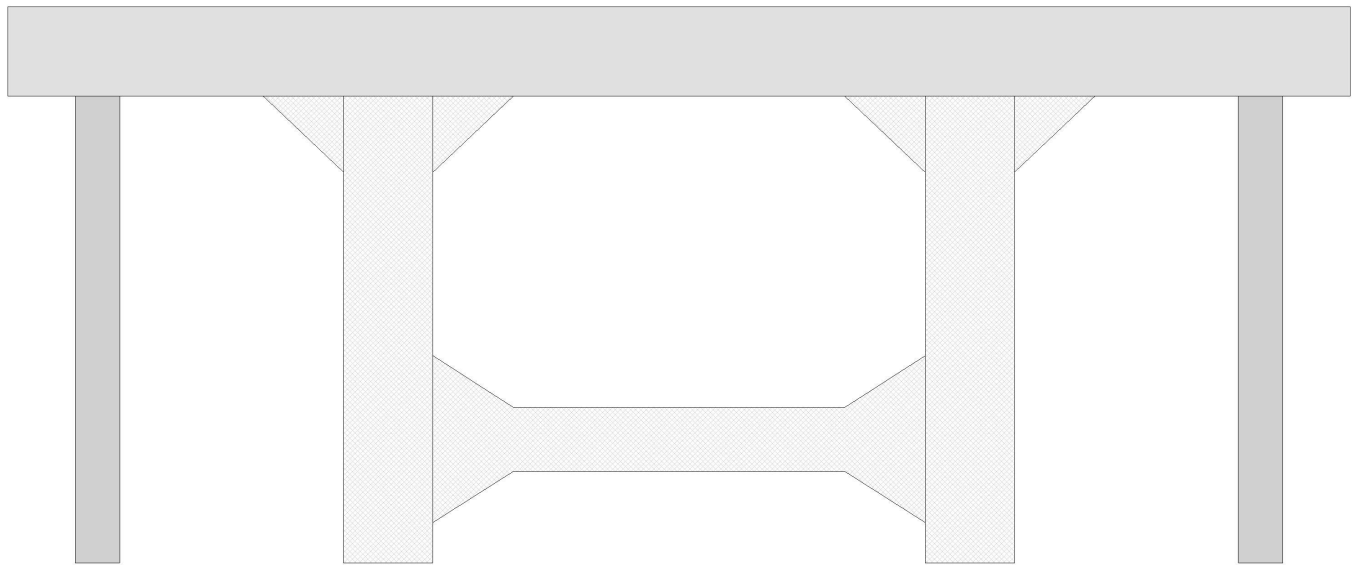

Cap Information			Material Cast-in-Place Concrete							
Length	Width	Height	Left Overhang	Right Overhang	Left Beam to End of Cap.	Right Beam to End of Cap.				
30.000 ft.	2.500 ft.	2.000 ft.	2.000 ft.	2.000 ft.	1.000 ft.	1.000 ft.				
Subcap Information			Material							
Length	Width	Height	Left Overhang	Right Overhang	Left Pile to Splice.					
Sill Information			Material							
Length	Width	Height								
Pile #	Material	Spacing	Width/Dia.	Height	Length	Orientation	Driven?	Replacement?	Removed?	Collar?
1	Concrete	6.5 ft.	1.0 ft.			Vertical	Yes	No	No	No
2	Concrete	13.0 ft.	2.0 ft.			Vertical	No	No	No	No
3	Concrete	6.5 ft.	2.0 ft.			Vertical	No	No	No	No
4	Concrete		1.0 ft.			Vertical	Yes	No	No	No
Bent/Abutment #: 1			Similar Bents: BENTS 2 & 3							

Title SUBSTRUCTURE				Description BENT DIAGRAM			
Bridge No: 500050	Drawn By: WTW			Date: 10/22/2013	File Name: S0018014562		

Bridge Inspection Field Sketch

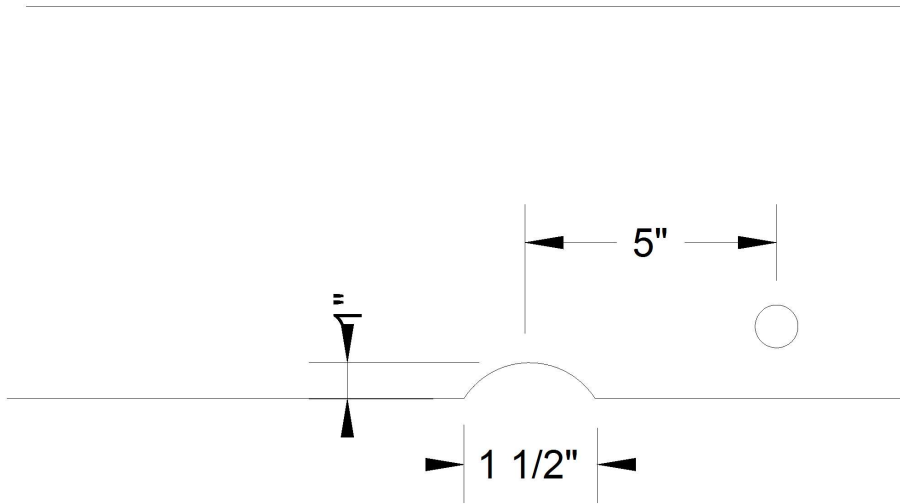

RT BOTTOM FLANGE OF BEAM 1 SPAN 2 AT BENT 2

CHECKED BY: WTW 10/22/2013

Title
CONDITION 2

Description
CONDITION 2

Bridge No: 500050

Drawn By: WCM

Date: 11/20/2009

File Name: S0014003801

Bridge Inspection Field Sketch

BEAMS 9,10,11 OF SPAN 3 BENT 3 END

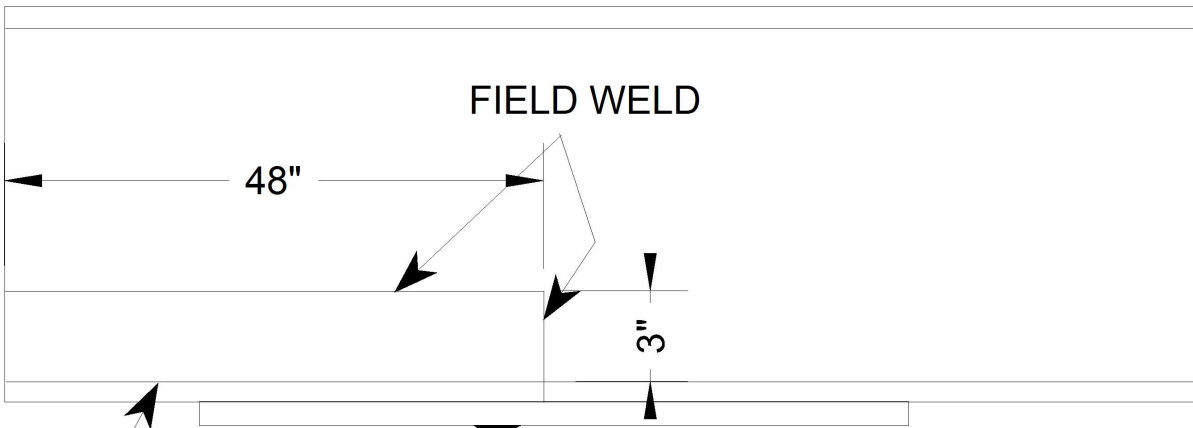

1/2" x 10" x 48" COVER PLATE ADDED OVER JOINT

WEB AND BOTTOM FLANGE HAVE BEEN REPLACED

CHECKED BY: WTW 10/22/2013

Title
REPAIR

Description
REPAIR TO BEAMS 9,10,11 SPAN 3

Bridge No: 500050

Drawn By: WCM

Date: 11/20/2009

File Name: S0014003799

Bridge Inspection Field Sketch

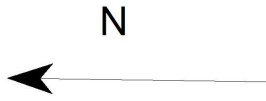

END BENT 2

BT 3

BT 2

4.7' BT 1 3.5'

FLOW

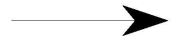

END BENT 1

BOTTOM COMP. = BEDROCK, SAND AND COBBLE W/ 6" PROBE
WATER SURFACE = 19.3' AT N. SIDE OF BT. 1

Title

PLAN VIEW

Description

WATERWAY

Bridge No: 500050

Drawn By: BZC

Date: 7/18/2007

File Name: S0158000430

Bridge Inspection Field Sketch

DELETED DRAWING

Title DELETED DRAWING		Description DELETED DRAWING	
Bridge No: 500050	Drawn By: WCM	Date: 11/20/2009	File Name: S0014003800

Bridge Inspection Field Sketch

SKETCH DELETED

Title	Description		
DELETED DRAWING I	DELETED DRAWING		
Bridge No: 500050	Drawn By: GGW	Date: 03/31/2006	File Name: S0214000183