

LOAD AND RESISTANCE FACTOR RATING (LRFR) SUMMARY FOR PRESTRESSED CONCRETE GIRDERS

LOAD TYPE	VEHICLE	WEIGHT (W) (TONS)	CONTROLLING LOAD RATING (#)	MINIMUM RATING FACTORS (RF)	TONS = W x RF	STRENGTH I LIMIT STATE										SERVICE III LIMIT STATE					COMMENT NUMBER			
						MOMENT					SHEAR					MOMENT								
						LIVE-LOAD FACTORS (γ LL)	DISTRIBUTION FACTORS (DF)	RATING FACTOR	SPAN	GIRDER LOCATION	DISTANCE FROM LEFT END OF SPAN (ft)	DISTRIBUTION FACTORS (DF)	RATING FACTOR	SPAN	GIRDER LOCATION	DISTANCE FROM LEFT END OF SPAN (ft)	LIVE-LOAD FACTORS (γ LL)	DISTRIBUTION FACTORS (DF)	RATING FACTOR	SPAN		GIRDER LOCATION	DISTANCE FROM LEFT END OF SPAN (ft)	
DESIGN LOAD	HL-93 (INVENTORY)	N/A	①	1.006	--	1.75	0.273	1.03	70'	EL	34.5	0.507	1.32	70'	EL	6.9	0.80	0.273	1.01	70'	EL	34.5		
	HL-93 (OPERATING)	N/A		1.341	--	1.35	0.273	1.34	70'	EL	34.5	0.507	1.72	70'	EL	6.9	N/A	--	--	--	--	--		
	HS-20 (INVENTORY)	36.000	②	1.306	47.02	1.75	0.273	1.34	70'	EL	34.5	0.507	1.65	70'	EL	6.9	0.80	0.273	1.31	70'	EL	34.5		
	HS-20 (OPERATING)	36.000		1.740	62.64	1.35	0.273	1.74	70'	EL	34.5	0.507	2.14	70'	EL	6.9	N/A	--	--	--	--	--		
LEGAL LOAD	SINGLE VEHICLE (SV)	SNSH	13.500		2.917	39.379	1.4	0.273	3.75	70'	EL	34.5	0.507	4.87	70'	EL	6.9	0.80	0.273	2.92	70'	EL	34.5	
		SNGARBS2	20.000		2.187	43.741	1.4	0.273	2.81	70'	EL	34.5	0.507	3.47	70'	EL	6.9	0.80	0.273	2.19	70'	EL	34.5	
		SNAGRIS2	22.000		2.077	45.690	1.4	0.273	2.67	70'	EL	34.5	0.507	3.23	70'	EL	6.9	0.80	0.273	2.08	70'	EL	34.5	
		SNCOTTS3	27.250		1.452	39.565	1.4	0.273	1.87	70'	EL	34.5	0.507	2.43	70'	EL	6.9	0.80	0.273	1.45	70'	EL	34.5	
		SNAGRS4	34.925		1.218	42.554	1.4	0.273	1.57	70'	EL	34.5	0.507	2.03	70'	EL	6.9	0.80	0.273	1.22	70'	EL	34.5	
		SNS5A	35.550		1.191	42.346	1.4	0.273	1.53	70'	EL	34.5	0.507	2.06	70'	EL	6.9	0.80	0.273	1.19	70'	EL	34.5	
		SNS6A	39.950		1.095	43.747	1.4	0.273	1.41	70'	EL	34.5	0.507	1.88	70'	EL	6.9	0.80	0.273	1.10	70'	EL	34.5	
	SNS7B	42.000		1.043	43.801	1.4	0.273	1.34	70'	EL	34.5	0.507	1.85	70'	EL	6.9	0.80	0.273	1.04	70'	EL	34.5		
	TRUCK TRACTOR SEMI-TRAILER (TTST)	TNAGRIT3	33.000		1.336	44.087	1.4	0.273	1.72	70'	EL	34.5	0.507	2.23	70'	EL	6.9	0.80	0.273	1.34	70'	EL	34.5	
		TNT4A	33.075		1.342	44.401	1.4	0.273	1.72	70'	EL	34.5	0.507	2.17	70'	EL	6.9	0.80	0.273	1.34	70'	EL	34.5	
		TNT6A	41.600		1.100	45.746	1.4	0.273	1.41	70'	EL	34.5	0.507	1.98	70'	EL	6.9	0.80	0.273	1.10	70'	EL	34.5	
		TNT7A	42.000		1.106	46.462	1.4	0.273	1.42	70'	EL	34.5	0.507	1.94	70'	EL	6.9	0.80	0.273	1.11	70'	EL	34.5	
		TNT7B	42.000		1.147	48.180	1.4	0.273	1.47	70'	EL	34.5	0.507	1.80	70'	EL	6.9	0.80	0.273	1.15	70'	EL	34.5	
		TNAGRIT4	43.000		1.089	46.838	1.4	0.273	1.40	70'	EL	34.5	0.507	1.74	70'	EL	6.9	0.80	0.273	1.09	70'	EL	34.5	
TNAGT5A		45.000		1.026	46.175	1.4	0.273	1.32	70'	EL	34.5	0.507	1.74	70'	EL	6.9	0.80	0.273	1.03	70'	EL	34.5		
TNAGT5B	45.000	③	1.013	45.579	1.4	0.273	1.30	70'	EL	34.5	0.507	1.66	70'	EL	6.9	0.80	0.273	1.01	70'	EL	34.5			
EMERGENCY VEHICLE (EV)	EV2	28.750		1.816	52.212	1.3	0.273	2.11	70'	EL	34.5	0.507	2.59	70'	EL	6.9	0.80	0.273	1.82	70'	EL	34.5		
	EV3	43.000	④	1.188	51.068	1.3	0.273	1.38	70'	EL	34.5	0.507	1.75	70'	EL	6.9	0.80	0.273	1.19	70'	EL	34.5		

LOAD FACTORS:

DESIGN LOAD RATING FACTORS	LIMIT STATE	γ DC	γ DW
	STRENGTH I	1.25	1.50
	SERVICE III	1.00	1.00

NOTES:

MINIMUM RATING FACTORS ARE BASED ON THE STRENGTH I AND SERVICE III LIMIT STATES.

ALLOWABLE STRESSES FOR SERVICE III LIMIT STATE ARE AS REQUIRED FOR DESIGN.

# CONTROLLING LOAD RATING

① DESIGN LOAD RATING (HL-93)

② DESIGN LOAD RATING (HS-20)

③ LEGAL LOAD RATING \*\*

④ EMERGENCY VEHICLE LOAD RATING \*\*

\*\* SEE CHART FOR VEHICLE TYPE

---

GIRDER LOCATION

I - INTERIOR GIRDER  
EL - EXTERIOR LEFT GIRDER  
ER - EXTERIOR RIGHT GIRDER

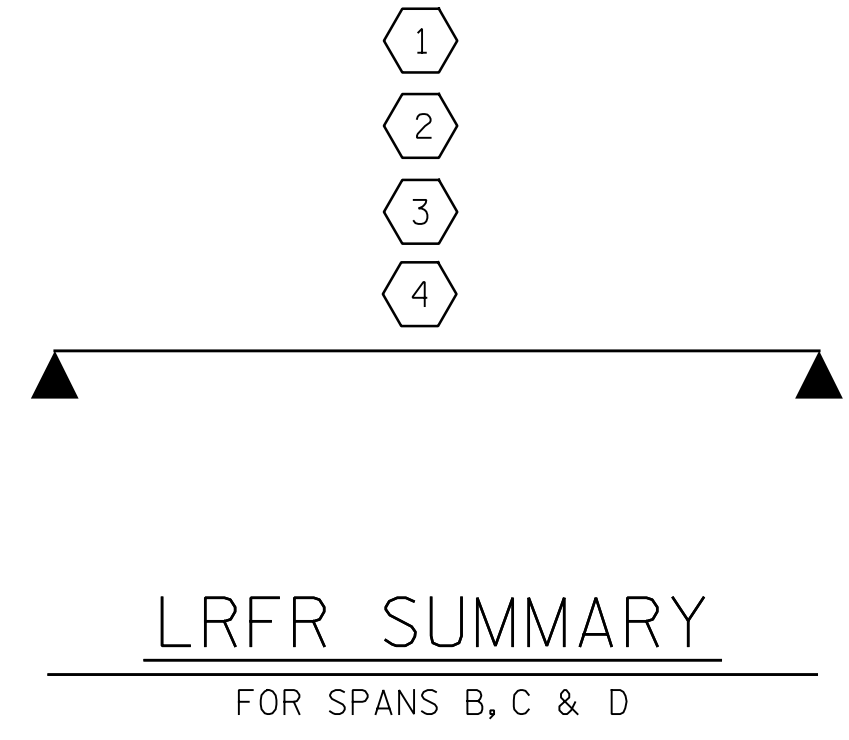

PROJECT NO. B-6046  
STANLY COUNTY  
 STATION: 17+66.00 -L-

User name: jmaustin Plot#ed: 11/14/2023 4:06:56 PM  
 File name: R:\Projects\19-55.01\_SML\_B.6046\_SR1917\_Over\_Long\_Creek\NCDOT\Structures\Drawings\Find\401\_007\_B6046\_SML\_LRFR2\_830102.dgn Print Driver: R:\cecad\Plotting\Structures\NCDOT\Pen Tables\ICE\_NC\_Struct.tbl  
 R:\cecad\Plotting\Structures\NCDOT\Pen Tables\ICE\_NC\_Struct.tbl Config\22x34\_PDF\_ICL.pltcf

DRAWN BY : J. N. AUSTIN DATE : 8-10-22  
 CHECKED BY : N. D'AIUTO DATE : 8-12-22  
 DESIGN E.O.R. : N. D'AIUTO DATE : 1-4-23

DOCUMENT NOT CONSIDERED FINAL  
 UNLESS ALL SIGNATURES COMPLETED

ICE of CAROLINAS, PLLC  
 4505 Falls of Neuse Road, Suite 110  
 Raleigh, North Carolina 27609  
 Phone: 919-822-0333  
 License #: P-0999

STATE OF NORTH CAROLINA  
 DEPARTMENT OF TRANSPORTATION  
 RALEIGH

LRFR SUMMARY FOR  
 70' CORED SLAB UNIT  
 90° SKEW

(NON-INTERSTATE TRAFFIC)

REVISIONS						SHEET NO.
NO.	BY:	DATE:	NO.	BY:	DATE:	
1			3			TOTAL SHEETS
2			4			24