

TIP PROJECT: B-6046

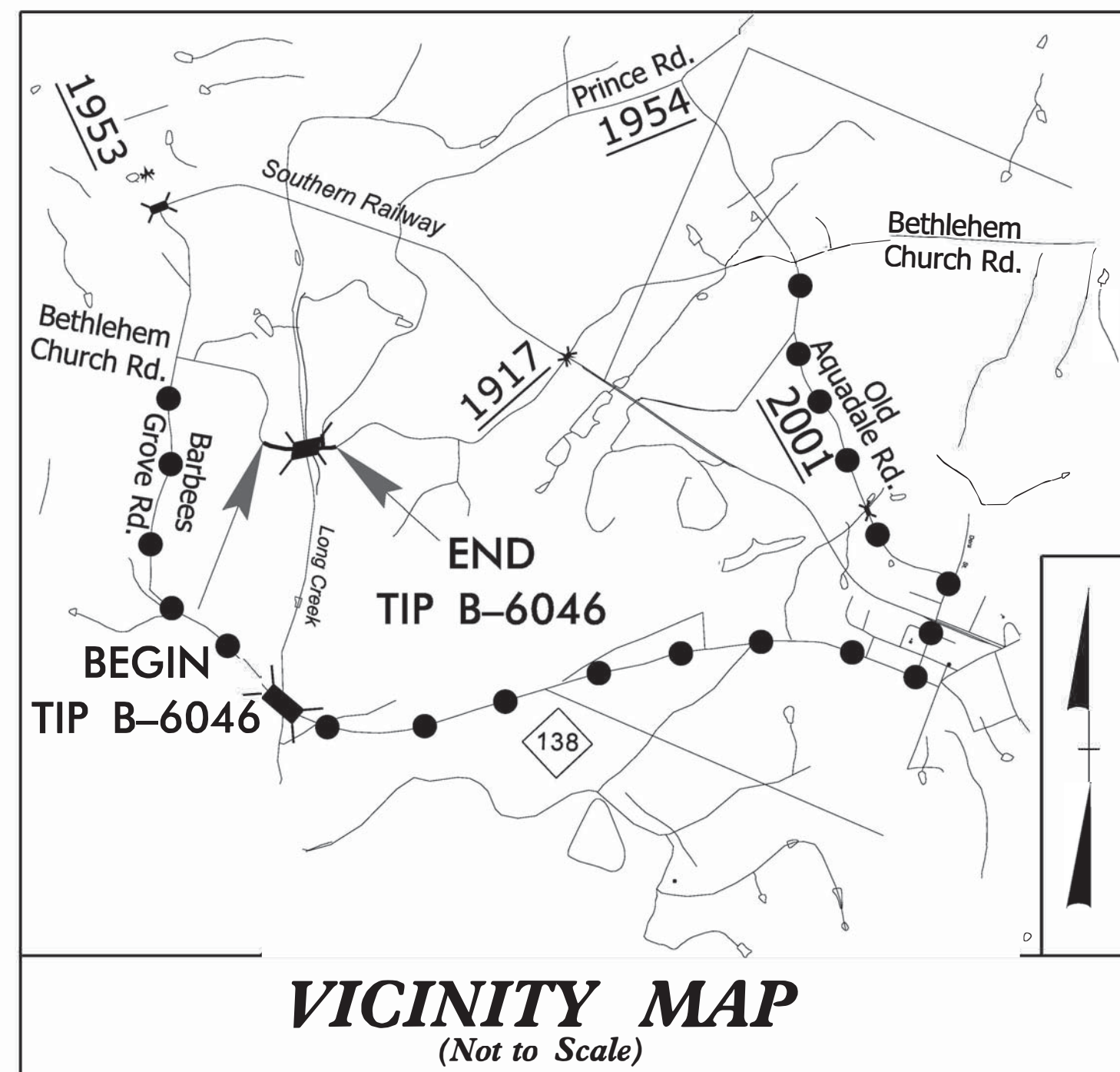

STATE OF NORTH CAROLINA
DIVISION OF HIGHWAYS

**UTILITIES BY OTHERS PLANS
STANLEY COUNTY**

**LOCATION: BRIDGE NO. 102 ON SR1917
(BETHLEHEM CHURCH ROAD) OVER LONG CREEK**

TYPE OF WORK: UTILITY RELOCATION

T.I.P. NO.	SHEET NO.
B-6046	UO-1

NOTE:
ALL UTILITY WORK SHOWN ON THIS SHEET WILL BE DONE BY OTHERS.
NO PAYMENT WILL BE MADE TO THE CONTRACTOR FOR UTILITY WORK SHOWN ON THIS SHEET.

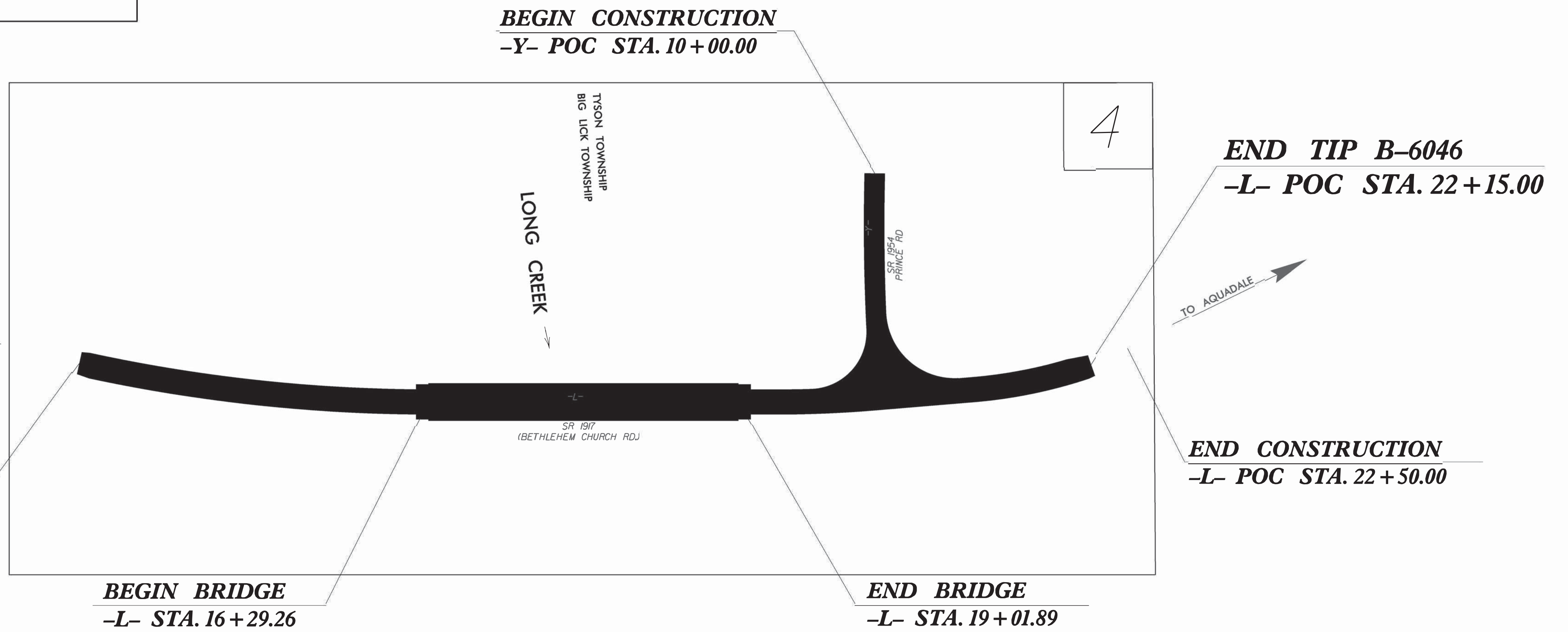

**BEGIN TIP B-6046
-L- POC STA. 13+20.00**

**BEGIN BRIDGE
-L- STA. 16+29.26**

**END BRIDGE
-L- STA. 19+01.89**

**END TIP B-6046
-L- POC STA. 22+15.00**

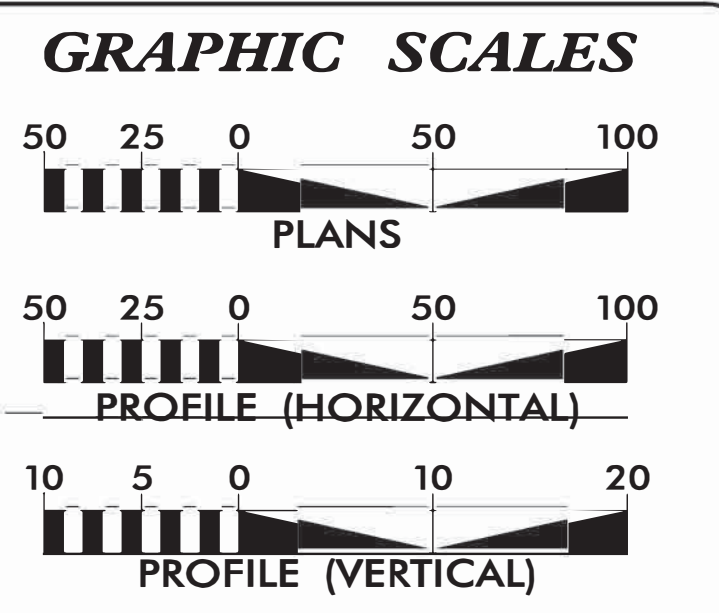

INDEX OF SHEETS

SHEET NO.:	DESCRIPTION:
UO-1	TITLE SHEET
UO-1B	LEGEND
U4	UBO PLAN SHEETS

UTILITY OWNERS WITH CONFLICTS

(A) GAS TRANSMISSION -
PIEDMONT NATURAL GAS/DUKE

PREPARED IN THE OFFICE OF:

ICE of Carolinas, PLLC
4505 Falls of Neuse Road, Suite 110
Raleigh, North Carolina 27609
Phone: 803-822-0333
License #: P-0999

GUS KRETSCHMER UTILITY PROJECT MANAGER
TERESA MCCLUNG PROJECT UTILITY COORDINATOR
PROJECT UTILITY XXXX

**DIVISION OF HIGHWAYS
UTILITIES UNIT**
1555 MAIL SERVICES CENTER
RALEIGH, NC 27699-1555
PHONE (919) 707-6690
FAX (919) 250-4151

MICHAEL BRIGHT UTILITIES REGIONAL ENGINEER
DONALD HAMPTON UTILITIES ENGINEER
JON GAILLARD UTILITIES AREA COORDINATOR
SUNIL SINGH UTILITIES COORDINATOR