

**SUPERSTRUCTURE REINFORCING STEEL LENGTHS ARE BASED ON THE FOLLOWING MINIMUM SPLICE LENGTHS**

BAR SIZE	SUPERSTRUCTURE EXCEPT APPROACH SLABS, PARAPETS, AND BARRIER RAILS		APPROACH SLABS		PARAPETS AND BARRIER RAILS
	EPOXY COATED	UNCOATED	EPOXY COATED	UNCOATED	
#4	1'-11"	1'-7"	1'-11"	1'-7"	2'-6"
#5	2'-5"	2'-0"	2'-5"	2'-0"	3'-1"
#6	2'-10"	2'-5"	3'-7"	2'-5"	3'-8"
#7	4'-2"	2'-9"			
#8	4'-9"	3'-2"			

**— SUPERSTRUCTURE BILL OF MATERIAL —**

	CLASS AA CONCRETE ( CU.YDS.)	REINFORCING STEEL ( LBS.)	EPOXY COATED REINFORCING STEEL ( LBS.)
SPANS A-C		67,538	66,242
POUR 1	152.1		
POUR 2	218.0		
POUR 3	226.9		
POUR 4	20.3		
SIDEWALK	31.4		
TOTALS**	648.7	67,538	66,242

\*\* QUANTITIES FOR BARRIER RAIL AND MONOLITHIC ISLAND ARE NOT INCLUDED.

**BAR TYPES**

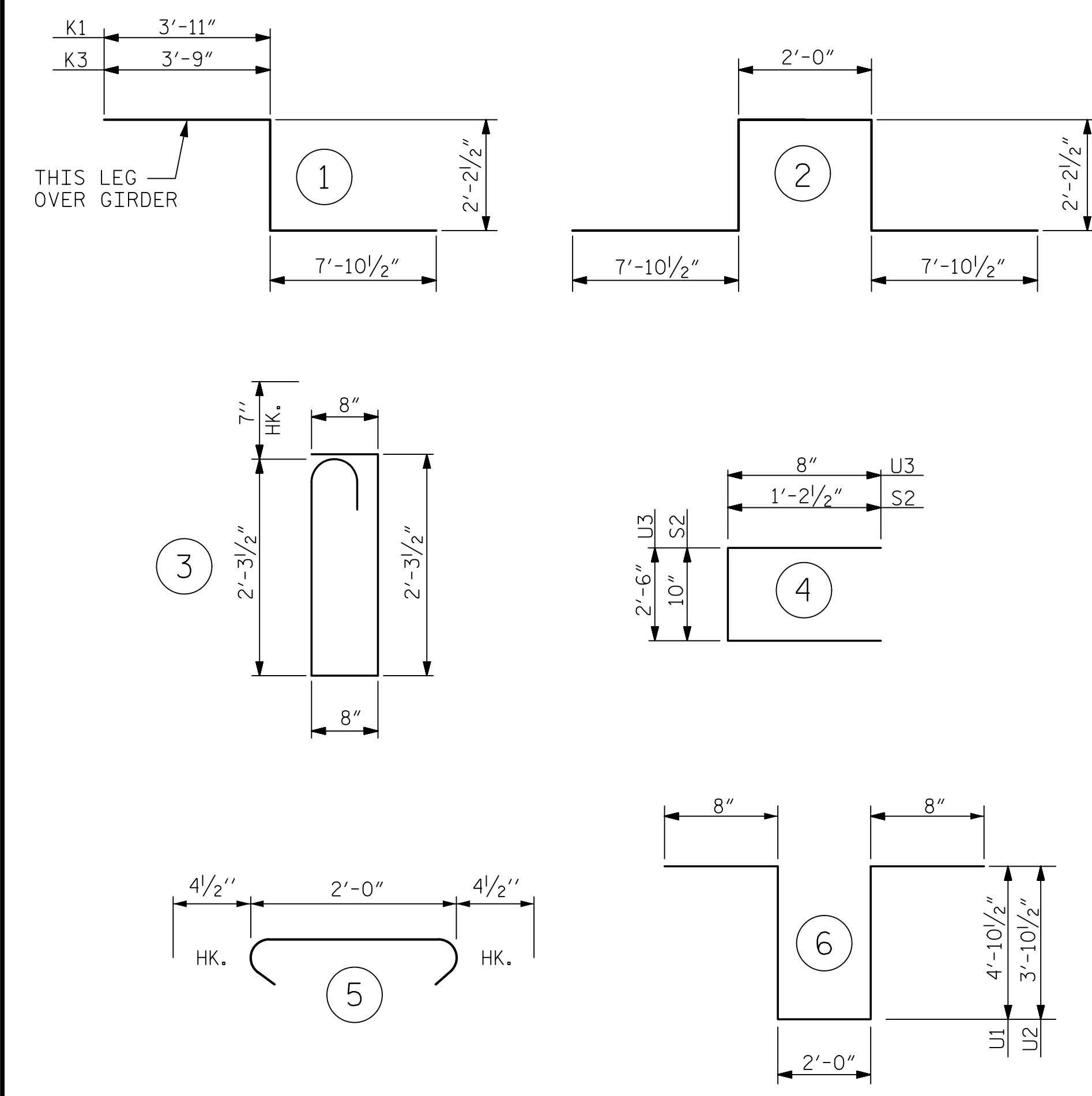

ALL BAR DIMENSIONS ARE OUT TO OUT

**BILL OF MATERIAL**

BAR	NO.	SIZE	TYPE	LENGTH	WEIGHT
* A1	526	#5	STR	31'-2"	17,099
* A2	526	#5	STR	42'-4"	23,225
A3	1,052	#5	STR	36'-6"	40,049
* A101	1	#5	STR	52'-11"	55
* A102	1	#5	STR	33'-4"	35
* A103	1	#5	STR	13'-8"	14
* A104	1	#5	STR	54'-6"	57
* A105	1	#5	STR	34'-10"	36
* A106	1	#5	STR	15'-1"	16
A201	1	#5	STR	52'-11"	55
A202	1	#5	STR	33'-4"	35
A203	1	#5	STR	13'-8"	14
A204	1	#5	STR	54'-6"	57
A205	1	#5	STR	34'-10"	36
A206	1	#5	STR	15'-1"	16
* B1	192	#4	STR	27'-0"	3,463
* B2	48	#4	STR	28'-1"	900
B3	460	#5	STR	50'-3"	24,109
* B4	188	#6	STR	24'-10"	7,012
* B5	96	#6	STR	60'-0"	8,652
* B6	49	#4	STR	36'-4"	1,189
* G1	4	#5	STR	36'-10"	154
* G2	243	#4	STR	7'-3"	1,177
* K1	4	#8	1	14'-0"	150
* K2	20	#8	2	22'-2"	1,184
* K3	4	#8	1	13'-10"	148
* K4	24	#6	STR	8'-9"	315
K5	96	#4	STR	8'-9"	561
K6	24	#4	STR	7'-1"	114
K7	20	#4	STR	33'-3"	444
* S1	132	#5	3	6'-6"	895
* S2	132	#4	4	3'-3"	287
S3	504	#4	5	2'-9"	926
U1	108	#4	6	13'-1"	944
U2	24	#4	6	11'-1"	178
* U3	70	#4	4	3'-10"	179
* EPOXY COATED REINF. STEEL (LBS.)					66,242
REINF. STEEL (LBS.)					67,538

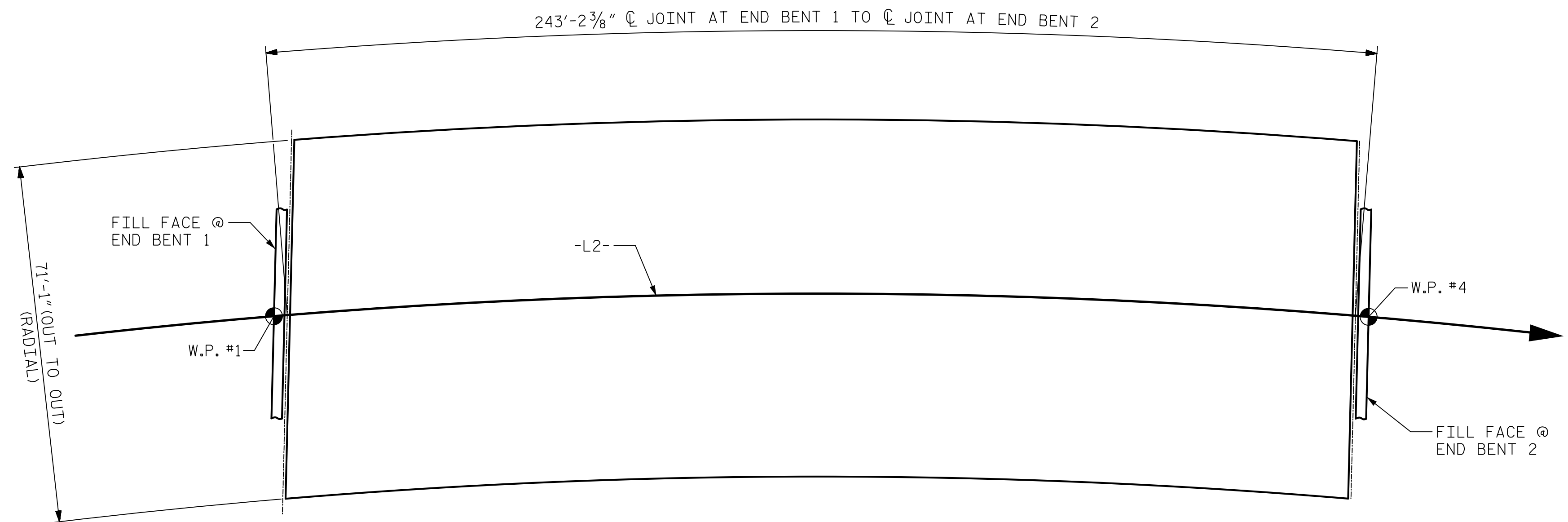

LAYOUT FOR COMPUTING AREA REINFORCED CONCRETE DECK SLAB (SQ. FT. = 17,273)

**GROOVING BRIDGE FLOORS**

APPROACH SLABS	2,549 SQ.FT.
BRIDGE DECK	12,793 SQ.FT.
TOTAL	15,342 SQ.FT.

PROJECT NO. U-5808  
 UNION COUNTY  
 STATION: 55+00.96 -L2-

**Mead & Hunt**  
 111 E. Hargett Street  
 Suite 300  
 Raleigh, NC 27601  
 919-714-8670  
 meadhunt.com  
 NC License No. F-1235

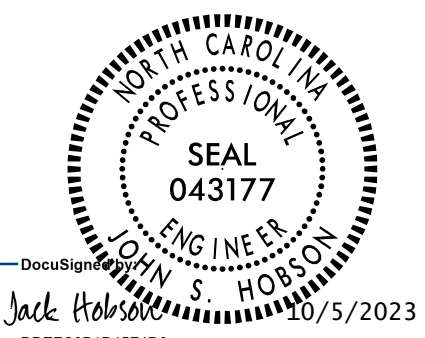

DOCUMENT NOT CONSIDERED FINAL UNLESS ALL SIGNATURES COMPLETED

STATE OF NORTH CAROLINA  
 DEPARTMENT OF TRANSPORTATION  
 RALEIGH  
 STANDARD  
 SUPERSTRUCTURE  
 BILL OF MATERIAL

REVISIONS						SHEET NO.
NO.	BY:	DATE:	NO.	BY:	DATE:	S-37
1			3			TOTAL SHEETS
2			4			56

ASSEMBLED BY :	J.S. HOBSON	DATE :	05/30/23
CHECKED BY :	J.A. BOYER	DATE :	06/29/23
DESIGN E.O.R. :	J.S. HOBSON	DATE :	08/30/23
DRAWN BY :	JMB 5/87	REV. 10/1/11	MAA/GM
CHECKED BY :	SJD 9/87	REV. 12/17	MAA/THC
		REV. 06/19	BNB/THC