

PROJECT REFERENCE NO. <b>U-5808</b>	SHEET NO. <b>7</b>
RW SHEET NO.	
ROADWAY DESIGN ENGINEER	HYDRAULICS ENGINEER
10/4/2023	10/5/2023
<b>DOCUMENT NOT CONSIDERED FINAL UNLESS ALL SIGNATURES COMPLETED</b>	
<b>Mead &amp; Hunt</b>	
111 E. Hargett Street, Suite 300 Raleigh, North Carolina 27601 919-714-8570   meadandhunt.com NC License No. F-1235	

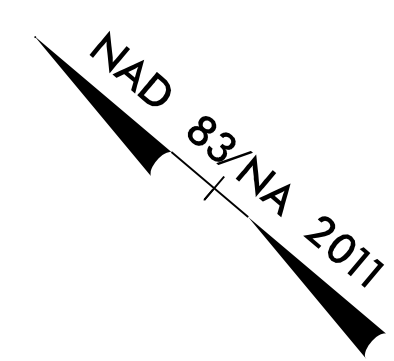

**-Y3WB- CURVE DATA**

PI Sta 12+10.07 Δs = 0' 37" 30.2" Ls = 120.00' LT = 80.00' ST = 40.00'	PI Sta 13+86.73 Δ = 2' 50" 48.0" (RT) D = 1' 02" 30.3" L = 273.26' T = 136.66' R = 5,500.00' e = EXIST.	PI Sta 15+63.33 Δs = 0' 37" 30.2" Ls = 120.00' LT = 80.00' ST = 40.00'
--	---	--

**-Y3- CURVE DATA**

PI Sta 12+80.63 Δ = 7' 22" 56.7" (RT) D = 1' 19" 01.7" L = 560.49' T = 280.63' R = 4,350.00' e = EXIST.
---

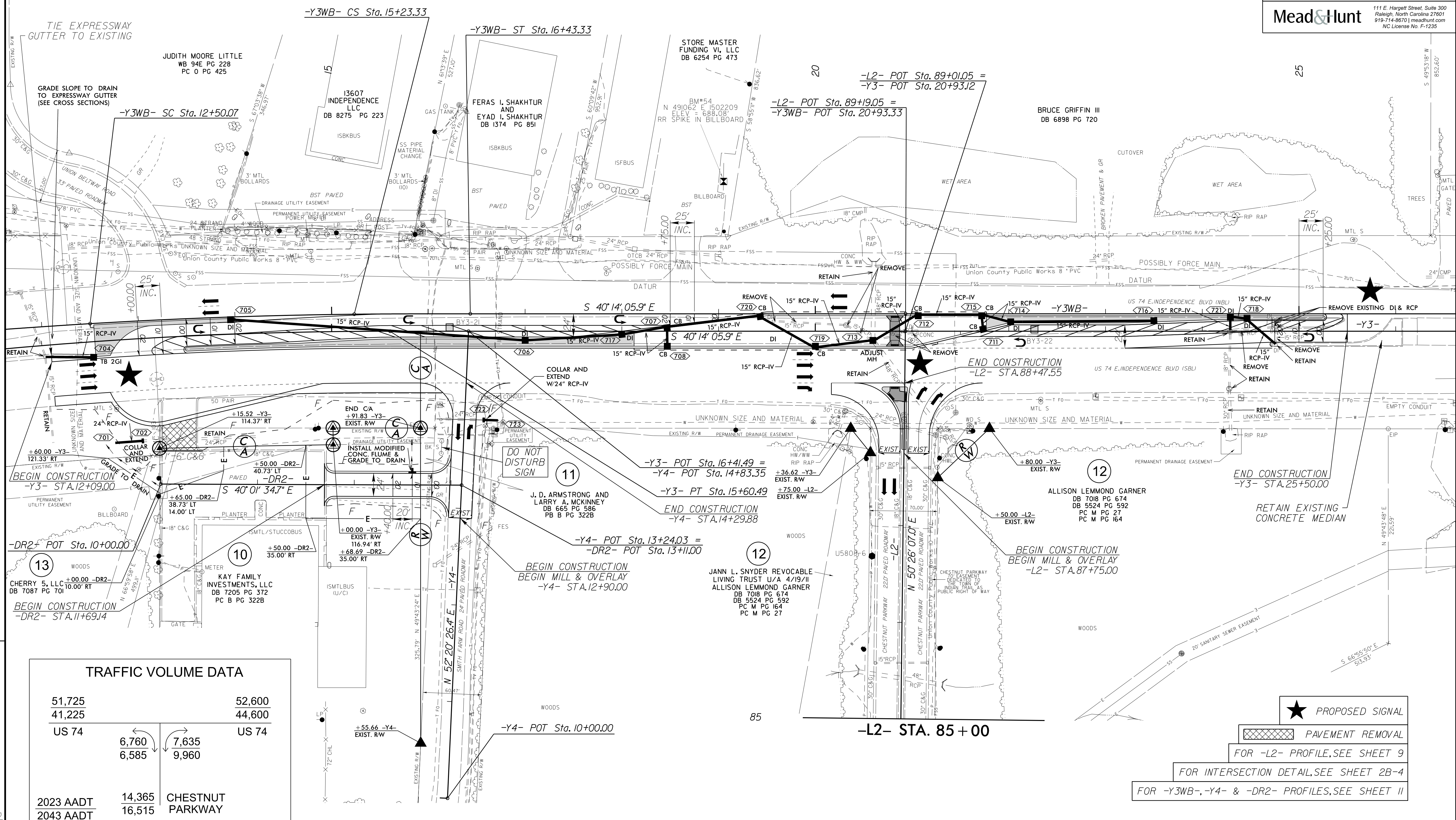

51,725	52,600
41,225	44,600
US 74	US 74
6,760	7,635
6,585	9,960
2023 AADT	CHESTNUT PARKWAY
2043 AADT	14,365
	16,515

★ PROPOSED SIGNAL

▨ PAVEMENT REMOVAL

FOR -L2- PROFILE, SEE SHEET 9

FOR INTERSECTION DETAIL, SEE SHEET 2B-4

FOR -Y3WB-, -Y4- & -DR2- PROFILES, SEE SHEET 11

REVISIONS

04-OCT-2023 16:30  
 X:\4506200\156543\_01\TECH\Roadway\Proj\U5808\_Rdy\_psh\_07.dgn  
 178411d