

PROJECT REFERENCE NO. U-5808		SHEET NO. 4	
ROADWAY DESIGN ENGINEER		HYDRAULICS ENGINEER	
10/4/2023		10/5/2023	
DOCUMENT NOT CONSIDERED FINAL UNLESS ALL SIGNATURES COMPLETED			
Mead&Hunt		111 E. Hargett Street, Suite 300 Raleigh, North Carolina 27601 919-714-8570 meadandhunt.com NC License No. F-1235	

<p>-LI- CURVE DATA</p> <p>PI Sta 42+26.86 $\Delta = 1^\circ 43' 24.8" (LT)$ $D = 0^\circ 57' 17.7"$ $L = 180.49'$ $T = 90.25'$ $R = 6,000.00'$ $e = NC$</p>	<p>-YIA- CURVE DATA</p> <p>PI Sta 10+75.64 $\Delta = 6^\circ 41' 29.4" (LT)$ $D = 14^\circ 19' 26.2"$ $L = 46.72'$ $T = 23.38'$ $R = 400.00'$ $e = EXISTING$</p>	<p>-YIB- CURVE DATA</p> <p>PI Sta 11+87.87 $\Delta = 7^\circ 35' 25.5" (RT)$ $D = 9^\circ 32' 57.5"$ $L = 79.49'$ $T = 39.80'$ $R = 600.00'$ $e = EXISTING$</p>	<p>-L2- CURVE DATA</p> <p>PI Sta 48+68.62 $\Delta = 20^\circ 01' 33.6" (LT)$ $D = 7^\circ 38' 22.0"$ $L = 262.14'$ $T = 132.42'$ $R = 750.00'$ $e = 0.04$ $RO = 152.00'$</p>	<p>-L2- CURVE DATA</p> <p>PI Sta 55+77.17 $\Delta = 42^\circ 12' 08.0" (RT)$ $D = 3^\circ 49' 11.0"$ $L = 1,104.85'$ $T = 578.84'$ $R = 1,500.00'$ $e = 0.03$ $RO = 152.00'$</p>
--	---	--	---	---

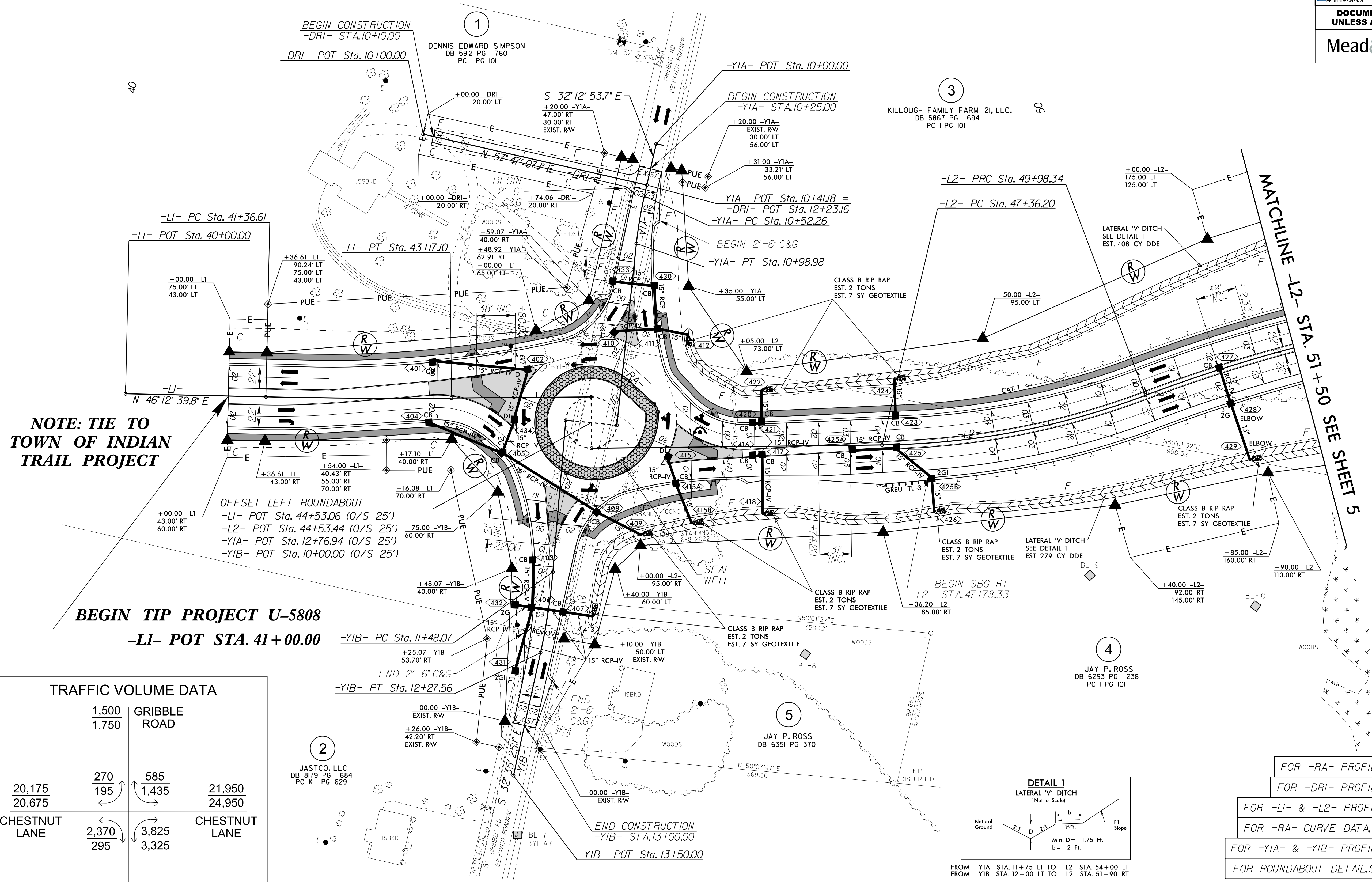

NOTE: TIE TO TOWN OF INDIAN TRAIL PROJECT

BEGIN TIP PROJECT U-5808
-LI- POT STA. 41+00.00

TRAFFIC VOLUME DATA			
	1,500 1,750	GRIBBLE ROAD	
20,175 20,675	270 195	585 1,435	21,950 24,950
CHESTNUT LANE	2,370 295	3,825 3,325	CHESTNUT LANE
2023 AADT 2043 AADT	6,840 3,740	GRIBBLE ROAD	

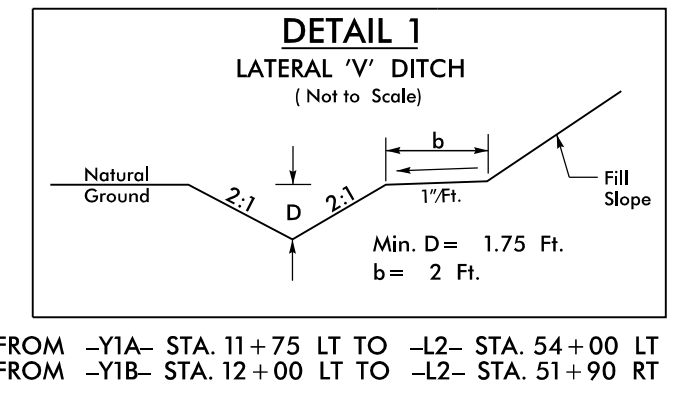

- FOR -RA- PROFILE, SEE SHEET 10
- FOR -DRI- PROFILE, SEE SHEET 10
- FOR -LI- & -L2- PROFILE, SEE SHEET 8
- FOR -RA- CURVE DATA, SEE SHEET 2B-1
- FOR -YIA- & -YIB- PROFILE, SEE SHEET 10
- FOR ROUNDABOUT DETAIL, SEE SHEET 2B-2

04-OCT-2023 16:30
 R:\Roadway\Proj\U5808.Rdy_psh_04.dgn
 17841d