

See Sheet UC-2 For Conventional Symbols

STATE OF NORTH CAROLINA
DIVISION OF HIGHWAYS

PROJECT REFERENCE NO.	SHEET NO.
U-5907	UC-1

DOCUMENT NOT CONSIDERED FINAL
UNLESS ALL SIGNATURES COMPLETED

MECKLENBURG COUNTY

LOCATION: POTTS-SLOAN-BEATTY CONNECTOR (NC-115)

TYPE OF WORK: WATER AND SEWER MAIN RELOCATIONS

*NOTE TO CONTRACTOR: ALL WATER MAINS SHALL BE RESTRAINED JOINT DI PIPE.

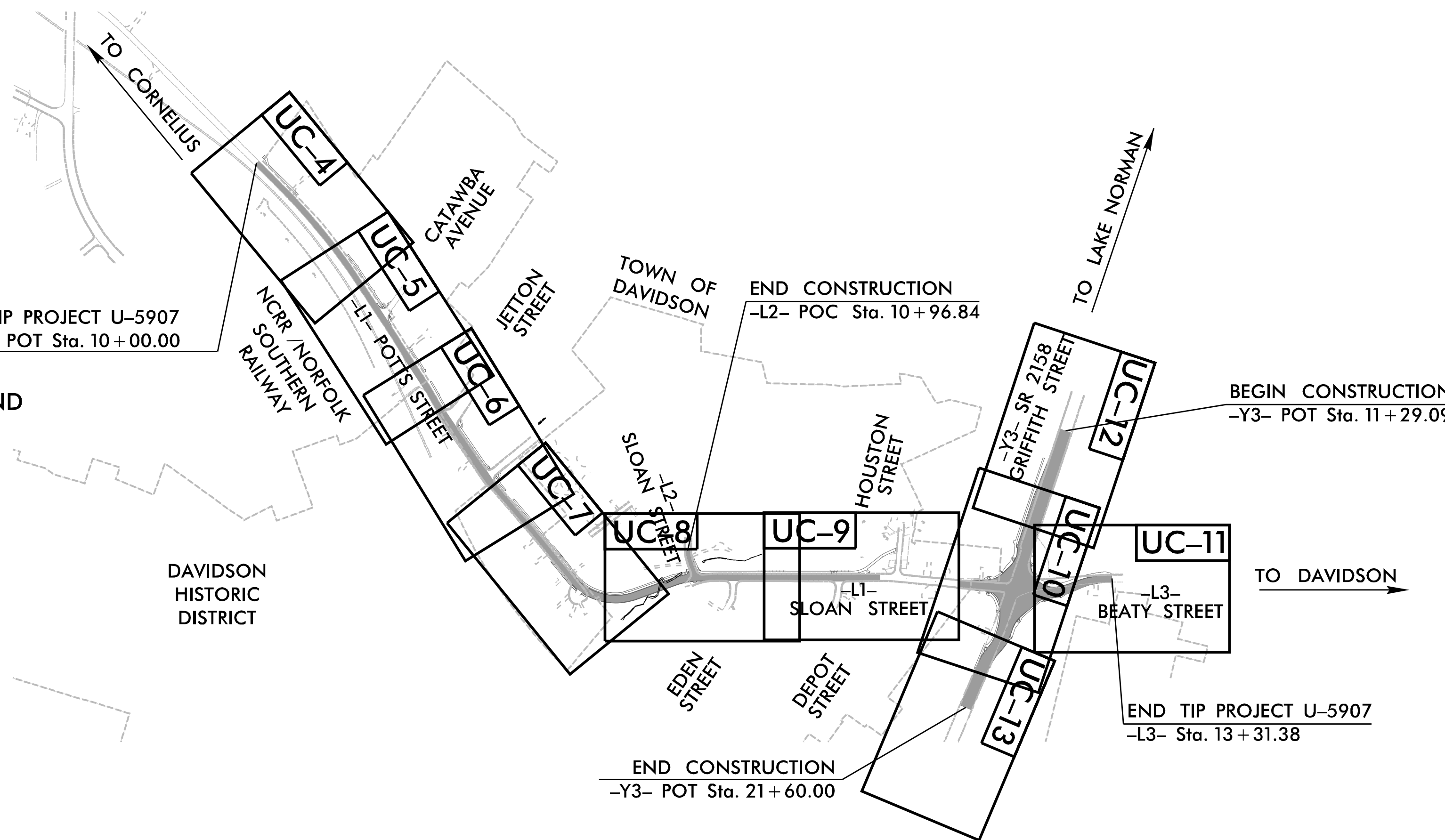
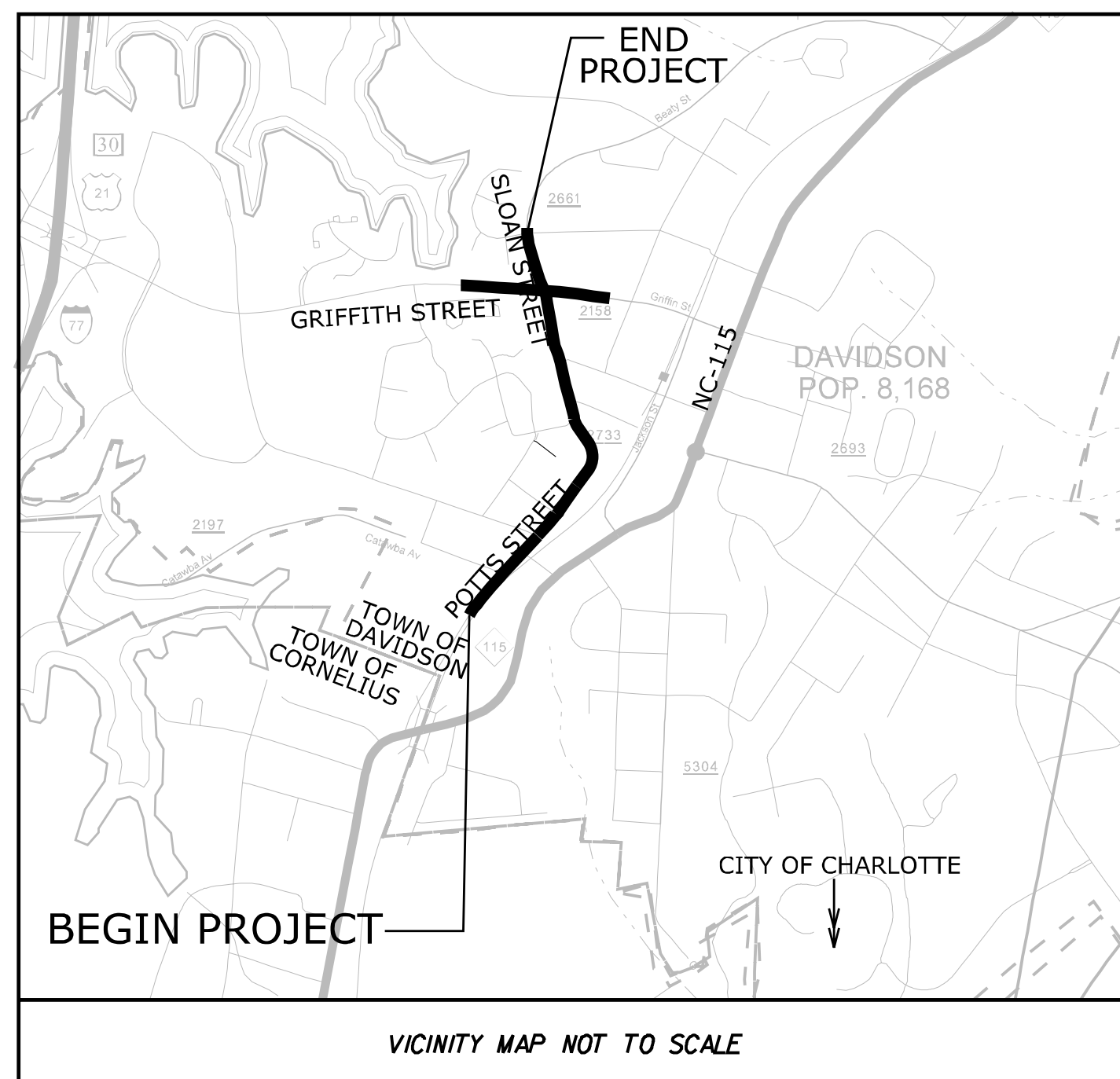

A PORTION OF THIS PROJECT IS LOCATED WITHIN THE MUNICIPAL BOUNDARIES OF THE TOWNS OF DAVIDSON AND CORNELIUS

A PORTION OF THIS PROJECT IS LOCATED WITHIN THE RIGHT-OF-WAY OF NORFOLK SOUTHERN RAILROAD

NCDOT CONTACT:
SEAN EPPERSON, P.E.
NCDOT - DIVISION 10
716 W. MAIN STREET
ALBEMARLE, NC 28001

OWNER:	CONTACT INFORMATION
	CHUCK BLISS, P.E. (704) 336-1012 CBLISS@CI.CHARLOTTE.NC.US
PROJECT ENGINEER:	MATTHEW SHOESMITH, P.E. (704) 954-7490 MATTHEW.SHOESMITH@KIMLEY-HORN.COM 200 SOUTH TRYON STREET, SUITE 200 CHARLOTTE, NORTH CAROLINA 28202

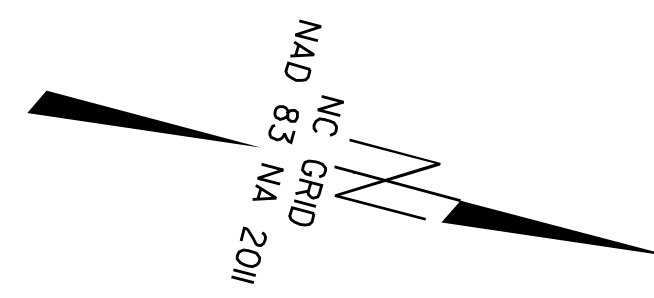

TIP PROJECT: U-5907

CONTRACT:

GRAPHIC SCALES

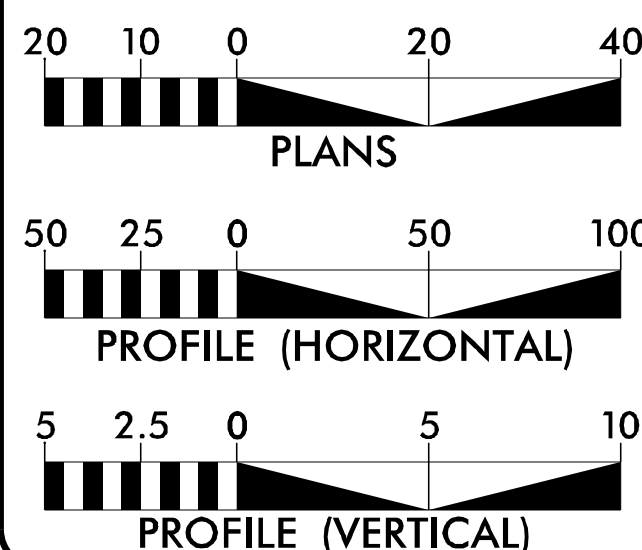

INDEX OF SHEETS

SHEET NO.:	DESCRIPTION:
UC-1	TITLE SHEET
UC-2	NCDOT SYMBOLS
UC-2A	PERMIT SHEET
UC-3	GENERAL NOTES
UC-3A THRU UC-3F	STANDARD DETAILS
UC-4 THRU UC-13	UTILITY CONSTRUCTION PLAN
UC-14 THRU UC-15	UTILITY CONSTRUCTION PROFILE

UTILITY OWNERS

WATER - CHARLOTTE WATER
SEWER - CHARLOTTE WATER

PLANS PREPARED FOR THE NCDOT BY:

2018 STANDARD SPECIFICATIONS

Kimley Horn

NC LICENSE #20102
200 SOUTH TRYON STREET, SUITE 200
CHARLOTTE, NORTH CAROLINA 28202
PHONE: (704) 333-5131

MATTHEW A. SHOESMITH, P.E.
CONSULTANT CONTACT #1

SOPHIA J. JOHNSTON, E.I.
CONSULTANT CONTACT #2

SEAN EPPERSON, P.E.
NCDOT CONTACT

SEAL

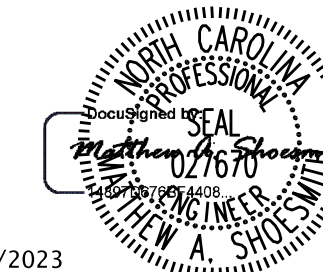

7/17/2023

