

PROJECT REFERENCE NO. U-5907		SHEET NO. 9	
RW SHEET NO.		HYDRAULICS ENGINEER	
ROADWAY DESIGN ENGINEER		SEAL 037923	
FRANK W. MASTERS, III		SEAL 032615	
10/23/2023		10/26/2023	
DOCUMENT NOT CONSIDERED FINAL UNLESS ALL SIGNATURES COMPLETED			

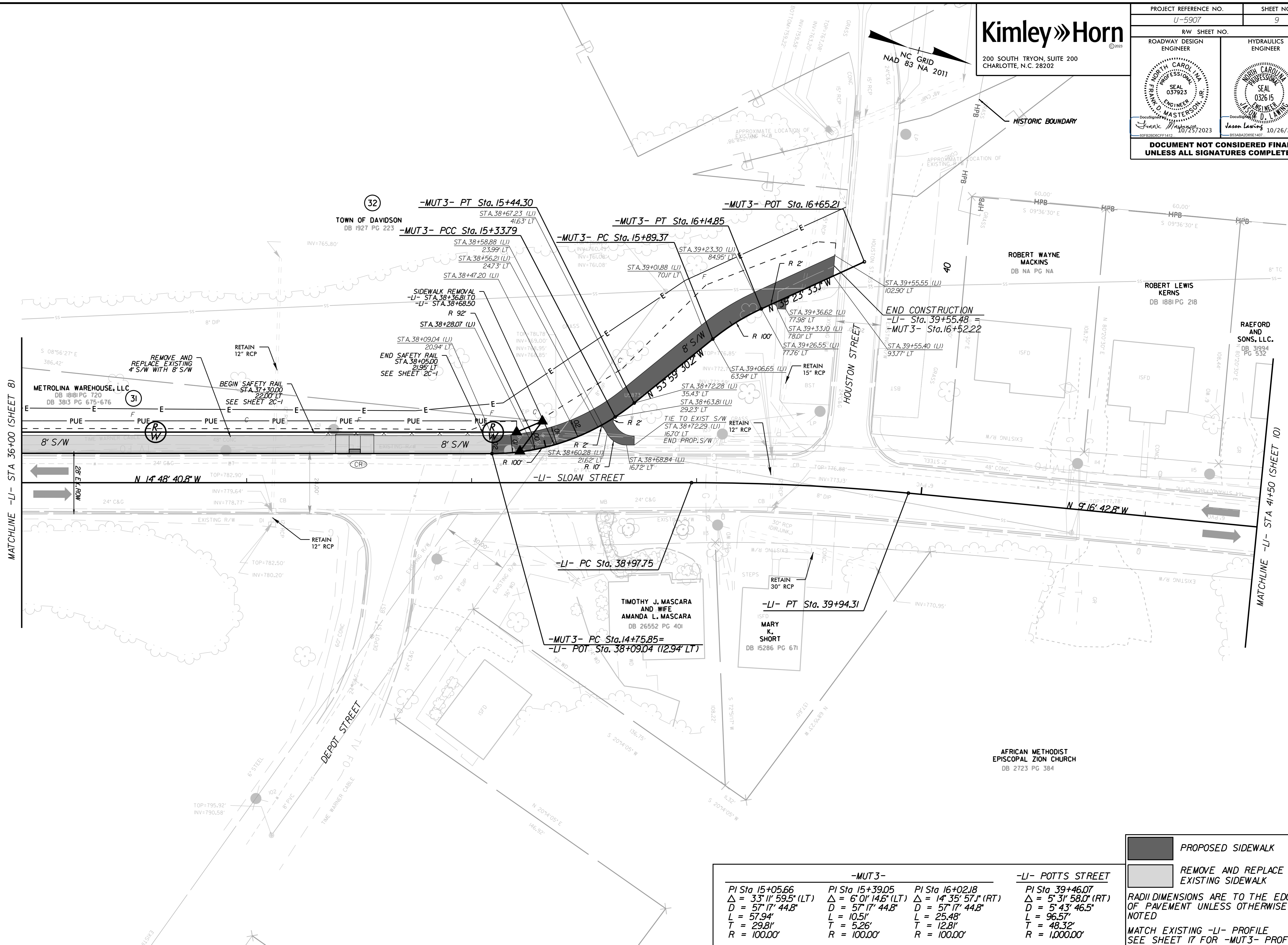

MATCHLINE -LI- STA 36+00 (SHEET 8)

MATCHLINE -LI- STA 41+50 (SHEET 10)

-MUT3-			-LI- POTTS STREET
PI Sta 15+05.66	PI Sta 15+39.05	PI Sta 16+02.18	PI Sta 39+46.07
$\Delta = 33' 11'' 59.5'' (LT)$	$\Delta = 6' 01'' 14.6'' (LT)$	$\Delta = 14' 35'' 57.1'' (RT)$	$\Delta = 5' 31'' 58.0'' (RT)$
D = 57' 17'' 44.8"	D = 57' 17'' 44.8"	D = 57' 17'' 44.8"	D = 5' 43'' 46.5"
L = 57.94'	L = 10.51'	L = 25.48'	L = 96.57'
T = 29.81'	T = 5.26'	T = 12.81'	T = 48.32'
R = 100.00'	R = 100.00'	R = 100.00'	R = 1,000.00'

PROPOSED SIDEWALK

REMOVE AND REPLACE EXISTING SIDEWALK

RADI DIMENSIONS ARE TO THE EDGE OF PAVEMENT UNLESS OTHERWISE NOTED

MATCH EXISTING -LI- PROFILE SEE SHEET 17 FOR -MUT3- PROFILE