

PROJECT REFERENCE NO. U-5907		SHEET NO. 7	
RW SHEET NO.		HYDRAULICS ENGINEER	
ROADWAY DESIGN ENGINEER		SEAL 037923	
FRANK D. MASTERS, P.E.		SEAL 032615	
10/25/2023		10/26/2023	
DOCUMENT NOT CONSIDERED FINAL UNLESS ALL SIGNATURES COMPLETED			

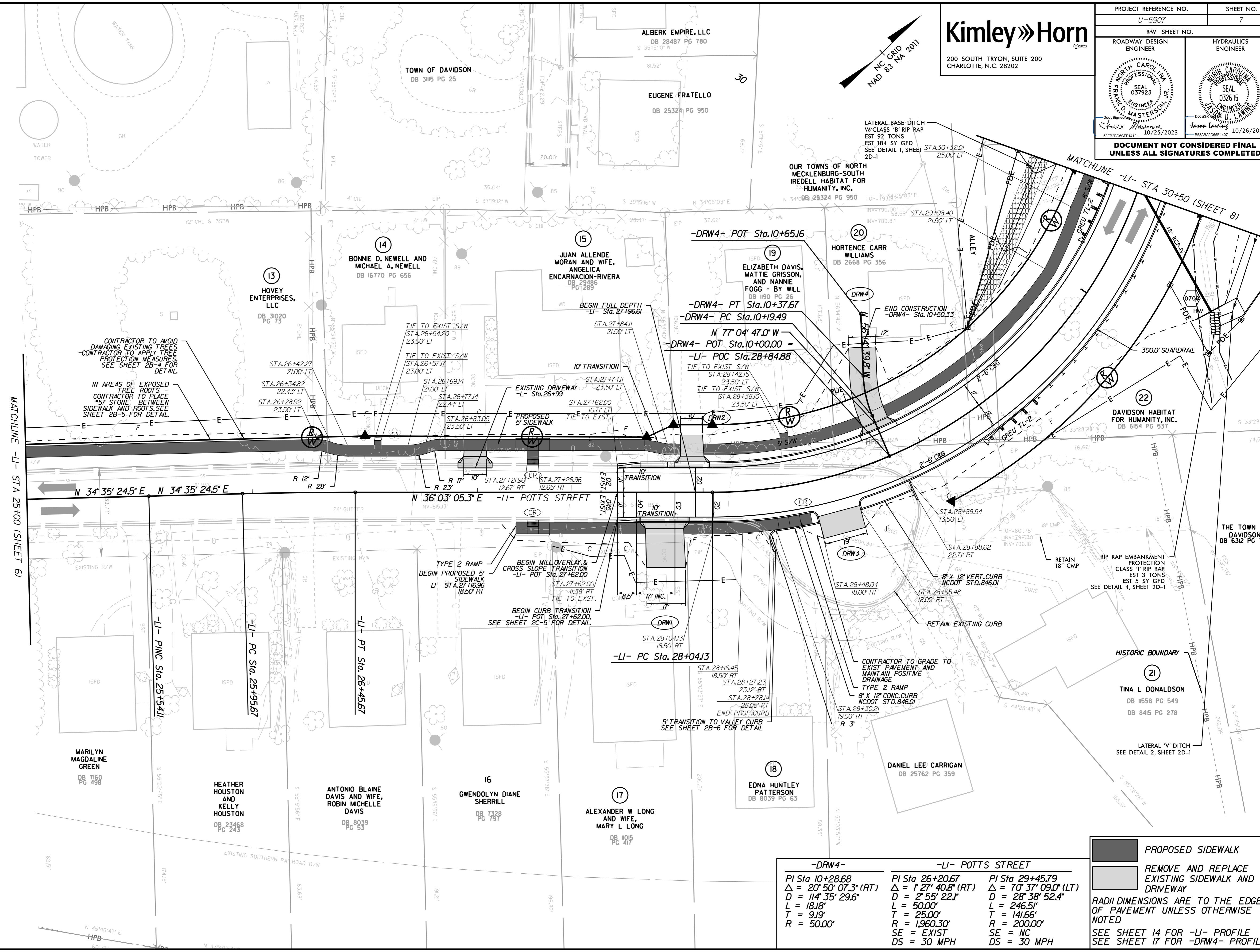
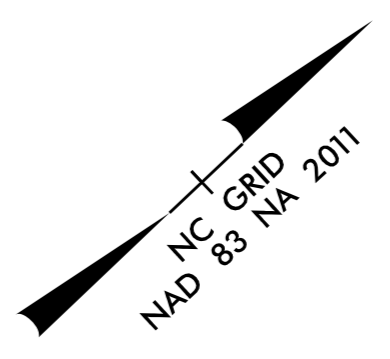

MATCHLINE -LI- STA 25+00 (SHEET 6)

MATCHLINE -LI- STA 30+50 (SHEET 8)

-DRW4-		-LI- POTTS STREET	
PI Sta 10+28.68	PI Sta 26+20.67	PI Sta 29+45.79	
$\Delta = 20' 50' 07.3''$ (RT)	$\Delta = 1' 27' 40.8''$ (RT)	$\Delta = 70' 37' 09.0''$ (LT)	
D = 114' 35' 29.6"	D = 2' 55' 22.1"	D = 28' 38' 52.4"	
L = 18.18'	L = 50.00'	L = 246.51'	
T = 9.19'	T = 25.00'	T = 141.66'	
R = 50.00'	R = 1,960.30'	R = 200.00'	
SE = EXIST	SE = NC	SE = NC	
DS = 30 MPH	DS = 30 MPH	DS = 30 MPH	

**PROPOSED SIDEWALK**

**REMOVE AND REPLACE EXISTING SIDEWALK AND DRIVEWAY**

RADI DIMENSIONS ARE TO THE EDGE OF PAVEMENT UNLESS OTHERWISE NOTED

SEE SHEET 14 FOR -LI- PROFILE

SEE SHEET 17 FOR -DRW4- PROFILE

CONTRACTOR TO AVOID DAMAGING EXISTING TREES - CONTRACTOR TO APPLY TREE PROTECTION MEASURES - SEE SHEET 2B-4 FOR DETAIL

IN AREAS OF EXPOSED TREE ROOTS - CONTRACTOR TO PLACE #57 STONE BETWEEN SIDEWALK AND ROOTS. SEE SHEET 2B-5 FOR DETAIL.

TYPE 2 RAMP  
BEGIN PROPOSED 5' SIDEWALK  
-LI- STA 27+46.36  
18.50' RT

BEGIN MILL OVERLAY & CROSS SLOPE TRANSITION  
-LI- POT Sta. 27+62.00

BEGIN CURB TRANSITION  
-LI- POT Sta. 27+62.00  
SEE SHEET 2C-5 FOR DETAIL.

CONTRACTOR TO GRADE TO EXIST PAVEMENT AND MAINTAIN POSITIVE DRAINAGE

TYPE 2 RAMP  
8" X 12" CONC. CURB  
NCDOT STD. 846.01

STA. 28+30.21  
19.00' RT  
R 3'

RIP RAP EMBANKMENT PROTECTION  
CLASS '1' RIP RAP  
EST 3 TONS  
EST 5 SY GFD  
SEE DETAIL 4, SHEET 2D-1

