

5/14/2023

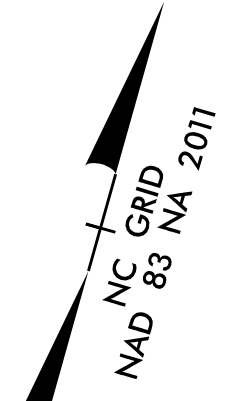

-Y6- DRIVEWAY GEOMETRY SHEET

Kimley»Horn

NC LICENSE #F-0102
200 SOUTH TRYON, SUITE 200
CHARLOTTE, N.C. 28202

PROJECT REFERENCE NO. U-5873	SHEET NO. 2B-3
RW SHEET NO.	
ROADWAY DESIGN ENGINEER	HYDRAULICS ENGINEER
DocuSigned by: Frank M. Johnson 11/10/24/2023	DocuSigned by: Jason Lawing 11/10/25/2023
DOCUMENT NOT CONSIDERED FINAL UNLESS ALL SIGNATURES COMPLETED	

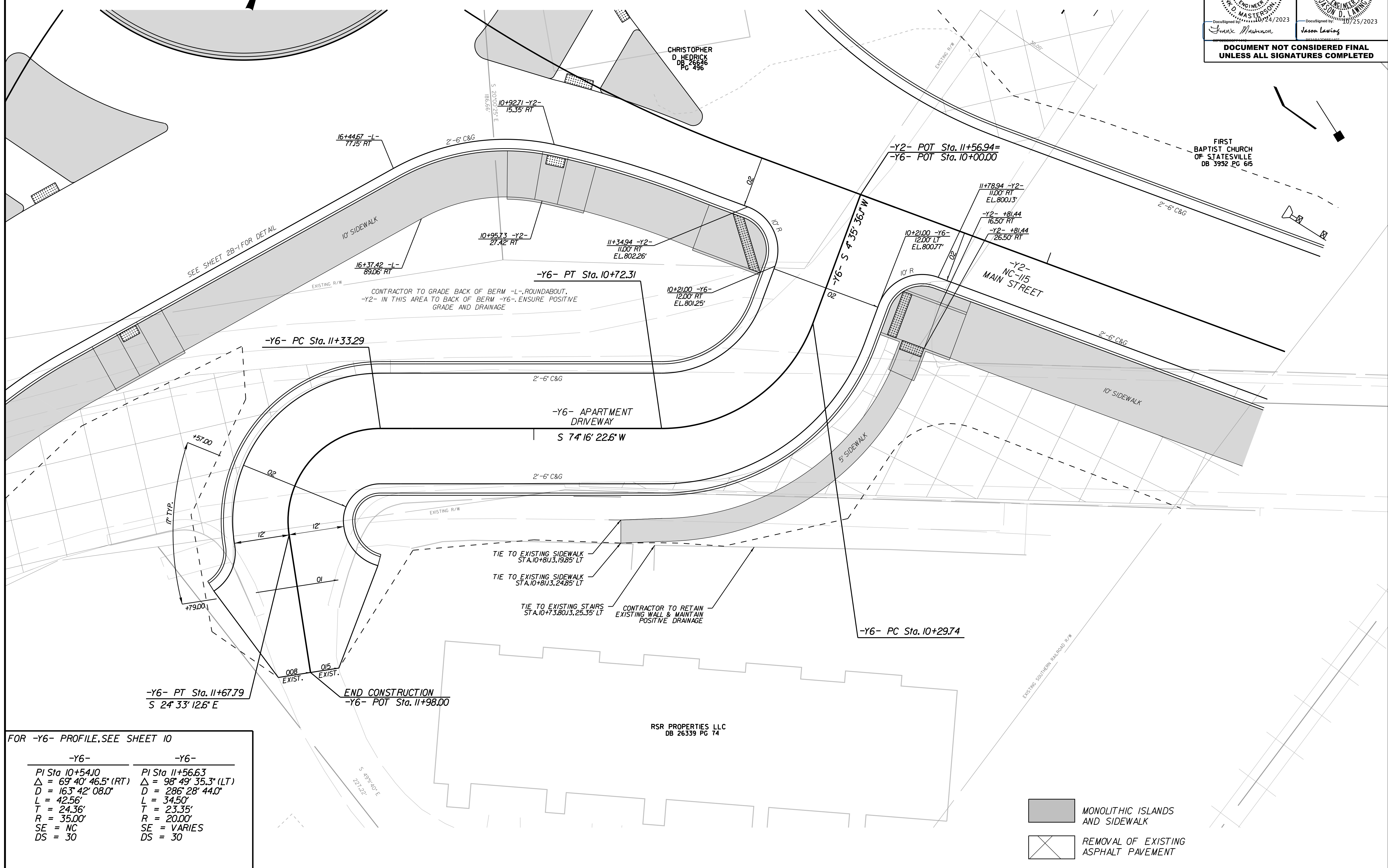

FOR -Y6- PROFILE, SEE SHEET 10

-Y6-	-Y6-
PI Sta 10+54.10	PI Sta 11+56.63
$\Delta = 69^\circ 40' 46.5" (RT)$	$\Delta = 98^\circ 49' 35.3" (LT)$
$D = 163' 42" 08.0"$	$D = 286' 28' 44.0"$
$L = 42.56'$	$L = 34.50'$
$T = 24.36'$	$T = 23.35'$
$R = 35.00'$	$R = 20.00'$
SE = NC	SE = VARIES
DS = 30	DS = 30

- MONOLITHIC ISLANDS AND SIDEWALK
- REMOVAL OF EXISTING ASPHALT PAVEMENT

10/6/2023