

B.17/99

PROPOSED RETAINING WALL #8

RETAINING WALL #8 (-WALL8-) LENGTH = 102.00'

GEOTECHNICAL ENGINEER

ENGINEER

SEAL 045672

THOMAS J. DAILY

DocuSigned by: Thomas J. Daily 3/31/2023

SIGNATURE DATE SIGNATURE DATE

DOCUMENT NOT CONSIDERED FINAL UNLESS ALL SIGNATURES COMPLETED



(ENGLISH)

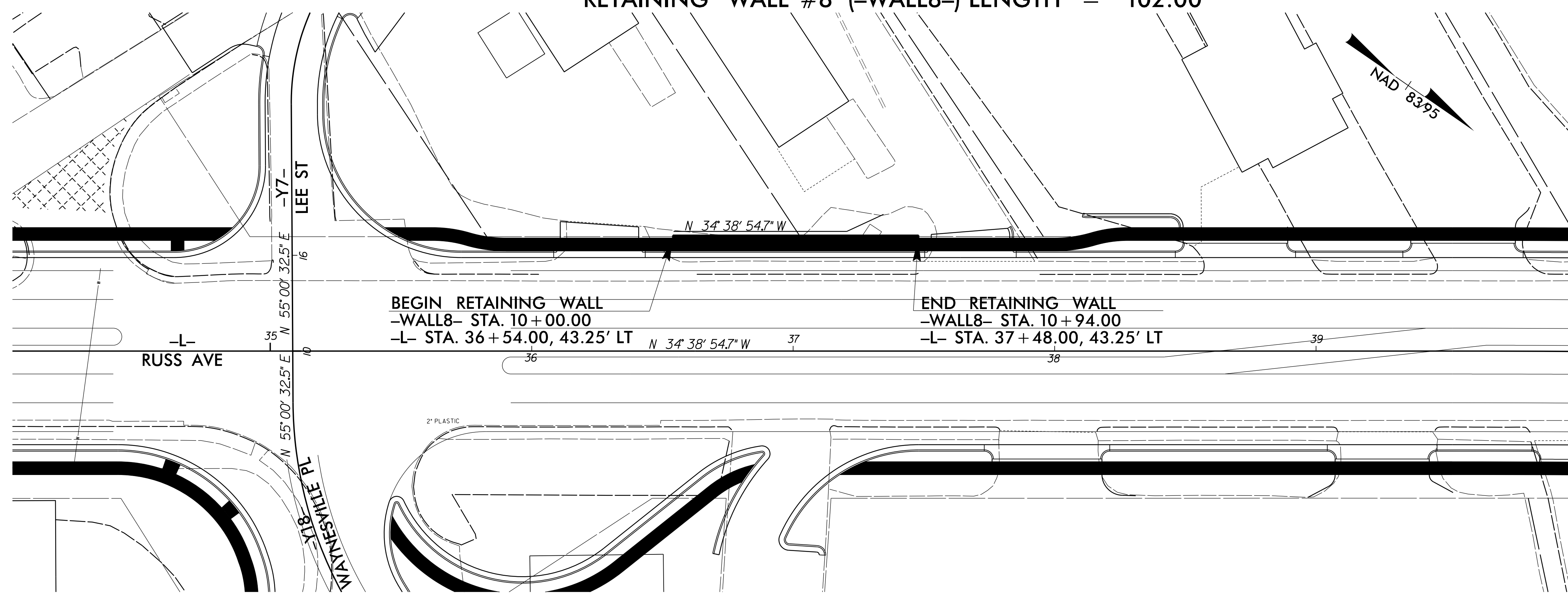

■ CONCRETE SIDEWALK / MEDIAN

NOTES:
SEE SHEET 27 FOR -L- PROFILE
SEE SHEET 9 FOR PLANS
SEE SHEET X-10 FOR CROSS SECTIONS

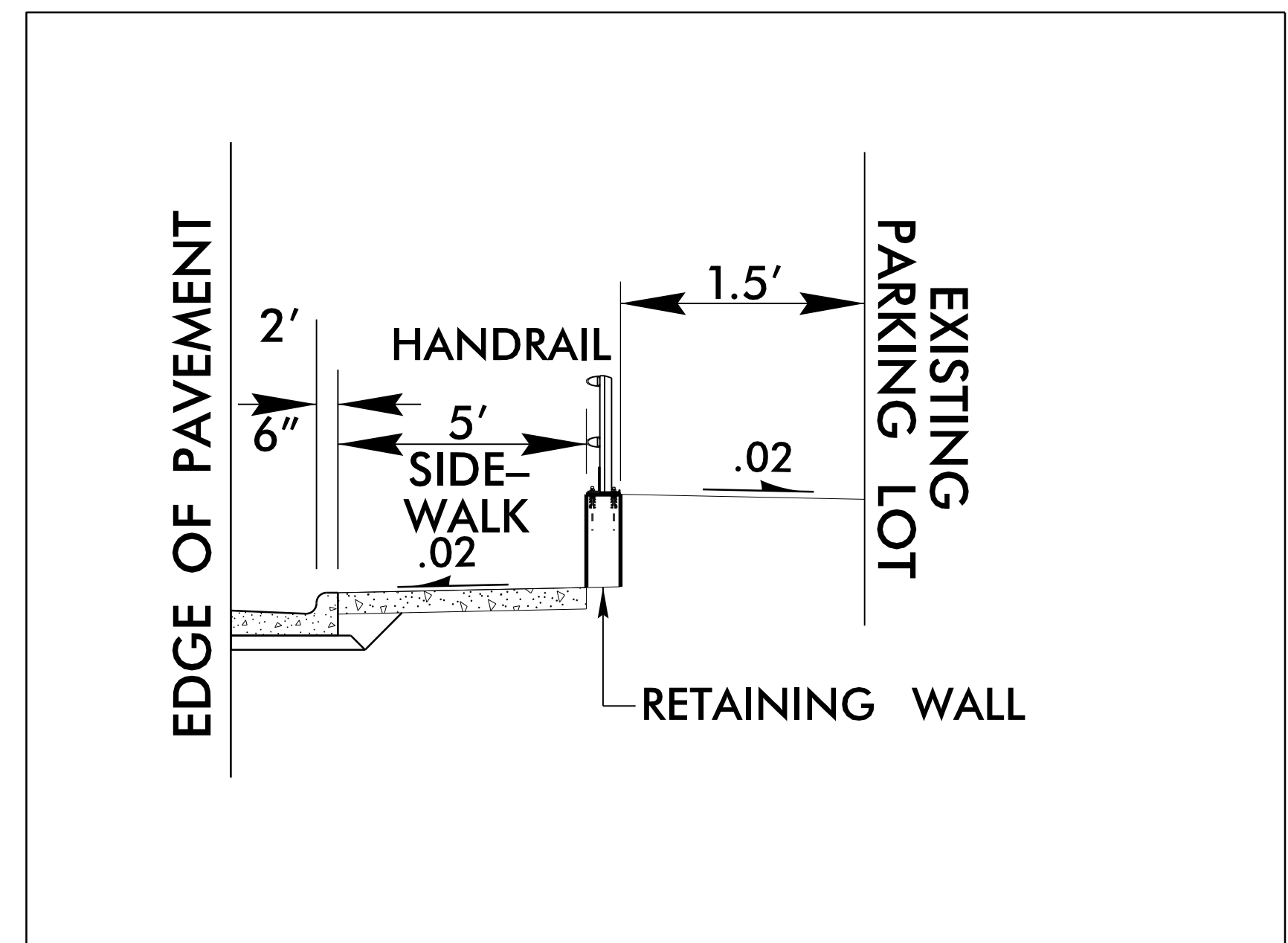
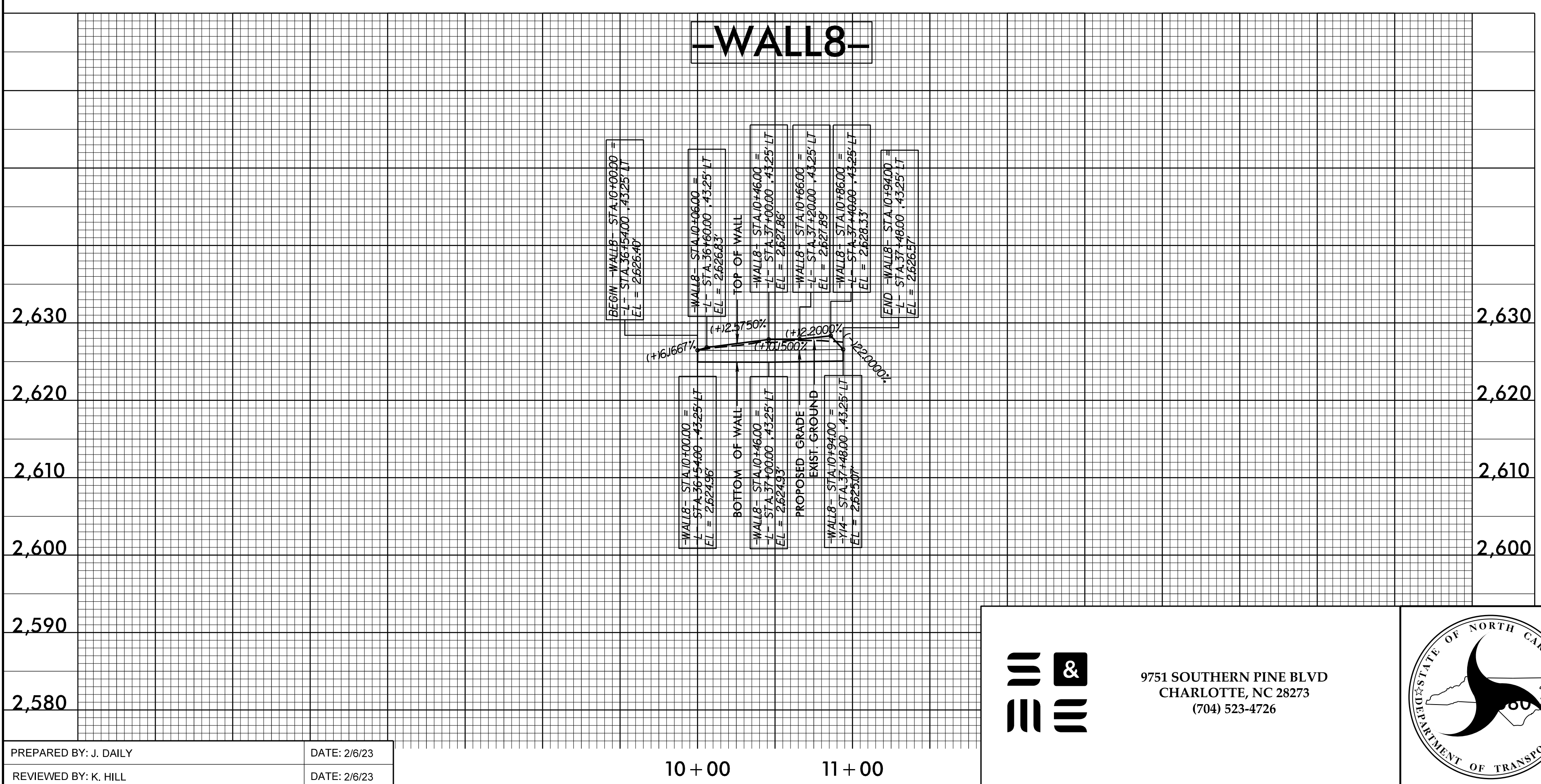

PROJECT NO.: U-5839

HAYWOOD COUNTY

9751 SOUTHERN PINE BLVD
CHARLOTTE, NC 28273
(704) 523-4726

NORTH CAROLINA
DEPARTMENT OF TRANSPORTATION
DIVISION OF HIGHWAYS

GEOTECHNICAL
ENGINEERING UNIT

RETAINING WALL NO. 8

REVISIONS						SHEET NO.
NO.	BY	DATE	NO.	BY	DATE	
1			3			W-7
2			4			

SYTIME
UNITS
\$

PREPARED BY: J. DAILY DATE: 2/6/23

REVIEWED BY: K. HILL DATE: 2/6/23

10 + 00 11 + 00