

07-FEB-2023 13:20 S:\server\Files\PROJECTS\2015\A2015803.00 Mulkey - U-5839\Design\Utilities\Str_Attachments\Proj\Bridges Railroad Att Conduit Attachment\U5939_Ut_tsh_RB_ATT_Conduit_Attach_SUI_psh.dgn

TIP PROJECT: U-5839

See Sheet 1A For Index of Sheets

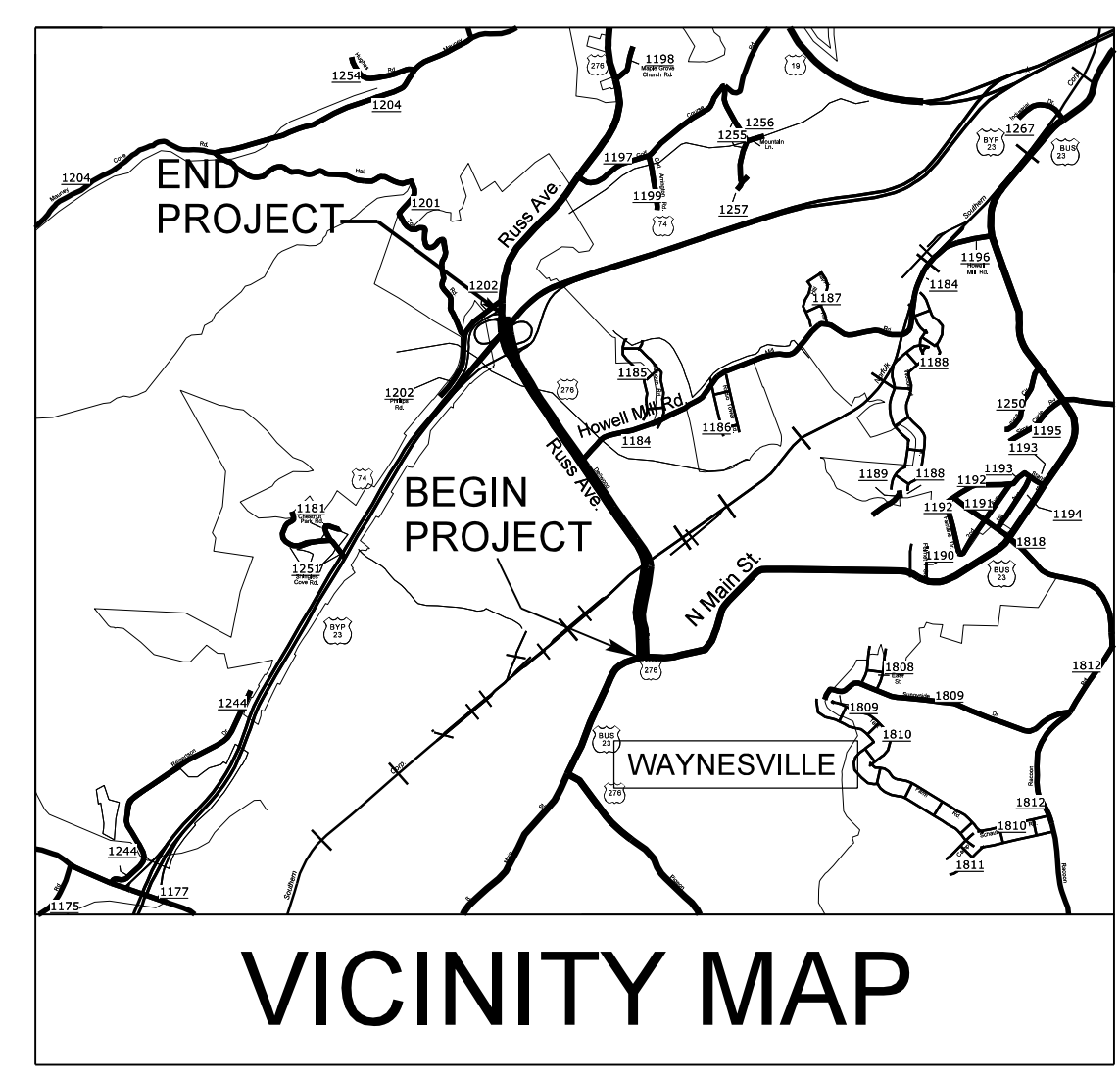

VICINITY MAP

STATE OF NORTH CAROLINA
DIVISION OF HIGHWAYS

**STRUCTURE UTILITIES PLANS
HAYWOOD COUNTY**

LOCATION: RUSS AVE-US 276 FROM US 23 73 (GREAT SMOKY MOUNTAINS EXPWY) RO US 23 BUS (N MAIN ST)

TYPE OF WORK: AT&T CONDUIT ATTACHMENTS TO THE BRIDGES OVER THE RAILROAD AND RICHLAND CREEK

T.I.P. NO.	SHEET NO.
U-5839	SU-1

BEGIN TIP PROJECT U-5839
-L- POT STA. 10+19.45

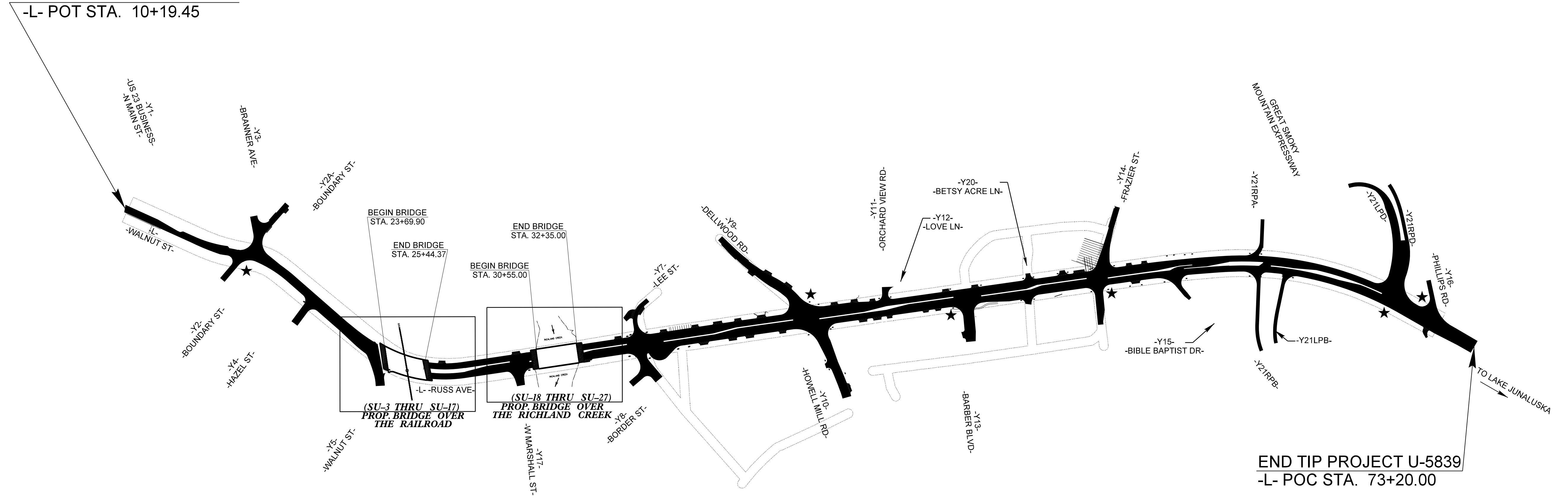

END TIP PROJECT U-5839
-L- POC STA. 73+20.00

CLEARING ON THIS PROJECT SHALL BE PERFORMED TO THE LIMITS ESTABLISHED BY METHOD II.
THIS PROJECT IS WITHIN THE MUNICIPAL BOUNDARIES OF GREENVILLE.

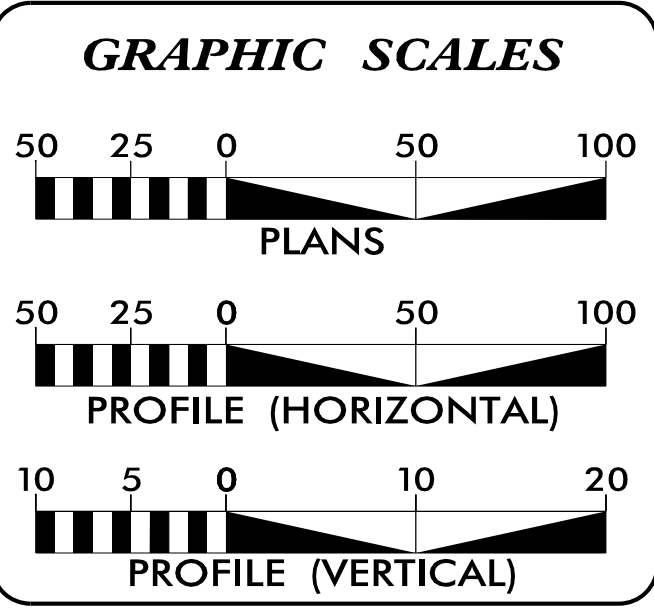

INDEX OF SHEETS	
SHEET NO.	DESCRIPTION
SU-1	TITLE SHEET
SU-2	UTILITY SYMBOLOGY
SU-3 THRU SU-16	9-4" PVC CONDUITS ATTACHED TO RAILROAD BRIDGE PLAN SHEETS
SU-17 THRU SU-26	9-4" PVC CONDUITS ATTACHED TO RICHLAND CREEK BRIDGE PLAN SHEETS

CONDUITS OWNERS ON PROJECT

(A) AT&T COMMUNICATIONS

PREPARED IN THE OFFICE OF:

HINDE ENGINEERING

License No. C-2639
401 Harrison Oaks Blvd., Suite 220 Cary, NC 27513
Ph. (919) 653-0001

Clint L. Stevens, P.E. UTILITIES PROJECT MANAGER
Corey D. Bousquet, P.E. UTILITIES PROJECT ENGINEER
Jordan K. Chapman UTILITIES PROJECT DESIGNER

SEAL

3/9/2023

DIVISION OF HIGHWAYS UTILITIES UNIT
1555 MAIL SERVICES CENTER
RALEIGH NC 27699-1555
PHONE (919) 707-6690
FAX (919) 250-4151

Wanda Austin, P.E. UTILITIES REGIONAL ENGINEER
Mitchell Bishop, P.E. UTILITIES ENGINEER
Nathan Tanner, PE UTILITIES AREA COORDINATOR
Bob Golding UTILITIES COORDINATOR