

PLAN OF MONOLITHIC CONCRETE ISLAND

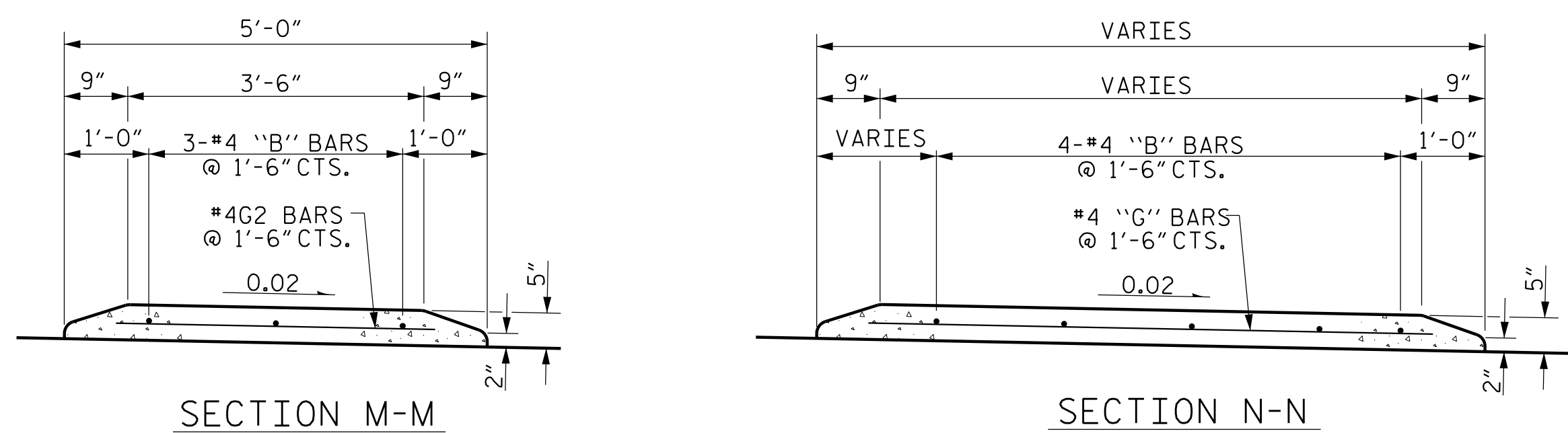

SECTION M-M

SECTION N-N

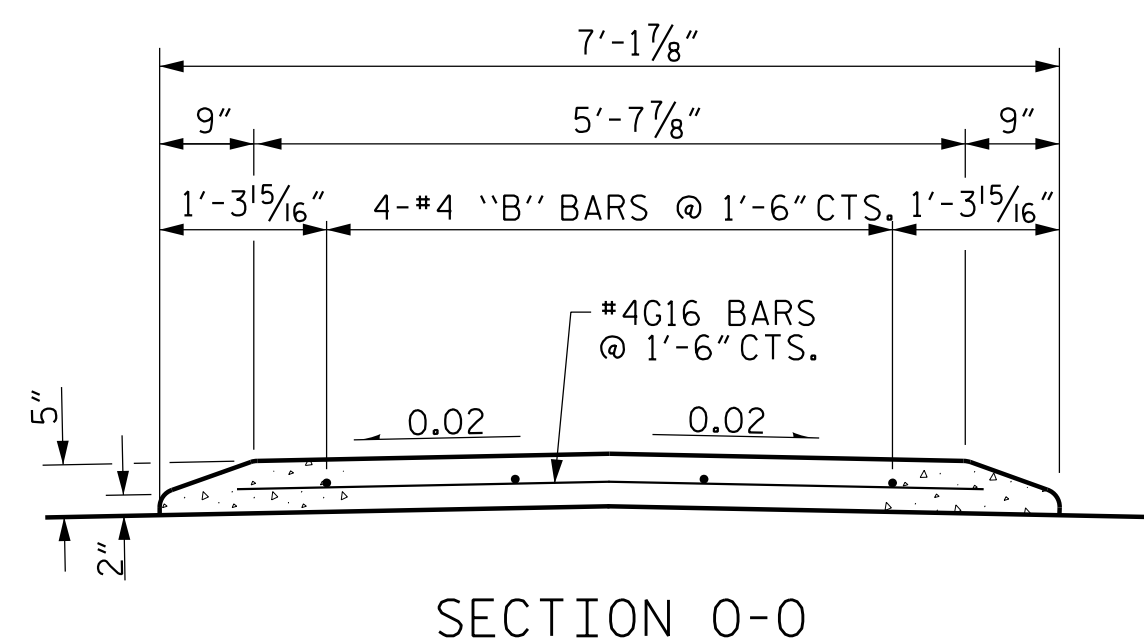

SECTION O-O

SECTIONS THRU MONOLITHIC CONCRETE ISLAND

BILL OF MATERIAL					
BAR	NO.	SIZE	TYPE	LENGTH	WEIGHT
* B8	8	#4	STR	31'-3"	167
* B9	4	#4	STR	35'-1"	94
* B10	4	#4	STR	32'-4"	86
* B11	2	#4	STR	32'-9"	44
* B12	2	#4	STR	24'-10"	33
* G2	76	#4	STR	3'-8"	186
* G3	1	#4	STR	3'-7"	2
* G4	1	#4	STR	3'-9"	3
* G5	1	#4	STR	3'-11"	3
* G6	1	#4	STR	4'-1"	3
* G7	1	#4	STR	4'-3"	3
* G8	1	#4	STR	4'-5"	3
* G9	1	#4	STR	4'-7"	3
* G10	1	#4	STR	4'-9"	3
* G11	1	#4	STR	4'-11"	3
* G12	1	#4	STR	5'-1"	3
* G13	1	#4	STR	5'-3"	4
* G14	1	#4	STR	5'-5"	4
* G15	1	#4	STR	5'-7"	4
* G16	31	#4	STR	5'-9"	119
* EPOXY COATED REINF. STEEL					770 LBS.
CLASS AA CONCRETE					14.5 CU. YDS.

* INDICATES EPOXY COATED REINF. STEEL

NOTES

GROOVED CONTRACTION JOINTS, 1/2" IN DEPTH, SHALL BE TOOLED IN ALL EXPOSED FACES OF THE MONOLITHIC CONCRETE ISLAND IN ACCORDANCE WITH ARTICLE 825-10(B) OF THE STANDARD SPECIFICATIONS. THE CONTRACTION JOINTS SHALL BE LOCATED AT A SPACING OF 8 FEET TO 10 FEET BETWEEN EXPANSION JOINTS. NO CONTRACTION JOINTS WILL BE REQUIRED FOR SEGMENTS LESS THAN 10 FEET IN LENGTH.

PAYMENT FOR THE MONOLITHIC CONCRETE ISLAND SHALL BE INCLUDED IN UNIT PRICE FOR "REINFORCED CONCRETE DECK SLAB"

ALL REINFORCING STEEL IN THE MONOLITHIC CONCRETE ISLAND SHALL BE EPOXY COATED.

PROJECT NO. U-5839
HAYWOOD COUNTY
 STATION: 31+45.00 -L- POT

STATE OF NORTH CAROLINA
 DEPARTMENT OF TRANSPORTATION
 RALEIGH
 SUPERSTRUCTURE
**MONOLITHIC
 CONCRETE ISLAND
 PLAN AND DETAILS**

REVISIONS

NO.	BY:	DATE:	NO.	BY:	DATE:
1			3		
2			4		

SHEET NO.
S2-15
 TOTAL SHEETS
 49

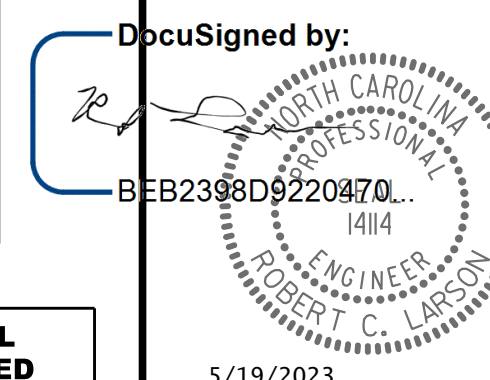

**DOCUMENT NOT CONSIDERED FINAL
 UNLESS ALL SIGNATURES COMPLETED**

5/19/2023

5/17/2023 7:03:20 PM R:\Structures\Bridges\over Richard Creek\15 U5839_SMI_M0_43086.dgn

DRAWN BY: W. B. ALLEN DATE: 5/19
 CHECKED BY: Z. H. BROWN DATE: 7/19
 DESIGN ENGINEER OF RECORD: R. C. LARSON DATE: 2/23

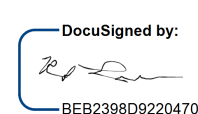

BEB2398D9220470...