

**PLAN OF MONOLITHIC CONCRETE ISLAND**

\* DENOTES RADIAL DIMENSION

**NOTES**

GROOVED CONTRACTION JOINTS, 1/2" IN DEPTH, SHALL BE TOOLED IN ALL EXPOSED FACES OF THE MONOLITHIC CONCRETE ISLAND IN ACCORDANCE WITH ARTICLE 825-10(B) OF THE STANDARD SPECIFICATIONS. THE CONTRACTION JOINTS SHALL BE LOCATED AT A SPACING OF 8 FEET TO 10 FEET BETWEEN EXPANSION JOINTS. NO CONTRACTION JOINTS WILL BE REQUIRED FOR SEGMENTS LESS THAN 10 FEET IN LENGTH.

PAYMENT FOR THE MONOLITHIC CONCRETE ISLAND SHALL BE INCLUDED IN UNIT PRICE FOR "REINFORCED CONCRETE DECK SLAB"

ALL REINFORCING STEEL IN THE MONOLITHIC CONCRETE ISLAND SHALL BE EPOXY COATED.

BILL OF MATERIAL											
BAR	NO.	SIZE	TYPE	LENGTH	WEIGHT	BAR	NO.	SIZE	TYPE	LENGTH	WEIGHT
* B49	15	#4	STR	35'-8"	357	* G43	1	#4	STR	8'-4"	6
* B50	2	#4	STR	30'-9"	41	* G44	1	#4	STR	8'-6"	6
* B51	2	#4	STR	26'-3"	35	* G45	1	#4	STR	8'-9"	6
* B52	2	#4	STR	21'-3"	28	* G46	1	#4	STR	9'-0"	6
* B53	1	#4	STR	28'-8"	19	* G47	1	#4	STR	9'-2"	6
* B54	1	#4	STR	17'-4"	12	* G48	1	#4	STR	9'-5"	6
* B55	1	#4	STR	2'-6"	2	* G49	1	#4	STR	9'-7"	6
						* G50	1	#4	STR	9'-10"	7
* G24	67	#4	STR	3'-8"	164	* G51	1	#4	STR	10'-0"	7
* G25	1	#4	STR	3'-9"	3	* G52	1	#4	STR	10'-3"	7
* G26	1	#4	STR	4'-0"	3	* G53	1	#4	STR	10'-5"	7
* G27	1	#4	STR	4'-3"	3	* G54	1	#4	STR	10'-7"	7
* G28	1	#4	STR	4'-7"	3	* G55	1	#4	STR	10'-9"	7
* G29	1	#4	STR	4'-10"	3	* G56	1	#4	STR	10'-11"	7
* G30	1	#4	STR	5'-1"	3	* G57	1	#4	STR	11'-1"	7
* G31	1	#4	STR	5'-4"	4	* G58	1	#4	STR	11'-3"	8
* G32	1	#4	STR	5'-8"	4	* G59	1	#4	STR	11'-5"	8
* G33	1	#4	STR	5'-11"	4	* G60	1	#4	STR	11'-6"	8
* G34	1	#4	STR	6'-2"	4	* G61	1	#4	STR	11'-8"	8
* G35	1	#4	STR	6'-5"	4	* G62	1	#4	STR	11'-10"	8
* G36	1	#4	STR	6'-9"	5	* G63	1	#4	STR	12'-0"	8
* G37	1	#4	STR	7'-0"	5	* G64	1	#4	STR	12'-2"	8
* G38	1	#4	STR	7'-3"	5	* G65	1	#4	STR	12'-4"	8
* G39	1	#4	STR	7'-6"	5	* G66	1	#4	STR	12'-6"	8
* G40	1	#4	STR	7'-8"	5	* G67	1	#4	STR	11'-3"	8
* G41	1	#4	STR	7'-11"	5	* G68	1	#4	STR	7'-4"	5
* G42	1	#4	STR	8'-1"	5	* G69	1	#4	STR	3'-4"	2

\* EPOXY COATED REINF. STEEL 916 LBS.

CLASS AA CONCRETE 17.1 CU. YDS.

\* INDICATES EPOXY COATED REINF. STEEL

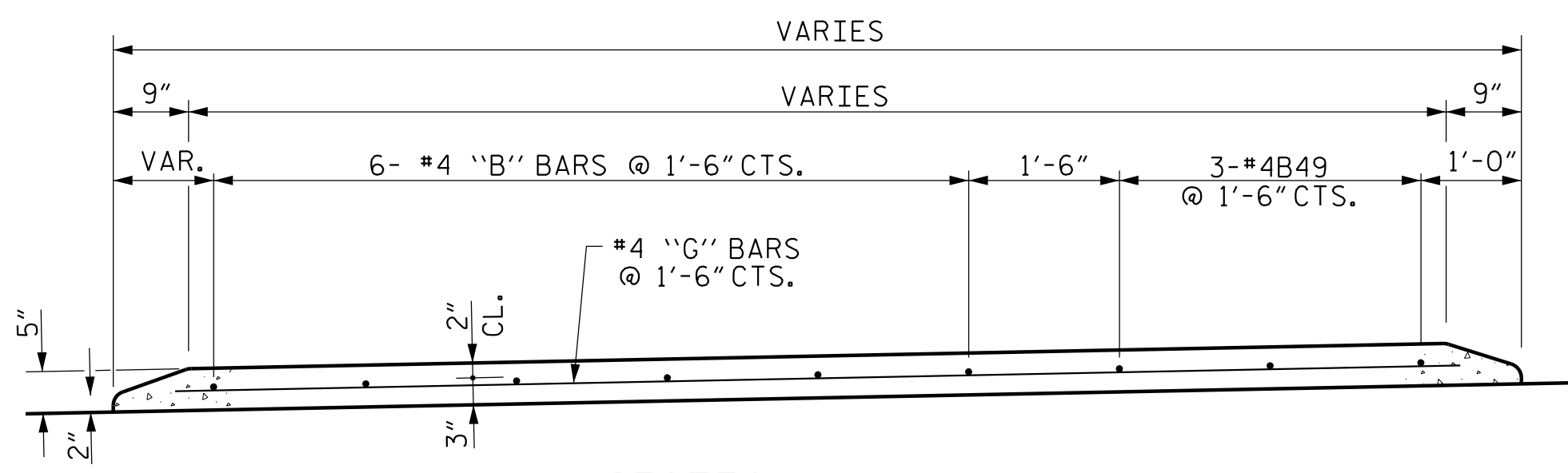

SECTION N-N

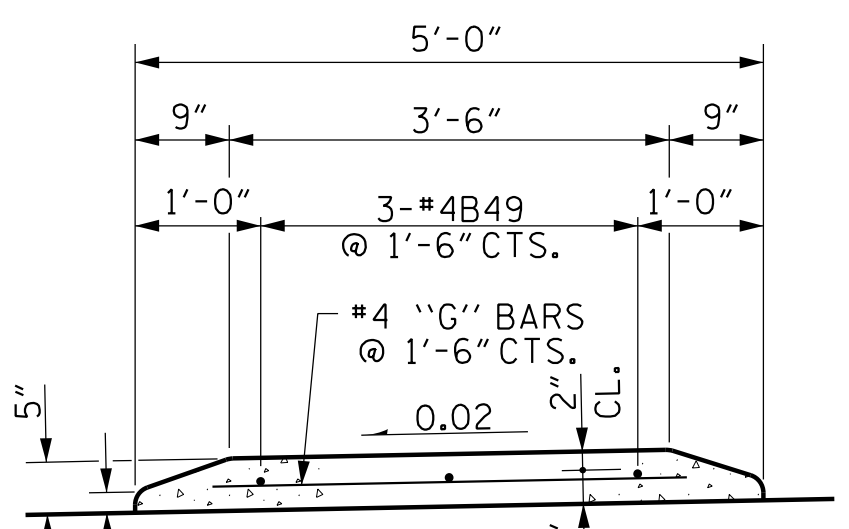

SECTION M-M

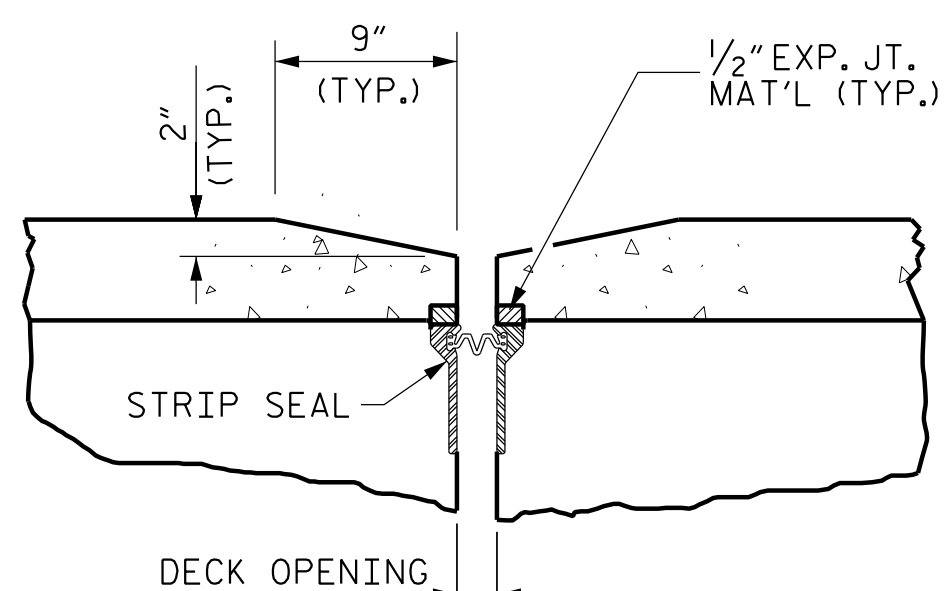

SECTION P-P

**SECTIONS THRU MONOLITHIC CONCRETE ISLAND**

PROJECT NO. U-5839  
HAYWOOD COUNTY  
 STATION: 24+64.13 -L- POC

STATE OF NORTH CAROLINA  
 DEPARTMENT OF TRANSPORTATION  
 RALEIGH  
 SUPERSTRUCTURE  
**MONOLITHIC CONCRETE ISLAND  
 PLAN AND DETAILS**

PLANS PREPARED BY:  
**N|V|5**  
 NV5 ENGINEERS & CONSULTANTS, INC.  
 3300 REGENCY PARKWAY, SUITE 100  
 CARY, NC 27518  
 P: 919.851.1912 www.nv5.com  
 NC License # F-1333

DocuSigned by:  
 NORTH CAROLINA PROFESSIONAL ENGINEER  
 ROBERT C. LARSON  
 EB2398D9220470  
 1414  
 5/18/2023

**DOCUMENT NOT CONSIDERED FINAL  
 UNLESS ALL SIGNATURES COMPLETED**

REVISIONS						SHEET NO.
NO.	BY:	DATE:	NO.	BY:	DATE:	18
1			3			TOTAL SHEETS
2			4			63

5/17/2023 7:05:17 PM RA\Structures\3 span Bridge cover RRVIB U5839.SMU.WD\_430184.dgn

DRAWN BY: W. B. ALLEN DATE: 10/19  
 CHECKED BY: Z. H. BROWN DATE: 1/20  
 DESIGN ENGINEER OF RECORD: R. C. LARSON DATE: 4/23

DocuSigned by:  
 BEB2398D9220470