

<p>-Y16- PI Sta 11-27.06 $\Delta = 33^{\circ} 39' 52.9"$ (RT) D = 13' 38' 30.7" L = 246.78' T = 127.06' R = 420.00' SE = EXIST</p>	<p>-Y21LPD- PIs Sta 11-60.99 $\Theta_s = 43^{\circ} 31' 47.7"$ Ls = 234.00' LT = 160.99' ST = 82.56'</p>	<p>-Y21LPD- PI Sta 16-27.03 $\Delta = 137^{\circ} 12' 24.0"$ (RT) D = 37' 12' 18.2" L = 368.79' T = 393.03' R = 154.00' SE = EXIST Vd = 30 MPH</p>	<p>-Y21LPD- PI Sta 18-21.24 $\Delta = 49^{\circ} 40' 20.7"$ (RT) D = 12' 08' 20.2" L = 409.20' T = 218.46' R = 472.00' SE = 06 Vd = 30 MPH</p>
<p>-Y21RPD- PIs Sta 11-45.34 $\Theta_s = 18^{\circ} 25' 50.9"$ Ls = 184.00' LT = 123.34' ST = 61.94'</p>	<p>-Y21RPD- PI Sta 12-40.70 $\Delta = 13^{\circ} 50' 14.1"$ (RT) D = 20' 02' 00.6" L = 69.07' T = 34.70' R = 286.00' SE = EXIST Vd = 35 MPH</p>	<p>-Y21RPD- PIs Sta 13-37.01 $\Theta_s = 18^{\circ} 25' 50.9"$ Ls = 184.00' LT = 123.34' ST = 61.94'</p>	<p>-Y21RPD- PI Sta 16-08.41 $\Delta = 38^{\circ} 00' 01.7"$ (RT) D = 20' 02' 00.6" L = 189.68' T = 98.48' R = 286.00' SE = 05 Vd = 35 MPH</p>

REVISIONS

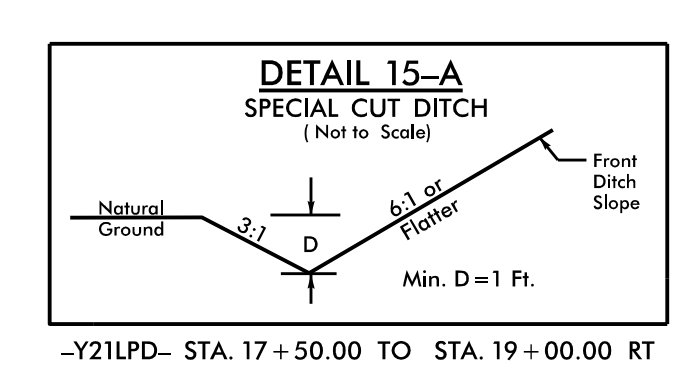
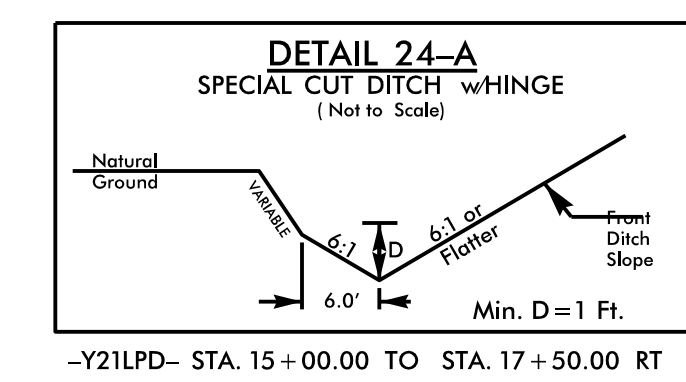
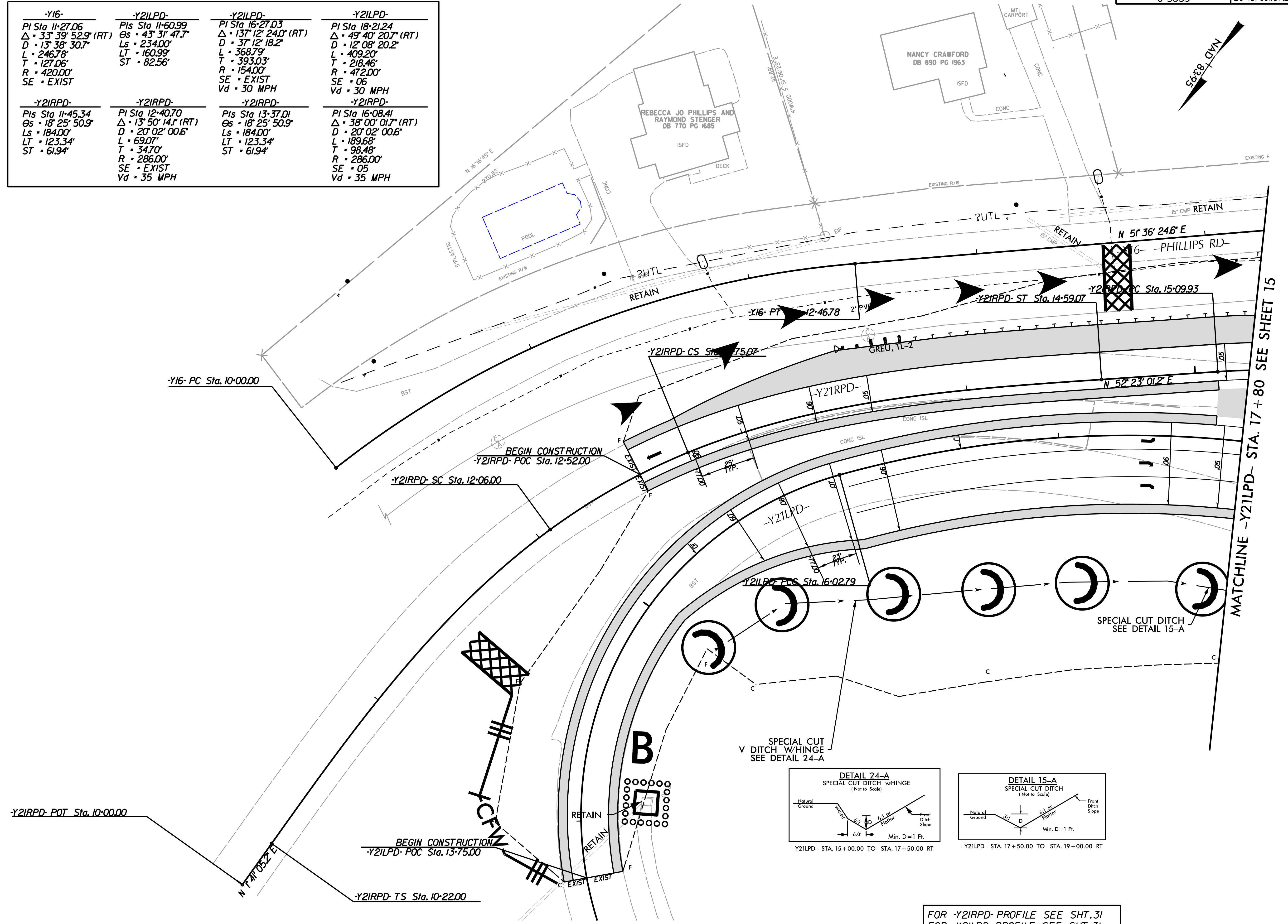

FOR -Y21RPD- PROFILE SEE SHT.31
 FOR -Y21LPD- PROFILE SEE SHT.31

8/17/99
 3/10/2023
 R:\Environmental\Design\U5839-EC-45-Final.dgn
 3/10/2023