

NOTE: UTILIZE FABRIC INSERT INLET DEVICES IN LIEU OF ROCK INLET SEDIMENT TRAPS, TYPE-C AS DIRECTED TO AVOID IMPOUNDMENT OF RUNOFF IN ROADWAY OPEN TO TRAFFIC.

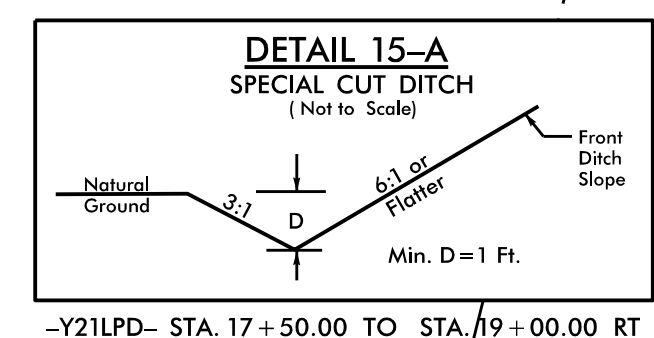

81 x 30 x 3
ID 15.1

BEGIN CONSTRUCTION
-Y16- POT Sta. 15+95.00

MATCHLINE -Y21LPD-
STA. 17+80 SEE SHEET 24

MATCHLINE -L- STA. 67+50 SEE SHEET 14

MATCHLINE -L- STA. 72+70 SEE SHEET 16

REVISIONS

3/10/2023
R:\Environmental\Design\U5839-EC-36-F.incl.dgn
wcm

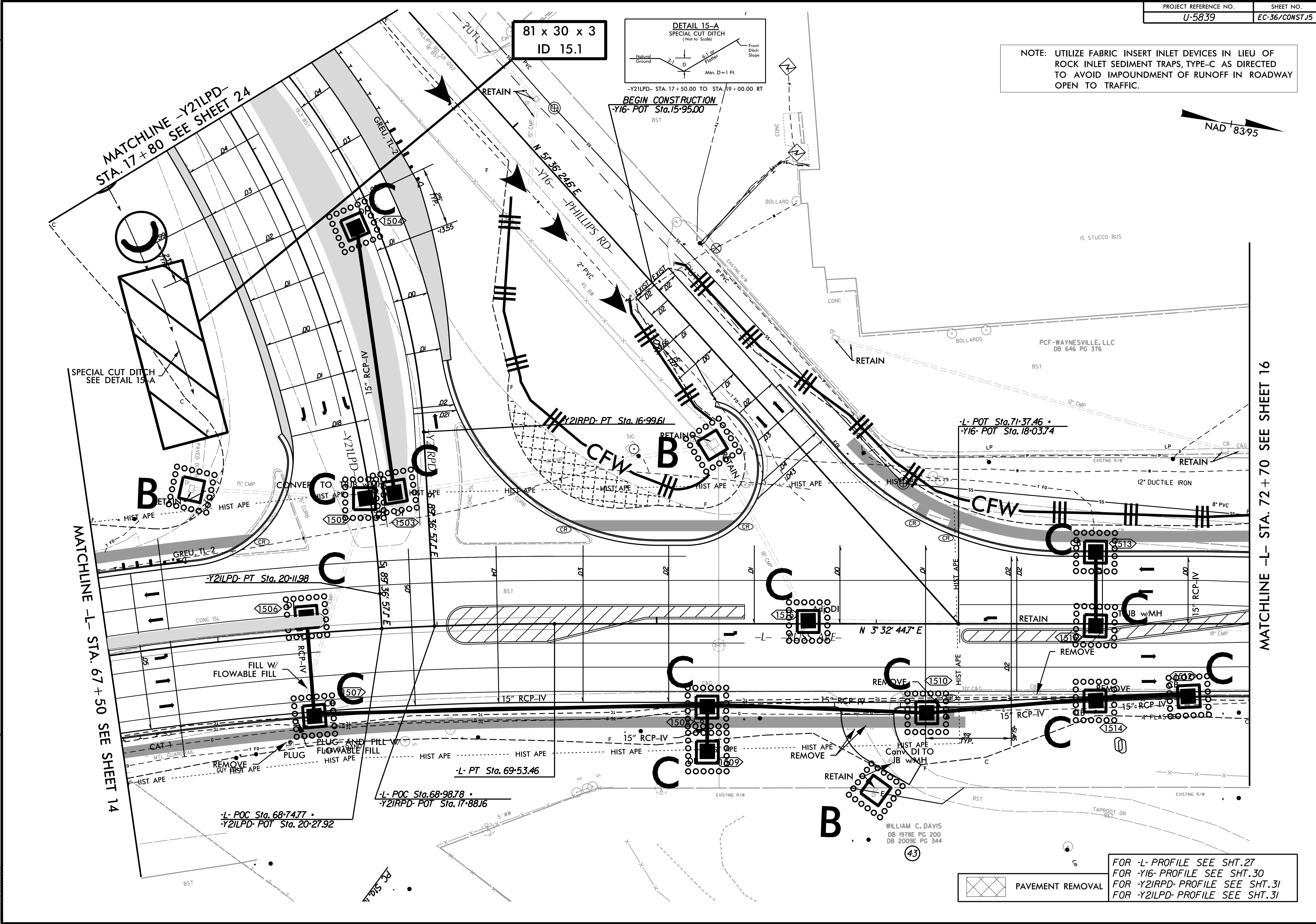

PAVEMENT REMOVAL

FOR -L- PROFILE SEE SHT.27
FOR -Y16- PROFILE SEE SHT.30
FOR -Y21RPD- PROFILE SEE SHT.31
FOR -Y21LPD- PROFILE SEE SHT.31

WILLIAM C. DAVIS
DB 1978E PG 200
DB 2009E PG 344