

8.17.19

PROJECT REFERENCE NO. <b>U-5839</b>	SHEET NO. <b>20</b>
RW SHEET NO.	
ROADWAY DESIGN ENGINEER 5/9/2023	HYDRAULICS ENGINEER 5/9/2023
<b>DOCUMENT NOT CONSIDERED FINAL UNLESS ALL SIGNATURES COMPLETED</b>	

<b>-Y10-</b> PI Sta 12+39.73 Δ = 7' 11" 13.3" (RT) D = 3' 28' 51.3" L = 206.47' T = 103.37' R = 1,646.00' SE = 03 Vd = 40 MPH	<b>-Y10-</b> PI Sta 14+59.28 Δ = 24' 38' 56.7" (RT) D = 10' 44' 58.8" L = 229.30' T = 116.45' R = 533.00' SE = EXIST
---	---

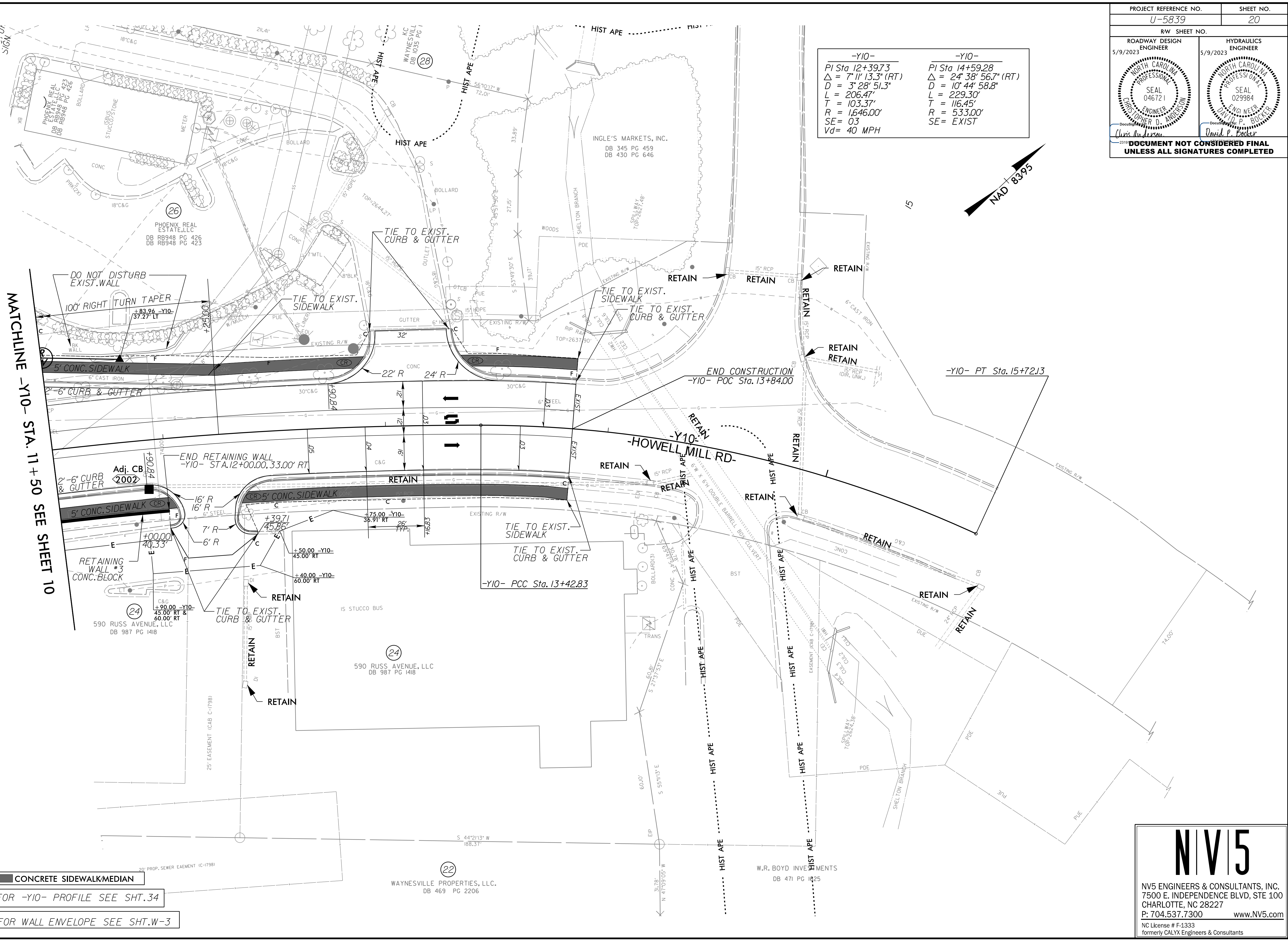
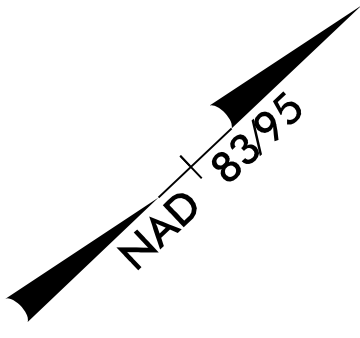

MATCHLINE -Y10- STA. 11+50 SEE SHEET 10

**CONCRETE SIDEWALK/MEDIAN**  
FOR -Y10- PROFILE SEE SHT. 34  
FOR WALL ENVELOPE SEE SHT. W-3

**NV5**  
 NV5 ENGINEERS & CONSULTANTS, INC.  
 7500 E. INDEPENDENCE BLVD., STE 100  
 CHARLOTTE, NC 28227  
 P: 704.537.7300 www.NV5.com  
 NC License # F-1333  
 formerly CALYX Engineers & Consultants

R:\Roadway\Projects\U5839\_RDY\_PSH\_20.dgn  
8/23/2023  
Reagan, C