

8.17.19

PROJECT REFERENCE NO. <b>U-5839</b>	SHEET NO. <b>16</b>
RW SHEET NO.	
ROADWAY DESIGN ENGINEER 5/9/2023	HYDRAULICS ENGINEER 5/9/2023
<b>DOCUMENT NOT CONSIDERED FINAL UNLESS ALL SIGNATURES COMPLETED</b>	

-L-  
 PI Sta 74+31.84  
 $\Delta = 9' 46' 19.9" (RT)$   
 $D = 4' 00' 04.0"$   
 $L = 244.24'$   
 $T = 122.42'$   
 $R = 1,432.00'$   
 SE = EXIST

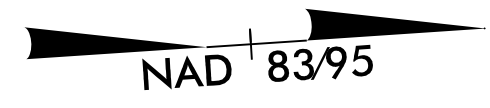

MATCHLINE -L- STA. 72 + 70 SEE SHEET 15

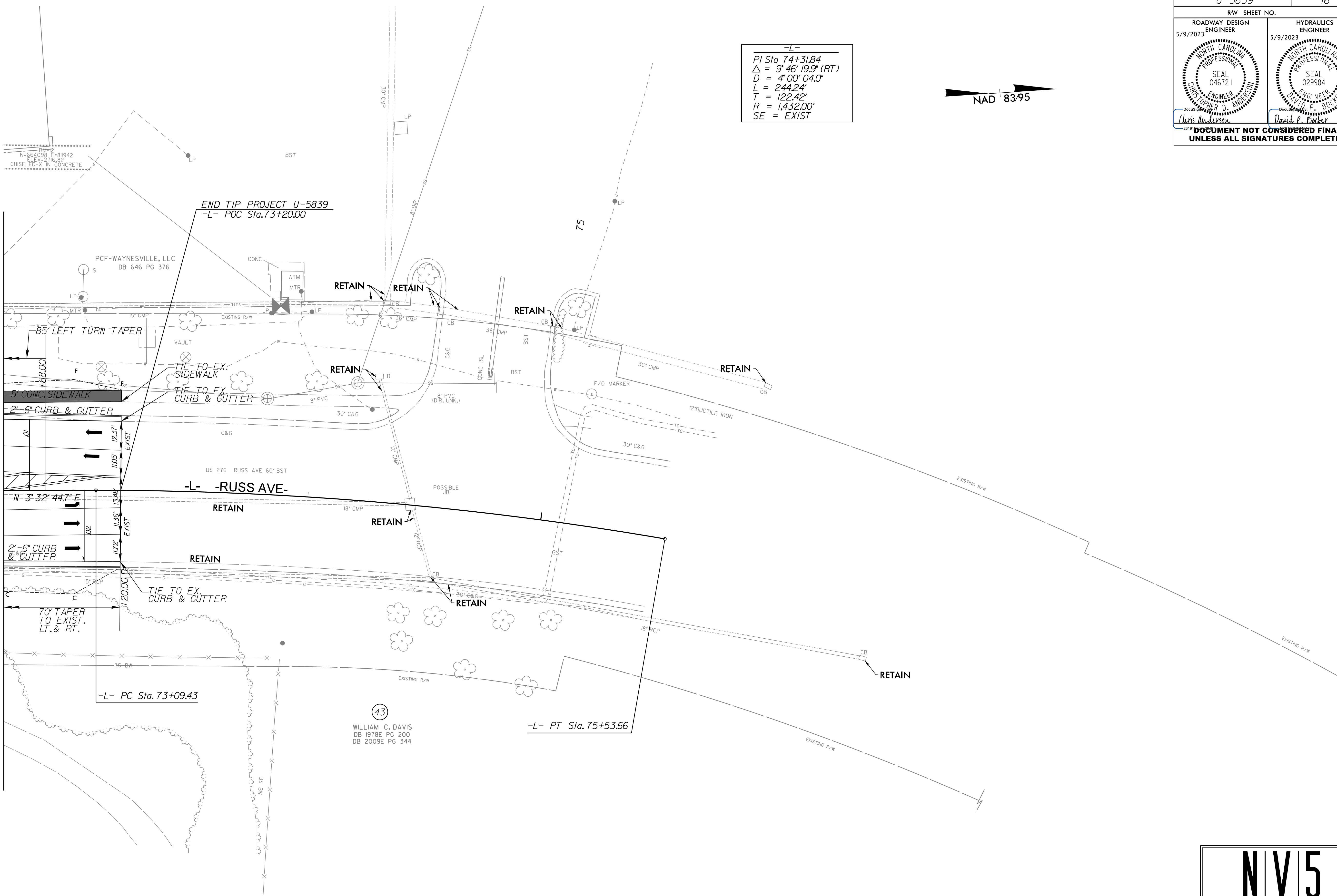

CONCRETE SIDEWALK/MEDIAN  
 FOR -L- PROFILE SEE SHT. 31

(43)  
 WILLIAM C. DAVIS  
 DB 1978E PG 200  
 DB 2009E PG 344

**NV5**  
 NV5 ENGINEERS & CONSULTANTS, INC.  
 7500 E. INDEPENDENCE BLVD, STE 100  
 CHARLOTTE, NC 28227  
 P: 704.537.7300 www.NV5.com  
 NC License # F-1333  
 formerly CALYX Engineers & Consultants

2/23/2023  
 R:\Roadway\Projects\U5839\RDY\_PSH\_16.dgn  
 Ryan Carothers