

PROJECT REFERENCE NO. U-5839	SHEET NO. 5
RW SHEET NO.	
ROADWAY DESIGN ENGINEER 5/9/2023	HYDRAULICS ENGINEER 5/9/2023
DOCUMENT NOT CONSIDERED FINAL UNLESS ALL SIGNATURES COMPLETED	

SOUTHERN CONCRETE MATERIALS INC
DB 356 PG 1009
DB 337 PG 979

NO CLEARING THIS SHEET,
EXCEPT ON PARCELS 1 & 2

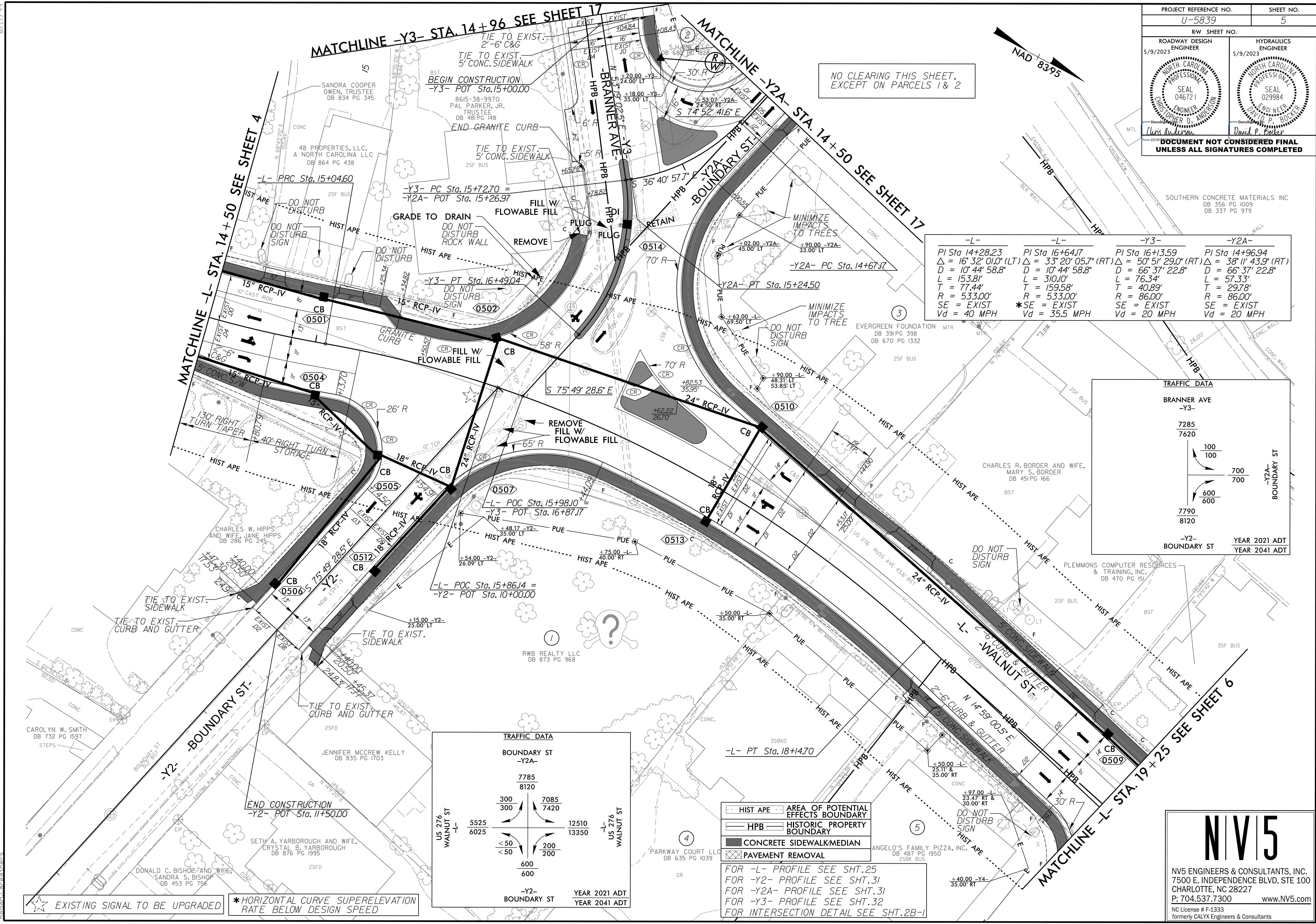
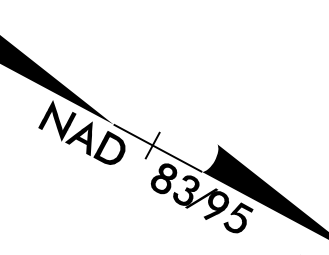

-L-	-L-	-Y3-	-Y2A-
PI Sta 14+28.23	PI Sta 16+64.17	PI Sta 16+13.59	PI Sta 14+96.94
$\Delta = 16' 32" 01.0" (LT)$	$\Delta = 33' 20" 05.7" (RT)$	$\Delta = 50' 51" 29.0" (RT)$	$\Delta = 38' 11" 43.9" (RT)$
$D = 10' 44" 58.8"$	$D = 10' 44" 58.8"$	$D = 66' 37" 22.8"$	$D = 66' 37" 22.8"$
$L = 153.81'$	$L = 310.10'$	$L = 76.34'$	$L = 57.33'$
$T = 77.44'$	$T = 159.58'$	$T = 40.89'$	$T = 29.78'$
$R = 533.00'$	$R = 533.00'$	$R = 86.00'$	$R = 86.00'$
$SE = EXIST$	$*SE = EXIST$	$SE = EXIST$	$SE = EXIST$
$Vd = 40 MPH$	$Vd = 35.5 MPH$	$Vd = 20 MPH$	$Vd = 20 MPH$

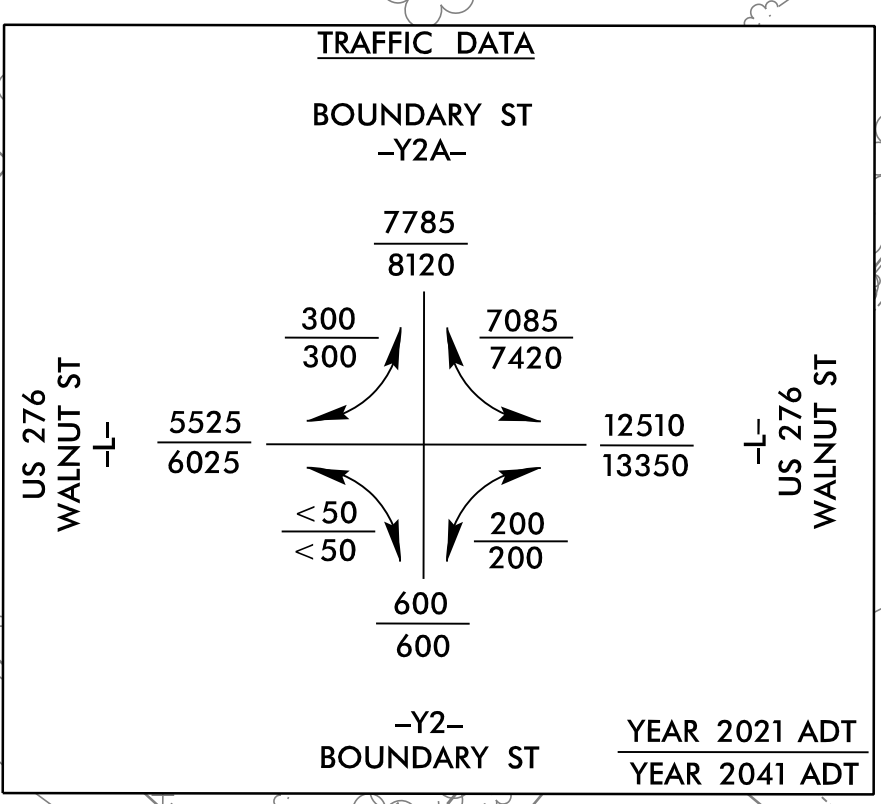
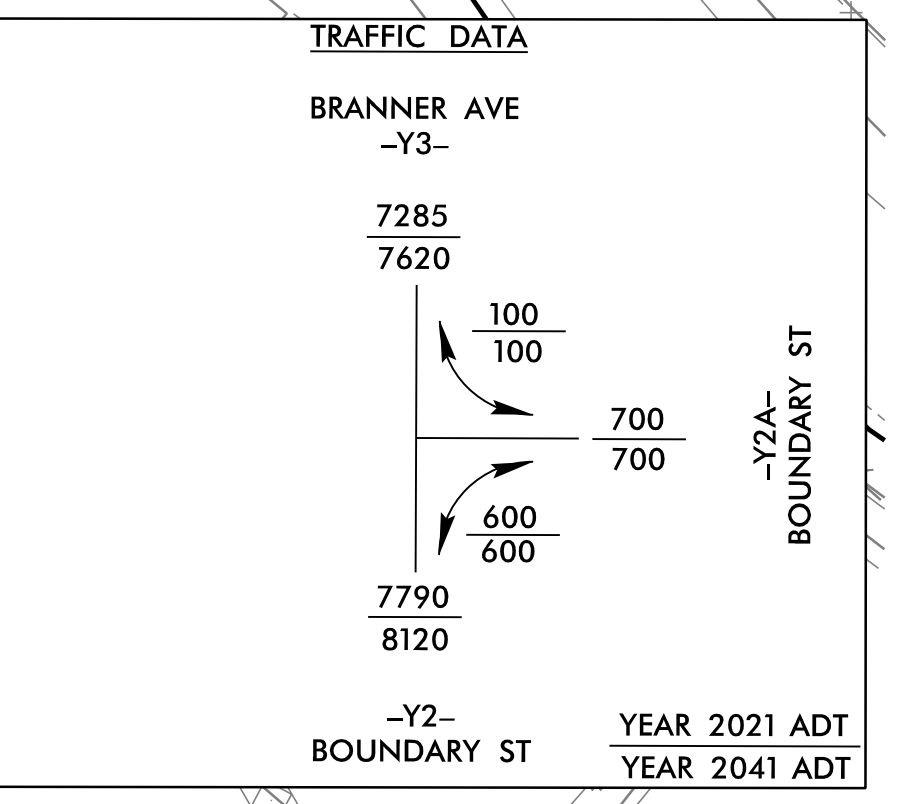

- HIST APE
- HPB
- CONCRETE SIDEWALK/MEDIAN
- PAVEMENT REMOVAL
- AREA OF POTENTIAL EFFECTS BOUNDARY
- HISTORIC PROPERTY BOUNDARY

FOR -L- PROFILE SEE SHT.25
 FOR -Y2- PROFILE SEE SHT.31
 FOR -Y2A- PROFILE SEE SHT.31
 FOR -Y3- PROFILE SEE SHT.32
 FOR INTERSECTION DETAIL SEE SHT.2B-1

EXISTING SIGNAL TO BE UPGRADED
 * HORIZONTAL CURVE SUPERELEVATION RATE BELOW DESIGN SPEED

NV5
 NV5 ENGINEERS & CONSULTANTS, INC.
 7500 E. INDEPENDENCE BLVD, STE 100
 CHARLOTTE, NC 28227
 P: 704.537.7300 www.NV5.com
 NC License # F-1333
 formerly CALYX Engineers & Consultants