

PROJECT REFERENCE NO. <b>U-5839</b>	SHEET NO. <b>4</b>
RW SHEET NO.	
ROADWAY DESIGN ENGINEER 5/9/2023	HYDRAULICS ENGINEER 5/9/2023
<p><b>DOCUMENT NOT CONSIDERED FINAL</b>  <b>UNLESS ALL SIGNATURES COMPLETED</b></p>	

<b>-YI-</b>	<b>-L-</b>
PI Sta 16+70.87	PI Sta 14+28.23
$\Delta = 21' 15" 05.0" (RT)$	$\Delta = 16' 32" 01.0" (LT)$
$D = 23' 52" 23.7"$	$D = 10' 44" 58.8"$
$L = 89.02'$	$L = 153.81'$
$T = 45.03'$	$T = 77.44'$
$R = 240.00'$	$R = 533.00'$
$SE = EXIST$	$SE = EXIST$
$Vd = 25 MPH$	$Vd = 40 MPH$

NO CLEARING ON THIS SHEET

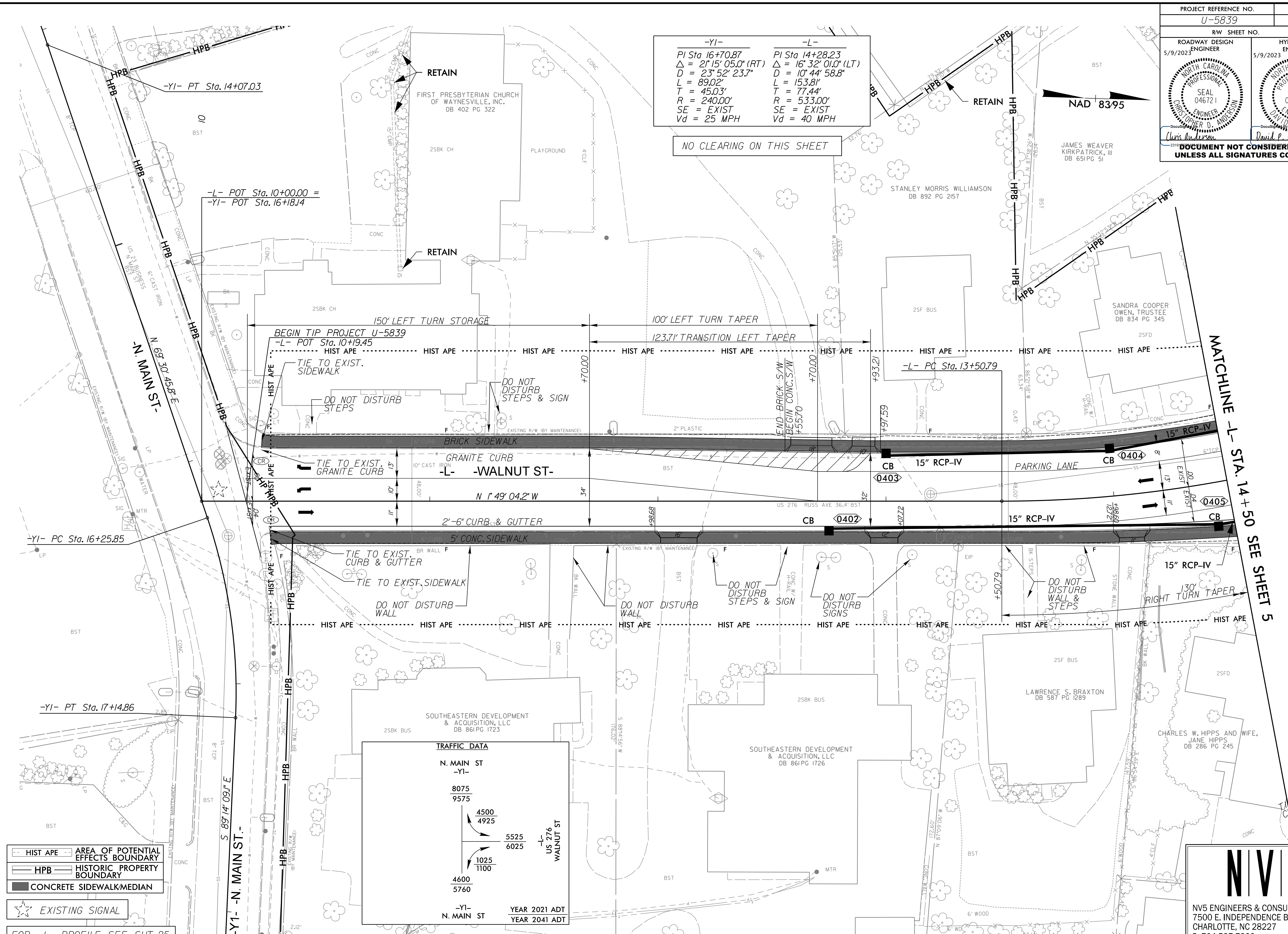

-L- POT Sta. 10+00.00 =  
 -YI- POT Sta. 16+18.14

BEGIN TIP PROJECT U-5839  
 -L- POT Sta. 10+19.45

-L- PC Sta. 13+50.79

-YI- PC Sta. 16+25.85

-YI- PT Sta. 17+14.86

**TRAFFIC DATA**

<b>N. MAIN ST</b>		<b>-YI-</b>	
8075	9575	4500	4925
↓		↑	
5525		6025	
↑		↓	
4600	5760	1025	1100
↑		↓	
<b>-YI-</b>		<b>YEAR 2021 ADT</b>	
<b>N. MAIN ST</b>		<b>YEAR 2041 ADT</b>	

- HIST APE AREA OF POTENTIAL EFFECTS BOUNDARY
- HPB HISTORIC PROPERTY BOUNDARY
- CONCRETE SIDEWALK/MEDIAN
- EXISTING SIGNAL

FOR -L- PROFILE SEE SHT. 25

**NV5**

NV5 ENGINEERS & CONSULTANTS, INC.  
 7500 E. INDEPENDENCE BLVD, STE 100  
 CHARLOTTE, NC 28227  
 P: 704.537.7300 www.NV5.com

NC License # F-1333  
 formerly CALYX Engineers & Consultants

8.17.19  
 2/23/2023  
 R:\Roadway\Pro\U5839\_RDY\_PSH\_04.dgn  
 Ryan Carothers