

WALL #3 DETAIL SHEET

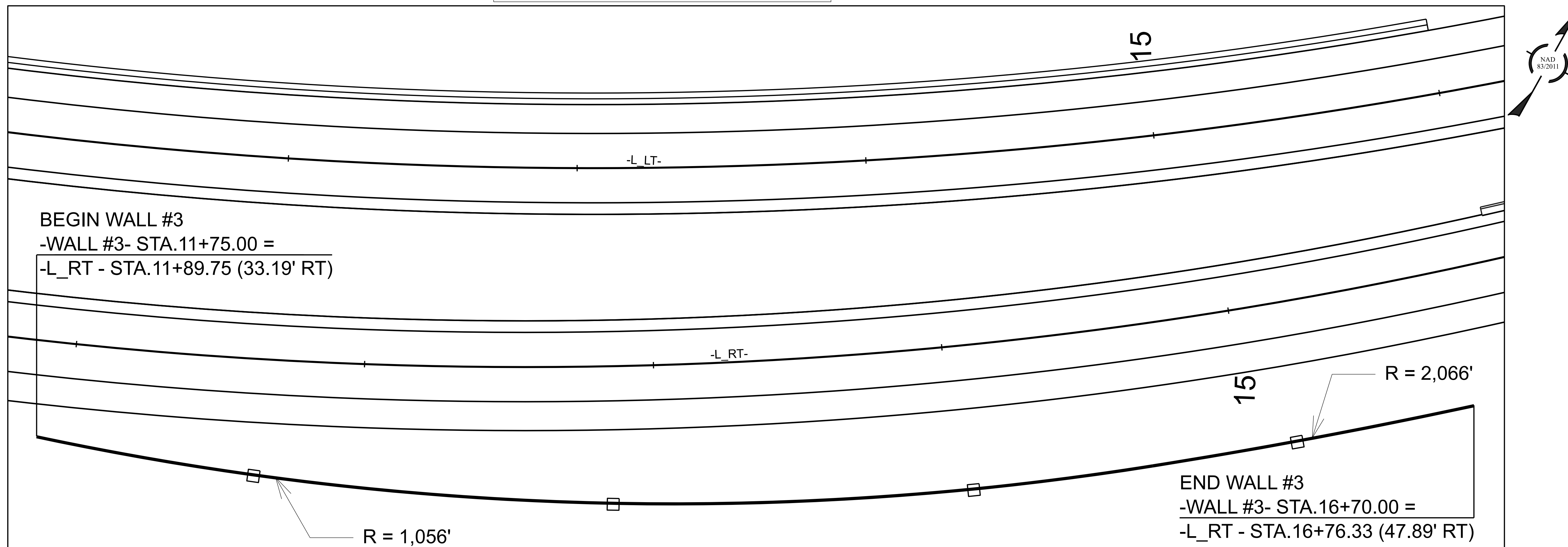

B-3186/B-5898
 W-03
 NORTH CAROLINA
 DEPARTMENT OF TRANSPORTATION
 HAYWOOD COUNTY
 ROADWAY DESIGN UNIT
 ROADWAY DESIGN
 ENGINEER
 NORTH CAROLINA
 PROFESSIONAL
 SEAL
 049634
 10/16/2023

PREPARED BY
AECOM
 NC FIRM LICENSE No: F-0342
 5438 Wade Park Boulevard, Suite 200
 Raleigh, NC 27603
 (919) 854-6200 (TEL) 854-6259 (FAX)

DOCUMENT NOT CONSIDERED FINAL UNLESS ALL SIGNATURES COMPLETED

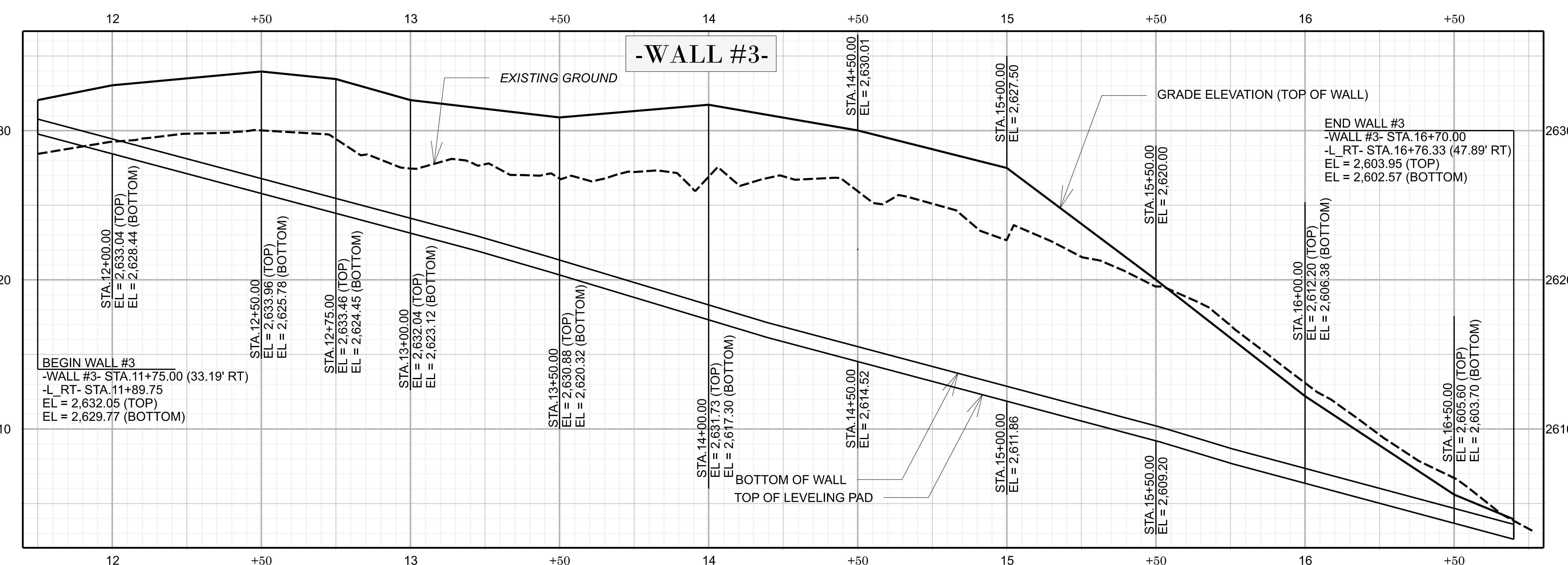

- NOTES:
1. APPROXIMATE WALL LENGTH = 495'
 2. APPROXIMATE WALL AREA = 4,295 SF
 3. TOP OF WALL ELEVATIONS DO NOT INCLUDE COPING

REVISIONS