

CCTV-1 GPS COORDINATES  
 35.518362° N  
 82.967380° W

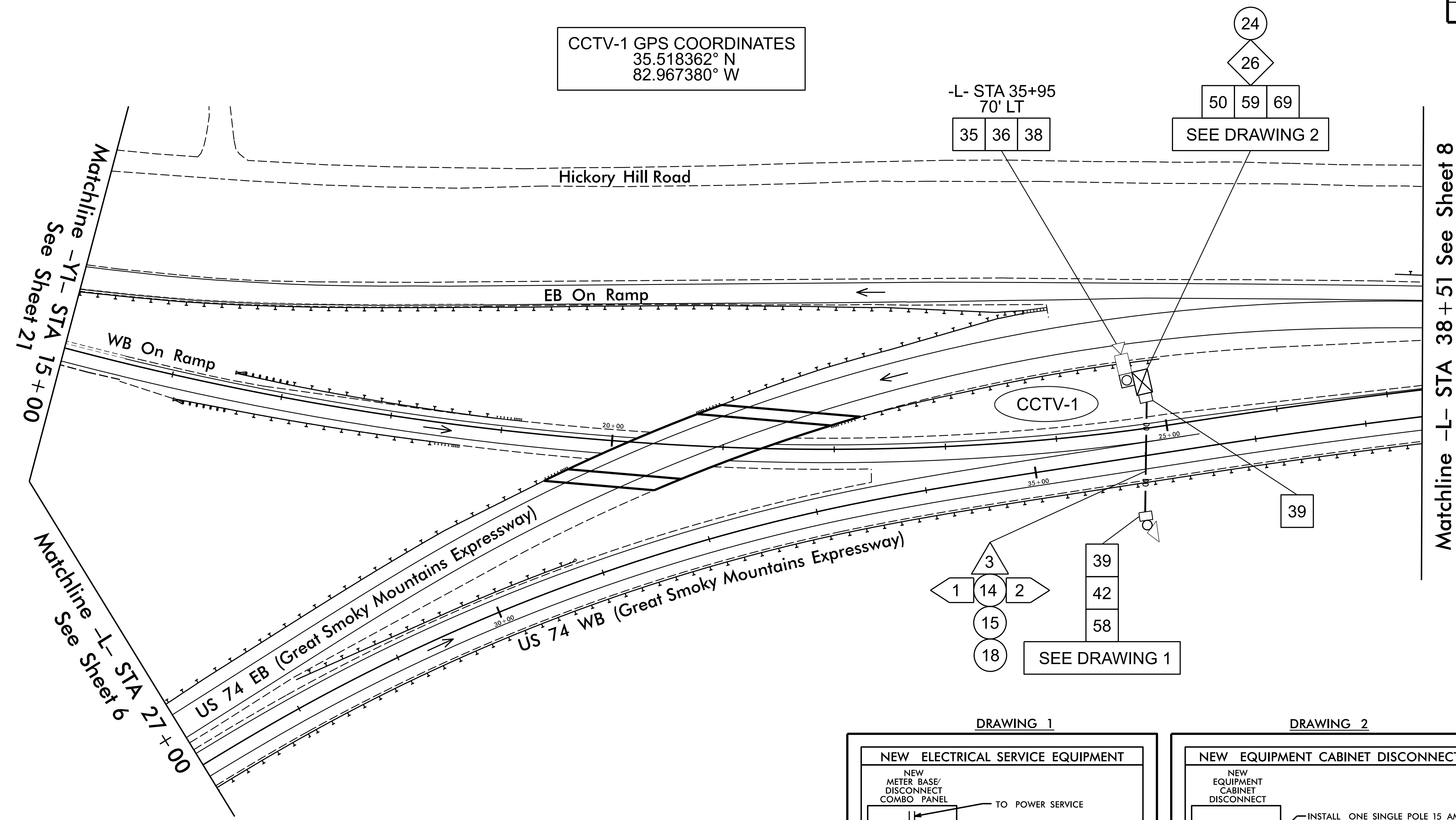

**NOTE:**

**Cellular Modem Antenna Mounting Bracket:**  
 Fabricate, furnish and install an L-Shaped mounting bracket to be secured to the outside of the cabinet to hold the cellular modem antenna. Design the L-Shape bracket out of 5052-H32 aluminum that is 0.125" thick by 3" wide by 6" long. Place a 90-degree bend along the 6" axis at it's length. Provide 2" mounting holes on one side of the L-Bend and provide 1/4" stainless-steel bolts, washers and nuts, for mounting the L-Bracket to the outside of the cabinet. On the other half of the bracket provide a 5/8" hole centered in the plate to accept the cellular antenna coaxial cable.

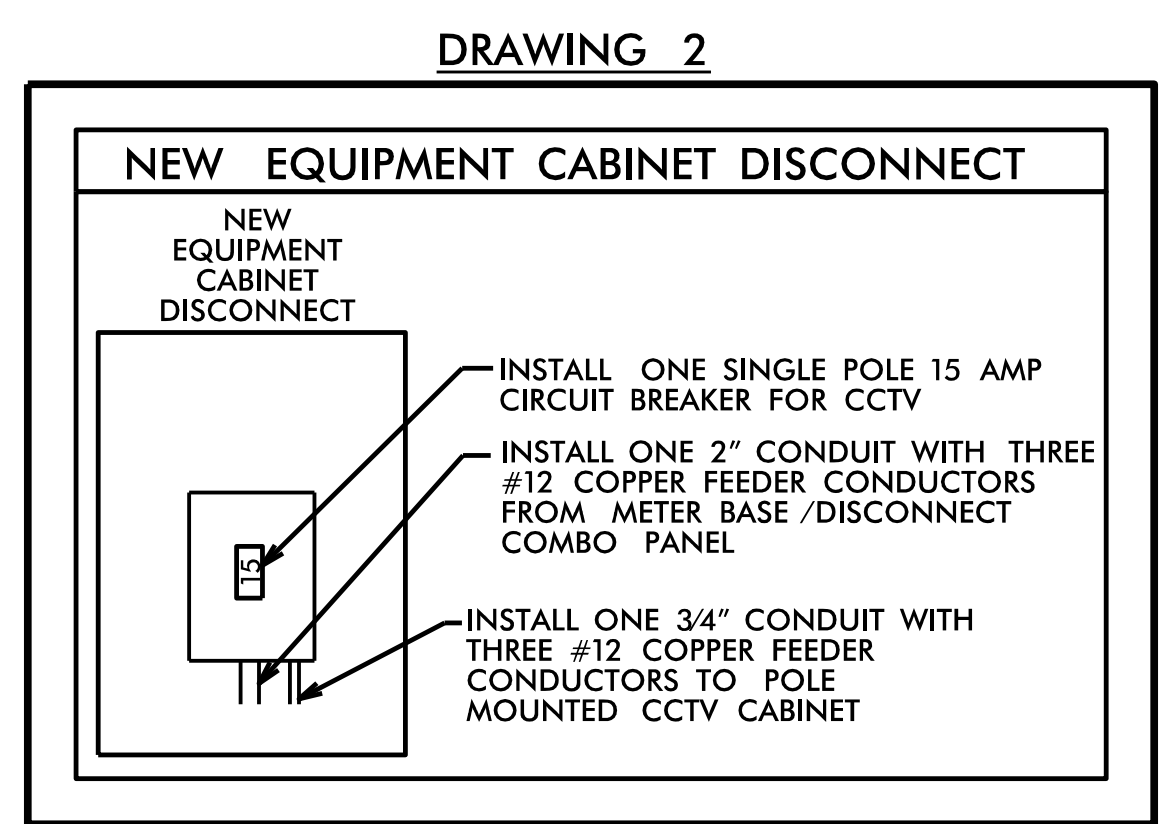
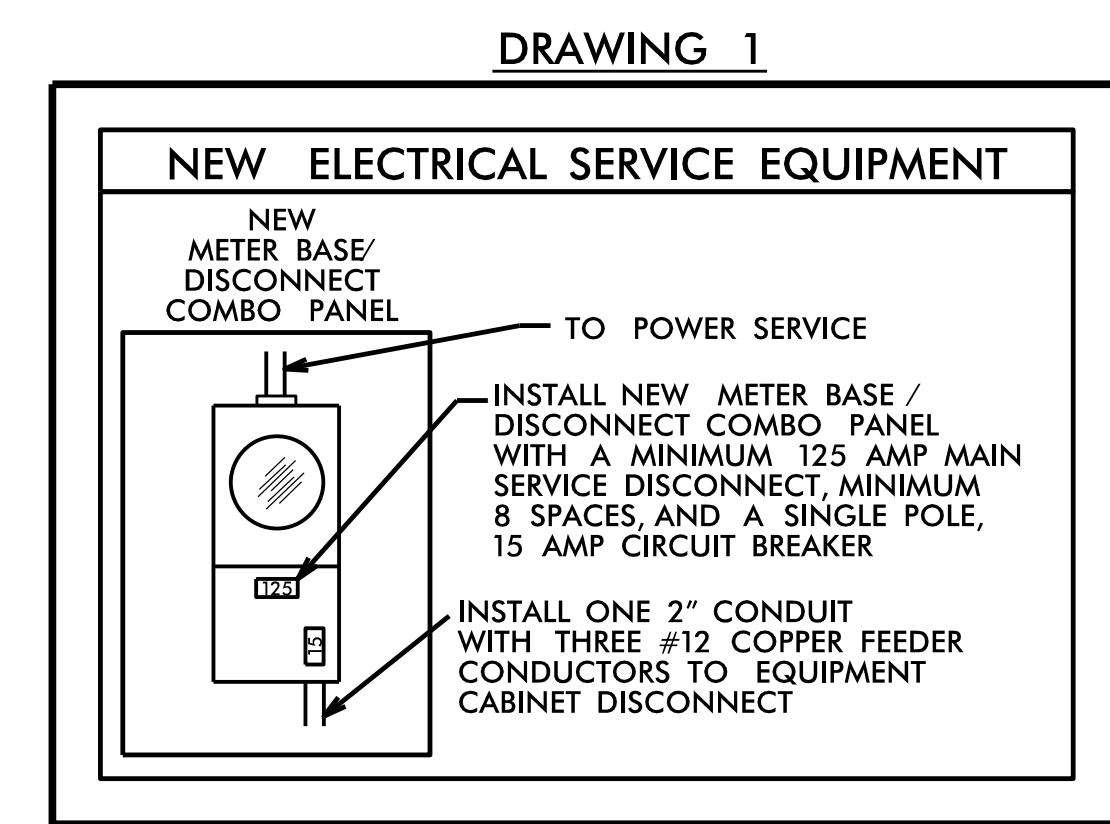

DOCUMENT NOT CONSIDERED FINAL  
 UNLESS ALL SIGNATURES COMPLETED

8/4/2023  
 p:\w\rocom\m-pw-bentley\ey.com\AECOM\_USA\_NorthCarolina\Documents\60670367-1-NCDOT\_B5898\_B3186\900-CAD\_GIS\910-CAD\70-INDOT-TIP\inter\igent Transportation Systems\B-5898-ITS\_PSH7.dgn  
 T:\indom

**AECOM**  
 NC Firm License No.: F-0342  
 5438 Wade Park Boulevard  
 Suite 200 Raleigh, NC 27607  
 Phone: 919-461-1100

Prepared for the Offices of:

750 N. Greenfield Pkwy., Garner, NC 27529

SCALE  
 0 50  
 1"=50'

ITS Communication Cable and Conduit Routing Plans

Division 14 Haywood County Waynesville

PLAN DATE: August 2023	REVIEWED BY: R. Garrett
PREPARED BY: M. Tindal	REVIEWED BY:
REVISIONS	INIT. DATE

SEAL

DocuSigned by:  
 Rochelle Garrett  
 8/4/2023

CADD Filename: