

SEE TMP-24A FOR SECTION DETAILS

PROJ. REFERENCE NO.	SHEET NO.
B-3186 / B-5898	TMP-24

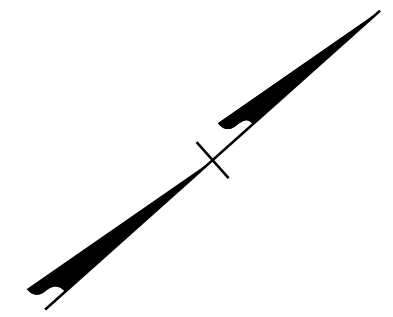

MATCHLINE -L\_RT STA 15+00  
SEE SHEET TMP-23

MATCHLINE -L\_RT STA 27+00  
SEE SHEET TMP-25

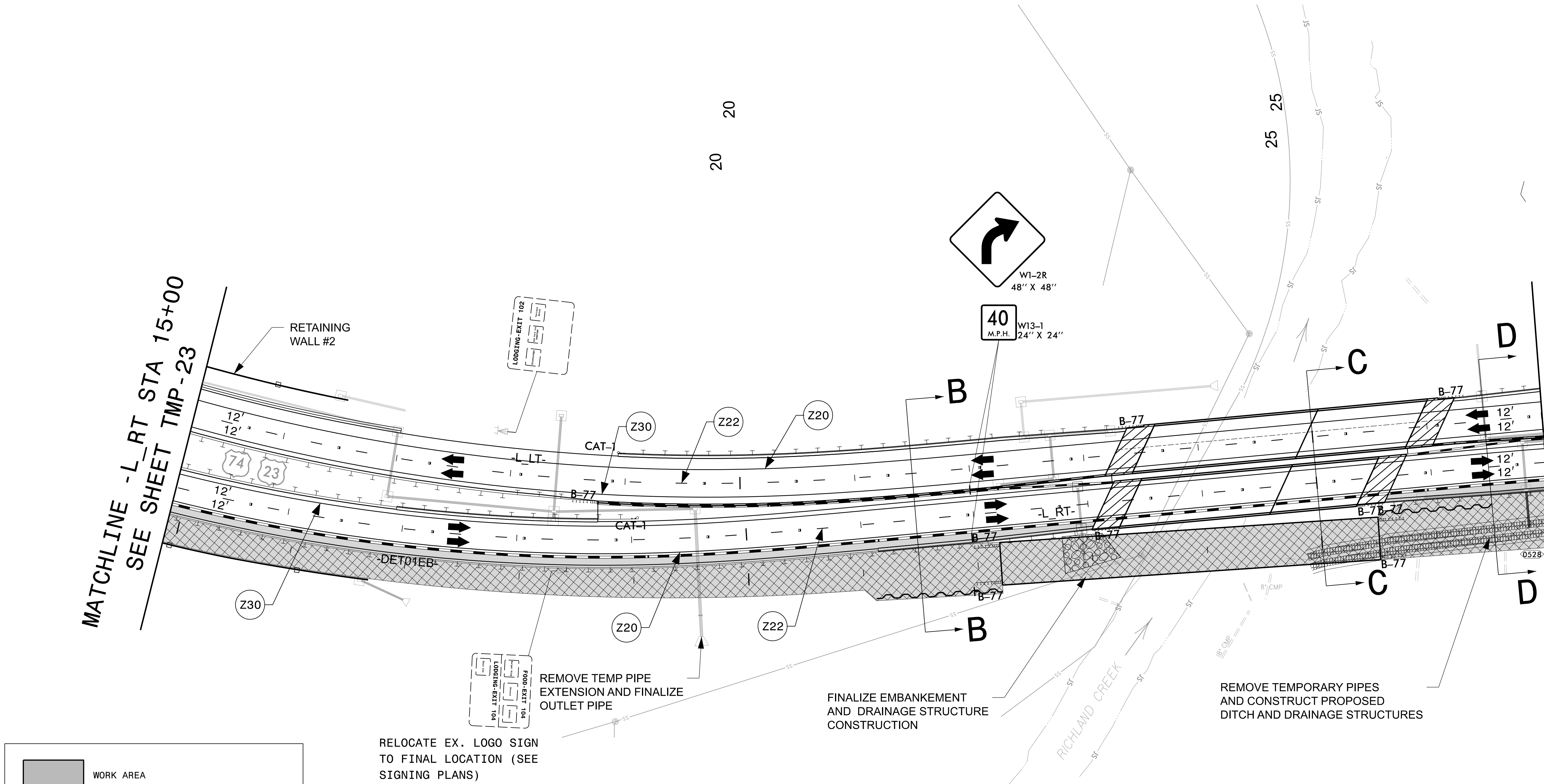

	WORK AREA
	WEDGING & WIDENING
	TEMPORARY PAVEMENT
	PAVEMENT / BRIDGE REMOVAL

RELOCATE EX. LOGO SIGN TO FINAL LOCATION (SEE SIGNING PLANS)

REMOVE TEMP PIPE EXTENSION AND FINALIZE OUTLET PIPE

FINALIZE EMBANKMENT AND DRAINAGE STRUCTURE CONSTRUCTION

REMOVE TEMPORARY PIPES AND CONSTRUCT PROPOSED DITCH AND DRAINAGE STRUCTURES

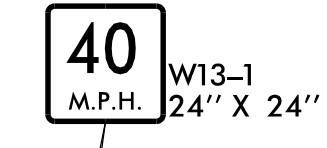
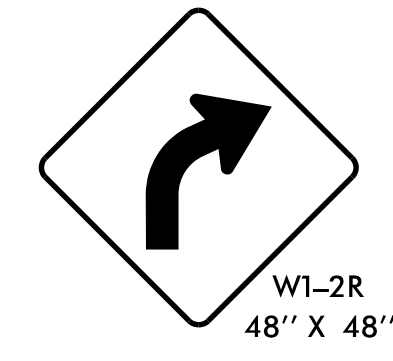

RICHLAND CREEK

9/14/2023  
 B3186-B5898.TC\_TMP-24\_Phase V.dgn  
 jeffrey.thurston

APPROVED: *Jeffrey A. Kooft*

DATE: 10/17/2023

**DOCUMENT NOT CONSIDERED FINAL UNLESS ALL SIGNATURES COMPLETED**

**AECOM**  
 NC FIRM LICENSE No: F-0342  
 5438 Wade Park Blvd., Ste 200  
 Raleigh, NC 27607  
 (919) 854-6200

PHASE V DETAILS  
US 74/US 23