

SEE TMP-13A FOR SECTION DETAILS

PROJ. REFERENCE NO.	SHEET NO.
B-3186 / B-5898	TMP-13

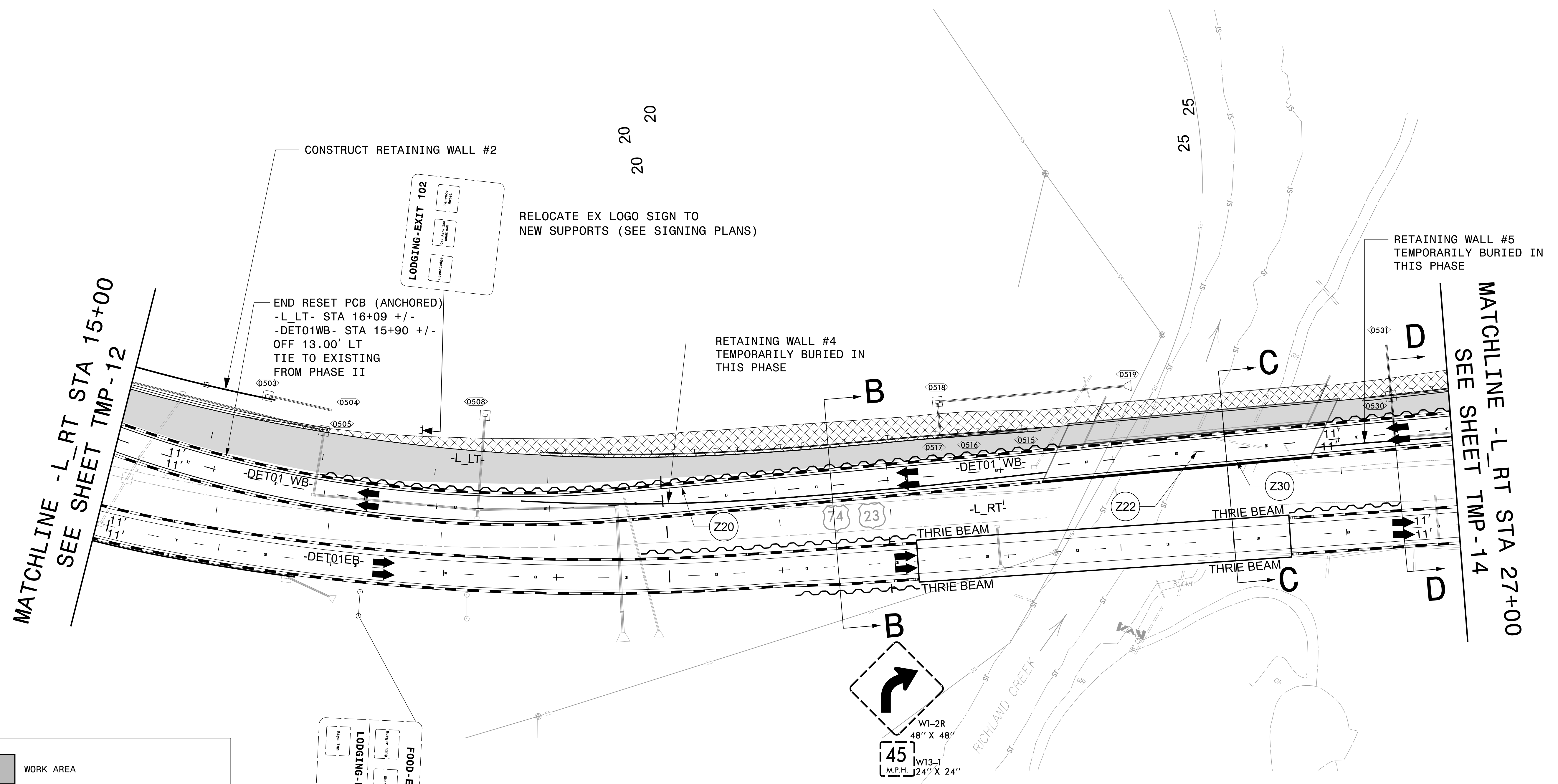
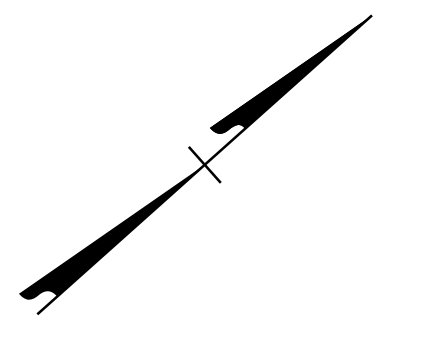

	WORK AREA
	WEDGING & WIDENING
	TEMPORARY PAVEMENT
	PAVEMENT / BRIDGE REMOVAL

FOOD-EXIT 104  
LOGGING-EXIT 104

W1-2R  
48" X 48"

W13-T  
24" X 24"  
M.P.H. 45

APPROVED: *Jeffrey A. Koontz*

DATE: 10/17/2023

Seal: NORTH CAROLINA PROFESSIONAL SEAL 018122 ENGINEER JEFFREY A. KOONTZ

DOCUMENT NOT CONSIDERED FINAL UNLESS ALL SIGNATURES COMPLETED

DIVISION OF HIGHWAYS  
STATE OF NORTH CAROLINA  
DEPARTMENT OF TRANSPORTATION  
WORK ZONE TRAFFIC CONTROL

**AECOM**  
NC FIRM LICENSE No: F-0342  
5438 Wade Park Blvd., Ste 200  
Raleigh, NC 27607  
(919) 854-6200

PHASE III DETAILS  
US 74/US 23

10/12/2023  
B3186-B5898\_TC\_TMP\_I3\_Phase III.dgn  
Jeff.Koontz