

INSET DETAIL FOR L_LT FROM STA.22+40 TO STA.28+00

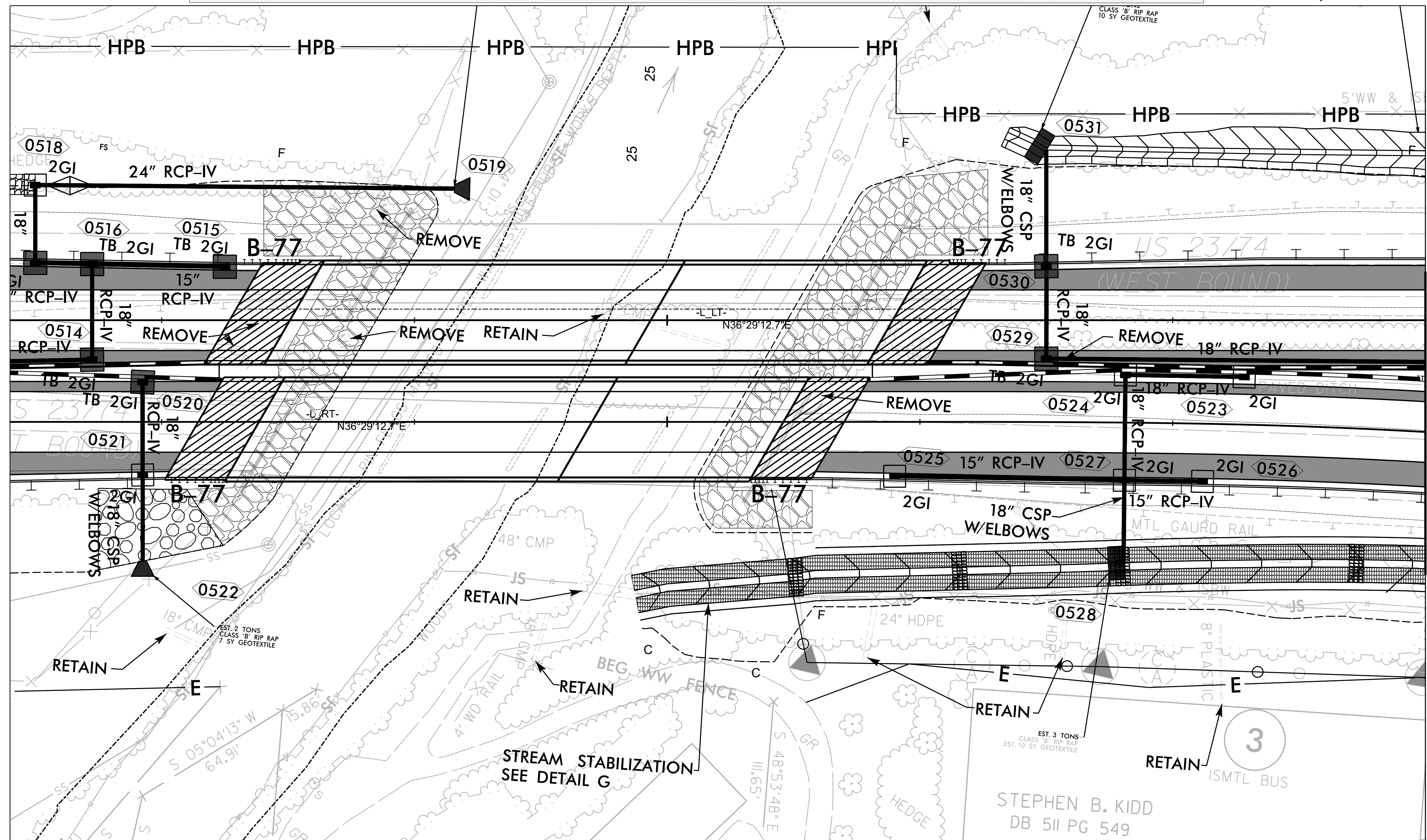

MATCH LINE -- STA 28+00.00 SEE SHEET 2B-8

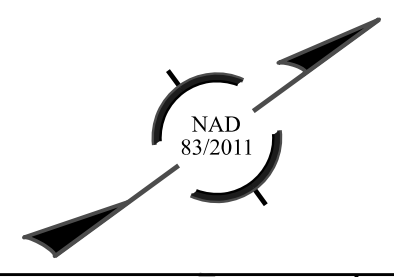
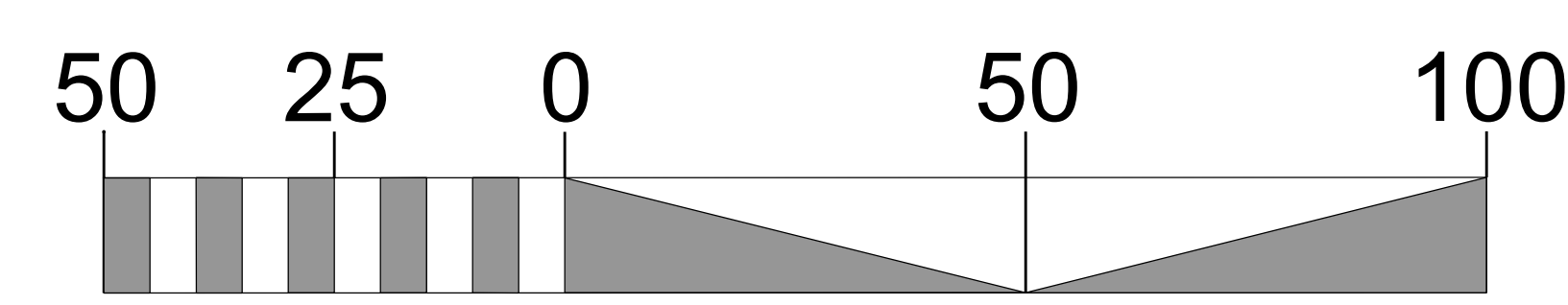

FOR HORIZONTAL GEOMETRY AND ADDITIONAL OFFSET DATA SEE SHEET 5

B-3186/B-5898

2B-7

NORTH CAROLINA
DEPARTMENT OF TRANSPORTATION
HAYWOOD COUNTY

ROADWAY DESIGN UNIT

ROADWAY DESIGN
ENGINEER



HYDRAULICS
ENGINEER

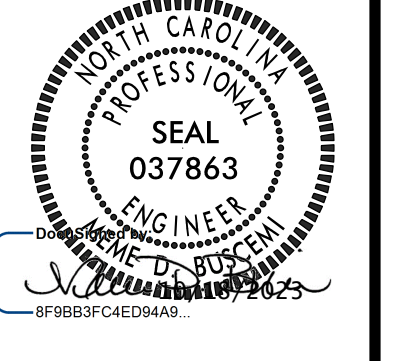

PREPARED BY

AECOM

NC FIRM LICENSE No: F-0342
5438 Wade Park Boulevard, Suite 200
Raleigh, NC 27603
(919) 854-6200 (919) 854-6259 (FAX)

DOCUMENT NOT CONSIDERED FINAL
UNLESS ALL SIGNATURES COMPLETED

REVISIONS

3

STEPHEN B. KIDD
DB 511 PG 549

RETAIN ISMTL BUS

5/26/20