

09.08/2019

27-SEP-2023 10:14
R:\Roadway\Proj\B5981_rdy_tsh_la_lb.dgn
\$\$\$\$\$SERNAME\$\$\$\$\$

TIP PROJECT: B-5981

CONTRACT: C204767

See Sheet 1A For Index of Sheets
See Sheet 1B For Conventional Symbols

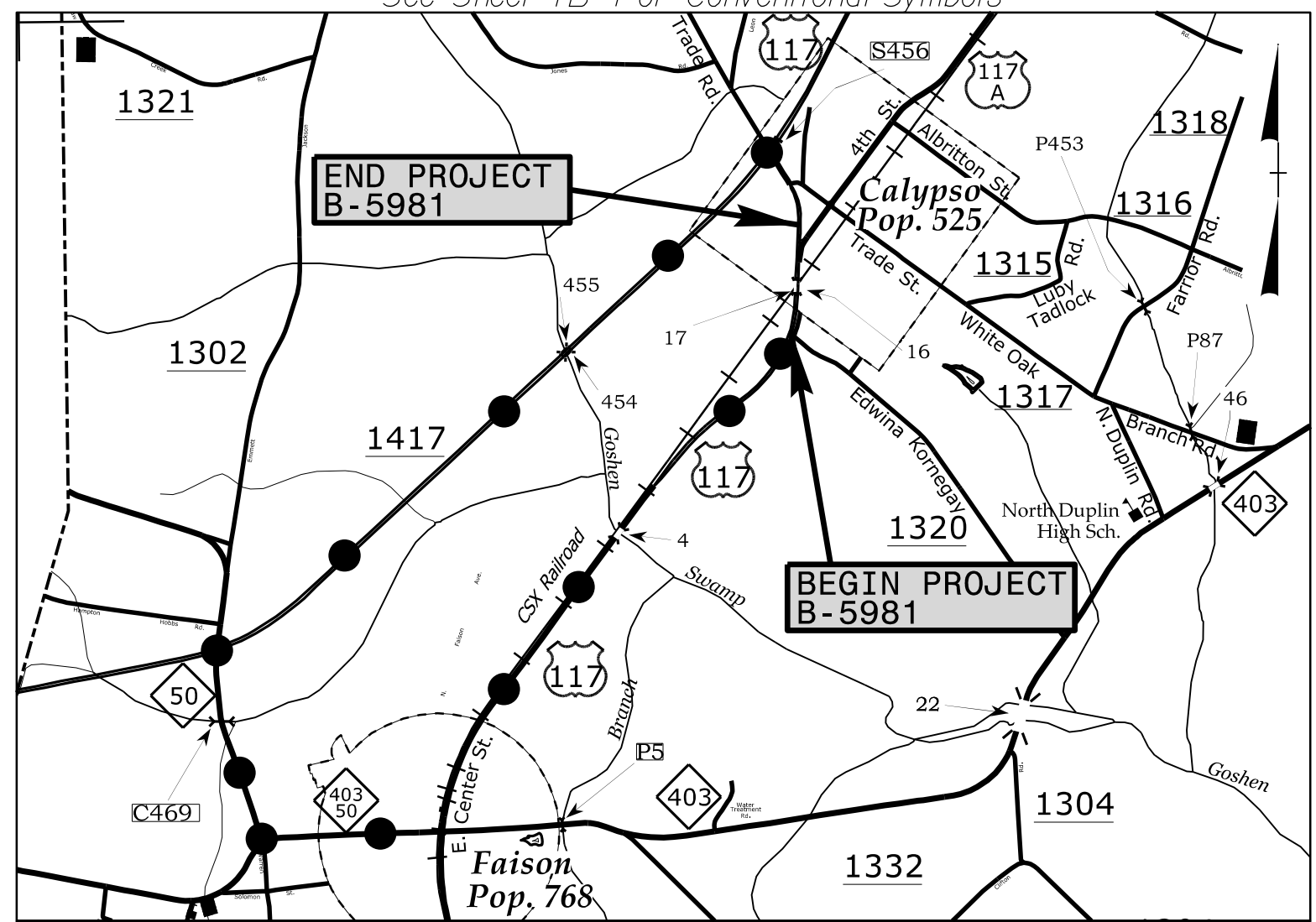

VICINITY MAP

NOT TO SCALE

●—●—●—● DETOUR ROUTE

STATE OF NORTH CAROLINA
DIVISION OF HIGHWAYS

DUPLIN COUNTY

**LOCATION: BRIDGE NO.16 OVER CSX RAILROAD ON
US-117 NORTH BOUND LANES AND
PRESERVATION OF BRIDGE NO.17 OVER CSX RAILROAD**

**TYPE OF WORK: GRADING, DRAINAGE, PAVING, STRUCTURE,
AND STRUCTURE PRESERVATION**

STATE	STATE PROJECT REFERENCE NO.	SHEET NO.	TOTAL SHEETS
N.C.	B-5981	1	
STATE PROJ. NO.	F.A. PROJ. NO.	DESCRIPTION	
47747.1.1		PE	
47747.2.1	BRZ-0117050	RW	
47747.3.1	BRZ-0117050	CONST.	

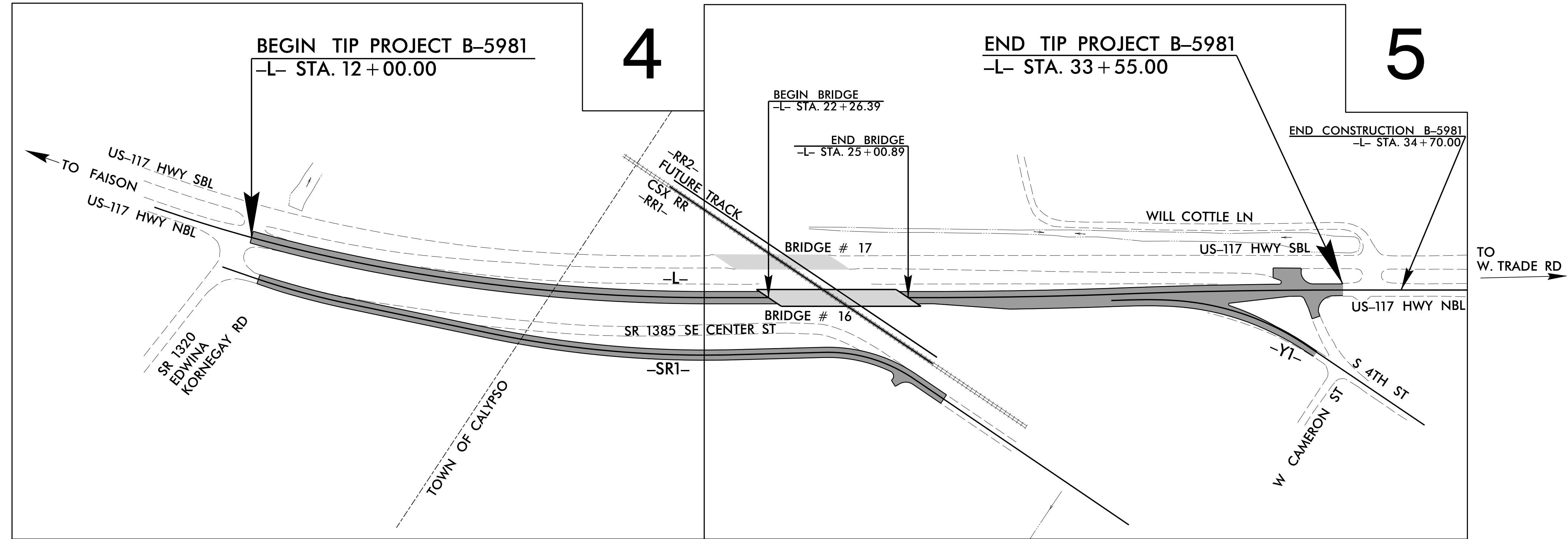
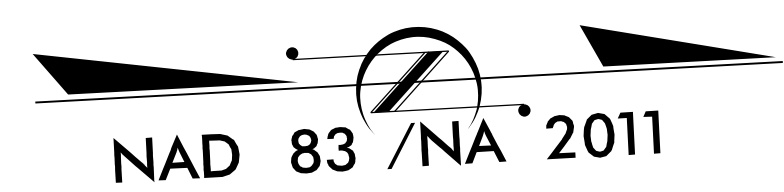

THIS IS A CONTROLLED-ACCESS FACILITY WITH ACCESS LIMITED TO INTERCHANGES OR AT GRADE INTERSECTIONS.

DOCUMENT NOT CONSIDERED FINAL
UNLESS ALL SIGNATURES COMPLETED

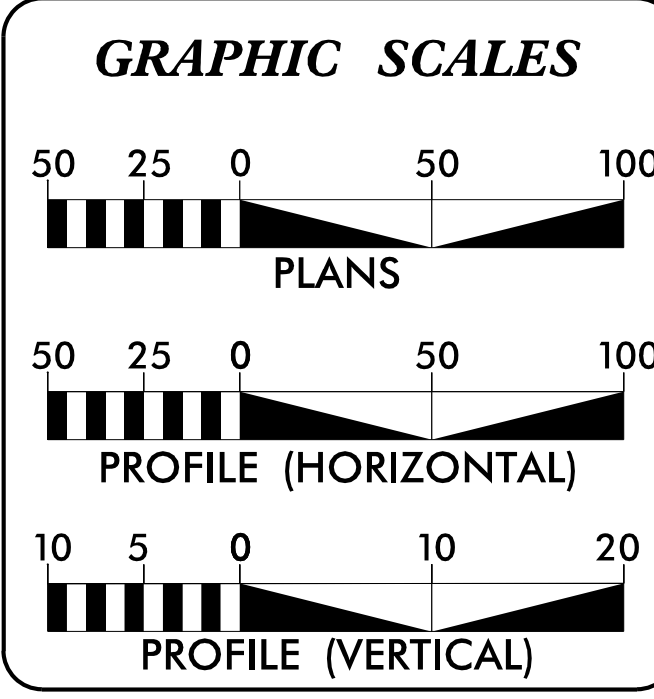

DESIGN DATA

ADT 2023 =	2,063
ADT 2042 =	2,300
K =	9% %
D =	100 %
T =	6 % *
V =	60 MPH

* (TTST=3%+DUAL=3%)

FUNC. CLASS = MAJOR COLLECTOR

REGIONAL TIER

PROJECT LENGTH

LENGTH OF ROADWAY TIP PROJECT B-5981 =	0.356 MI
LENGTH OF STRUCTURE TIP PROJECT B-5981 =	0.052 MI
LENGTH OF STRUCTURE REHAB TIP PROJECT B-5981 =	0.043 MI
TOTAL LENGTH OF TIP PROJECT B-5981 =	0.451 MI

Prepared in the Office of:
DIVISION OF HIGHWAYS
1000 Birch Ridge Dr., Raleigh, NC 27610

2018 STANDARD SPECIFICATIONS

RIGHT OF WAY DATE:
MAY 19, 2020

LETTING DATE:
DECEMBER 19, 2023

KRISTY W. ALFORD, PE PROJECT MANAGER	SHERRI E. CALHOUN, PE PROJECT TEAM LEAD
HAN C. NGUYEN, PE ROADWAY DESIGN ENGINEER	

HYDRAULICS ENGINEER

DocuSigned by:
Craig Lee
SIGNATURE: 10/02/2023

ROADWAY DESIGN ENGINEER

DocuSigned by:
Han C. Nguyen
SIGNATURE: 10/02/2023

