

THE ESTIMATED QUANTITY OF DUCTILE IRON PIPE SEWER FITTINGS ON THIS PLAN SHEET IS 350 POUNDS. THE ACTUAL NUMBER OF FITTINGS WILL VARY BASED ON PLAN CONDITIONS.

ESTIMATED I FITTINGS:  
 (6) 3" Ø 45° DIRJ ELBOWS  
 (1) 3" Ø 22.5° DIRJ ELBOWS

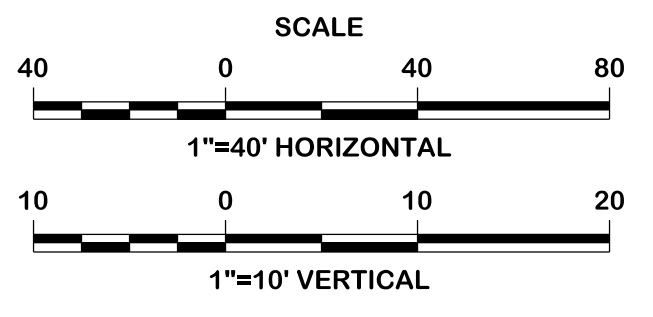
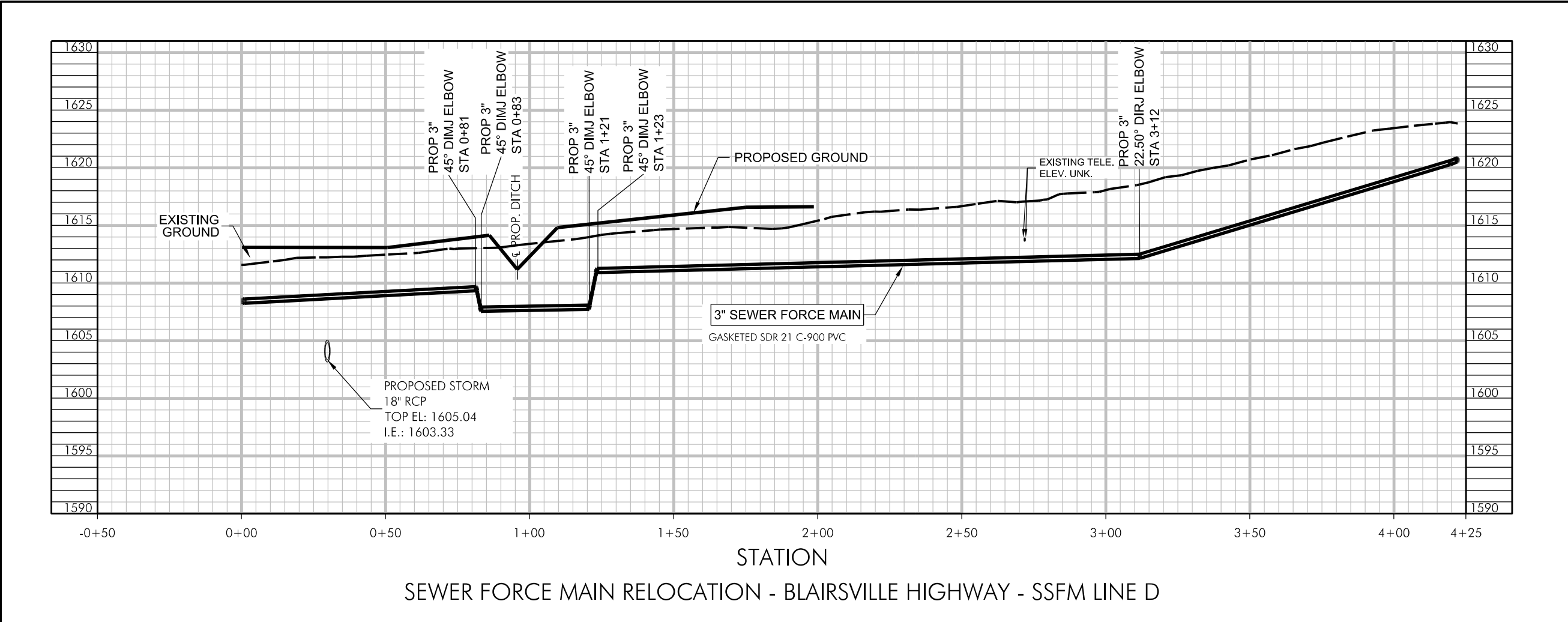

I:\2024\2023 - NCDOT R-5861 Cherokee\05-Export Client\Final\Final\F5861.ut...Rd\18\_U08\_psh.dgn  
 W:\181603 - NCDOT R-5861 Cherokee\05-Export Client\Final\Final\F5861.ut...Rd\18\_U08\_psh.dgn  
 Curtis, Ellison