

8/17/2023
 R:\Projects\2023\18-000\18-000-001\18-000-001.dgn
 R:\Projects\2023\18-000\18-000-001\18-000-001.dgn
 R:\Projects\2023\18-000\18-000-001\18-000-001.dgn

-L-	-Y8-	-Y9-
PI Sta 127+30.02	PI Sta 10+55.66	PI Sta 11+22.32
$\Delta = 23^\circ 20' 58.3" (LT)$	$\Delta = 24^\circ 56' 46.9" (RT)$	$\Delta = 73^\circ 19' 25.7" (RT)$
D = 2' 4" 46.6"	D = 35' 48" 35.5"	D = 45' 50" 11.8"
L = 865.99'	L = 69.66'	L = 159.97'
T = 439.09'	T = 35.39'	T = 93.04'
R = 2,125.00'	R = 160.00'	R = 125.00'
SE = 0.06	SE = 0.03	SE = 0.05
DS = 60 MPH	DS = 15 MPH	DS = 15 MPH

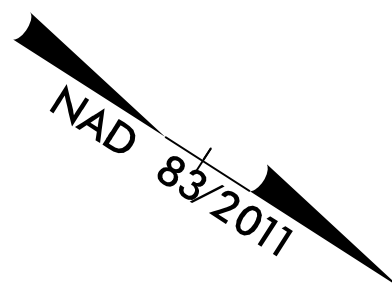

PROJECT REFERENCE NO. R-5861	SHEET NO. EC-31/CONST J3
RW SHEET NO.	
ROADWAY DESIGN ENGINEER	HYDRAULICS ENGINEER

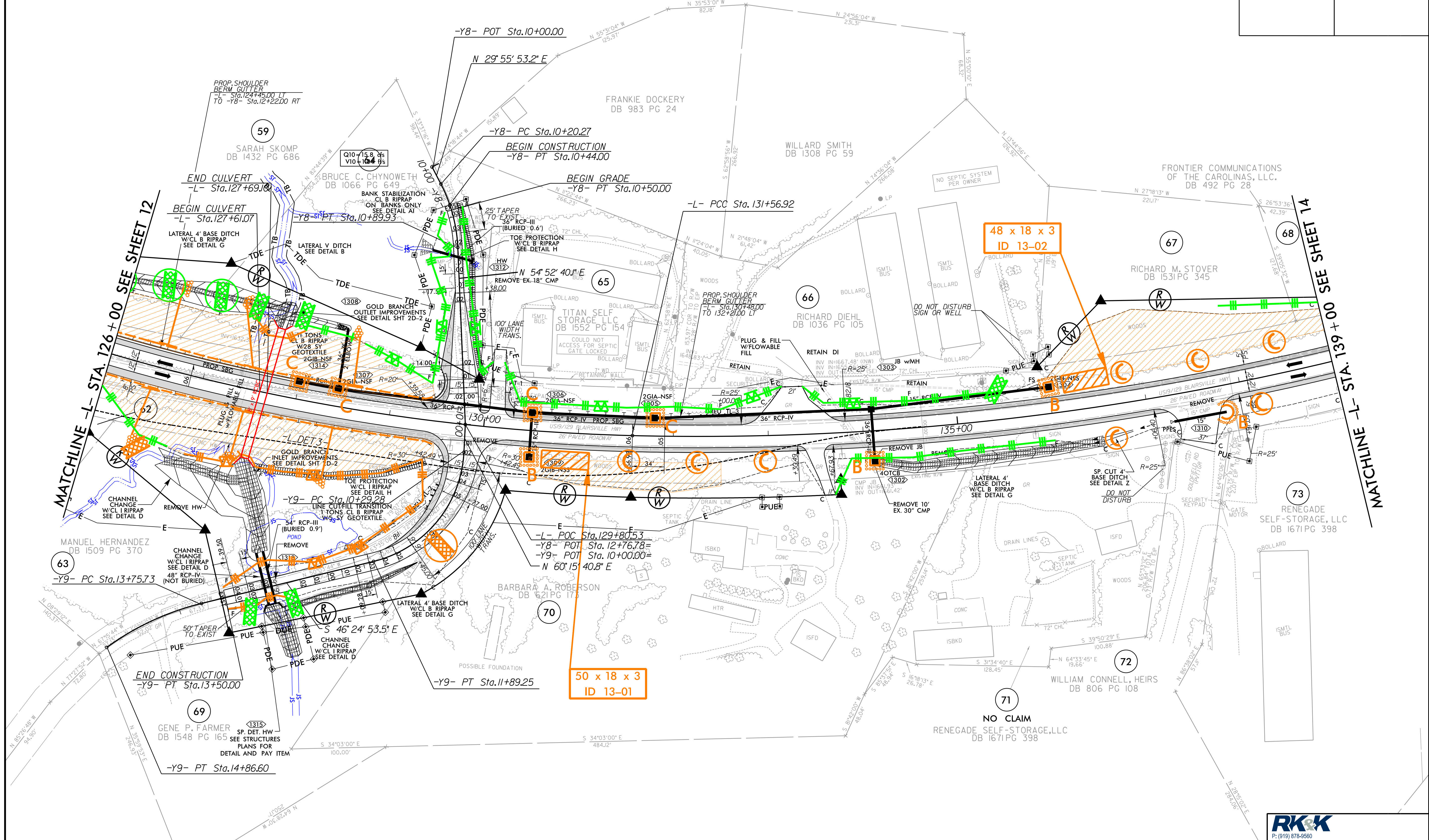

NOTE: ALL DRIVES ARE 16' WIDE WITH 10' RADII UNLESS OTHERWISE NOTED.

FOR -L- PROFILE SEE SHT. 26
 FOR -Y8- PROFILE SEE SHT. 31
 FOR -Y9- PROFILE SEE SHT. 32
 FOR DITCH DETAILS SEE SHTS. 2D-1 & 2D-2
 FOR HEADWALL SPECIAL DETAIL SEE SHTS. S-1 THRU S-6

RK&K
 P: (919) 878-9560
 8601 Six Forks Road, Forum 1, Suite 700
 Raleigh, North Carolina 27615-3960
 NC License No. F-0112
 Engineers | Construction Managers | Planners | Scientists
 www.rk&k.com
 Responsive People | Creative Solutions