

8/17/99
R:\18\2023\RA\Highways\Control\PSH\Erosion_Control\RS861_EC_psh30.dgn
P:\18\2023\RA\Highways\Control\PSH\Erosion_Control\RS861_EC_psh30.dgn

-L-		-DR15-	
PI Sta 127+30.02	PI Sta 11+99.43	PI Sta 12+96.26	PI Sta 13+52.13
$\Delta = 23^\circ 20' 58.3" (LT)$	$\Delta = 73^\circ 27' 47.3" (RT)$	$\Delta = 52^\circ 13' 28.3" (LT)$	$\Delta = 22^\circ 25' 31.3" (RT)$
$D = 2^\circ 41' 46.6"$	$D = 60^\circ 00' 00.0"$	$D = 60^\circ 00' 00.0"$	$D = 67^\circ 29' 52.7"$
$L = 865.99'$	$L = 122.44'$	$L = 87.04'$	$L = 33.22'$
$T = 439.09'$	$T = 74.62'$	$T = 49.02'$	$T = 17.84'$
$R = 2425.00'$	$R = 100.00'$	$R = 100.00'$	$R = 90.00'$
$SE = 0.06$	$SE = 0.02$	$SE = 0.02$	$SE = 0.02$
$RO = 165'$	$DS = 15 MPH$	$DS = 15 MPH$	$DS = 15 MPH$

PROJECT REFERENCE NO. R-5861	SHEET NO. EC-30/CONSTJ2
RW SHEET NO.	
ROADWAY DESIGN ENGINEER	HYDRAULICS ENGINEER

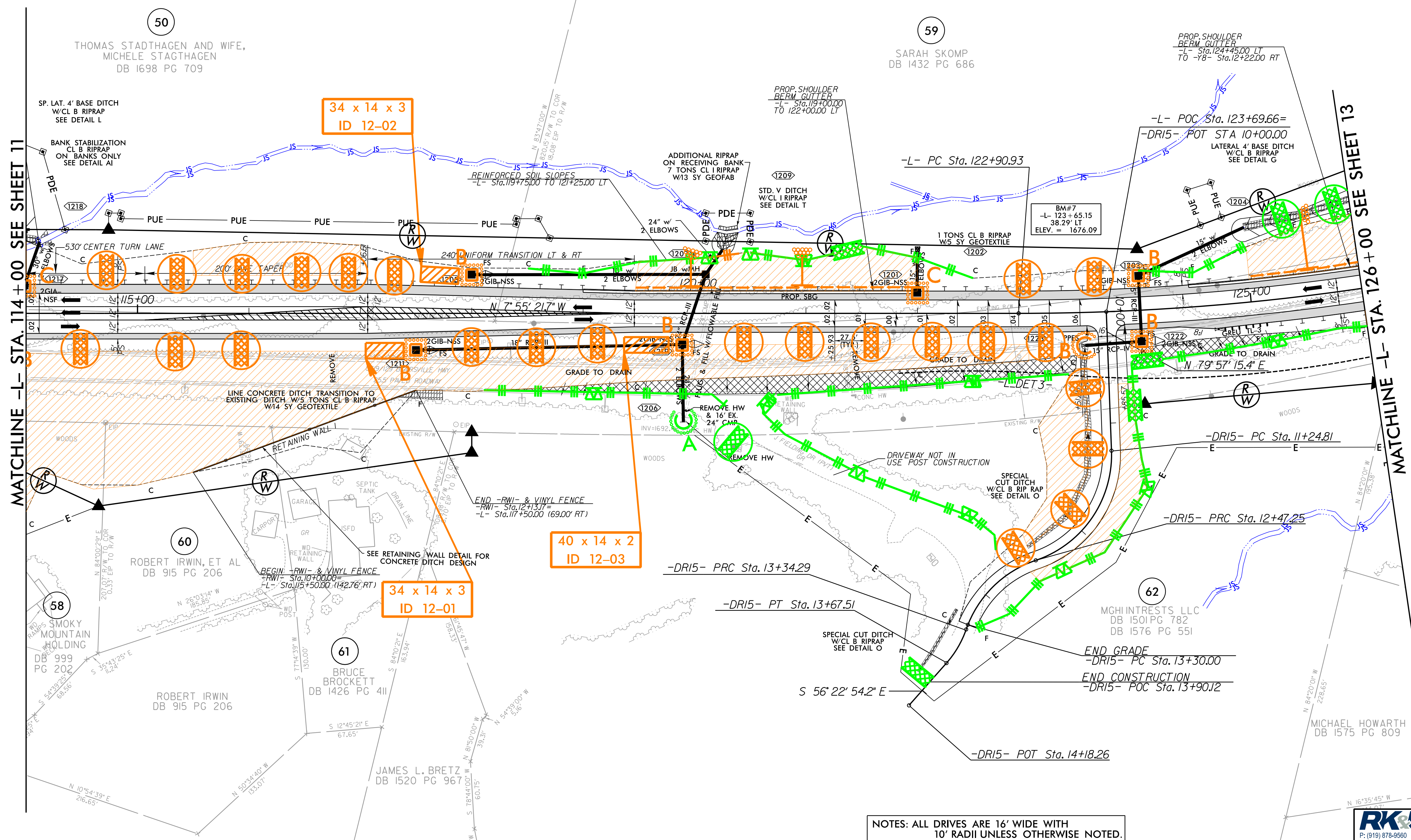
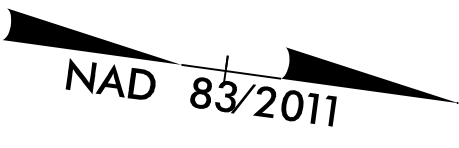

NOTES: ALL DRIVES ARE 16' WIDE WITH 10' RADII UNLESS OTHERWISE NOTED.

FOR -L- PROFILE SEE SHTS. 25 & 26
 FOR -DR15- PROFILE SEE SHT. 36
 FOR DITCH DETAILS SEE SHT. 2D-1 & 2D-2
 FOR RETAINING WALL ENVELOPE SEE SHT. W-1 THRU W-3
 FOR REINFORCED SOIL SLOPE DETAILS SEE SHTS. 2G-1 & 2G-2

RK&K
 P: (919) 878-9560
 8601 Six Forks Road, Forum 1, Suite 700
 Raleigh, North Carolina 27615-3960
 NC License No. F-0112
 Engineers | Construction Managers | Planners | Scientists
 www.rk&k.com
 Responsive People | Creative Solutions