

10/16/2023 R:\Roadway\Proj\NR5861\_L\_Rdy\_psh05.dgn

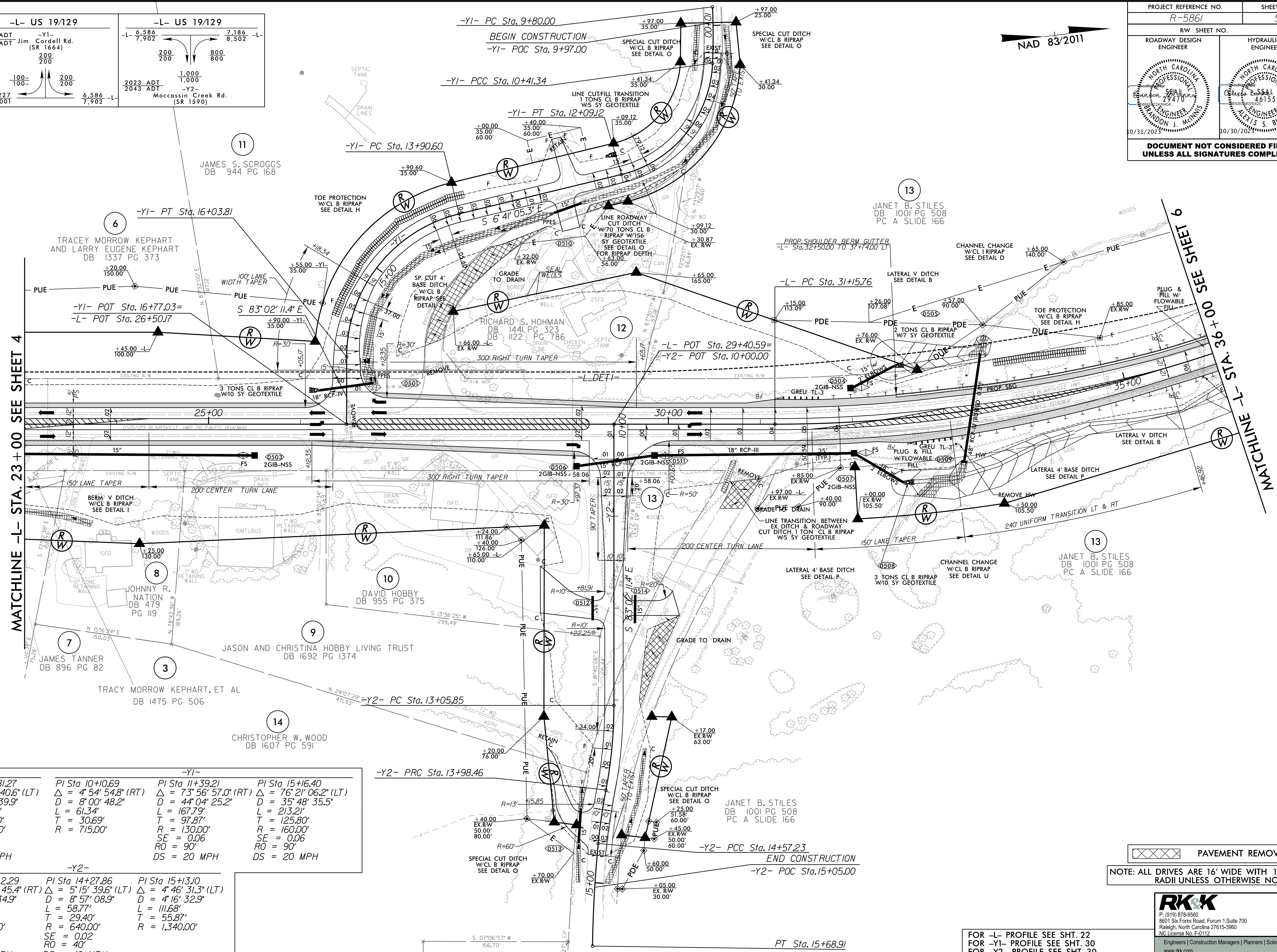

-L-		-Y1-	
PI Sta 33+81.27	PI Sta 10+10.69	PI Sta 11+39.21	PI Sta 15+16.40
$\Delta = 19^\circ 56' 40.6''$ (LT)	$\Delta = 4^\circ 54' 54.8''$ (RT)	$\Delta = 73^\circ 56' 57.0''$ (RT)	$\Delta = 76^\circ 21' 06.2''$ (LT)
D = 3' 47' 39.9"	D = 8' 00' 48.2"	D = 44' 04' 25.2"	D = 35' 48' 35.5"
L = 525.63'	L = 61.34'	L = 167.79'	L = 213.21'
T = 265.50'	T = 30.69'	T = 97.87'	T = 125.80'
R = 1,510.00'	R = 715.00'	R = 130.00'	R = 160.00'
SE = 0.06	SE = 0.06	SE = 0.06	SE = 0.06
RO = 210'	RO = 90'	RO = 90'	RO = 90'
DS = 60 MPH	DS = 20 MPH	DS = 20 MPH	DS = 20 MPH

-Y2-		
PI Sta 13+52.29	PI Sta 14+27.86	PI Sta 15+13.10
$\Delta = 10^\circ 49' 45.4''$ (RT)	$\Delta = 5^\circ 15' 39.6''$ (LT)	$\Delta = 4^\circ 46' 31.3''$ (LT)
D = 11' 41' 34.9"	D = 8' 57' 08.9"	D = 4' 16' 32.9"
L = 92.61'	L = 58.77'	L = 111.68'
T = 46.44'	T = 29.40'	T = 55.87'
R = 490.00'	R = 640.00'	R = 1,340.00'
SE = NC	SE = 0.02	SE = 0.02
RO = 40'	RO = 40'	RO = 40'
DS = 40 MPH	DS = 40 MPH	DS = 40 MPH

PAVEMENT REMOVAL  
NOTE: ALL DRIVES ARE 16' WIDE WITH 10' RADII UNLESS OTHERWISE NOTED.

**RK&K**  
P: (919) 978-9560  
8601 Six Forks Road, Forum 1, Suite 700  
Raleigh, North Carolina 27615-3960  
NC License No. F-0112  
Engineers | Construction Managers | Planners | Scientists  
www.rk.com  
Responsive People | Creative Solutions

FOR -L- PROFILE SEE SHT. 22  
FOR -Y1- PROFILE SEE SHT. 30  
FOR -Y2- PROFILE SEE SHT. 30  
FOR DITCH DETAILS SEE SHT. 2D-1 & 2D-2