

PLATED TRAFFIC BEARING PRECAST STRUCTURES:  
 INSTALL TRAFFIC BEARING PRECAST STRUCTURES 1017 AND 1018.

FIELD VERIFY TOP OF STRUCTURE ELEVATION PRIOR TO MANUFACTURE. BACKFILL/PLATE AND PAVE OVER AS DIRECTED BY THE ENGINEER.  
 (STRUCTURES 1017 AND 1018 WILL REMAIN NON-FUNCTIONING UNTIL PHASE 6)

INSTALL LONGITUDINAL CHANNELIZING CURB SYSTEM ALONG MIDDLE OF MEDIAN.

IN ACCORDANCE WITH THE TIME RESTRICTIONS ON TMP-2, CLOSE THE OUTSIDE TRAVEL LANE ON -L- (US 421) TO CONSTRUCT THE RIGHT SIDE OF -L-. SEE RSD 1101.02, SHEET 3 OF 14 FOR DETAIL.

MAINTAIN SIDE STREET LANEAGE DURING CONSTRUCTION. REPLACE EXISTING MARKINGS WITH TEMPORARY PAINT MARKINGS AS NEEDED. USE TEMPORARY LANE CLOSURES AS NEEDED TO CONSTRUCT SIDE STREET. (TYP.)

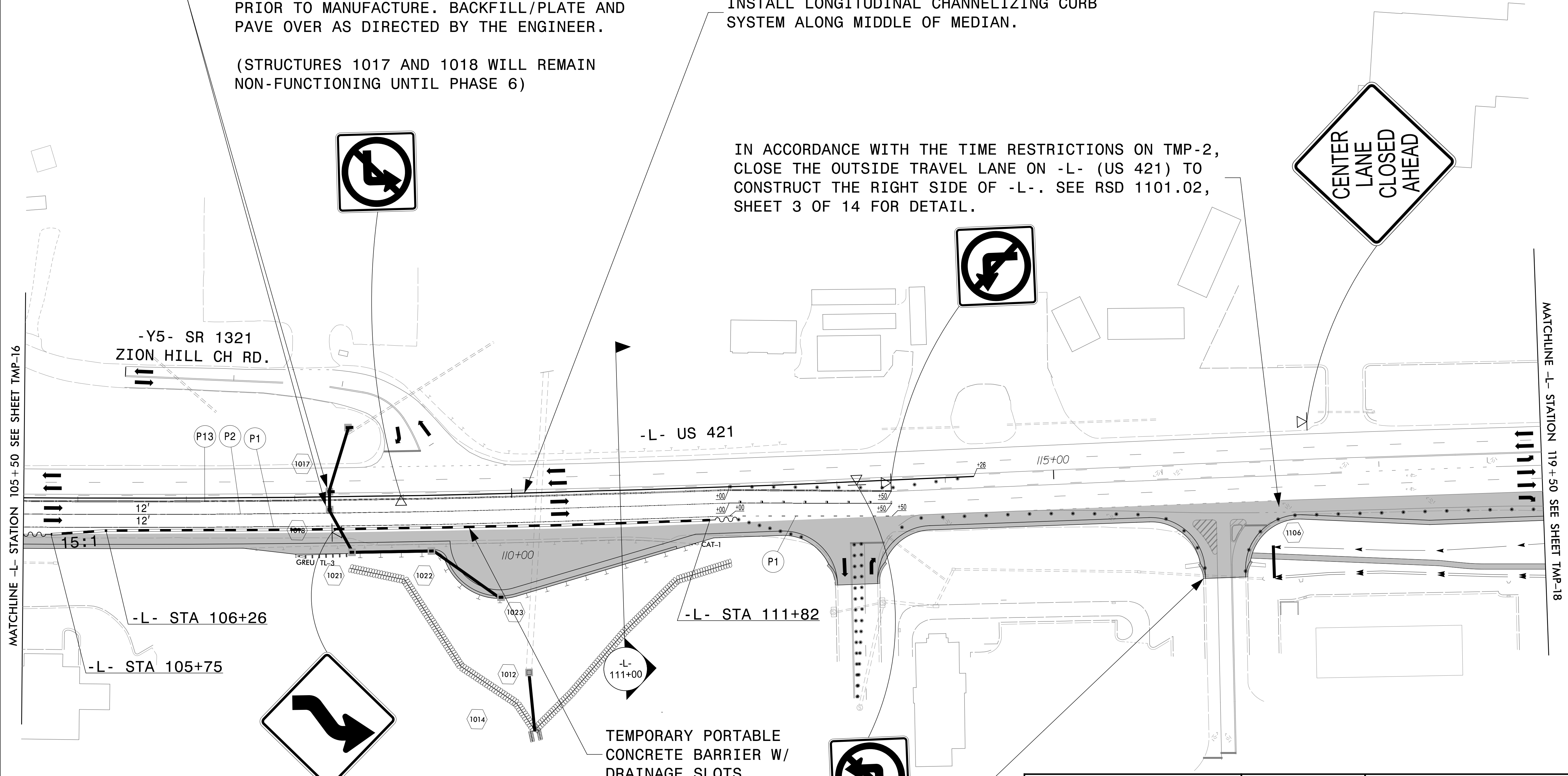
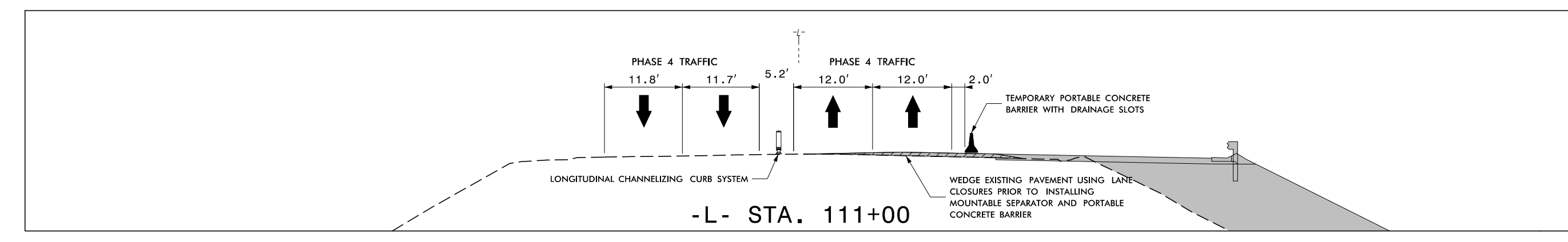

APPROVED: _____			<p>PHASE 4 DETAIL</p>
DATE: _____			
<p><b>DOCUMENT NOT CONSIDERED FINAL UNLESS ALL SIGNATURES COMPLETED</b></p>			

8/9/2023  
 R:\TrafficControl\CP\U5312\_fc\_tmp17.dgn  
 User:jtownden