

FOR -L- PROFILE SEE SHEET 21
FOR INTERSECTION AND U-TURN BULB DETAILS SEE SHEETS 2B-II & 2B-12
FOR FLARING C&G DETAIL AT DRIVEWAY TIE-INS SEE SHEET 2A-1

PROJECT REFERENCE NO. U-5312		SHEET NO. 13	
ROADWAY DESIGN ENGINEER		HYDRAULICS ENGINEER	
DOCUMENT NOT CONSIDERED FINAL UNLESS ALL SIGNATURES COMPLETED			

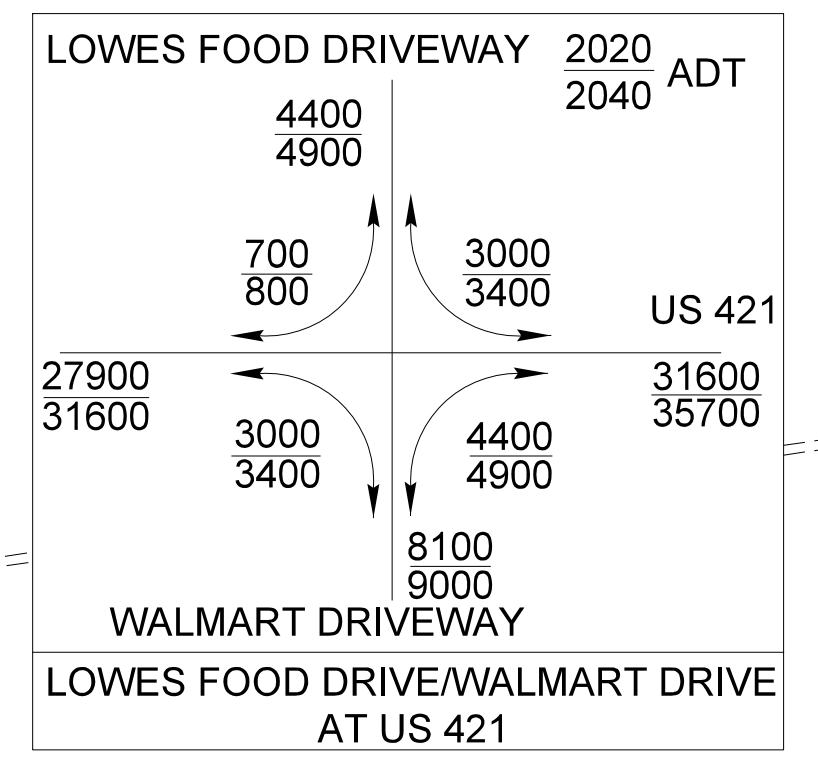

-L-
 PI Sta 156+85.53
 $\Delta = 0^{\circ} 59' 24.4''$ (RT)
 $D = 0^{\circ} 06' 15.0''$
 $L = 950.44'$
 $T = 475.23'$
 $R = 55,000.00'$
 $S_e = NC$

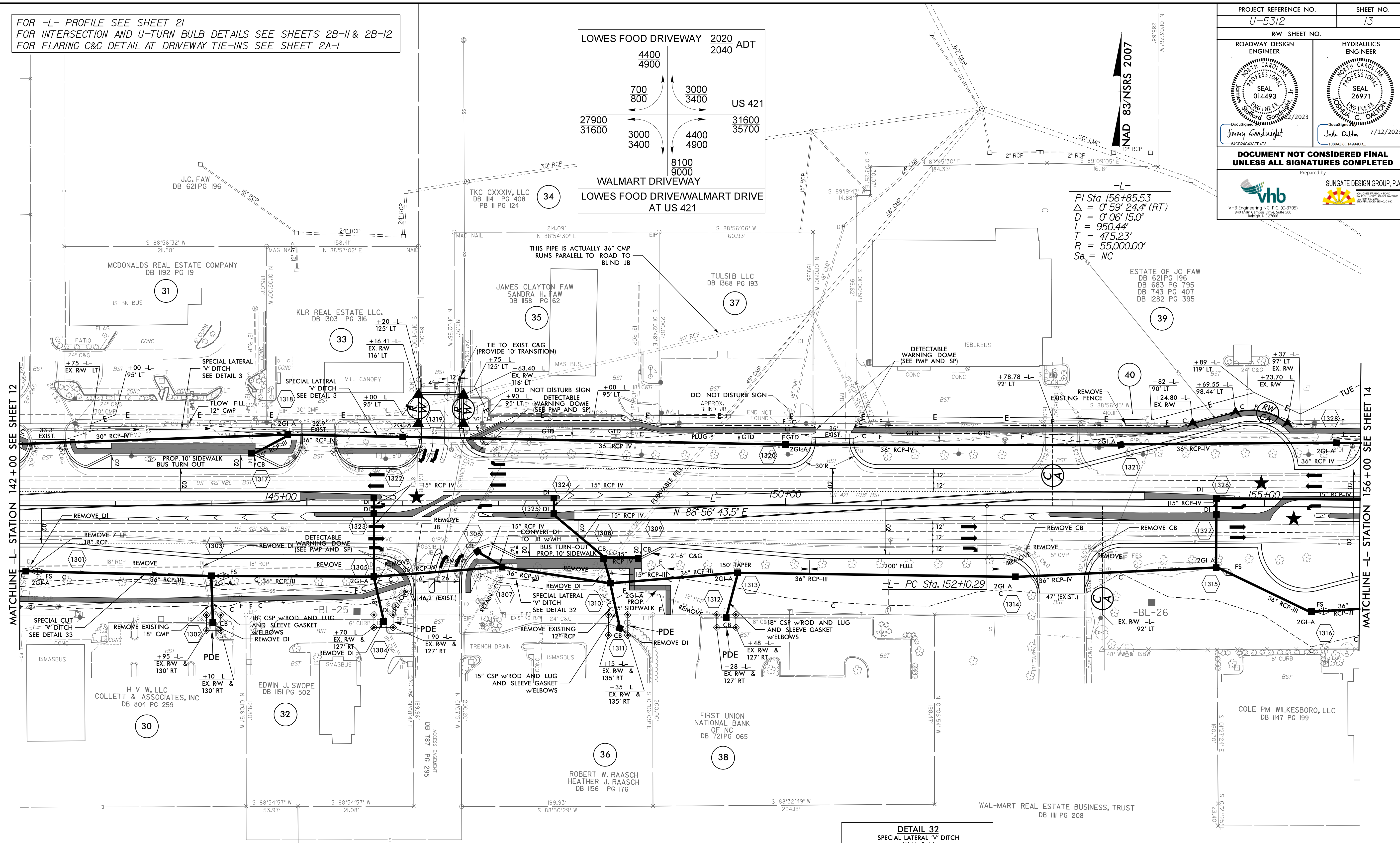

MATCHLINE -L- STATION 142+00 SEE SHEET 12

MATCHLINE -L- STATION 156+00 SEE SHEET 14

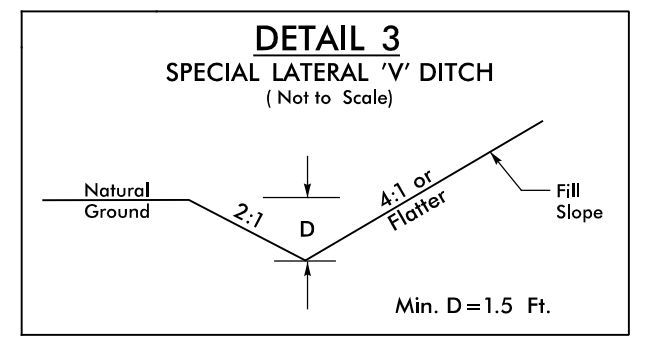

FROM STA. 143+00 -L- TO STA. 144+75 -L- LT
FROM STA. 145+60 -L- TO STA. 146+00 -L- LT

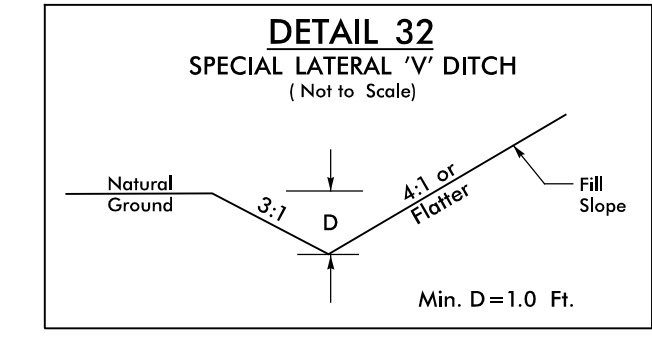

FROM STA. 147+00 -L- TO STA. 148+00 -L- RT

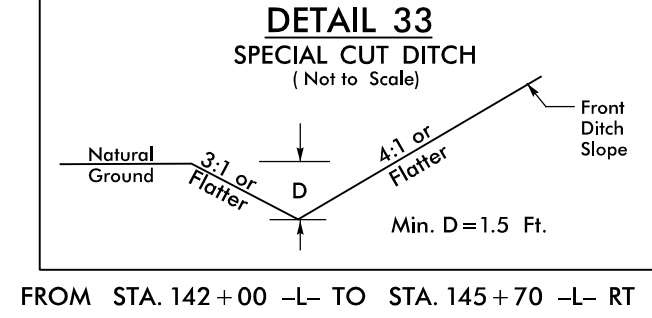

FROM STA. 142+00 -L- TO STA. 145+70 -L- RT

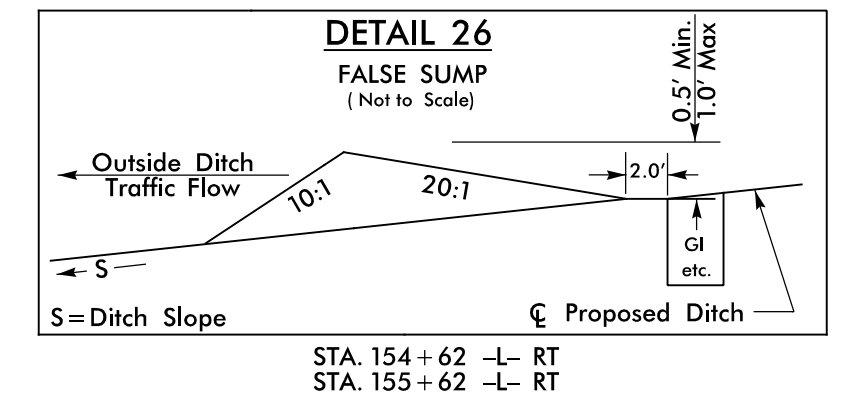

STA. 154+62 -L- RT
STA. 155+62 -L- RT

★ DENOTES PROPOSED SIGNALIZED INTERSECTION