

PLAN OF RIGHT WINGWALL

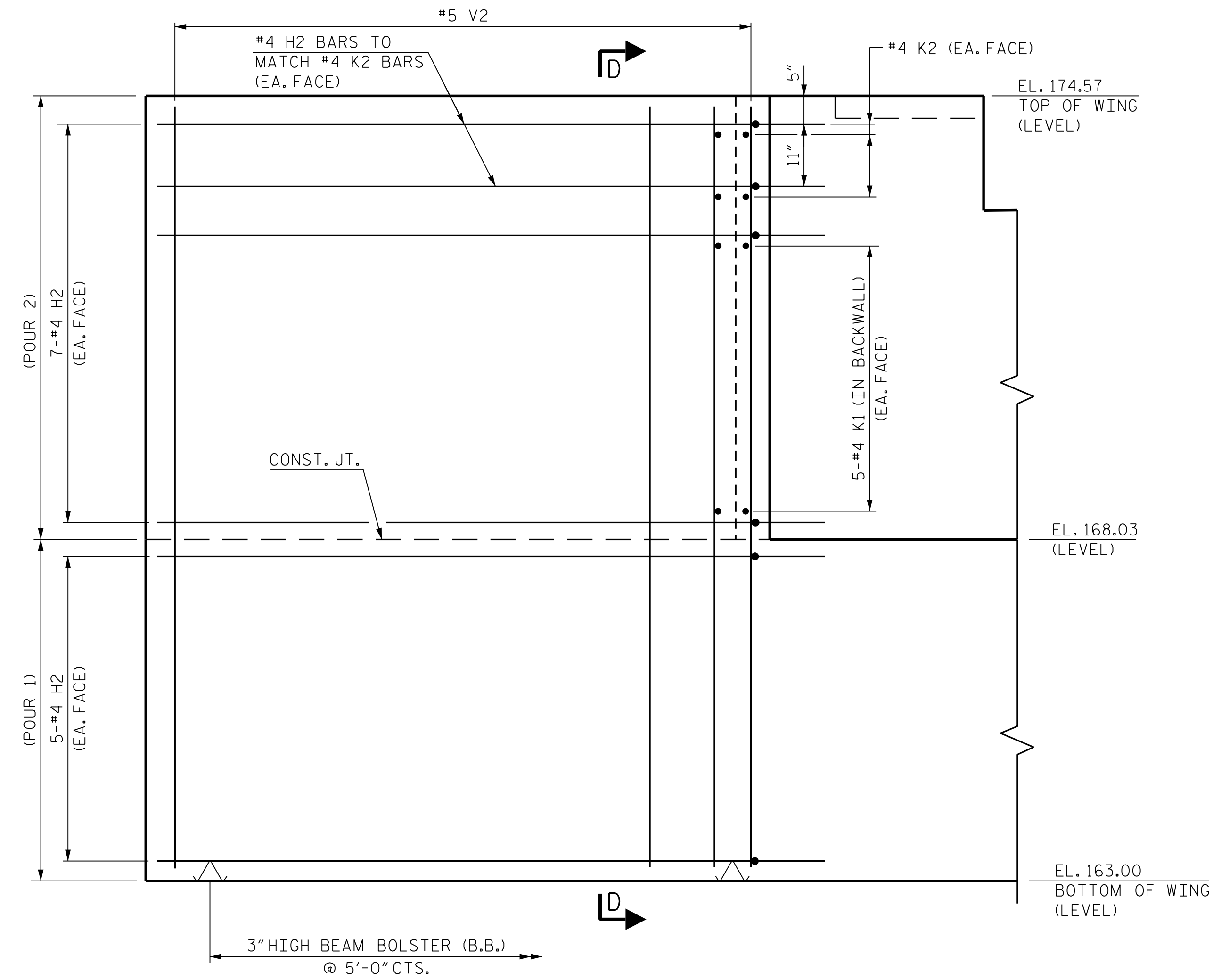

ELEVATION OF RIGHT WINGWALL

RIGHT WINGWALL DETAILS (W2)

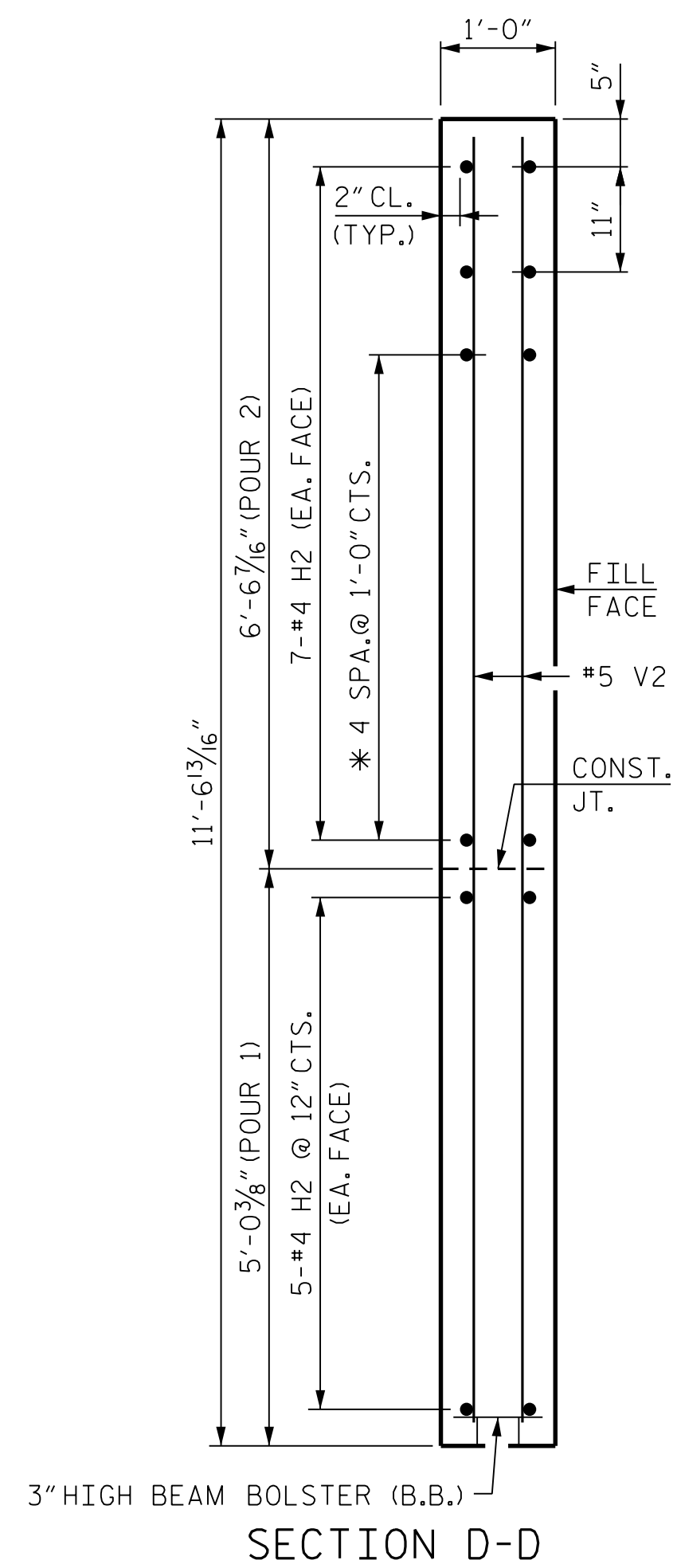

3\"/>

\* MATCH TO K1 BARS  
IN BACKWALL

PROJECT NO. I-5972  
JOHNSTON COUNTY  
 STATION: 36+93.50 -Y1-

SHEET 2 OF 3

STATE OF NORTH CAROLINA  
 DEPARTMENT OF TRANSPORTATION  
 RALEIGH

SUBSTRUCTURE  
 END BENT 2  
 WINGWALL DETAILS  
 STAGE 1

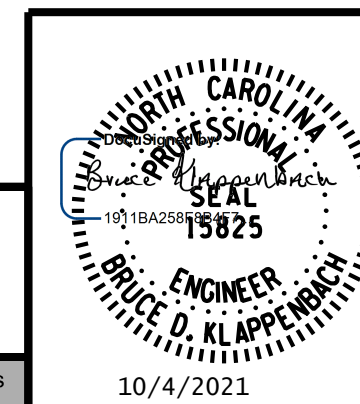

**RK&K**  
 P: (919) 878-9560  
 8601 Six Forks Road, Forum 1 Suite 700  
 Raleigh, North Carolina 27615 | NC License No. F-0112  
 Engineers | Construction Managers | Planners | Scientists  
 www.rkk.com

10/4/2021

REVISIONS						SHEET NO.
NO.	BY:	DATE:	NO.	BY:	DATE:	S-46
1			3			TOTAL SHEETS
2			4			54

**DOCUMENT NOT CONSIDERED FINAL  
 UNLESS ALL SIGNATURES COMPLETED**

R:\Structures\DN\BR\_500066\Final\I5972\_SMU.E2.1B\_500066.dgn  
 10/4/2021 10:44:20 AM bhag

DRAWN BY : B. A. HAAG DATE : JUN 2021  
 CHECKED BY : D. M. RAGAN DATE : JUN 2021  
 DESIGN ENGINEER OF RECORD : B. D. KLAPPENBACH DATE : JUN 2021