

REINFORCED CONCRETE DECK SLAB
 STAGE 1 = 7,993 SQ. FT.
 STAGE 2 = 11,448 SQ. FT.
 TOTAL = 19,441 SQ. FT.

SUPERSTRUCTURE REINFORCING STEEL LENGTHS ARE BASED ON THE FOLLOWING MINIMUM SPLICE LENGTHS

BAR SIZE	SUPERSTRUCTURE EXCEPT APPROACH SLABS, PARAPETS, AND BARRIER RAILS		APPROACH SLABS		PARAPETS AND BARRIER RAILS
	EPOXY COATED	UNCOATED	EPOXY COATED	UNCOATED	EPOXY COATED
#4	1'-11"	1'-7"	1'-11"	1'-7"	2'-6"
#5	2'-5"	2'-0"	2'-5"	2'-0"	3'-1"
#6	2'-10"	2'-5"	3'-7"	2'-5"	3'-8"
#7	4'-2"	2'-9"			
#8	4'-9"	3'-2"			

REINFORCING BAR SCHEDULE - STAGE 1

BAR	NO.	SIZE	TYPE	LENGTH	WEIGHT	BAR	NO.	SIZE	TYPE	LENGTH	WEIGHT
*A1	352	5	STR.	36'-3"	13,309	*B1	128	4	STR.	37'-3"	3,185
A2	352	5	STR.	36'-3"	13,309	*B2	32	6	STR.	50'-0"	2,403
*A101	4	5	STR.	35'-0"	146	*B3	32	6	STR.	29'-10"	1,434
*A102	4	5	STR.	33'-6"	140	*B4	31	6	STR.	34'-0"	1,583
*A103	4	5	STR.	32'-1"	134	*B5	160	5	STR.	55'-11"	9,331
*A104	4	5	STR.	30'-8"	128	*B6	30	4	STR.	37'-11"	760
*A105	4	5	STR.	29'-2"	122	*D1	400	5	STR.	5'-3"	2,190
*A106	4	5	STR.	27'-9"	116	D2	400	5	STR.	5'-3"	2,190
*A107	4	5	STR.	26'-4"	110	*G1	2	5	STR.	45'-4"	95
*A108	4	5	STR.	24'-10"	104	*G3	215	4	STR.	4'-6"	646
*A109	4	5	STR.	23'-5"	98						
*A110	4	5	STR.	22'-0"	92						
*A111	4	5	STR.	20'-6"	86	*K1	4	8	1	13'-9"	147
*A112	4	5	STR.	19'-1"	80	*K2	12	8	2	19'-7"	627
*A113	4	5	STR.	17'-7"	73	*K3	4	8	1	9'-6"	101
*A114	4	5	STR.	16'-2"	67	*K4	24	6	STR.	7'-10"	282
*A115	4	5	STR.	14'-9"	62	K5	10	4	6	6'-6"	43
*A116	4	5	STR.	13'-3"	55	K6	15	4	7	12'-10"	129
*A117	4	5	STR.	11'-10"	49	K7	8	4	STR.	6'-6"	35
*A118	4	5	STR.	10'-5"	43	K8	16	4	STR.	9'-1"	97
*A119	4	5	STR.	8'-11"	37	K9	16	4	STR.	7'-10"	84
*A120	4	5	STR.	7'-6"	31						
*A121	4	5	STR.	6'-1"	25	*S1	64	4	4	4'-2"	178
*A122	4	5	STR.	4'-7"	19	*S2	64	5	3	6'-2"	412
*A123	4	5	STR.	3'-2"	13	S3	104	4	8	3'-6"	243
*A124	3	6	STR.	7'-1"	32						
A201	4	5	STR.	35'-0"	146	U1	8	4	5	11'-9"	63
A202	4	5	STR.	33'-6"	140	U2	20	4	5	13'-9"	184
A203	4	5	STR.	32'-1"	134	*U3	62	4	9	3'-1"	128
A204	4	5	STR.	30'-8"	128						
A205	4	5	STR.	29'-2"	122						
A206	4	5	STR.	27'-9"	116						
A207	4	5	STR.	26'-4"	110						
A208	4	5	STR.	24'-10"	104						
A209	4	5	STR.	23'-5"	98						
A210	4	5	STR.	22'-0"	92						
A211	4	5	STR.	20'-6"	86						
A212	4	5	STR.	19'-1"	80						
A213	4	5	STR.	17'-7"	73						
A214	4	5	STR.	16'-2"	67						
A215	4	5	STR.	14'-9"	62						
A216	4	5	STR.	13'-3"	55						
A217	4	5	STR.	11'-10"	49						
A218	4	5	STR.	10'-5"	43						
A219	4	5	STR.	8'-11"	37						
A220	4	5	STR.	7'-6"	31						
A221	4	5	STR.	6'-1"	25						
A222	4	5	STR.	4'-7"	19						
A223	4	5	STR.	3'-2"	13						
A224	3	6	STR.	6'-8"	30						

REINFORCING STEEL 27,568 LBS.
 *EPOXY COATED REINFORCING STEEL 29,342 LBS.

BAR TYPES

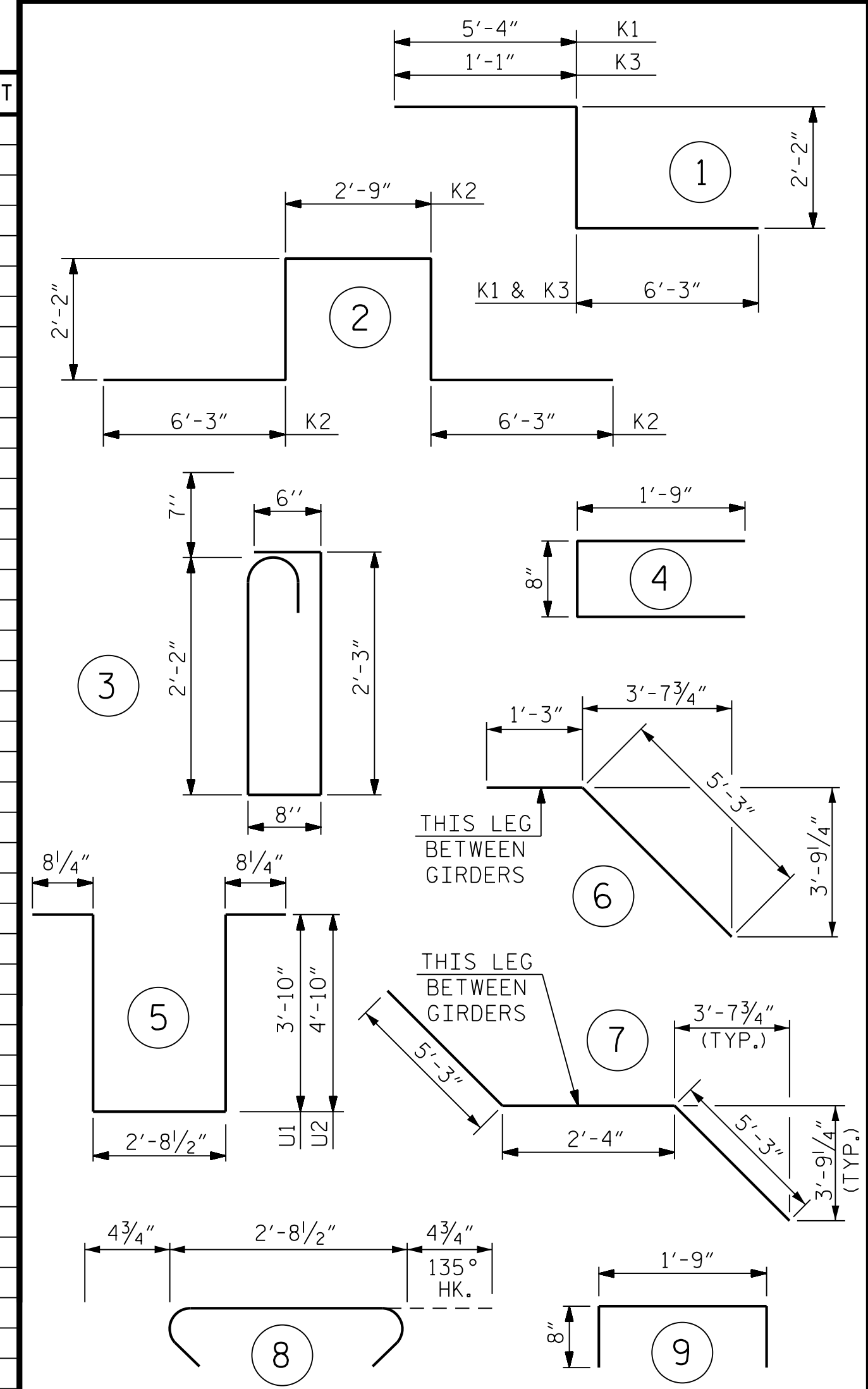

ALL BAR DIMENSIONS ARE OUT TO OUT

SUPERSTRUCTURE BILL OF MATERIAL

	CLASS AA CONCRETE (CU. YDS.)	REINFORCING STEEL (LBS.)	EPOXY COATED REINFORCING STEEL (LBS.)
POUR 1	108.4		
POUR 2	143.3		
POUR 3 (SIDEWALK)	24.4		
TOTALS**	276.1	27,568	29,342

**QUANTITIES FOR CONCRETE PARAPET ARE NOT INCLUDED

PROJECT NO. I-5972
 JOHNSTON COUNTY
 STATION: 36+93.50 -Y1-

SHEET 1 OF 2

STATE OF NORTH CAROLINA
 DEPARTMENT OF TRANSPORTATION
 RALEIGH
 SUPERSTRUCTURE
 BILL OF MATERIAL
 STAGE 1

REVISIONS						SHEET NO.
NO.	BY:	DATE:	NO.	BY:	DATE:	
1			3			S-33
2			4			TOTAL SHEETS 54

GROOVING BRIDGE FLOORS (STAGE 1)

APPROACH SLABS	1,394 SQ.FT.
BRIDGE DECK	6,283 SQ.FT.
TOTAL	7,677 SQ.FT.

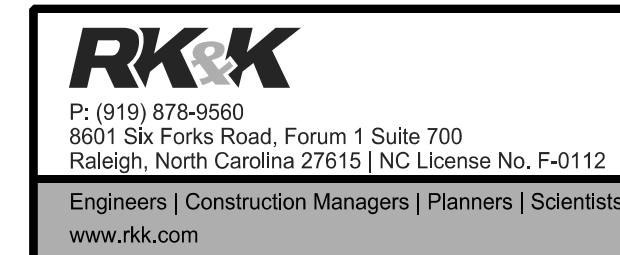

ENGINEERS | CONSTRUCTION MANAGERS | PLANNERS | SCIENTISTS
 www.rk&k.com
 Responsive People | Creative Solutions

DOCUMENT NOT CONSIDERED FINAL UNLESS ALL SIGNATURES COMPLETED

bklappenbach 9/13/2023 R:\Structures\DON\BR_500066\Final\I5972_SMU_BM1_500066.dgn

DRAWN BY : B. A. HAAG DATE : JUN 2021
 CHECKED BY : B. D. KLAPPENBACH DATE : JUN 2021
 DESIGN ENGINEER OF RECORD : B. D. KLAPPENBACH DATE : JUN 2021